

RESIDENTIAL TOWNHOMES

15-19 Atherton Ave, Nashua, NH 03064

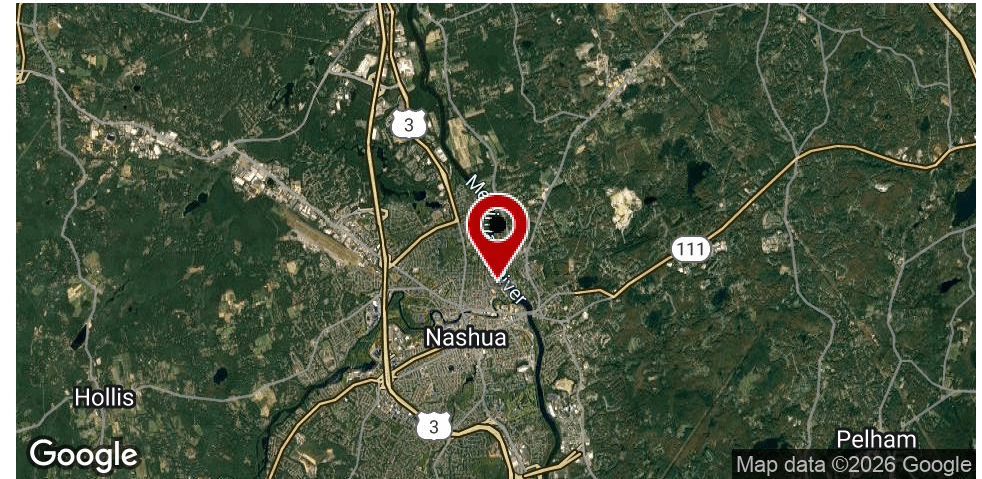
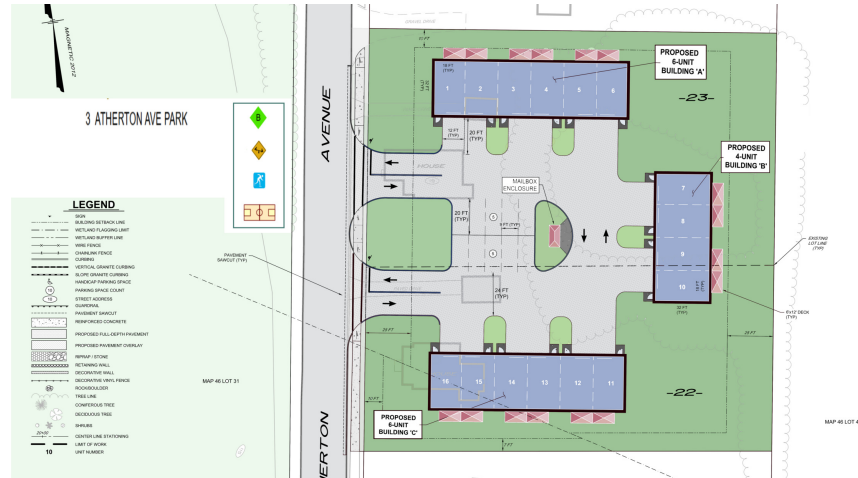

PROPERTY DESCRIPTION

The optionee of this property presents a proposed 16-unit residential townhome style development across from the park on Atherton Ave. These are two flat lots with excellent soils—great for keeping sitework costs down (e.g., no road, blasting, excess fill, or otherwise required). Natural gas and all city utilities are sized appropriately and ready for easy connection at the street. Seller is in the process of obtaining Zoning Board of Adjustment (ZBA) variance approvals supporting 16-unit townhome development, to be delivered prior to closing. Buyer to pursue all remaining Planning Board approvals, site plan review, and permits. The buyer shall provide their own building plans to the PBA (e.g., the builder is not tied into a product or construction style they don't like). The buyer may elect to phase the development as preferred for greater flexibility. The optionee is taking all offers and will consider owner financing, a joint venture, and/or selling its option prior to obtaining approvals at discount. Deals like this don't come around often in Nashua. Don't miss out on your chance to secure a winning project for 2026.

PROPERTY HIGHLIGHTS

- The properties may be purchased individually or as a package:
- 15-19 Atherton combined — potential for 16 to 20 total units
- 15 Atherton or 19 Atherton purchased separately
- Construction plans may be available, subject to mutually agreed-upon terms.

OFFERING SUMMARY

Sale Price:	\$1,450,000
Conceptual Drawings, number of units:	16+ Townhomes
Lot Size:	51,601 SF

We obtained the information above from sources we believe to be reliable. However, we have not verified its accuracy and make no guarantee, warranty or representation about it. It is submitted subject to the possibility of errors, omissions, change of price, rental or other conditions, prior sale, lease or financing, or withdrawal without notice. We include projections, opinions, assumptions or estimates for example only, and they may not represent current or future performance of the property. You and your tax and legal advisors should conduct your own investigation of the property and transaction.

VIKTORIA ALKOVA
Commercial Specialist, MiCP
O: 603.610.8500
C: 646.577.1194
viktoria@kwclcg.com
NH #074657

ETHAN ASH
Commercial & Investment Specialist, MiCP
O: 603.610.8500 X1430
C: 603.707.2319
ethan.ash@kw.com
NH #071469

DAVE GARVEY
Managing Director
O: 603.610.8523
C: 603.491.2854
dave@kwclcg.com
NH #004637

LISA ALKOVA
Commercial Specialist
O: 508.308.5617
C:
lisa@kwclcg.com
NH #081274

KELLER WILLIAMS COASTAL REALTY
603.610.8500
750 Lafayette Rd.
Suite 201 - Coastal Land & Commercial Group
Portsmouth, NH 03801

Each Office Independently Owned and Operated kwclcg.com

DEVELOPMENT OPPORTUNITY FOR SALE

RESIDENTIAL TOWNHOMES

15-19 Atherton Ave, Nashua, NH 03064



We obtained the information above from sources we believe to be reliable. However, we have not verified its accuracy and make no guarantee, warranty or representation about it. It is submitted subject to the possibility of errors, omissions, change of price, rental or other conditions, prior sale, lease or financing, or withdrawal without notice. We include projections, opinions, assumptions or estimates for example only, and they may not represent current or future performance of the property. You and your tax and legal advisors should conduct your own investigation of the property and transaction.

VIKTORIA ALKOVA
Commercial Specialist, MiCP
O: 603.610.8500
C: 646.577.1194
viktoria@kwclcg.com
NH #074657

ETHAN ASH
Commercial & Investment Specialist, MiCP
O: 603.610.8500 X1430
C: 603.707.2319
ethan.ash@kw.com
NH #071469

DAVE GARVEY
Managing Director
O: 603.610.8523
C: 603.491.2854
dave@kwclcg.com
NH #004637

LISA ALKOVA
Commercial Specialist
O: 508.308.5617
C:
lisa@kwclcg.com
NH #081274

KELLER WILLIAMS COASTAL REALTY
603.610.8500
750 Lafayette Rd.
Suite 201 - Coastal Land & Commercial Group
Portsmouth, NH 03801

Each Office Independently Owned and Operated **kwclcg.com**

RESIDENTIAL TOWNHOMES

15-19 Atherton Ave, Nashua, NH 03064

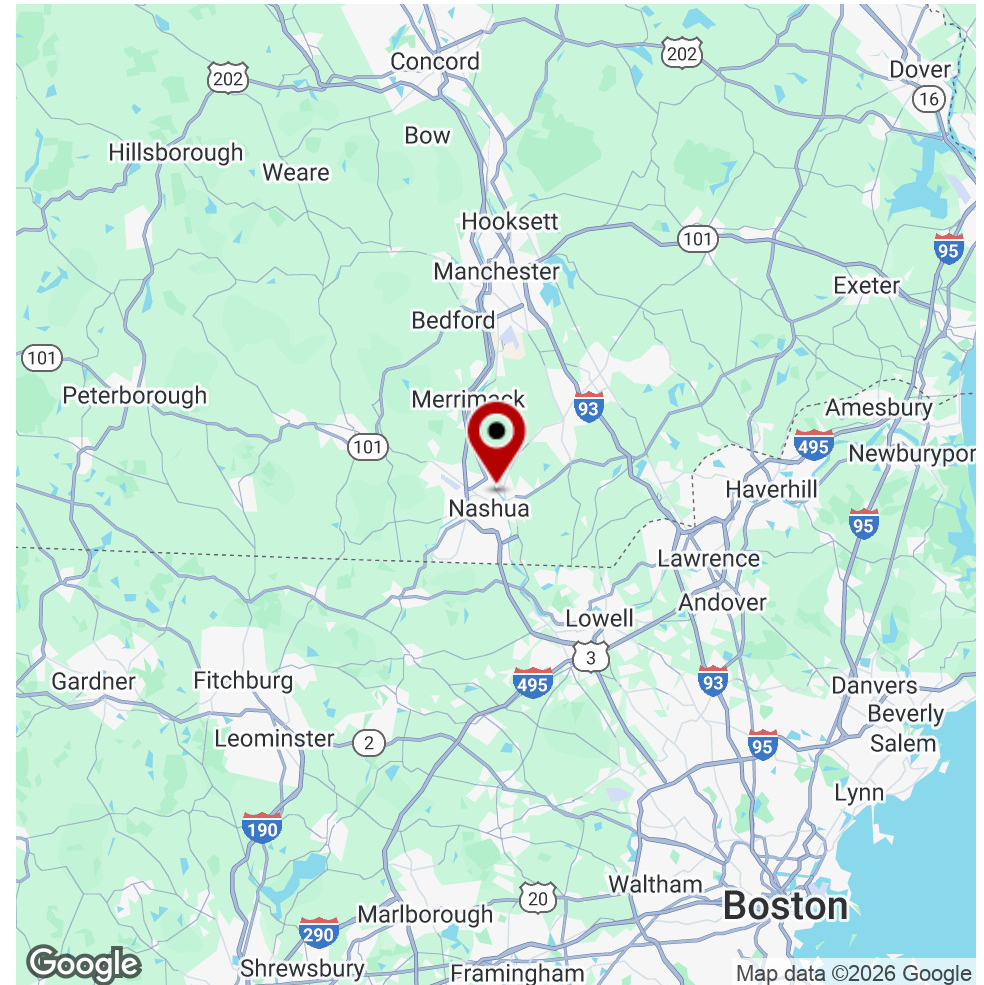
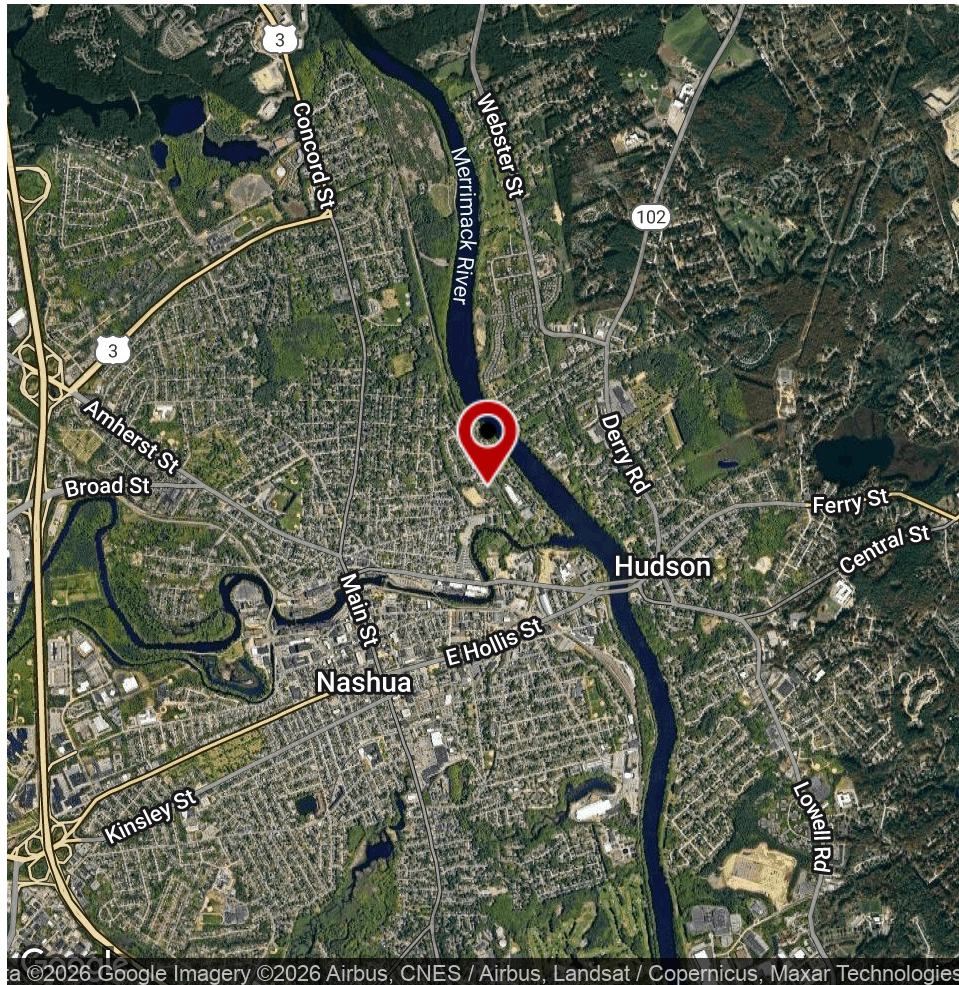

We obtained the information above from sources we believe to be reliable. However, we have not verified its accuracy and make no guarantee, warranty or representation about it. It is submitted subject to the possibility of errors, omissions, change of price, rental or other conditions, prior sale, lease or financing, or withdrawal without notice. We include projections, opinions, assumptions or estimates for example only, and they may not represent current or future performance of the property. You and your tax and legal advisors should conduct your own investigation of the property and transaction.

VIKTORIA ALKOVA
Commercial Specialist, MiCP
O: 603.610.8500
C: 646.577.1194
viktoria@kwclcg.com
NH #074657

ETHAN ASH
Commercial & Investment Specialist, MiCP
O: 603.610.8500 X1430
C: 603.707.2319
ethan.ash@kw.com
NH #071469

DAVE GARVEY
Managing Director
O: 603.610.8523
C: 603.491.2854
dave@kwclcg.com
NH #004637

LISA ALKOVA
Commercial Specialist
O: 508.308.5617
C:
lisa@kwclcg.com
NH #081274

KELLER WILLIAMS COASTAL REALTY
603.610.8500
750 Lafayette Rd.
Suite 201 - Coastal Land & Commercial Group
Portsmouth, NH 03801

Each Office Independently Owned and Operated kwclcg.com

DEVELOPMENT OPPORTUNITY FOR SALE

PROPOSED SITE PLAN, FLOORPLAN & RENDERING

15-19 Atherton Ave, Nashua, NH 03064



Lower Level

Main Floor

Top Floor



We obtained the information above from sources we believe to be reliable. However, we have not verified its accuracy and make no guarantee, warranty or representation about it. It is submitted subject to the possibility of errors, omissions, change of price, rental or other conditions, prior sale, lease or financing, or withdrawal without notice. We include projections, opinions, assumptions or estimates for example only, and they may not represent current or future performance of the property. You and your tax and legal advisors should conduct your own investigation of the property and transaction.

VIKTORIA ALKOVA
Commercial Specialist, MiCP
O: 603.610.8500
C: 646.577.1194
viktoria@kwclcg.com
NH #074657

ETHAN ASH
Commercial & Investment Specialist, MiCP
O: 603.610.8500 X1430
C: 603.707.2319
ethan.ash@kw.com
NH #071469

DAVE GARVEY
Managing Director
O: 603.610.8523
C: 603.491.2854
dave@kwclcg.com
NH #004637

LISA ALKOVA
Commercial Specialist
O: 508.308.5617
C:
lisa@kwclcg.com
NH #081274





KELLER WILLIAMS COASTAL REALTY
603.610.8500
750 Lafayette Rd.
Suite 201 - Coastal Land & Commercial Group
Portsmouth, NH 03801

Each Office Independently Owned and Operated **kwclcg.com**

COMPARABLE UNITS IN THE AREA

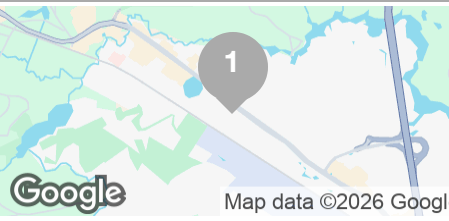
15-19 Atherton Ave, Nashua, NH 03064

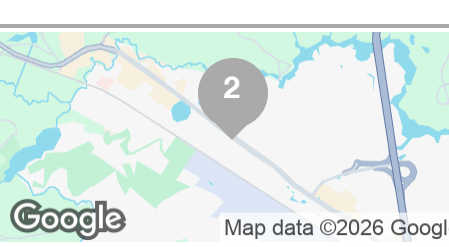

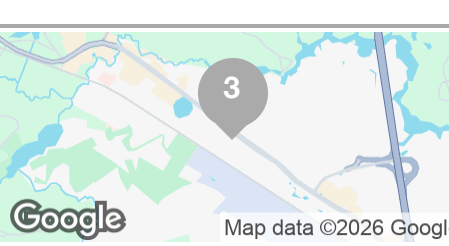
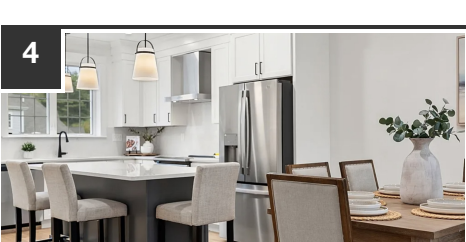
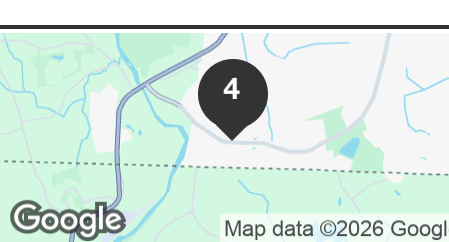
<div>1</div> 	<p>5 DUMAINE AVE, UNIT E Nashua, NH 03063</p> <p>Sold 6/25/2025</p> <p>Price: \$520,272 Bldg Size: 1,321 SF</p>	
<div>2</div> 	<p>7 DEERWOOD DR, UNIT C Nashua, NH 03063</p> <p>Sold 6/11/2025</p> <p>Price: \$502,000 Bldg Size: 1,401 SF</p>	
<div>3</div> 	<p>17 DEERWOOD DR, UNIT E Nashua, NH 03063</p> <p>Sold 9/24/2025</p> <p>Price: \$487,000 Bldg Size: 1,401 SF</p>	
<div>4</div> 	<p>67 GROTON RD, #B Nashua, NH 03062</p> <p>On Market</p> <p>Price: \$694,900 Bldg Size: 2,200 SF</p>	

We obtained the information above from sources we believe to be reliable. However, we have not verified its accuracy and make no guarantee, warranty or representation about it. It is submitted subject to the possibility of errors, omissions, change of price, rental or other conditions, prior sale, lease or financing, or withdrawal without notice. We include projections, opinions, assumptions or estimates for example only, and they may not represent current or future performance of the property. You and your tax and legal advisors should conduct your own investigation of the property and transaction.

VIKTORIA ALKOVA
Commercial Specialist, MiCP
O: 603.610.8500
C: 646.577.1194
viktoria@kwclcg.com
NH #074657

ETHAN ASH
Commercial & Investment Specialist, MiCP
O: 603.610.8500 X1430
C: 603.707.2319
ethan.ash@kw.com
NH #071469

DAVE GARVEY
Managing Director
O: 603.610.8523
C: 603.491.2854
dave@kwclcg.com
NH #004637

LISA ALKOVA
Commercial Specialist
O: 508.308.5617
C:
lisa@kwclcg.com
NH #081274

KELLER WILLIAMS COASTAL REALTY
603.610.8500
750 Lafayette Rd.
Suite 201 - Coastal Land & Commercial Group
Portsmouth, NH 03801



COMPARABLE UNITS IN THE AREA, MAP

15-19 Atherton Ave, Nashua, NH 03064

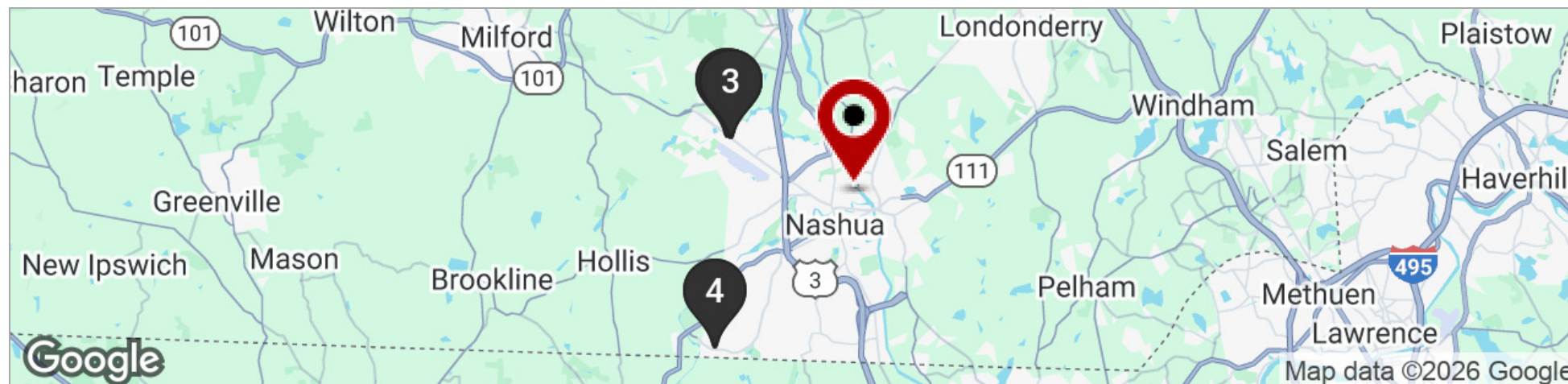

	NAME/ADDRESS	PRICE	LOT SIZE
★	Residential Townhomes 15-19 Atherton Ave Nashua, NH	\$1,450,000	51,601 SF
1	5 Dumaine Ave, Unit E Nashua, NH	\$520,272	-
2	7 Deerwood Dr, Unit C Nashua, NH	\$502,000	-
3	17 Deerwood Dr, Unit E Nashua, NH	\$487,000	-
4	67 Groton Rd, #B Nashua, NH	\$694,900	-
AVERAGES		\$551,043	NAN SF

We obtained the information above from sources we believe to be reliable. However, we have not verified its accuracy and make no guarantee, warranty or representation about it. It is submitted subject to the possibility of errors, omissions, change of price, rental or other conditions, prior sale, lease or financing, or withdrawal without notice. We include projections, opinions, assumptions or estimates for example only, and they may not represent current or future performance of the property. You and your tax and legal advisors should conduct your own investigation of the property and transaction.

VIKTORIA ALKOVA
Commercial Specialist, MiCP
O: 603.610.8500
C: 646.577.1194
viktoria@kwclcg.com
NH #074657

ETHAN ASH
Commercial & Investment Specialist, MiCP
O: 603.610.8500 X1430
C: 603.707.2319
ethan.ash@kw.com
NH #071469

DAVE GARVEY
Managing Director
O: 603.610.8523
C: 603.491.2854
dave@kwclcg.com
NH #004637

LISA ALKOVA
Commercial Specialist
O: 508.308.5617
C:
lisa@kwclcg.com
NH #081274

KELLER WILLIAMS COASTAL REALTY
603.610.8500
750 Lafayette Rd.
Suite 201 - Coastal Land & Commercial Group
Portsmouth, NH 03801

Population Trends

15 Atherton Ave, Nashua, New Hampshire, 03064 2 (5 minutes)

15 Atherton Ave, Nashua, New Hampshire, 03064

Drive time of 5 minutes

Prepared by Esri and Lisa

Latitude: 42.76912

Longitude: -71.45482

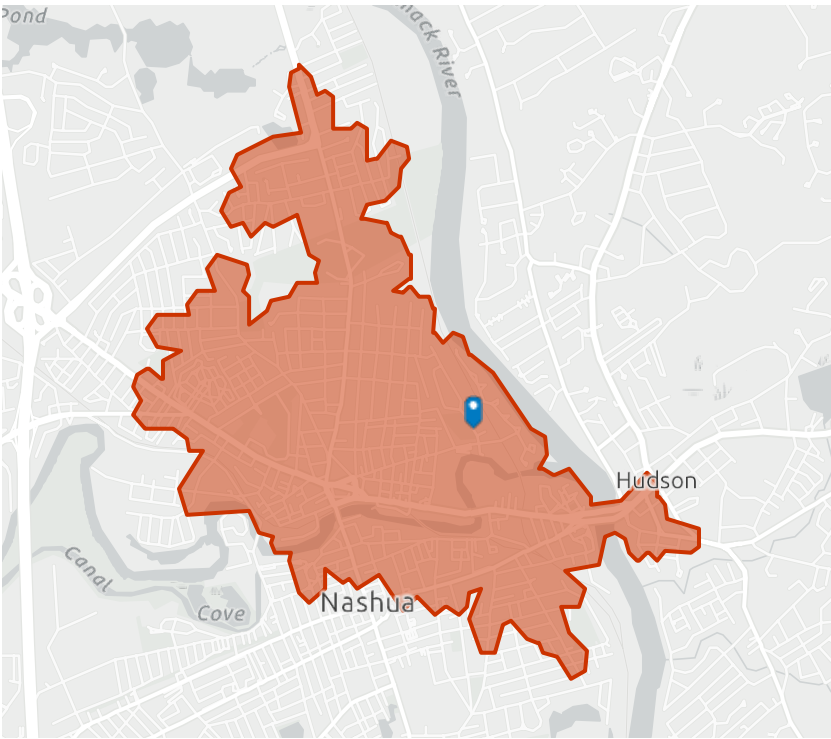

Population Trends and Key Indicators

15 Atherton Ave, Nashua, New Hampshire, 03064 2

Drive time of 5 minutes

14,389	6,500	2.18	38.1	\$73,084	\$454,878	72	54	67
Population	Households	Avg Size Household	Median Age	Median Household Income	Median Home Value	Wealth Index	Housing Affordability	Diversity Index

MORTGAGE INDICATORS

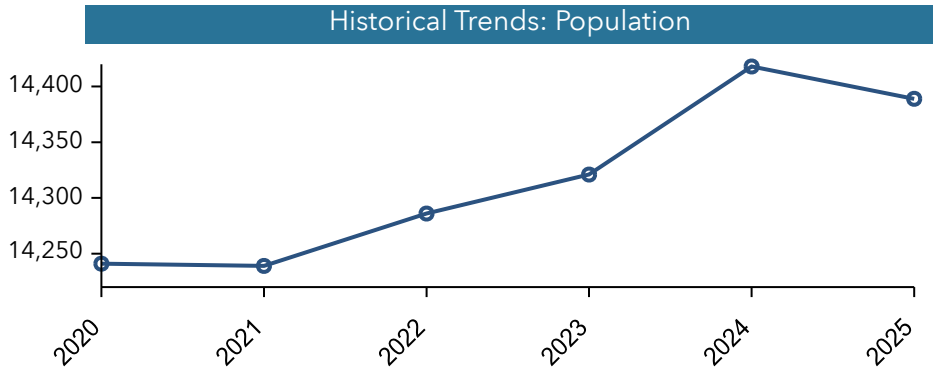

POPULATION BY AGE

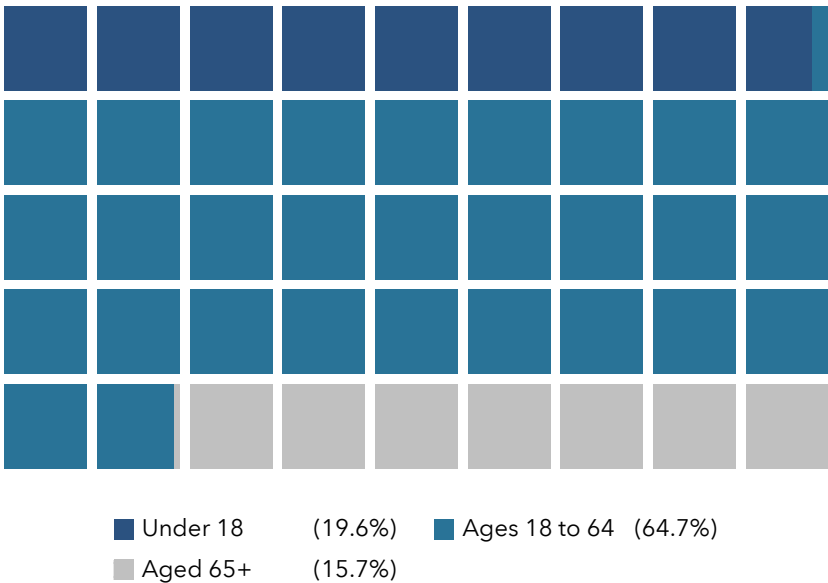

POPULATION BY GENERATION

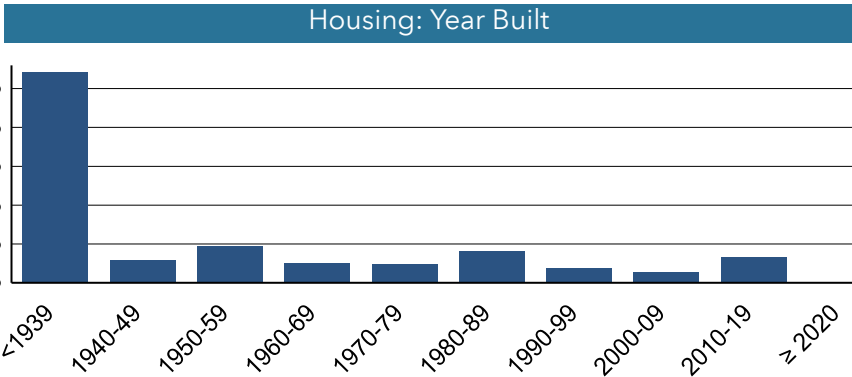
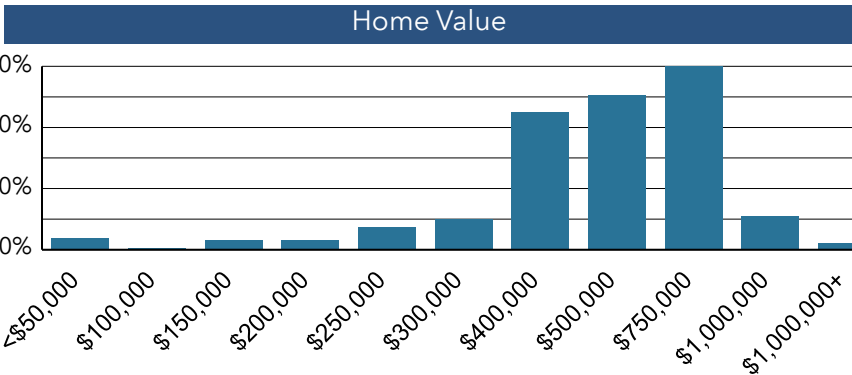
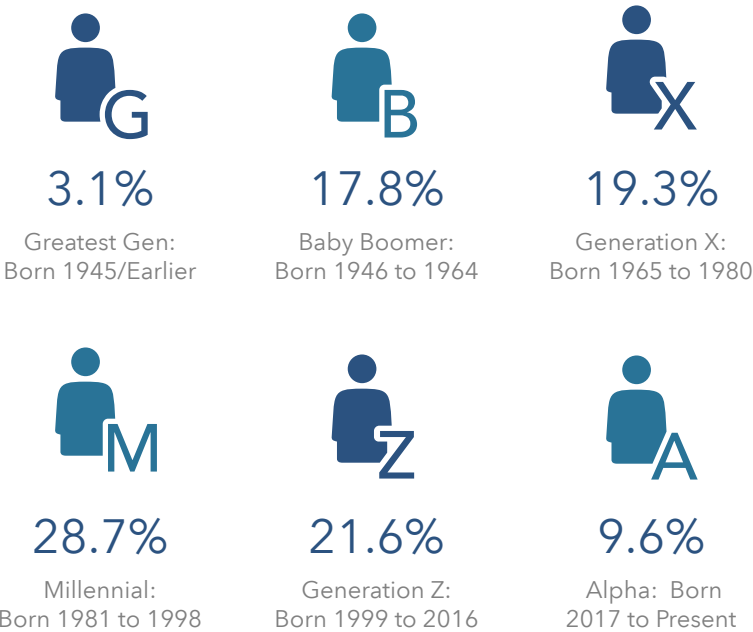

Source: This infographic contains data provided by Esri (2025, 2030), Esri-U.S. BLS (2025), ACS (2019-2023). © 2025 Esri

Commute Profile

15 Atherton Ave, Nashua, New Hampshire, 03064 2 (10 minutes)
15 Atherton Ave, Nashua, New Hampshire, 03064
Drive time of 10 minutes

Prepared by Esri and Lisa
Latitude: 42.76912
Longitude: -71.45482

COMMUTE PROFILE

15 Atherton Ave, Nashua, New Hampshire, 03064 2
Drive time of 10 minutes
This infographic provides information about how population age 16+ travels to work. This data comes from the American Community Survey (ACS) from the US Census Bureau. Read an in-depth analysis on the [ACS documentation page](#).

WORKERS



30,107

ACS Workers Age 16+



73.4%

Drove Alone to Work

TRANSPORTATION TO WORK



1.5%

Took Public Transportation



10.3%

Carpooled



2.0%

Walked to Work



0.1%

Bike to Work

TRAVEL TIME TO WORK

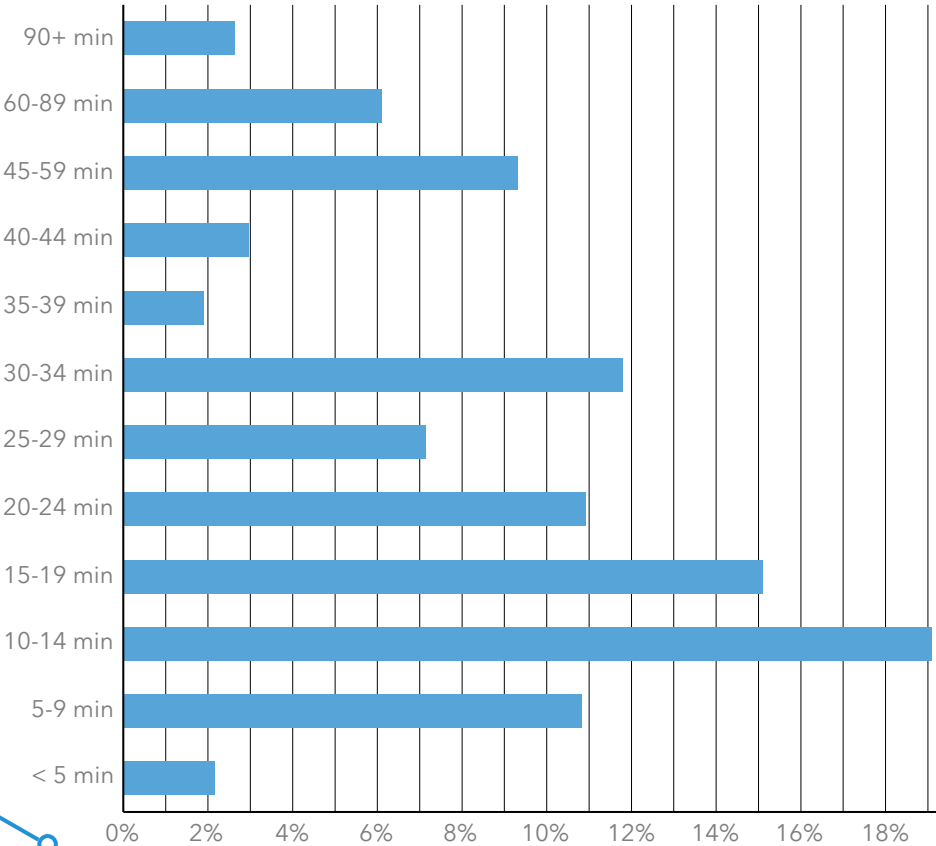

Percent of Workers

What's in My Community?

19 Atherton Ave, Nashua, New Hampshire, 03064 (10 minutes)
19 Atherton Ave, Nashua, New Hampshire, 03064
Drive time of 10 minutes

Prepared by Esri and Lisa
Latitude: 42.76935
Longitude: -71.45503



What's in My Community?

Places that make your life richer and community better

19 Atherton Ave, Nashua, New Hampshire, 03064
10 minutes



This infographic was inspired by the visionary [Plan Melbourne](#) and the hyper proximity 20-minute neighbourhoods concept. Points of interest are grouped into civic themes which contribute to livability and community engagement.

Points of interest are sourced from Foursquare. License information about this content is available in the [data documentation](#). * Indicates the number of locations has reached the maximum. © 2025 Esri