



ARES
INDUSTRIAL
MANAGEMENT

COMPLETION

2 | Q

2 0 2 6

801 S ACACIA AVE

801 SOUTH ACACIA AVENUE, FULLERTON, CA 92831

FOR LEASE | ±185,525 SQ FT | Speculative Class A Warehouse Distribution Facility on ±8.44 AC



SEAN WARD

18575 Jamboree Rd, Ste 600
Irvine, CA, 92612
714-371-9222
sean.ward@cbre.com
Lic. #01415499

BEN SEYBOLD

18575 Jamboree Rd, Ste 600
Irvine, CA, 92612
714-371-9233
ben.seybold@cbre.com
Lic. #01081310

DEVELOPED BY



ARES
INDUSTRIAL
MANAGEMENT

Property FEATURES

- $\pm 185,525$ SF Speculative Class-A, High-Pile Storage, Warehouse Distribution Facility
- $\pm 10,000$ SF Two-Story Office
 - 1st Floor: $\pm 5,000$ SF
 - 2nd Floor: $\pm 5,000$ SF
- 36' Warehouse Clear Height
- 27 Dock-High Doors
- Two (2) Grade-Level Doors
- 4,000 Amps, 277/480v, 3-Phase, 4-Wire
- ESFR Sprinkler System with K-25 Heads
- 185' Concrete Truck Court
- 56' x 50' Bay Spacing (Typical)
- 88 Auto Parking Stalls & 42 Trailer Stalls
- Large Secured & Fenced Yard Area

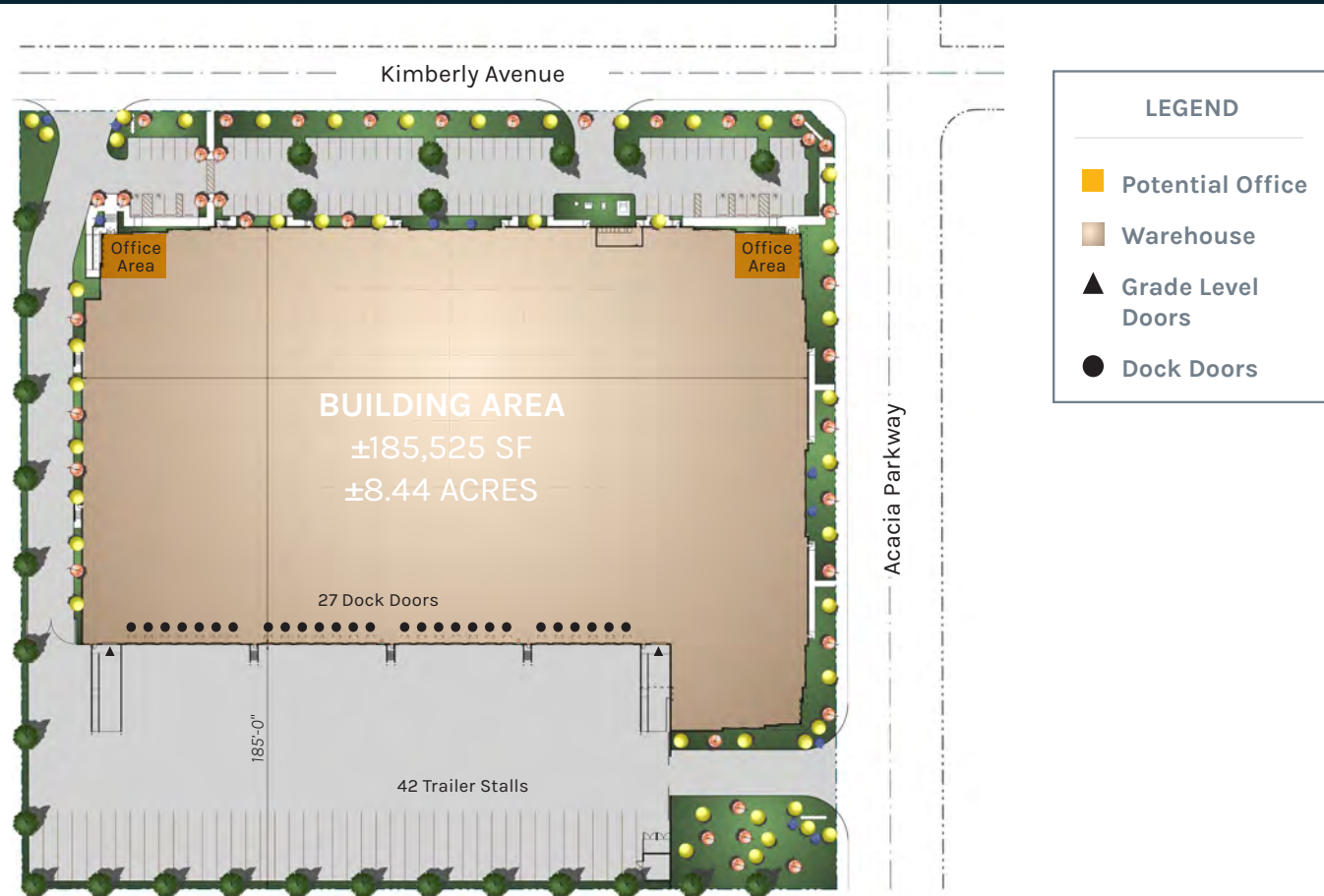

ARES
INDUSTRIAL
MANAGEMENT

Location HIGHLIGHTS

- Prime North Orange County Location
- Less Than 3 Miles of Outstanding Retail & Restaurant Amenities in Downtown Fullerton
- Within 5 Miles of the Brea Mall
- Centrally Located Within 25 Miles of All Major SoCal Markets
- Robust Labor Pool of $\pm 1.93\text{M}$ People Within a 10 Mile Radius
- Close Proximity to Imperial Highway and the 91, 57 and 5 Freeways

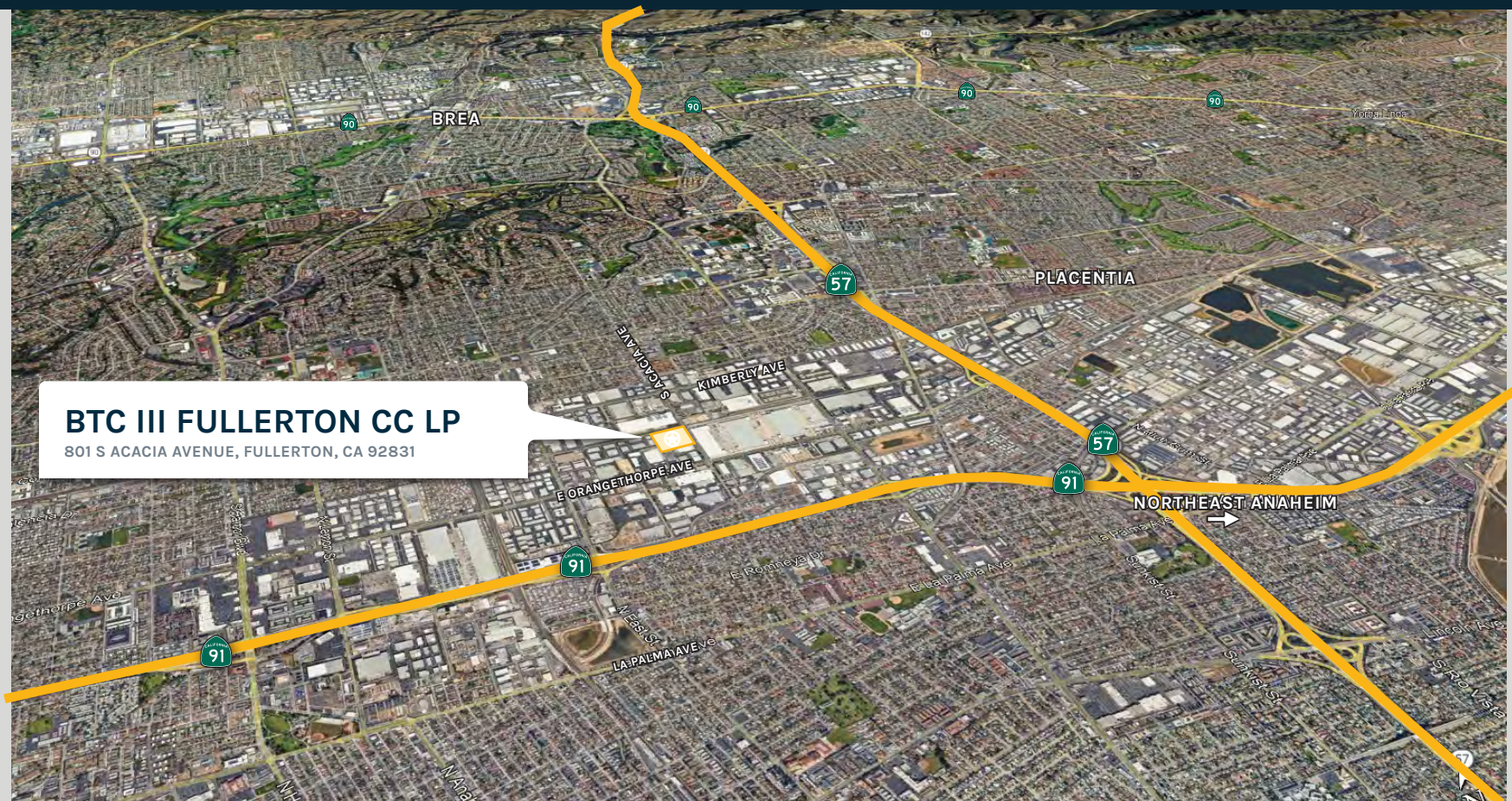

ARES
INDUSTRIAL
MANAGEMENT

Regional MAP

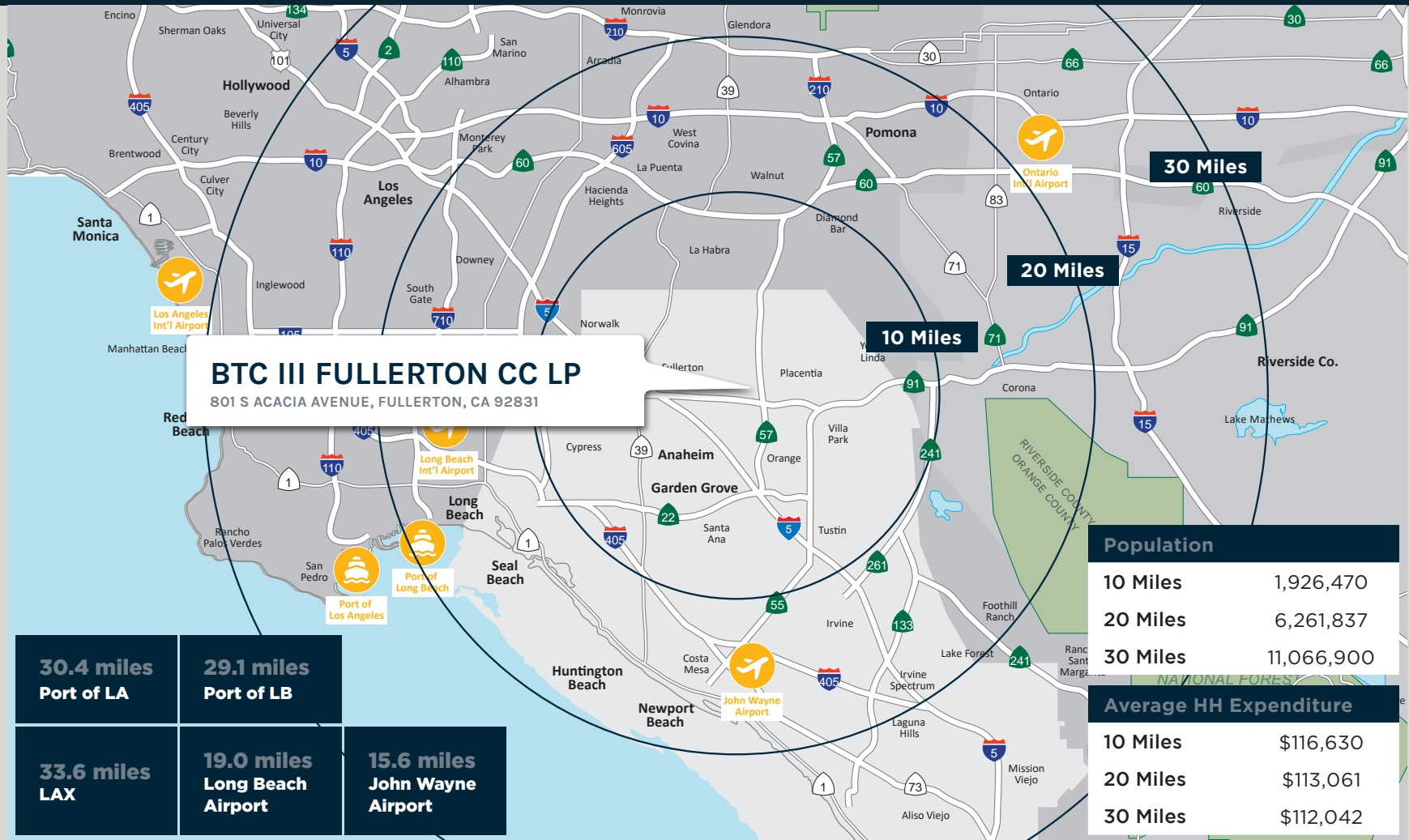

ARES
INDUSTRIAL
MANAGEMENT

ABOUT ARES MANAGEMENT CORPORATION

Ares Management Corporation (NYSE: ARES) is a leading global alternative investment manager offering clients complementary primary and secondary investment solutions across the credit, private equity, real estate and infrastructure asset classes. We seek to provide flexible capital to support businesses and create value for our stakeholders and within our communities. By collaborating across our investment groups, we aim to generate consistent and attractive investment returns throughout market cycles. For more information, please visit www.aresmgmt.com.



SEAN WARD

18575 Jamboree Rd, Ste 600
Irvine, CA, 92612
714-371-9222
sean.ward@cbre.com
Lic. #01415499

BEN SEYBOLD

18575 Jamboree Rd, Ste 600
Irvine, CA, 92612
714-371-9233
ben.seybold@cbre.com
Lic. #01081310



ARES
INDUSTRIAL
MANAGEMENT