

FOR LEASE



## OFFICE/WAREHOUSE SPACE FOR LEASE

1928-1948 W County Road C | Roseville, MN 55113



100 S 5th Street, Suite 2100  
Minneapolis, MN 55042

# OFFICE/WAREHOUSE SPACE FOR LEASE

1928-1948 W County Road C | Roseville, MN 55113



**ONWARD**  
INVESTORS

## BUILDING HIGHLIGHTS:

- Approx. 26,046 total building square feet
- Great access to I-35W via County Road C
- Near many retail shops, hotels and restaurants
- Dock high and grade-level loading doors
- 16' clear height
- Centrally-located between St. Paul and Minneapolis

## AVAILABLE SPACE:

### Suite 1944:

550 SF - Office

2,150 SF - Warehouse

2,700 SF - Total

## LEASE RATE:

Negotiable

## 2024 EST. TAX/CAM:

\$4.48

## LOADING:

One (1) Drive in Door

## SUITE 1944

**2,700 SF**

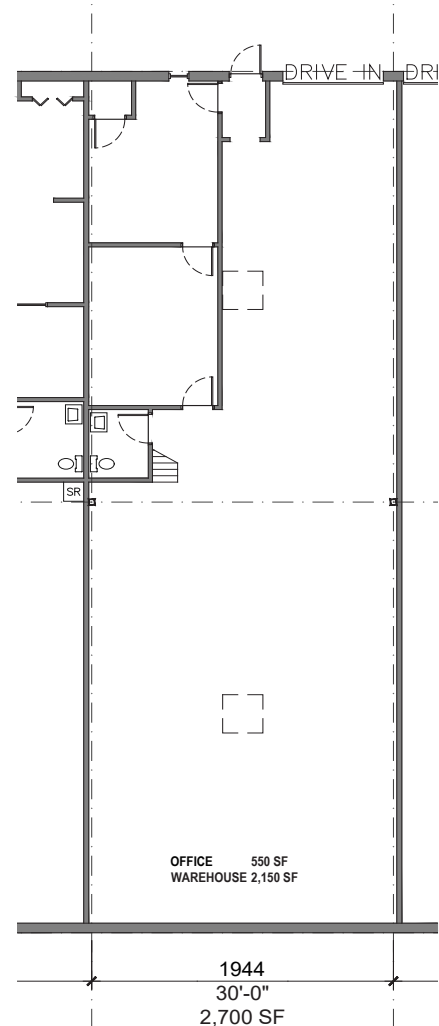

**JAY CHMIELESKI**  
Office: 612.430.9982  
Mobile: 612.275.3772  
[jay.chmielecki@nmrk.com](mailto:jay.chmielecki@nmrk.com)

**DAN FRIEDNER**  
Office: 612.430.9991  
Mobile: 612.599.7864  
[dan.friedner@nmrk.com](mailto:dan.friedner@nmrk.com)

**PATRICK CULLEN**  
Office: 612.430.9995  
Mobile: 651.308.4271  
[patrick.cullen@nmrk.com](mailto:patrick.cullen@nmrk.com)