



**Not Actual Building

For Lease

±12,000 SF industrial warehouse

Site features:

- **Size:** ±12,000 SF (120' x 100') on up to ±2.0 Acres net usable stabilized land
- **Construction Type:** Metallic construction
- **Slab:** 6"
- **Clear Height:** 20'
- **Loading:** Grade level
- **Doors:** Four (4) 12' x 14' overhead doors
- **Power:** 3phase 220v
- 2026 Construction
- Can Be Sprinklered
- Crane Capable
- **Lease Rate:** \$1.00/SF NNN
- **Available Q1 2026**



FM 2854 Business Park 12344 FM 2854 - Building B Conroe, TX 77304

Mark Nicholas, SIOR

+1 713 888 4024

mark.nicholas@jll.com

Will Clay

+1 713 425 1810

will.clay@jll.com

Angela Watford

+1 713 425 1848

angela.watford@jll.com

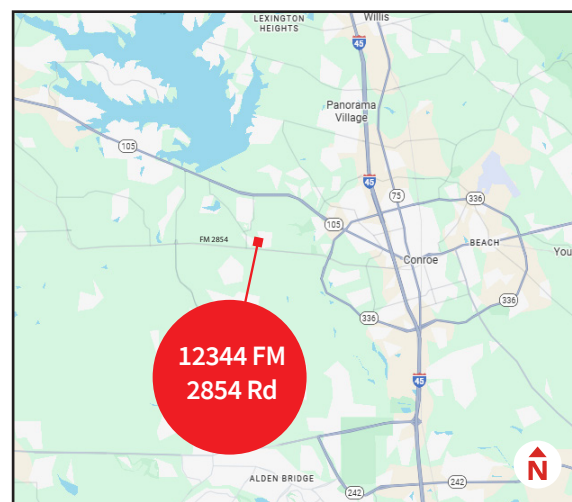

For Lease

±12,000 SF warehouse available for lease

12344 FM 2854 | Conroe, TX 77304



DESTINATION	DISTANCE	APPROXIMATE DRIVE TIME
I-45	±5 miles	9 minutes
Conroe	±5 miles	10 minutes
The Woodlands	±15 miles	17 minutes
Highway 99	±20 miles	22 minutes
Beltway 8	±30 miles	31 minutes
I-610	±40 miles	42 minutes
Dallas	±200 miles	3 hours

Although information has been obtained from sources deemed reliable, JLL does not make any guarantees, warranties or representations, express or implied, as to the completeness or accuracy as to the information contained herein. Any projections, opinions, assumptions or estimates used are for example only. There may be differences between projected and actual results, and those differences may be material. JLL does not accept any liability for any loss or damage suffered by any party resulting from reliance on this information. If the recipient of this information has signed a confidentiality agreement with JLL regarding this matter, this information is subject to the terms of that agreement. ©2024 Jones Lang LaSalle IP, Inc. All rights reserved.



12344 FM 2854 | Conroe, TX 77304

