

Stone River Center

Space Available

Missouri City, Texas

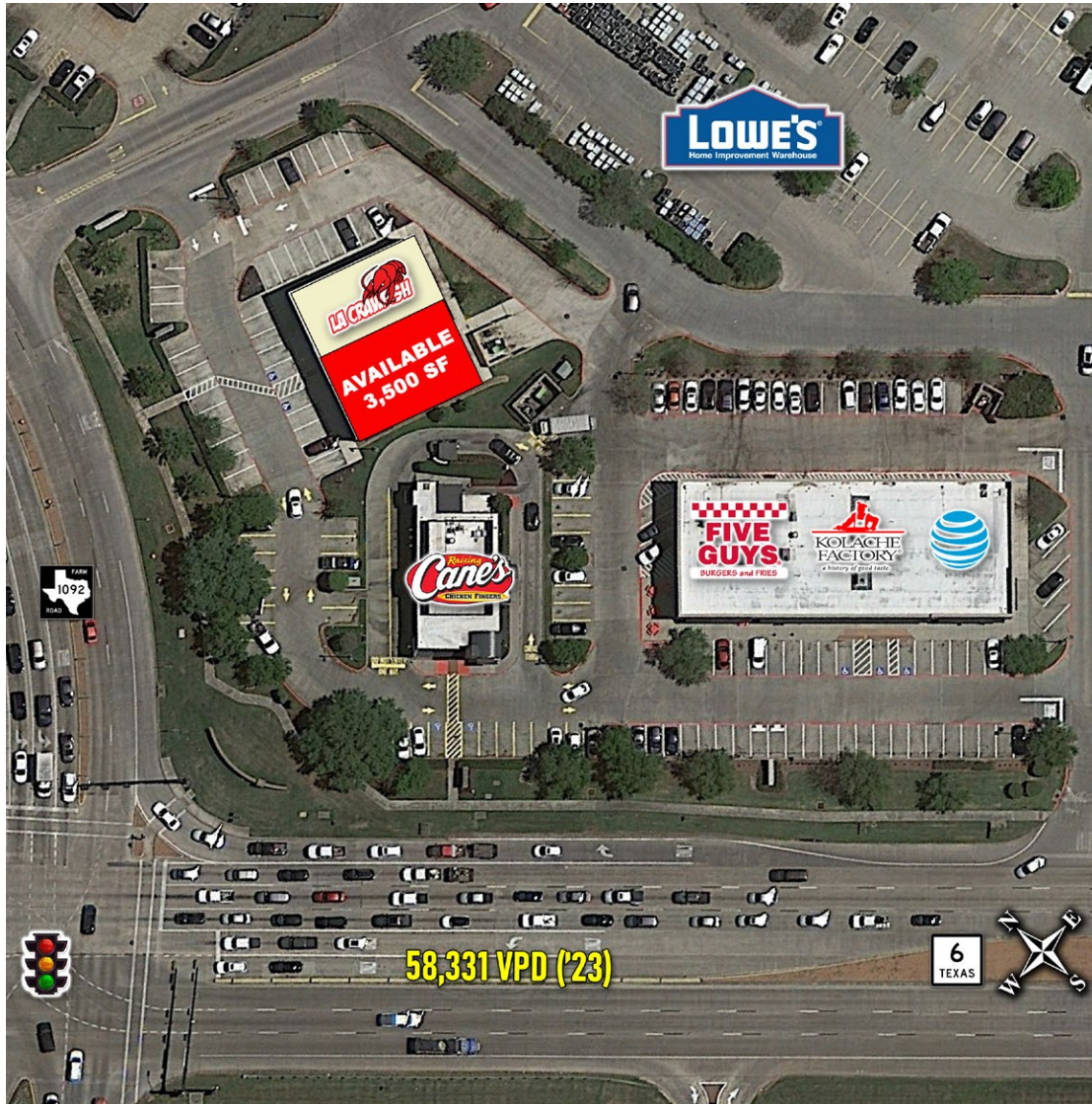

Location:

NEC of Hwy 6 & FM 1092/University
3823 FM 1092, Missouri City, Texas

Details:

- 3,500 SF End Cap Space coming Available (Currently Mattress Firm)
- Anchored by Lowe's Home Improvement
- Adjacent to Raising Cane's
- The shopping center is accessible from Hwy 6, FM 1092 & Glen Lakes Ln
- Area retailers include Kroger, Super Target, Home Depot, Walmart Supercenter, HEB, Kohl's, Ross, Bed Bath and Beyond, PetSmart, Hobby Lobby, Office Depot, Walgreens and many more.
- Call for Pricing

Traffic Counts

Highway 6: 58,331 VPD (TXDOT 2023)

University Blvd: 14,766 VPD (TXDOT 2021)

Demographics

	1 Mile	3 Mile	5 Mile
2024 Population	9,828	101,816	202,115
Avg. HH Income	\$159,493	\$149,796	\$147,288
Daytime Pop.	11,188	80,132	103,217



Lauren Heimann
713-893-3192
lheimann@sdirealty.com

Stone River Center Space Available Missouri City, Texas

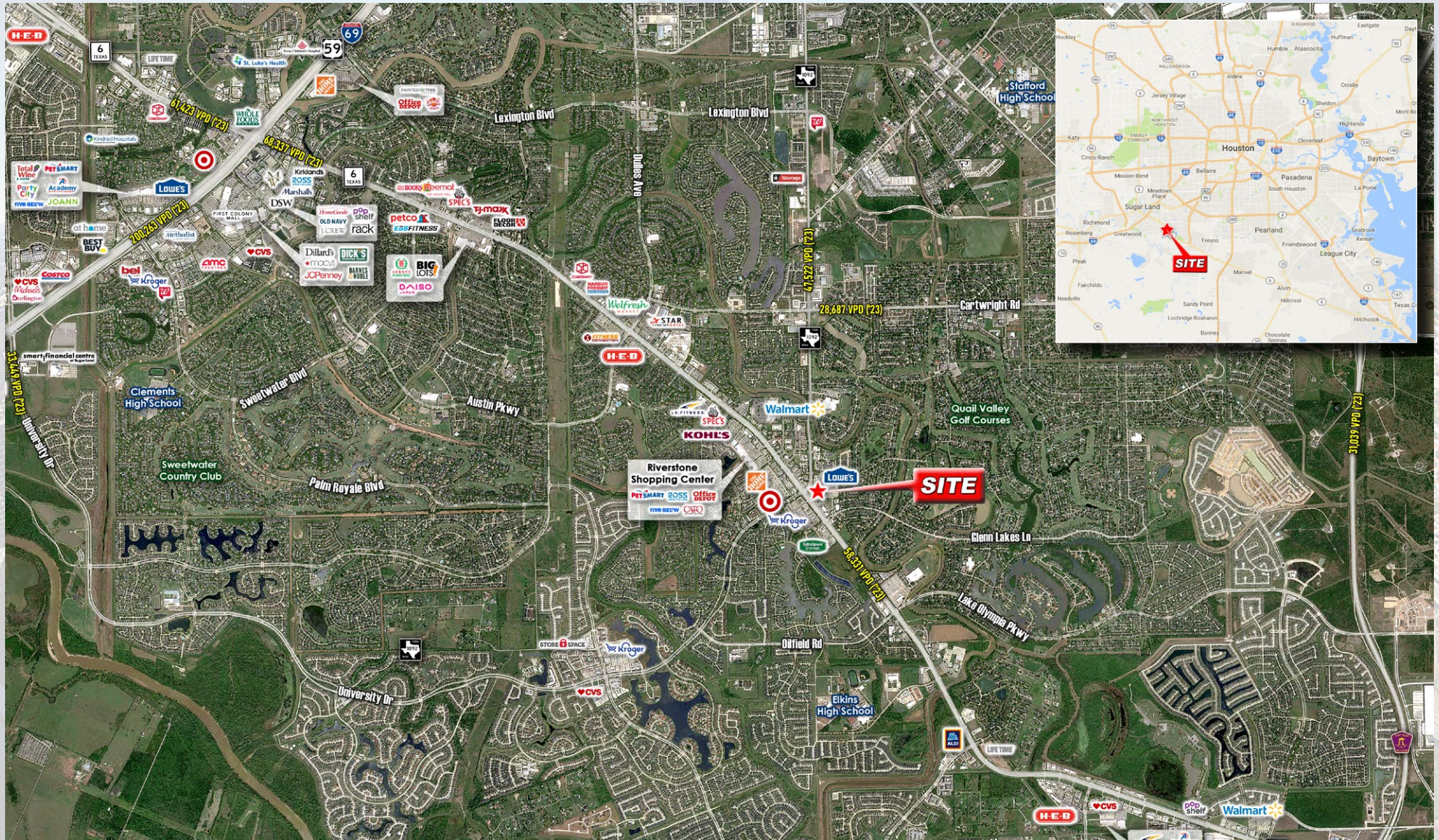

SDI Realty, LLC | 1800 West Loop South, Suite 1850, Houston, TX 77027 | 713.892.5200 | www.sdirealty.com

The information contained herein is deemed reliable; however, SDI Realty, LLC makes no warranties, guarantees or representations as to the accuracy thereof. The presentation of this information is submitted subject to change in conditions and price, corrections, errors, and omissions, and/or withdrawal without notice.



Lauren Heimann
713-893-3192
lheimann@sdirealty.com

Stone River Center Space Available

Missouri City, Texas

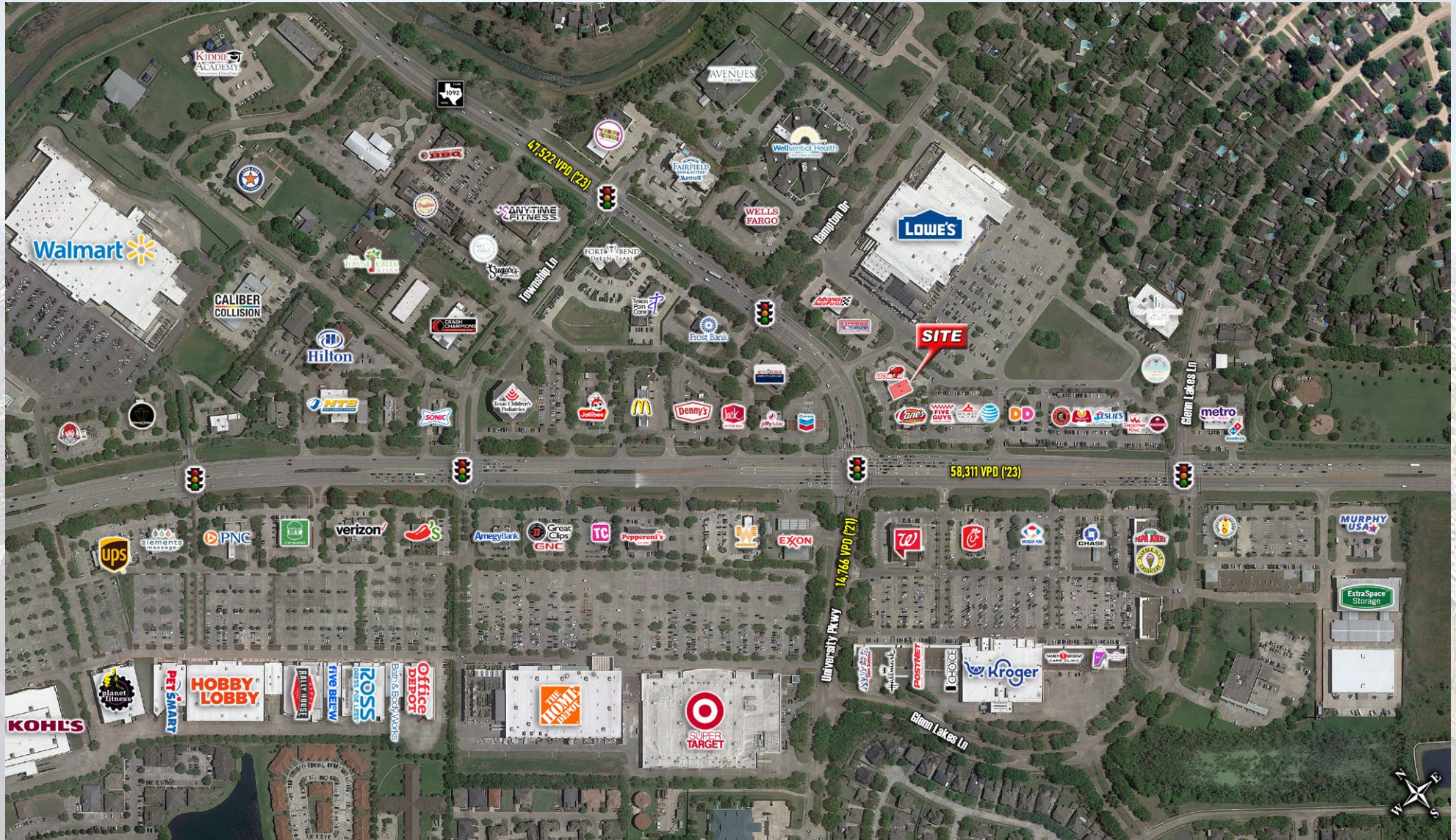

SDI Realty, LLC | 1800 West Loop South, Suite 1850, Houston, TX 77027 | 713.892.5200 | www.sdirealty.com

The information contained herein is deemed reliable; however, SDI Realty, LLC makes no warranties, guarantees or representations as to the accuracy thereof. The presentation of this information is submitted subject to change in conditions and price, corrections, errors, and omissions, and/or withdrawal without notice.