

FOR LEASE | 25,282 SF



WEST OAK BUSINESS CENTER
1801 WEST OAK PKWY, STE B | MARIETTA, GA 30062

PROPERTY OVERVIEW

BUILDING SIZE:	50,564 SF
AVAILABLE SPACE:	25,282 SF
OFFICE:	4,058 SF
CLEAR HEIGHT:	21' - 24'
LOADING:	2 DH Doors 1 DI Door
CONFIGURATION:	Rear Load
BUILDING DEPTH:	200'
SPRINKLER:	Fully Sprinkled
ADDITIONAL NOTES:	<ul style="list-style-type: none">» Interior Warehouse walls painted white» Brick & block construction

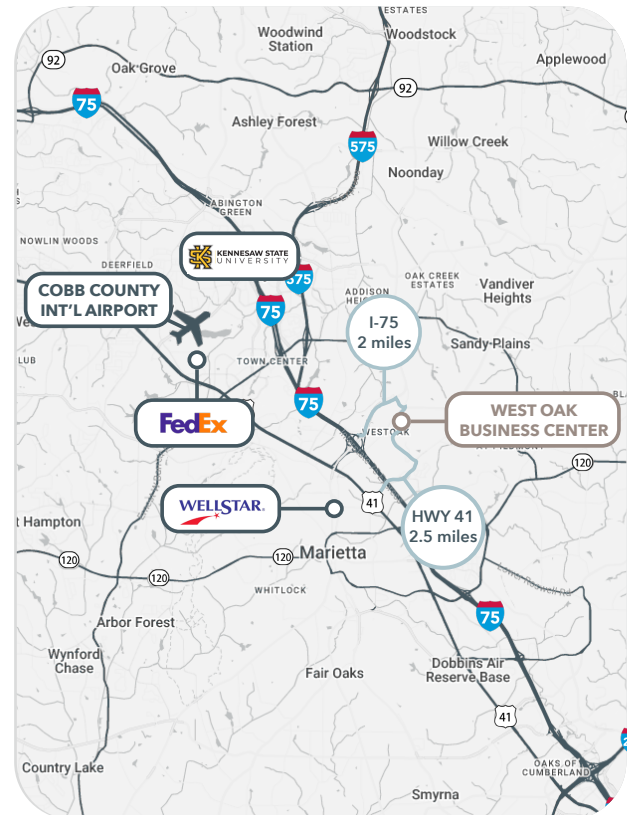

BILLY SNOWDEN, SIOR
Executive VP / Principal
bsnowden@lee-associates.com
O: 404.442.2839

TOMMY HILES, SIOR
Principal
thiles@lee-associates.com
O: 404.442.2847

WILLIE CANDLER
Principal
wcandler@lee-associates.com
O: 404.442.2802

GID
INDUSTRIAL

FOR LEASE

25,282 SF | 1801 WEST OAK PKWY | STE B | MARIETTA, GA 30062

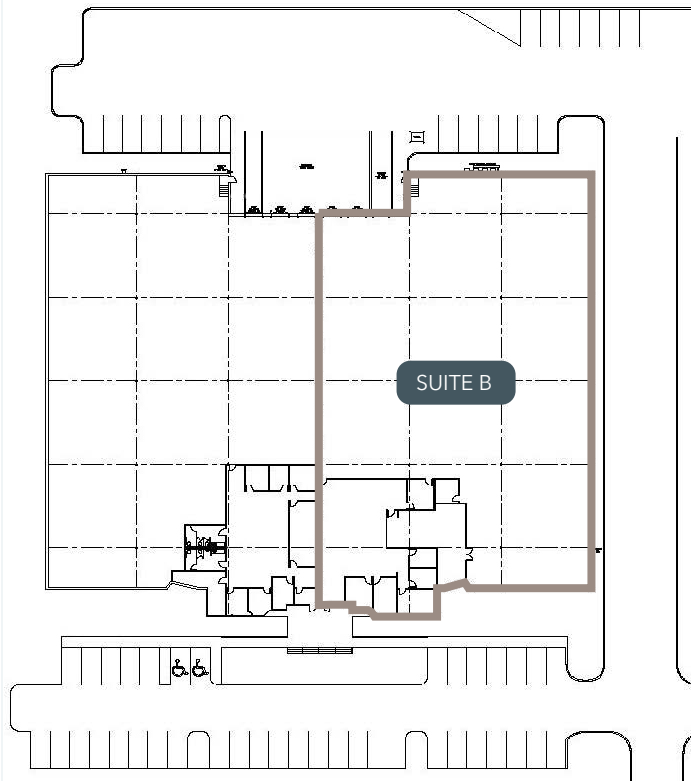

The West Oak Business Center buildings are infill industrial facilities ideal for "Last Mile" tenants looking to serve a large number of rooftops or other businesses in the area. A corporate park setting boasting numerous Fortune 500 neighbors, top notch landscaping, and low traffic counts, West Oak is ideal for image conscious tenants looking to secure quality labor.

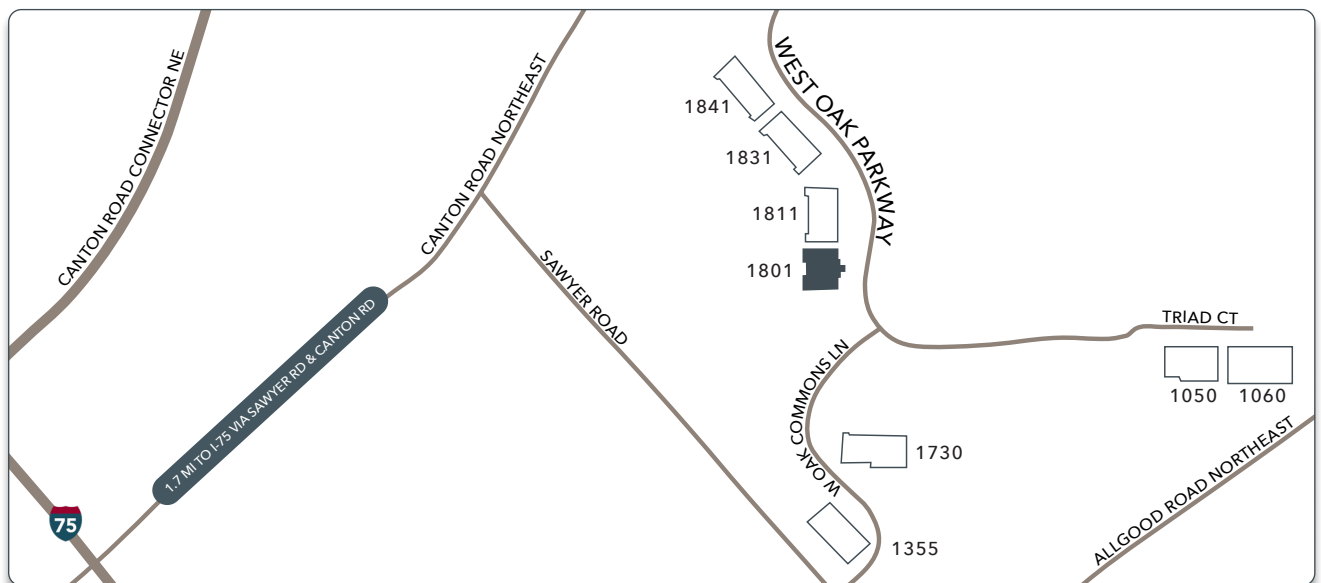

All information furnished regarding property for sale, rental, or financing is from sources deemed reliable, but not warranty or representation is made to the accuracy thereof and same is submitted to errors, omissions, change of price, rental or other conditions prior to sale, lease, or financing or withdrawal without notice. No liability of any kind is to be imposed on the broker herein.



BILLY SNOWDEN, SIOR

Executive VP / Principal

bsnowden@lee-associates.com

O: 404.442.2839

TOMMY HILES, SIOR

Principal

thiles@lee-associates.com

O: 404.442.2847

WILLIE CANDLER

Principal

wcandler@lee-associates.com

O: 404.442.2802

G I D
INDUSTRIAL