



**4281 OLD
DIXIE HWY**
ATLANTA, GA,
GA 30354

FOR LEASE

24,080± SF Office/Warehouse

STEVE RATCHFORD, SIOR, CCIM

Senior Vice President

404.942.2003

sratchford@kingindustrial.com

BRIAN BRATTON, SIOR

Senior Vice President

404.942.2028

bbratton@kingindustrial.com

King Industrial
Realty, Inc.

Industrial • Commercial • Investment

404.942.2000 | kingindustrial.com

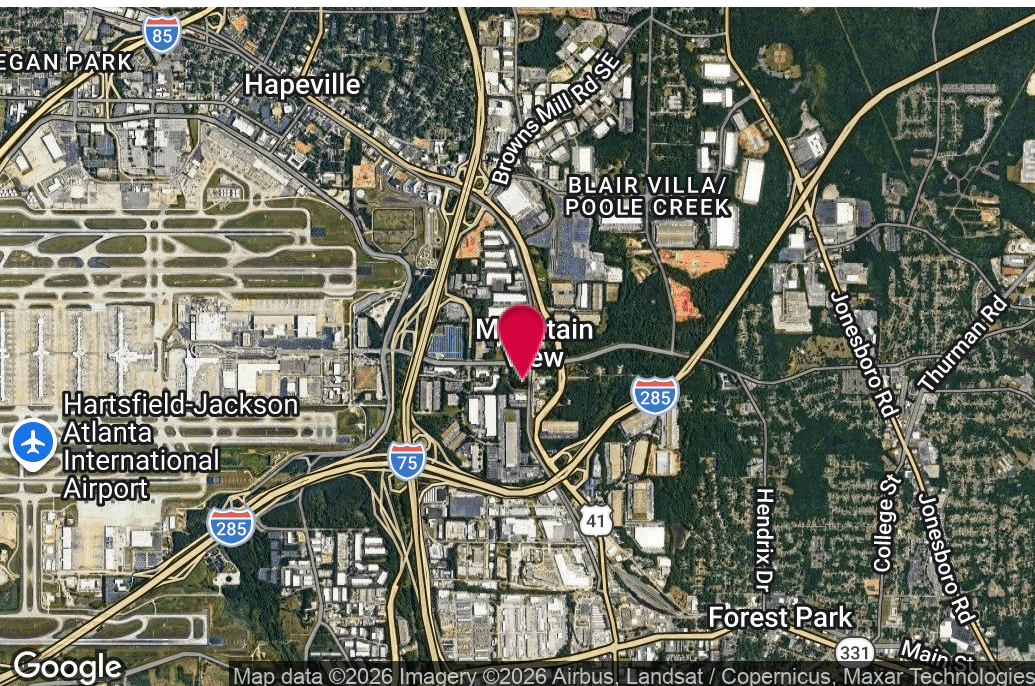

PROPERTY HIGHLIGHTS

- Building A: 24,080± SF
- 3,220± SF Office
- 8 Dock Doors w/Canopy
- Zoned LI
- 10,000± SF to 11,000± SF Office Space can be Leased Separately (see rendering floor plan)
- Double Procurement Fee to Tenant Rep Brokers!

STEVE RATCHFORD, SIOR, CCIM

Senior Vice President

404.942.2003

sratchford@kingindustrial.com

BRIAN BRATTON, SIOR

Senior Vice President

404.942.2028

bbratton@kingindustrial.com

Every effort has been made to provide accurate information, but no liability is assumed for errors or omissions.

King Industrial Realty, Inc.

CORFAC INTERNATIONAL

Industrial • Commercial • Investment
404.942.2000 | kingindustrial.com

BUILDING A



STEVE RATCHFORD, SIOR, CCIM

Senior Vice President

404.942.2003

sratchford@kingindustrial.com

BRIAN BRATTON, SIOR

Senior Vice President

404.942.2028

bbratton@kingindustrial.com

Every effort has been made to provide accurate information, but no liability is assumed for errors or omissions.

King Industrial
Realty, Inc. **CORFAC**
INTERNATIONAL

Industrial • Commercial • Investment
404.942.2000 | kingindustrial.com

BUILDING A INTERIOR PHOTOS



STEVE RATCHFORD, SIOR, CCIM
Senior Vice President
404.942.2003
sratchford@kingindustrial.com

BRIAN BRATTON, SIOR
Senior Vice President
404.942.2028
bbratton@kingindustrial.com

Every effort has been made to provide accurate information, but no liability is assumed for errors or omissions.

King Industrial Realty, Inc. **CORFAC** INTERNATIONAL
Industrial • Commercial • Investment
404.942.2000 | kingindustrial.com

3D RENDERING FLOOR PLAN

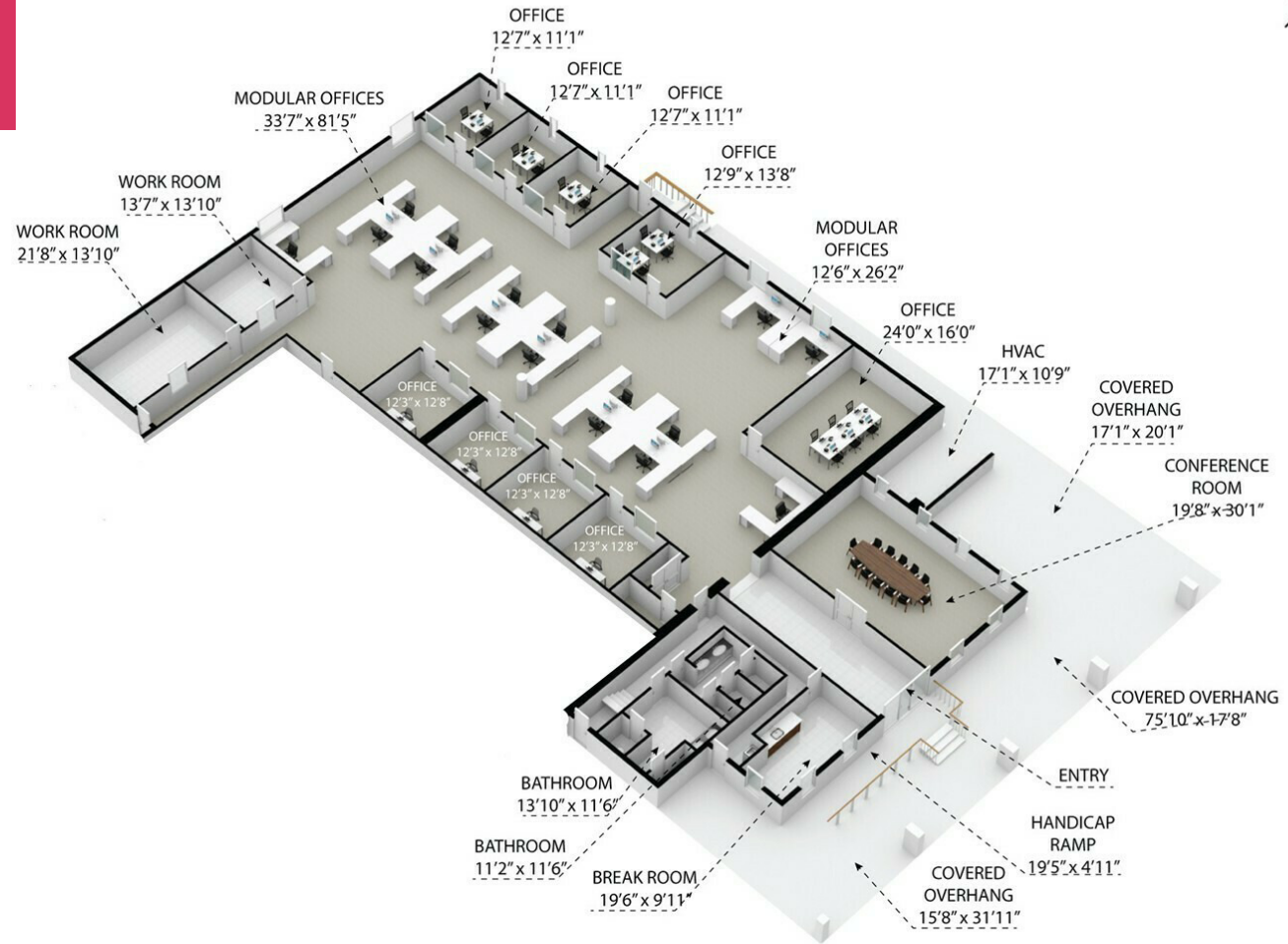

4281 Old Dixie Highway, Atlanta 30354
 TOTAL APPROX. FLOOR AREA 11,609 SQ.FT
 While every attempt has been made to ensure the accuracy of the floor plan contained here, measurements of doors, windows, rooms and any other items are approximate and no responsibility is taken for any error, omission, or misstatement. This plan is for illustrative purposes only and should be used as such by any prospective purchaser.

Atlanta 3D Tours

10,000± SF - 11,000± SF Office Space Can Be Leased Separately

STEVE RATCHFORD, SIOR, CCIM

Senior Vice President

404.942.2003

sratchford@kingindustrial.com

BRIAN BRATTON, SIOR

Senior Vice President

404.942.2028

bbratton@kingindustrial.com

King Industrial
Realty, Inc.

CORFAC
INTERNATIONAL

Industrial • Commercial • Investment
404.942.2000 | kingindustrial.com

Every effort has been made to provide accurate information, but no liability is assumed for errors or omissions.

LOCATION MAP

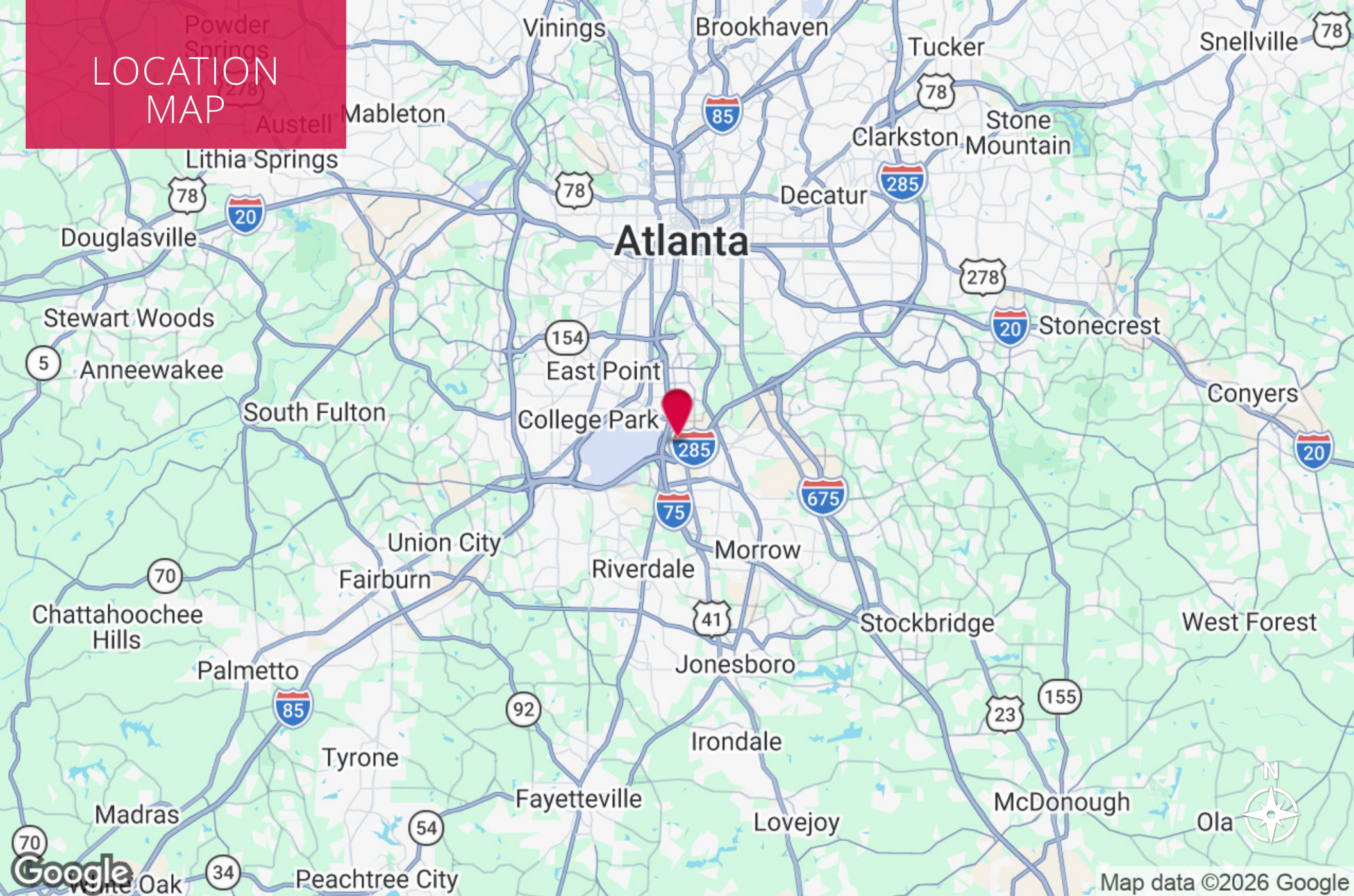

STEVE RATCHFORD, SIOR, CCIM

Senior Vice President

404.942.2003

sratchford@kingindustrial.com

BRIAN BRATTON, SIOR

Senior Vice President

404.942.2028

bbratton@kingindustrial.com



Industrial • Commercial • Investment
404.942.2000 | kingindustrial.com

FOR LEASE
Bldg A
24,080± SF

LEASED
Bldg B

EXCLUSIVELY LISTED BY:

STEVE RATCHFORD, SIOR, CCIM

Senior Vice President
sratchford@kingindustrial.com
404.942.2003

BRIAN BRATTON, SIOR

Senior Vice President
bbratton@kingindustrial.com
404.942.2028

King *Industrial
Realty, Inc.*

Industrial • Commercial • Investment
404.942.2000 | kingindustrial.com