



CANNABIS FACILITY FOR LEASE

2326 E. WASHINGTON STREET

Phoenix, AZ 85034

FOR MORE INFORMATION, CONTACT:

Jeff Hambro
Associate

P: 602.575.2316 | M: 480.540.8996
jhambro@daumcommercial.com
AZDRE #SA670834000



David Valenzuela
P: 480.861.1446
david@frontlineconsulting.net

Although all information is furnished regarding for sale, rental or financing from sources deemed reliable, such information has not been verified and no express representation is made nor is any to be implied as to the accuracy thereof, and it is submitted subject to errors, omissions, changes of price, rental or other conditions, prior sale, lease or financing, or withdrawal without notice.

PROPERTY INFO 2326 EAST WASHINGTON STREET

Industrial Property | ± 4,560 SF

- Newly renovated building suited for the manufacturing, processing, extraction and infusion of cannabis products.
- on site dispensary and cultivation facility
- Seven (7) Suites ranging from ±500 SF - ±1,000 SF
- Medical/Recreational license attached to the building
- Potential for vertical integration
- Looking for experienced tenants who are established in the Arizona cannabis market
- Rental rate shall vary and include a licensing fee

PROPERTY HIGHLIGHTS

EXCLUSIVE LISTING TEAM:

Jeff Hambro
Associate

P: 602.575.2316 | M: 480.540.8996
jhambro@daumcommercial.com
AZDRE #SA670834000

David Valenzuela
P: 480.861.1446

david@frontlineconsulting.net

Although all information is furnished regarding for sale, rental or financing is from sources deemed reliable, such information has not been verified and no express representation is made nor is any to be implied as to the accuracy thereof, and it is submitted subject to errors, omissions, changes of price, rental or other conditions, prior sale, lease or financing, or withdrawal without notice.

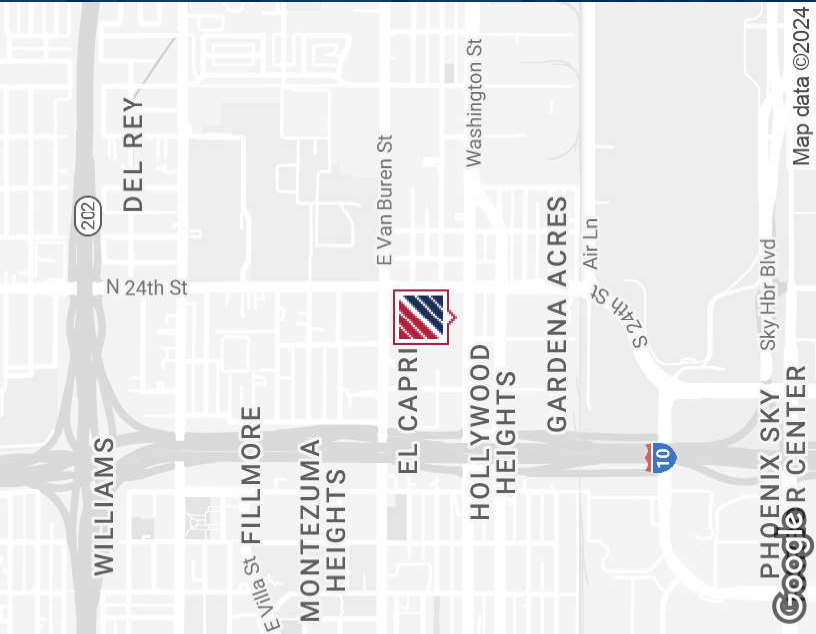
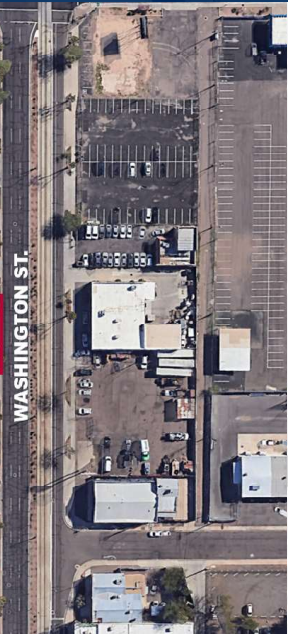

2326 E. WASHINGTON STREET

Industrial Property | ± 4,560 SF

FLOOR PLAN

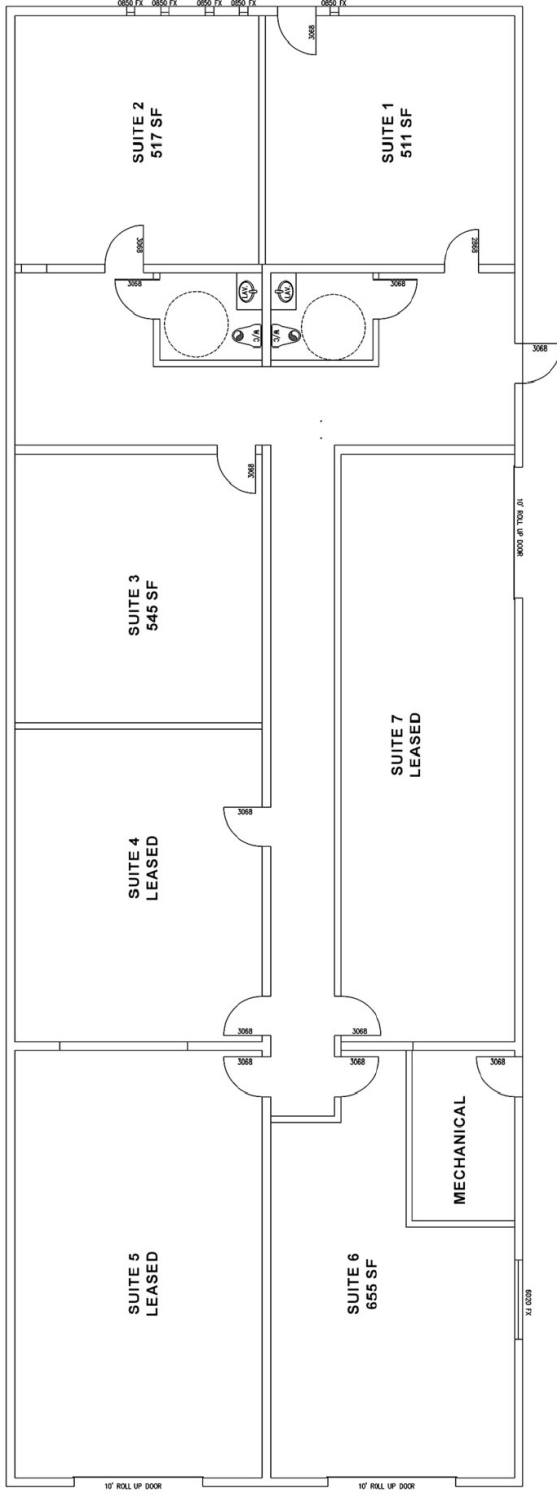

*NOT TO SCALE

EXCLUSIVE LISTING TEAM:

Jeff Hambro
Associate

P: 602.575.2316 | M: 480.540.8996
jhambro@daumcommercial.com
AZDRE #SA670834000

David Valenzuela
P: 480.861.1446
david@frontlineconsulting.net

Although all information is furnished regarding for sale, rental or financing is from sources deemed reliable, such information has not been verified and no express representation is made nor is any to be implied as to the accuracy thereof, and it is submitted subject to errors, omissions, changes of price, rental or other conditions, prior sale, lease or financing, or withdrawal without notice.



2326 E. WASHINGTON STREET

Industrial Property | ± 4,560 SF

Although all information is furnished regarding for sale, rental or financing is from sources deemed reliable, such information has not been verified and no express representation is made nor is any to be implied as to the accuracy thereof, and it is submitted subject to errors, omissions, changes of price, rental or other conditions, prior sale, lease or financing, or withdrawal without notice.



DEMOGRAPHICS

PHOENIX 2024

10,866

PEOPLE

1 MILE

3,297

HOUSEHOLDS

1 MILE

\$28,935

HH INCOME

1 MILE

CONSUMER SPENDING

\$70,344,265

CONSUMER SPENDING

2028



\$63,552,171

CONSUMER SPENDING

2023

PHOENIX 2028

11,024

PEOPLE

3,348

HOUSING UNITS

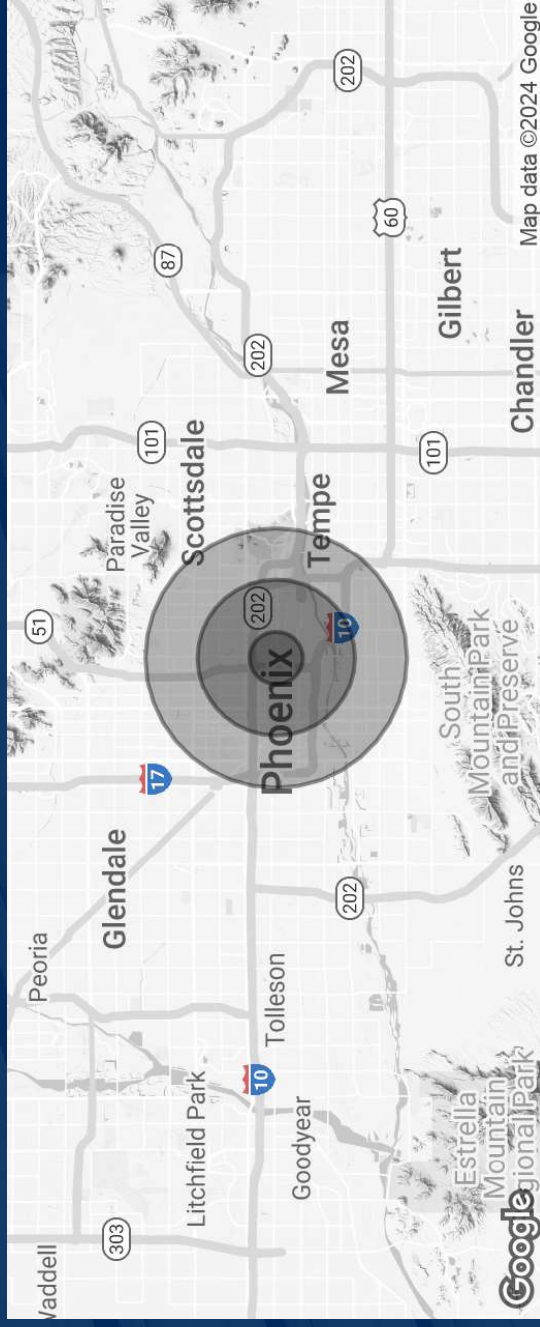

FOR MORE INFORMATION, CONTACT:

Jeff Hambro
Associate

P: 602.575.2316 | M: 480.540.8996
jhambro@daumcommercial.com
AZDRE #SA670834000

David Valenzuela
P: 480.861.1446
david@frontlineconsulting.net

