



# GATEWAY BUSINESS CENTER

## THREE BUILDING INDUSTRIAL PARK

# FOR LEASE

610 & 650 GATEWAY CENTER WAY | 675 GATEWAY CENTER DRIVE  
SAN DIEGO, CALIFORNIA 92102



For Leasing  
Information Contact

**BRYAN TEEL**  
858.369.3074  
bryan.teel@kidder.com

**Kidder  
Mathews**

This information supplied herein is from sources we deem reliable. It is provided without any representation, warranty, or guarantee, expressed or implied as to its accuracy. Prospective Buyer or Tenant should conduct an independent investigation and verification of all matters deemed to be material, including, but not limited to, statements of income and expenses. Consult your attorney, accountant, or other professional advisor.

**KIDDER.COM**

**FOR LEASE | THREE BUILDING INDUSTRIAL PARK**

# Gateway Business Center

610 & 650 GATEWAY CENTER WAY | 675 GATEWAY CENTER DRIVE  
SAN DIEGO, CA 92102



**±16,934 SF**

AVAILABLE SQUARE FOOTAGE  
(DIVISIBLE TO 1,752 SF)

**\$1.35-\$1.50**

LEASE RATE + NNN  
(NNN EST. \$0.275)

**SUITES CAN BE LEASED  
INDIVIDUALLY OR COMBINED**

**EXCELLENT VISIBILITY**

**PREMIER LOCATION WITH QUICK  
ACCESS TO I-15, SR-94, I-5,  
AND I-805**

**GRADE LEVEL DOORS (12'X14')**

**ZONED IL-3-1 CITY OF SAN DIEGO**

## AVAILABILITIES

SUITES A&B	±3,480 SF
SUITES C&D	±3,505 SF
SUITE E	±1,752 SF
SUITE F	±1,752 SF
SUITE G	±1,752 SF
SUITE H&I	±4,693 SF

[KIDDER.COM](http://KIDDER.COM)

This information supplied herein is from sources we deem reliable. It is provided without any representation, warranty, or guarantee, expressed or implied as to its accuracy. Prospective Buyer or Tenant should conduct an independent investigation and verification of all matters deemed to be material, including, but not limited to, statements of income and expenses. Consult your attorney, accountant, or other professional advisor.



## FOR LEASE | THREE BUILDING INDUSTRIAL PARK

# Gateway Business Center

610 & 650 GATEWAY CENTER WAY | 675 GATEWAY CENTER DRIVE  
SAN DIEGO, CA 92102

## Site Plan



KIDDER.COM

This information supplied herein is from sources we deem reliable. It is provided without any representation, warranty, or guarantee, expressed or implied as to its accuracy. Prospective Buyer or Tenant should conduct an independent investigation and verification of all matters deemed to be material, including, but not limited to, statements of income and expenses. Consult your attorney, accountant, or other professional advisor.

# FOR LEASE | THREE BUILDING INDUSTRIAL PARK

## Gateway Business Center

610 & 650 GATEWAY CENTER WAY | 675 GATEWAY CENTER DRIVE  
SAN DIEGO, CA 92102

### Floor Plan | Suites A-I

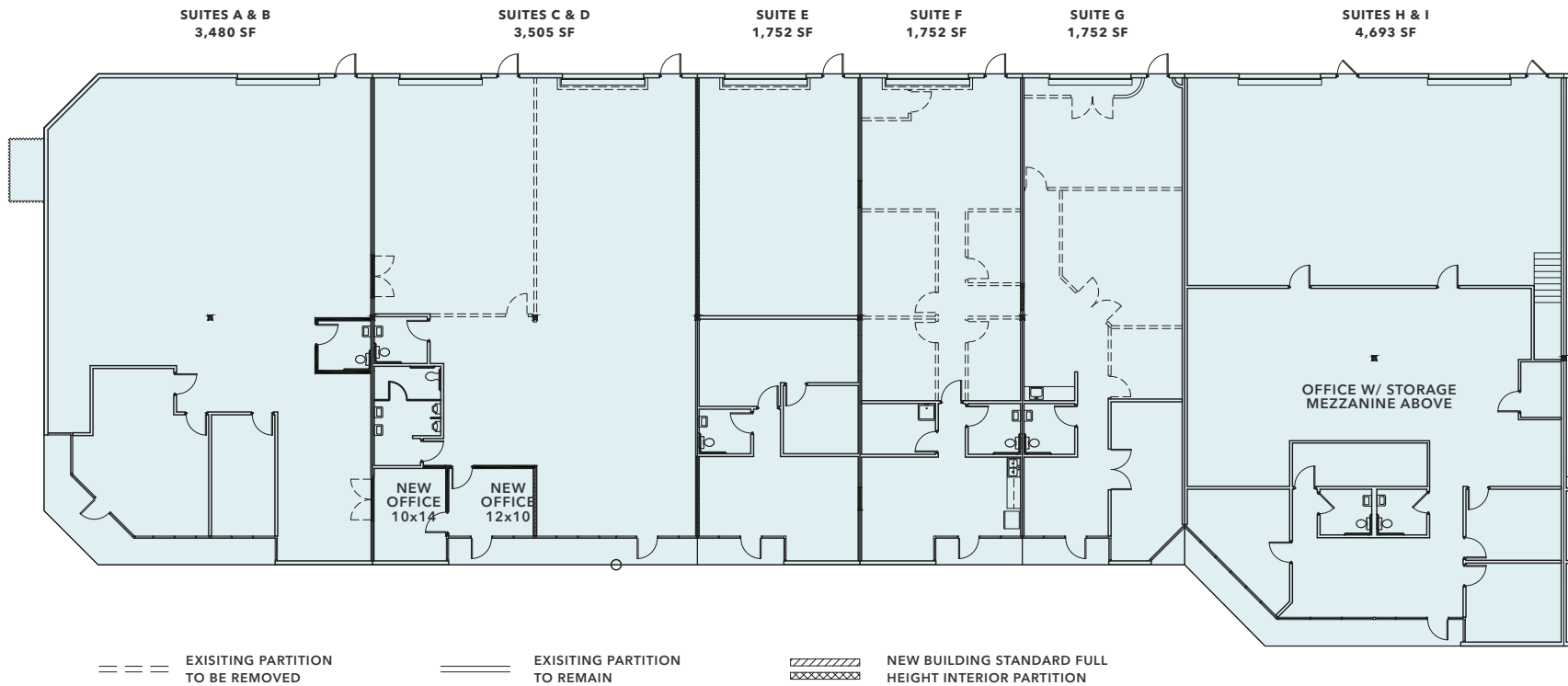

KIDDER.COM

This information supplied herein is from sources we deem reliable. It is provided without any representation, warranty, or guarantee, expressed or implied as to its accuracy. Prospective Buyer or Tenant should conduct an independent investigation and verification of all matters deemed to be material, including, but not limited to, statements of income and expenses. Consult your attorney, accountant, or other professional advisor.



# FOR LEASE | THREE BUILDING INDUSTRIAL PARK

## Gateway Business Center

610 & 650 GATEWAY CENTER WAY | 675 GATEWAY CENTER DRIVE  
SAN DIEGO, CA 92102

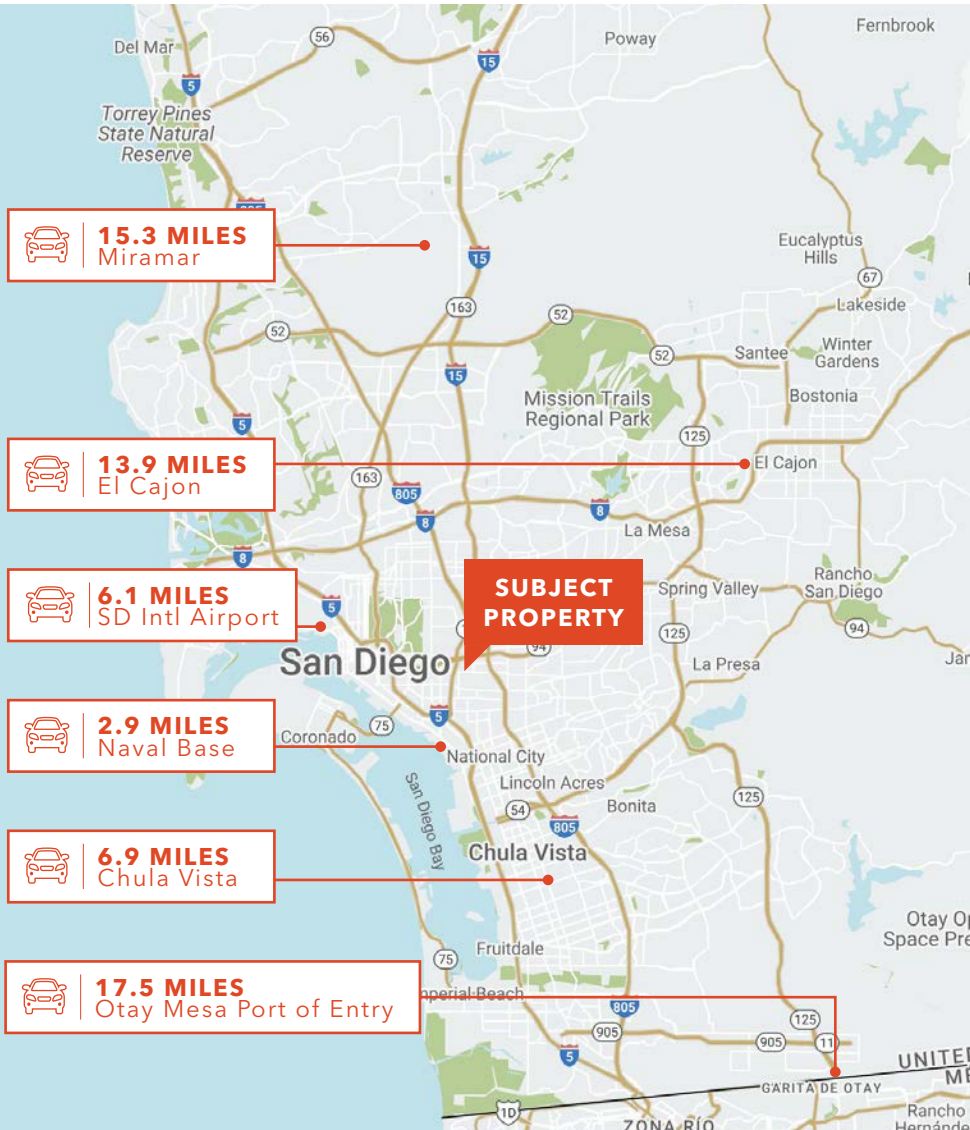

KIDDER.COM

This information supplied herein is from sources we deem reliable. It is provided without any representation, warranty, or guarantee, expressed or implied as to its accuracy. Prospective Buyer or Tenant should conduct an independent investigation and verification of all matters deemed to be material, including, but not limited to, statements of income and expenses. Consult your attorney, accountant, or other professional advisor.

**km** Kidder Mathews

**FOR LEASE | THREE BUILDING INDUSTRIAL PARK**

# Gateway Business Center

610 & 650 GATEWAY CENTER WAY | 675 GATEWAY CENTER DRIVE  
SAN DIEGO, CA 92102

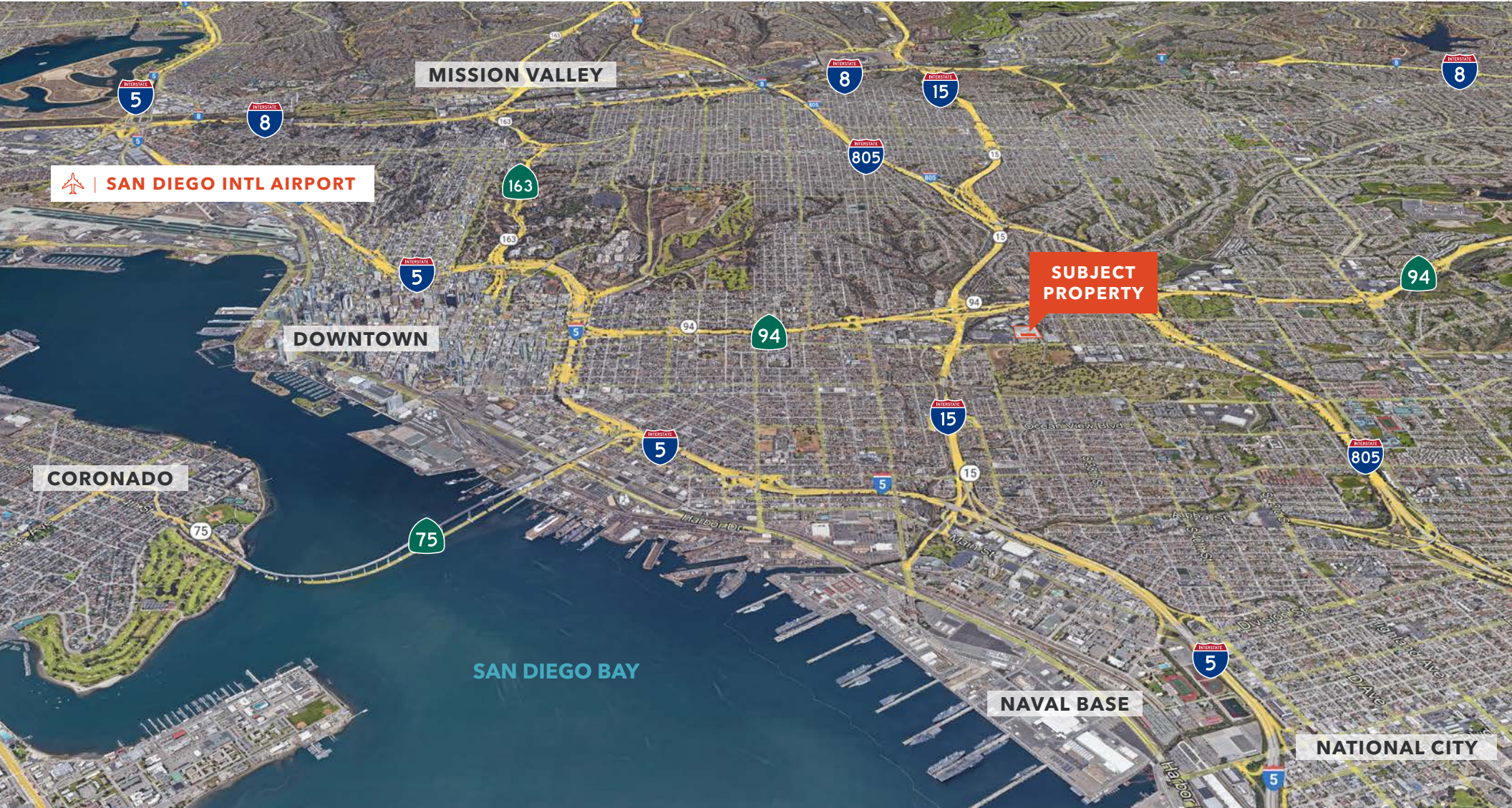

KIDDER.COM

This information supplied herein is from sources we deem reliable. It is provided without any representation, warranty, or guarantee, expressed or implied as to its accuracy. Prospective Buyer or Tenant should conduct an independent investigation and verification of all matters deemed to be material, including, but not limited to, statements of income and expenses. Consult your attorney, accountant, or other professional advisor.

**km** Kidder Mathews

**FOR LEASE | THREE BUILDING INDUSTRIAL PARK**

# Gateway Business Center

610 & 650 GATEWAY CENTER WAY | 675 GATEWAY CENTER DRIVE  
SAN DIEGO, CA 92102

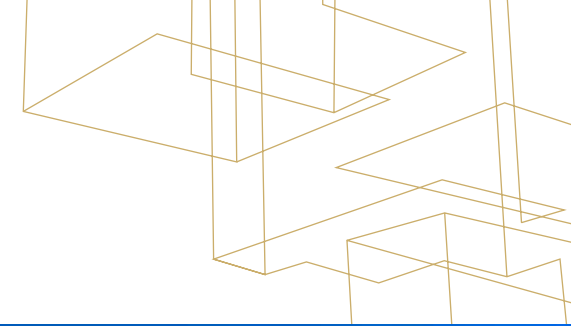

**For Leasing  
Information Contact**

**BRYAN TEEL**  
858.369.3074  
[bryan.teel@kidder.com](mailto:bryan.teel@kidder.com)  
LIC N° 01464788

**KIDDER.COM**

This information supplied herein is from sources we deem reliable. It is provided without any representation, warranty, or guarantee, expressed or implied as to its accuracy. Prospective Buyer or Tenant should conduct an independent investigation and verification of all matters deemed to be material, including, but not limited to, statements of income and expenses. Consult your attorney, accountant, or other professional advisor.



## CONTACT

**BRYAN TEEL**

Vice President

858.369.3074

[bryan.teel@kidder.com](mailto:bryan.teel@kidder.com)

LIC N° 01464788



[KIDDER.COM](http://KIDDER.COM)