

# WILLIAMS CENTER TOWER II - SUBLEASE OPPORTUNITY

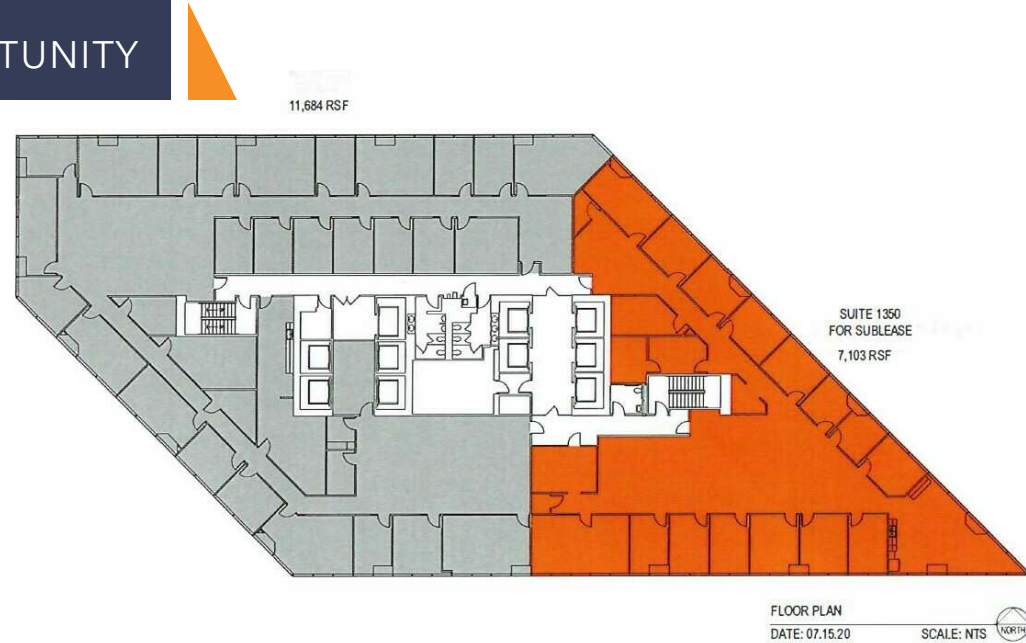
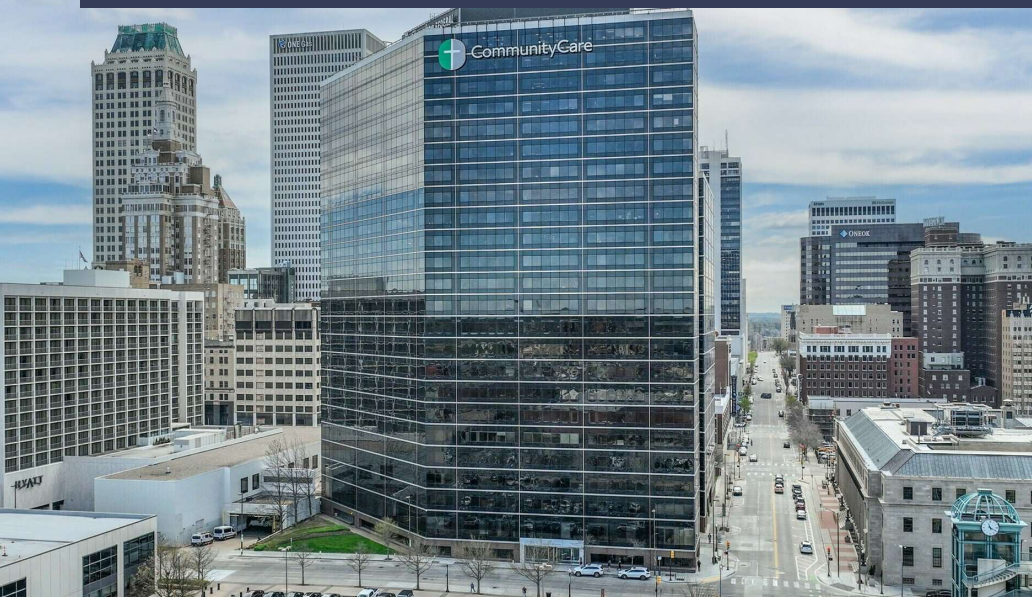

## Property Description

Discover an exceptional sublease opportunity at 2 West 2nd Street, Tulsa, OK. This premier property boasts modern amenities and state-of-the-art facilities designed to elevate your business. With high-speed internet connectivity, furnishings and ample parking options this space is tailored to meet your unique needs. The property's strategic location provides convenient access to downtown businesses, dining, and entertainment, ensuring your team thrives in a dynamic work environment. Elevate your business presence at this sought-after location in the heart of Tulsa.

## Property Highlights

- Reception area, 14 Perimeter offices, large and small conference rooms, kitchen and bullpen area (Furnishings available)
- Large windows with excellent views; Impressive facade and architectural design
- On-site covered parking
- Strategic location providing convenient access to downtown businesses and restaurants

## Offering Summary

LEASE RATE:	\$17.50 SF/yr (Full Service)
NUMBER OF UNITS:	1
AVAILABLE SF:	7,103 SF
BUILDING SIZE:	446,937 SF

Lisa Brandes, RPA  
VICE PRESIDENT  
918.978.6155  
Lisa@legacypadvisors.com

Jessica Reese  
ASSOCIATE  
918.855.3265  
jessica@legacypadvisors.com

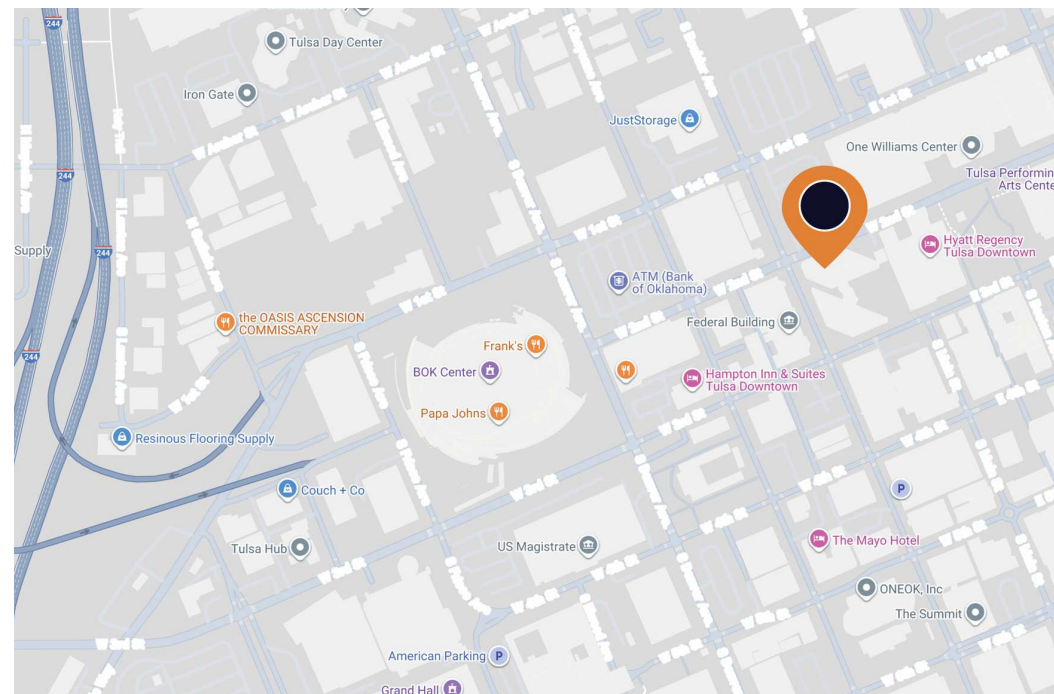



# WILLIAMS CENTER TOWER II - SUBLEASE OPPORTUNITY



Lisa Brandes, RPA  
VICE PRESIDENT  
918.978.6155  
Lisa@legacypadvisors.com

Jessica Reese  
ASSOCIATE  
918.855.3265  
jessica@legacypadvisors.com

