

1311 Leesburg Ave

Medical Office Building in Washington Court House

1311 Leesburg, Ave
Washington Court House, OH 43160

4,136 SF Available



Property Information

- Price: \$1,500,000
- Functioning, new-build Urgent Care
- Freestanding Building
- All equipment including X-ray and furniture available
- Employees can transfer if desired
- Existing patient base



Contact Us

Molly Leach
Senior Voce President
+1 614 332 4792
molly.leach@cbre.com

Paul Tingley
Senior Vice President
+1 614 430 5046
paul.tingley@cbre.com

Austin Knisley
Associate
+1 614 430 5056
austin.knisley@cbre.com

Floor Plan

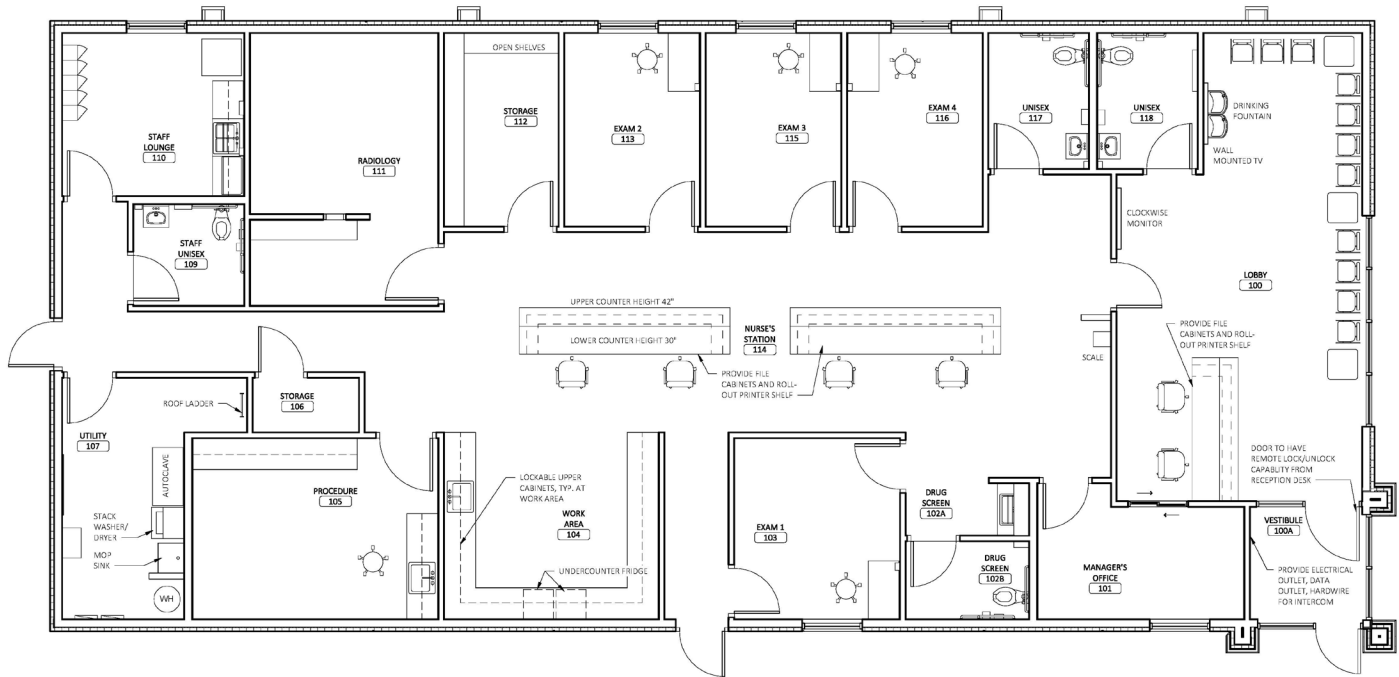

Site Plan

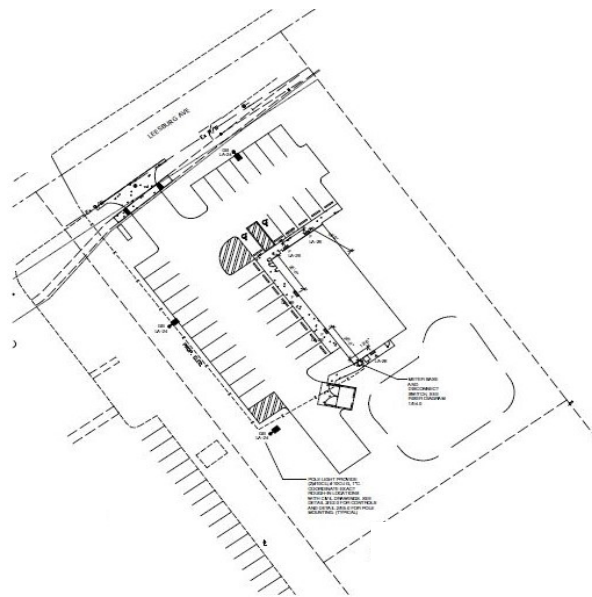

Contact Us

Molly Leach
Senior Voce President
+1 614 332 4792
molly.leach@cbre.com

Paul Tingley
Senior Vice President
+1 614 430 5046
paul.tingley@cbre.com

Austin Knisley
Associate
+1 614 430 5056
austin.knisley@cbre.com

Map

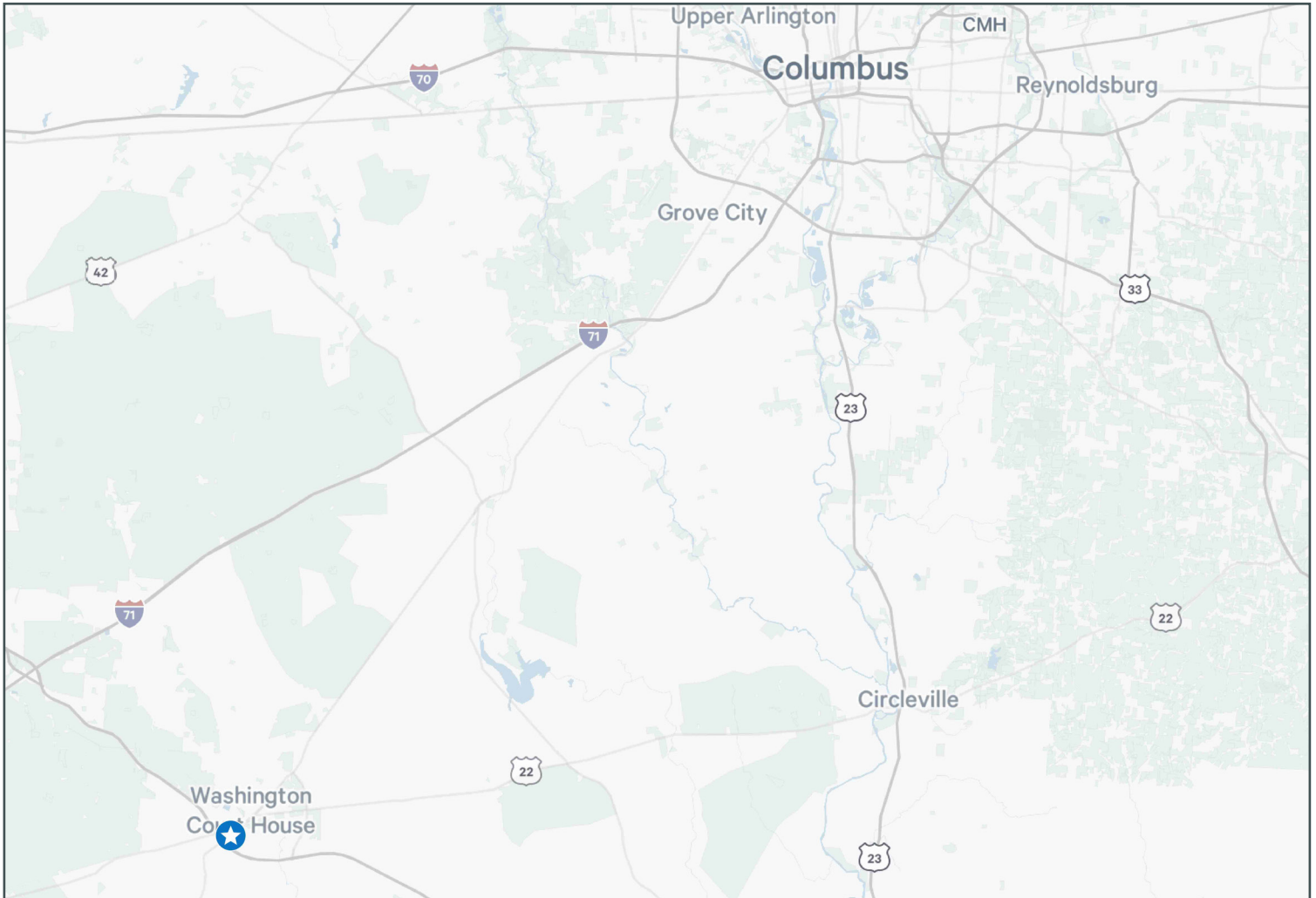

Contact Us

Molly Leach
Senior Voce President
+1 614 332 4792
molly.leach@cbre.com

Paul Tingley
Senior Vice President
+1 614 430 5046
paul.tingley@cbre.com

Austin Knisley
Associate
+1 614 430 5056
austin.knisley@cbre.com

© 2024 CBRE, Inc. All rights reserved. This information has been obtained from sources believed reliable, but has not been verified for accuracy or completeness. You should conduct a careful, independent investigation of the property and verify all information. Any reliance on this information is solely at your own risk. CBRE and the CBRE logo are service marks of CBRE, Inc. All other marks displayed on this document are the property of their respective owners, and the use of such logos does not imply any affiliation with or endorsement of CBRE. Photos herein are the property of their respective owners. Use of these images without the express written consent of the owner is prohibited.