



**TULASI**  
COMMERCE PARK



7715

# NEW DISTRIBUTION CENTER | FOR LEASE

E 76TH ST. N & WHIRLPOOL DR., TULSA, OK 74117

**COLLIER IMGRUND, CCIM**

cimgrund@newmarkrp.com  
C: 214.392.7828

**BRETT PRICE, CCIM, SIOR**

bprice@newmarkrp.com  
C: 405.613.8380





## DETAILS

|                    |                            |
|--------------------|----------------------------|
| Total SF Available | 507,997 SF                 |
| Lease Rate         | Contact Broker             |
| Lot Size           | 44.3 Acres±                |
| Zoning             | Industrial - IM            |
| Market             | Northeast Tulsa Industrial |

## PROPERTY OVERVIEW

Tulasi Commerce Park is a new industrial development located less than 1/2 mile east of Hwy 75 in Tulsa, OK. The property's location allows for quick access to Tulsa's major highways, making the Tulsa International Airport only a 10 minute drive, 15 minute drive to downtown Tulsa, and approximately a 20 minute drive to the Port of Catoosa.

## DRIVE TIME MAP

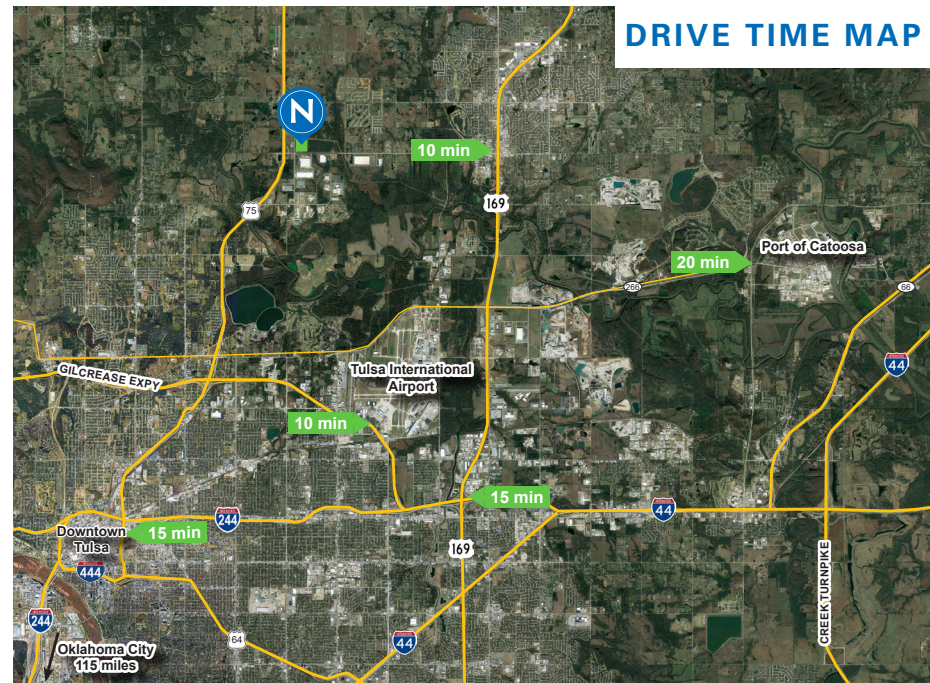

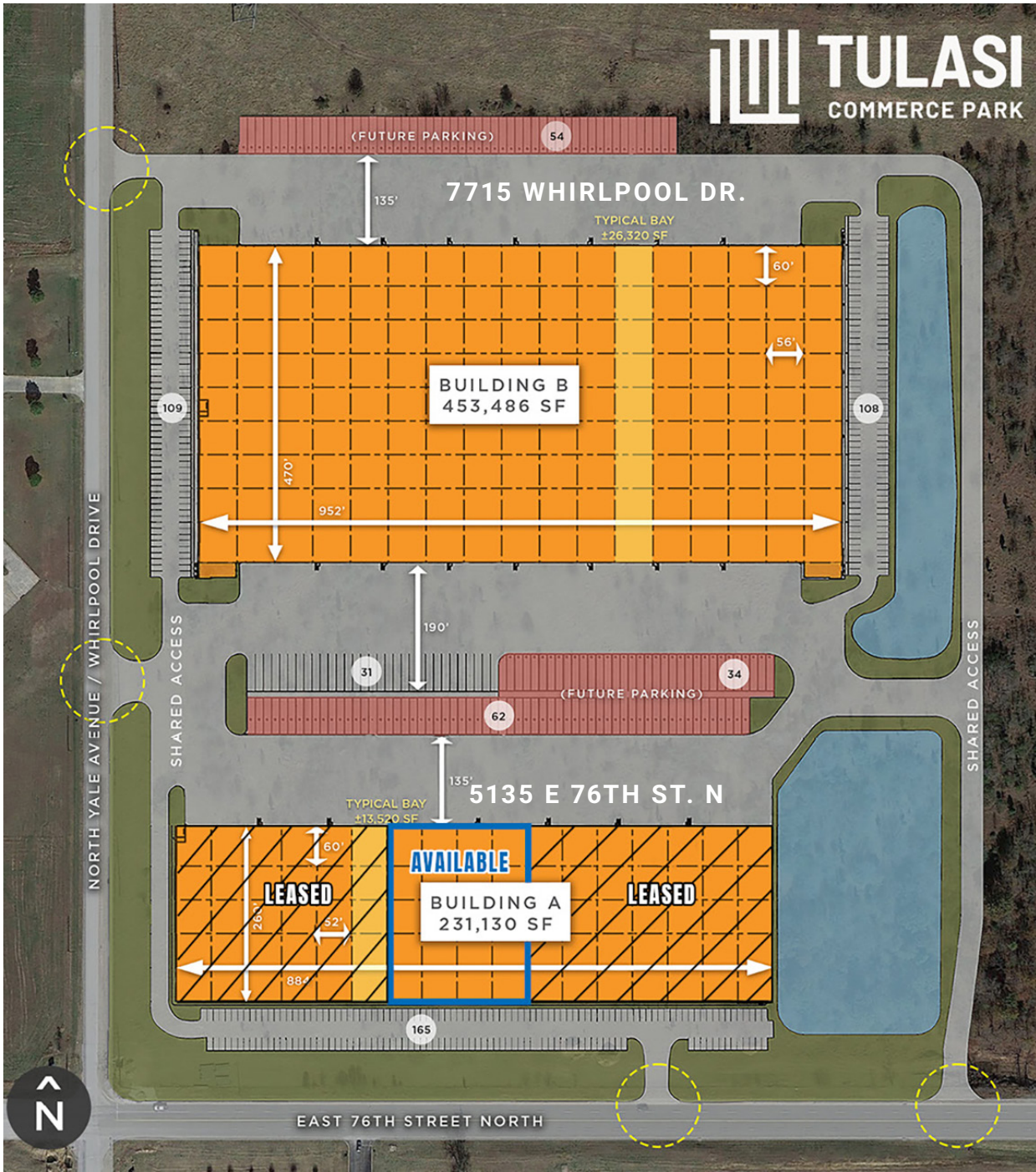

**BUILDING B: 7715 WHIRLPOOL DR.**

|                     |                                       |
|---------------------|---------------------------------------|
| Available SF        | 453,486 SF                            |
| Building Dimensions | 952' x 470'                           |
| Building SF         | 453,486 SF<br>Divisible to 100,000 SF |
| Column Spacing      | 56' x 50'                             |
| Bay Size            | 26,320 SF                             |
| Speed Bay           | 60'                                   |
| Clear Height        | 36'                                   |
| Dock Doors          | 44                                    |
| Drive-in Doors      | 4                                     |
| Truck Court         | 190'                                  |
| Car Parks           | 217                                   |
| Trailer Parking     | 31 (88 future)                        |

**BUILDING A: 5135 E 76TH ST NORTH**

|                     |             |
|---------------------|-------------|
| Available SF        | 54,511 SF   |
| Building Dimensions | 884' x 260' |
| Building SF         | 231,130 SF  |
| Column Spacing      | 52' x 50'   |
| Bay Size            | 13,520 SF   |
| Speed Bay           | 60'         |
| Clear Height        | 32'         |
| Dock Doors          | 4           |
| Drive-in Doors      | 0           |
| Truck Court         | 190'        |
| Car Parks           | 55          |
| Trailer Parking     | 62 future   |



**TULASI**  
COMMERCE PARK



204 N. Robinson, Ste 700 OKC, OK, 73102 | for more information, visit us at  
110 W. 7th, Ste 2600 Tulsa, OK, 74119 | **NEWMARKRP.COM**

The information contained herein was obtained from sources believed reliable; however, Newmark Robinson Park makes no guarantees, warranties or representations as to the completeness or accuracy thereof. The presentation of this property is submitted subject to errors, omissions, change of price or conditions prior to sale or lease, or withdrawal without notice. Independently Owned and Operated.