

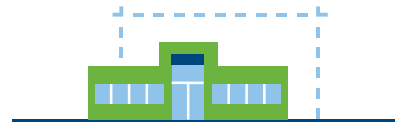

# NORTH SHORE SQUARE

Slidell, Louisiana

North Shore Square is a 621,292 square foot shopping center, located along Interstate 12 and Northshore Boulevard, an intersection containing over 1.7 million square feet of retail. North Shore Square's primary market consists of St. Tammany Parish, Hancock County, Pearl River County, and surrounding municipalities in Louisiana and Mississippi.



UNDER REDEVELOPMENT

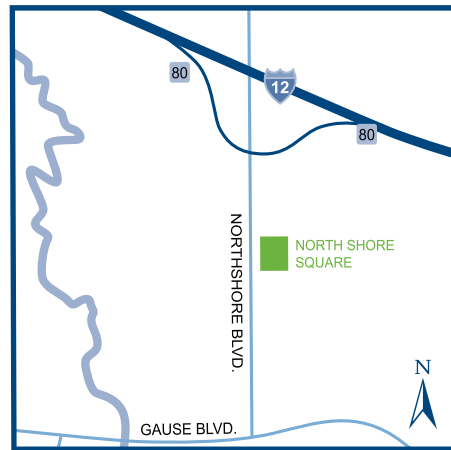

**NORTH SHORE SQUARE**  
 150 Northshore Boulevard  
 Slidell, LA 70460  
 Phone 985-646-0661

## CENTER PROFILE

Total Square Feet	621,292
Number of Stores/Services	5
Number of Levels	1
Number of Parking Spaces	3,140

## MAJOR TENANTS

At Home	97,582 SF
Dillard's	76,954 SF
Conn's HomePlus	48,588 SF

## MARKET DEMOGRAPHICS

<b>3 Mile</b>	Population	20,930
	Number of Households	7,878
	Average Household Income	\$60,745

<b>5 Mile</b>	Population	56,238
	Number of Households	21,651
	Average Household Income	\$69,244

<b>10 Mile</b>	Population	114,829
	Number of Households	44,646
	Average Household Income	\$73,638

<b>Daily Vehicle Count</b>		
I12	67,000	
Northshore Blvd	29,000	

## LEASING INQUIRIES

Morguard Management Company Inc.  
 6305 Airline Drive, Metairie, LA 70003  
 Phone 504-904-8546  
 Amanda Punch Apunch@morguard.com  
[morguard.com](http://morguard.com)



Real Estate Potential. Realized.

## NORTH SHORE SQUARE

### TENANT LIST

#### ANCHORS

At Home	1000
Conn's HomePlus	5000A
Dillard's	3000

#### RESTAURANT/FOOD

Cane's	
Olive Garden	OP B2

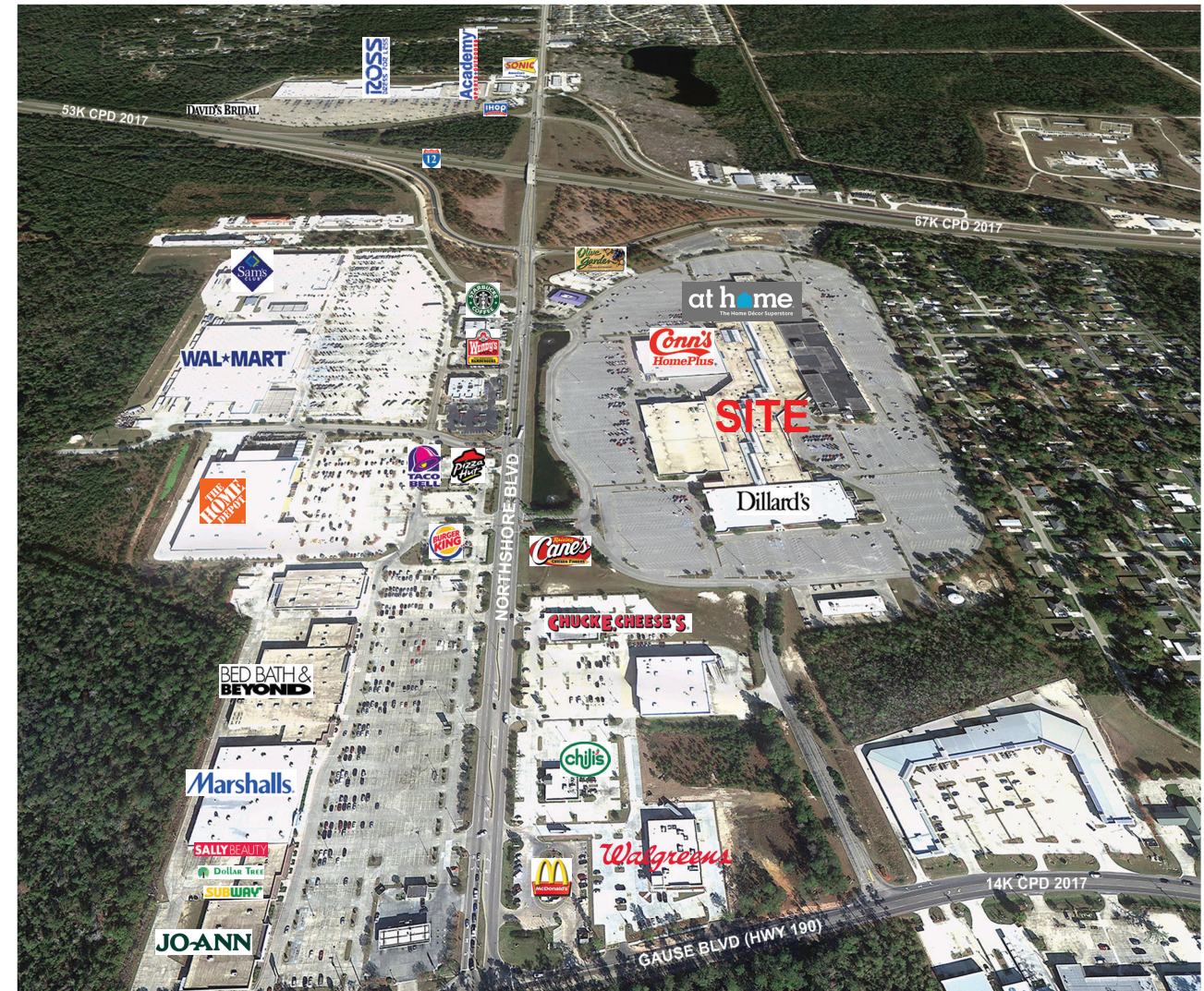



# NORTH SHORE SQUARE

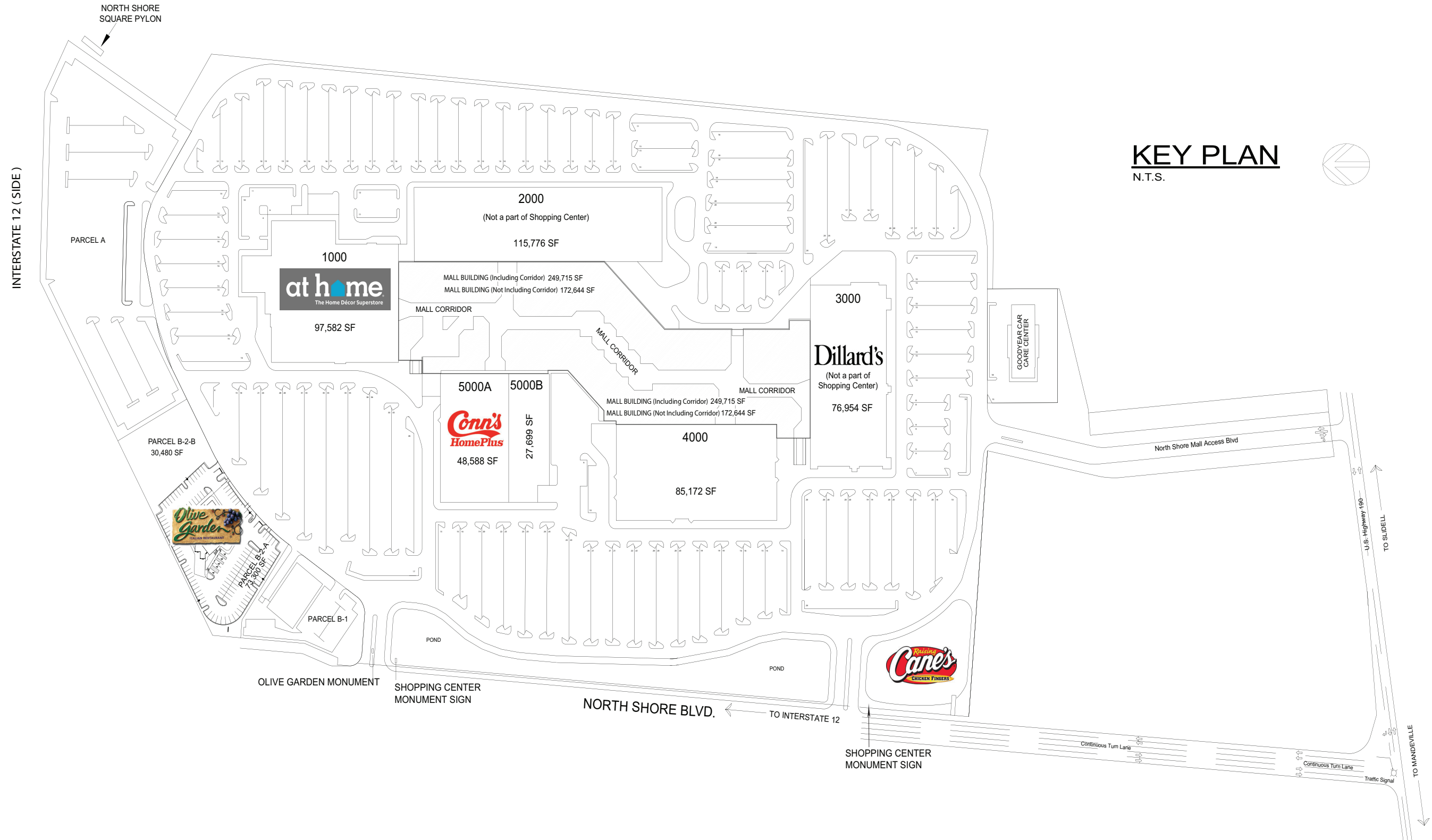



# NORTH SHORE SQUARE

