

# FOR SALE: OFFICE CONDO ON 20<sup>TH</sup> STREET

300 20<sup>th</sup> Street North, Birmingham, AL 35203



**PHILIP CURRIE, CCIM, SIOR**  
205.313.4369  
pcurrie@jhberr.com

**GRACE ADAMS, MBA**  
205.313.4350  
grace@jhberr.com

**JAKE TAYLOR**  
205.313.  
jtaylor@jhberr.com

**JH  
BERRY**  
Commercial Real Estate

# 300 20<sup>th</sup> Street N

Birmingham, AL 35203

FOR SALE: BRICK AND BEAM OFFICE CONDO

## / Property Features

- 4,900 SF Office Condo For Sale in the Blach's building

---

- Prominently located on the corner of 20th Street

---

- Brick and Beam aesthetics

---

- Walkable to ample amenities including: Helen, Brick and Tin, Paramount, Chick-fil-a, Trattoria Zaza

---

- Convenient to corner parking lot on 20th Street and 4th Avenue (Approximately \$125/space)

---



**SALE PRICE:**

**\$975,000**

**PHILIP CURRIE, CCIM, SIOR**  
205.313.4369  
pcurrie@jhberr.com

**GRACE ADAMS, MBA**  
205.313.4350  
grace@jhberr.com

**JAKE TAYLOR**  
205.313.  
jtaylor@jhberr.com

# 300 20<sup>th</sup> Street N

Birmingham, AL 35203

## FOR SALE: BRICK AND BEAM OFFICE CONDO

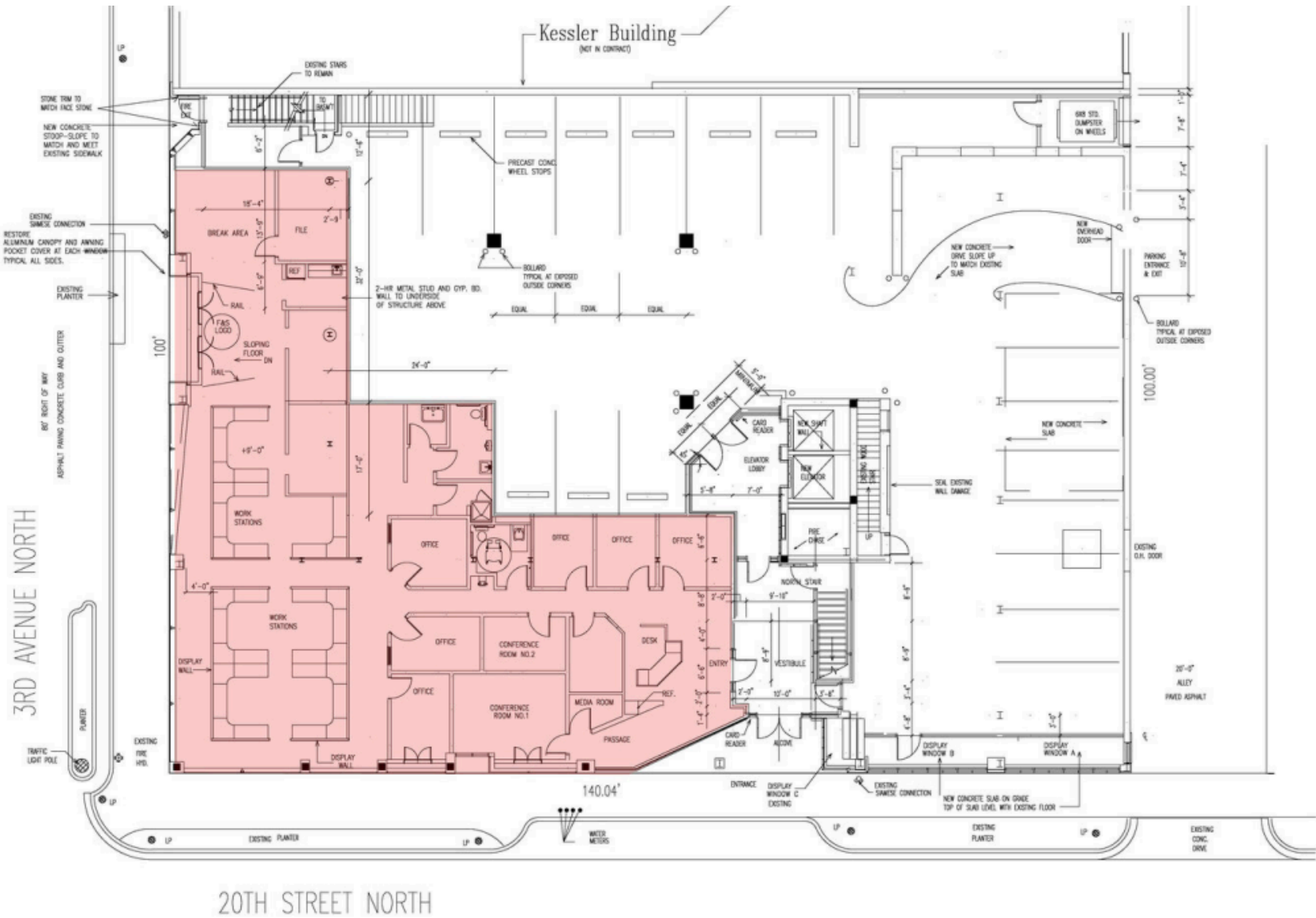

20TH STREET NORTH

**PHILIP CURRIE, CCIM, SIOR**  
205.313.4369  
pcurrie@jhberry.com

**GRACE ADAMS, MBA**  
205.313.4350  
grace@jhberry.com

**JAKE TAYLOR**  
205.313.  
jtaylor@jhberry.com

# Commercial Real Estate is Complex. We Simplify it.



Visit [jhberry.com](http://jhberry.com) to learn more.

**PHILIP CURRIE, CCIM, SIOR**  
205.313.4369  
[pcurrie@jhberry.com](mailto:pcurrie@jhberry.com)

**JAKE TAYLOR**  
205.313.4377  
[jtaylor@jhberry.com](mailto:jtaylor@jhberry.com)

**GRACE ADAMS**  
205.313.4350  
[gadams@jhberry.com](mailto:gadams@jhberry.com)