

INDUSTRIAL/MFG BUILDING W/ LARGE YARD

2378 POLVOROSA AVENUE | SAN LEANDRO, CA

28,920± SF SITUATED ON 2.65± ACRES



EXCLUSIVE AGENTS:

Ryan Martens, Principal

E \ \ rmartens@lee-associates.com

P \ \ 510.903.7605 | LIC# 01709157

Craig Hagglund, SIOR/Principal

E \ \ chagglund@lee-associates.com

P \ \ 510.903.7611 | LIC# 01090730

Jesse Lucas, Principal

E \ \ jlucas@lee-associates.com

P \ \ 510.903.7607 | LIC# 01264756

Lee & Associates Oakland Commercial Real Estate \ 520 3rd Street, Suite 105, Oakland, CA 94607 \ www.lee-associates.com

All information furnished regarding property for sale, rental or financing is from sources deemed reliable, but no warranty or representation is made to the accuracy thereof and same is submitted to errors, omissions, change of price, rental or other conditions prior to sale, lease or financing or withdrawal without notice. No liability of any kind is to be imposed on the broker herein.

INDUSTRIAL/MFG BUILDING W/ LARGE YARD

2378 POLVOROSA AVENUE | SAN LEANDRO, CA

FEATURES:

- 28,920± SF Industrial Building on 2.65± Acres
- 8,000± SF Office Area
- 6 Drive-in Doors (Oversized)
- Floor Drains
- Heavy Power: 1200 Amps @ 277/480 Volts (Verify w/ Electrician)
- Sprinklers
- 20' - 22' Clear Height
- Large Paved Yard w/ Lighting & 2 Driveway Entrances
- NNN Lease Rate: TBD
- Available w/ 60 Day Notice

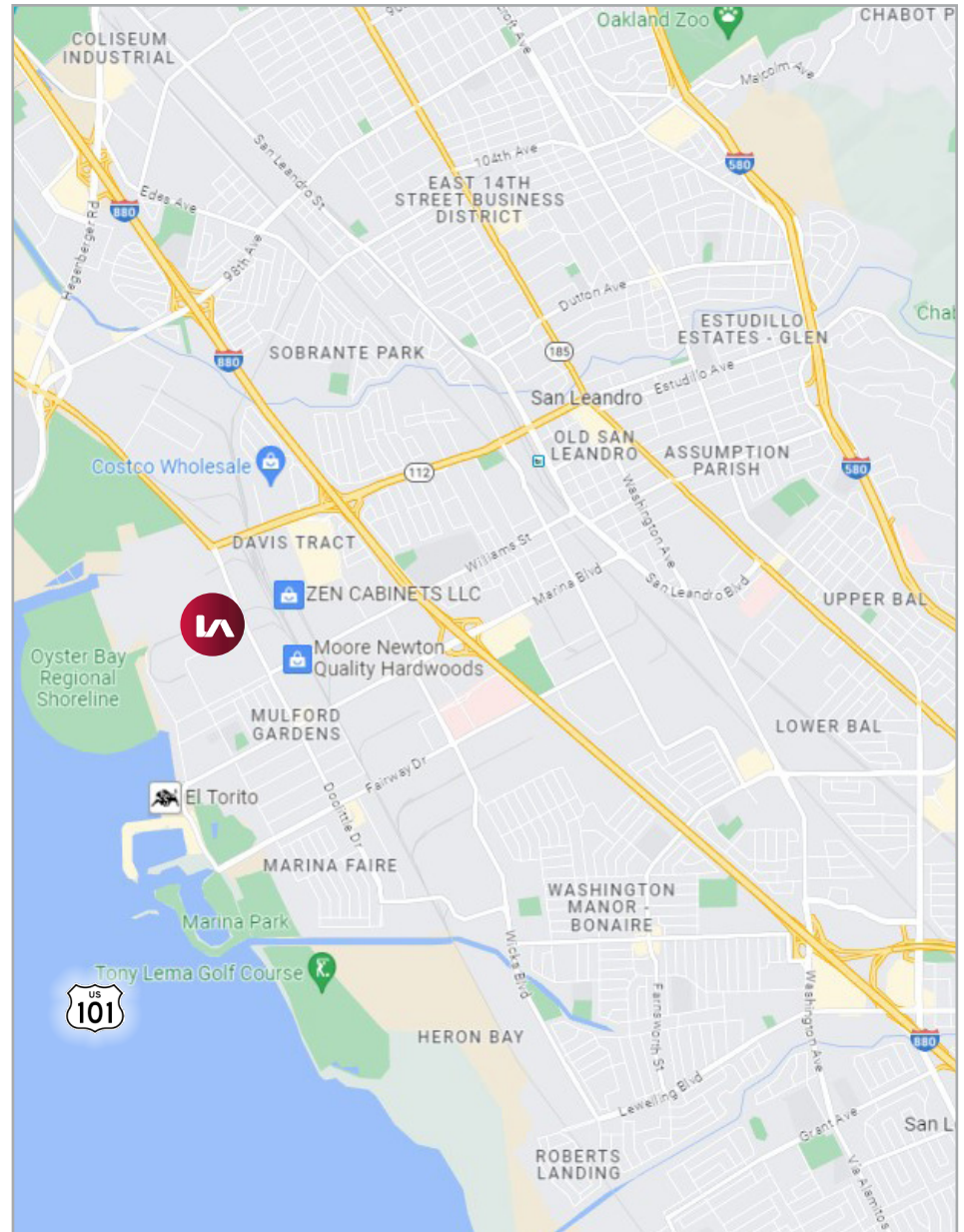
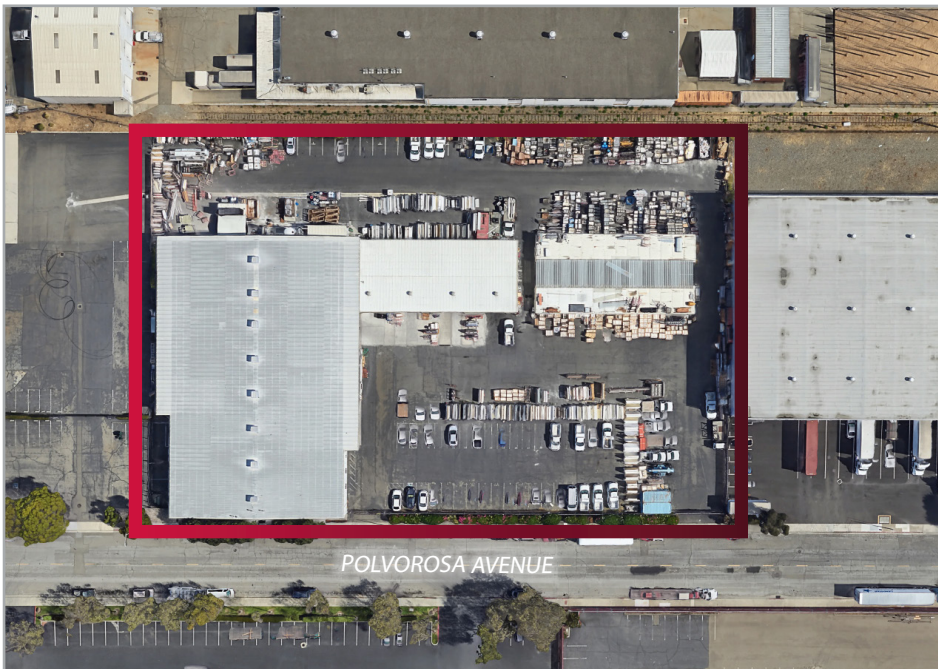

INDUSTRIAL/MFG BUILDING W/ LARGE YARD

2378 POLVOROSA AVENUE | SAN LEANDRO, CA

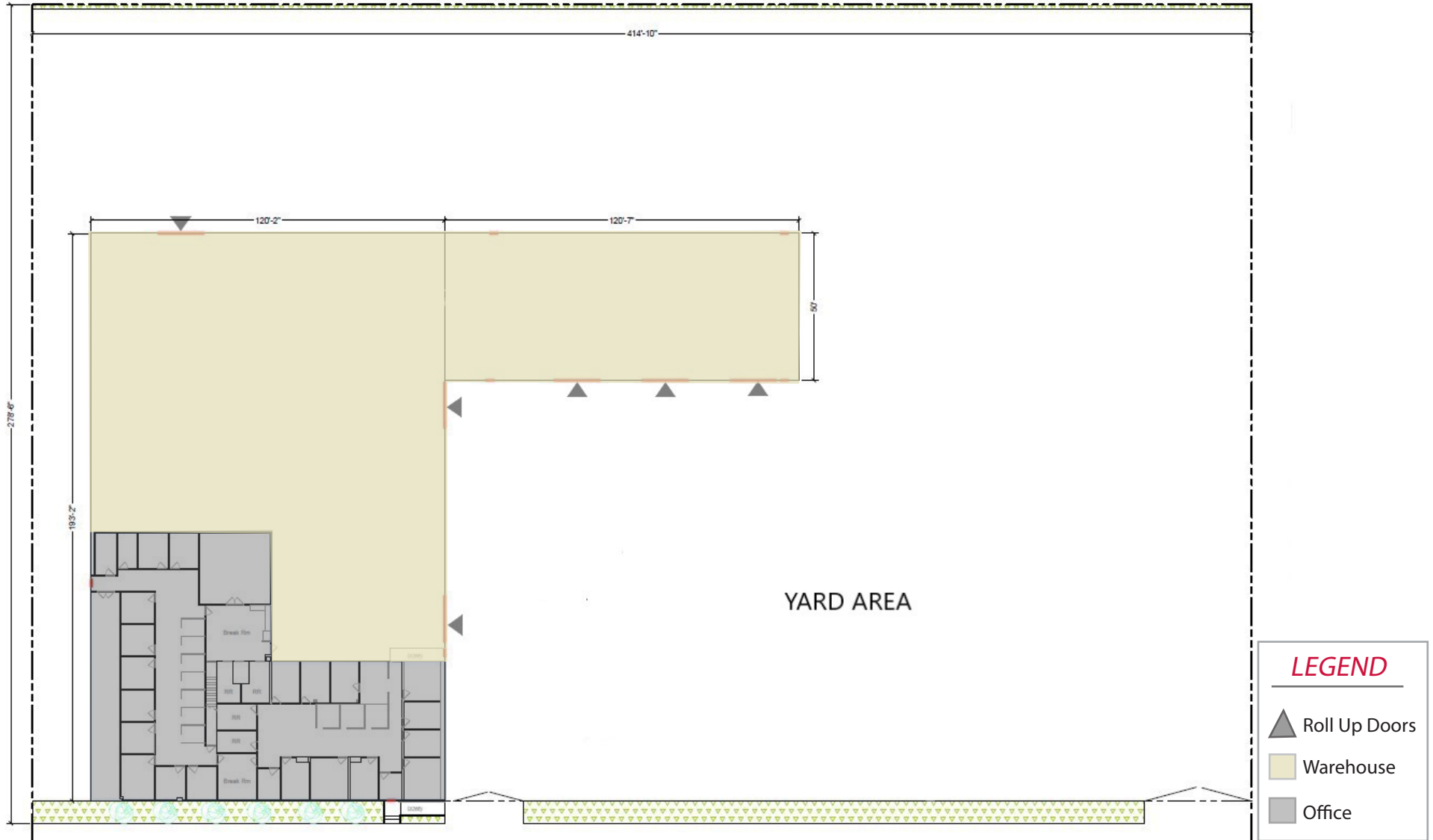

INDUSTRIAL/MFG BUILDING W/ LARGE YARD

2378 POLVOROSA AVENUE | SAN LEANDRO, CA

