

9482 COUNTY ROAD H  
80/90 TURNPIKE  
DELTA, OH 43515



**SIGNATURE  
ASSOCIATES**  
KNOW SIGNATURE | KNOW RESULTS

FULL-SERVICE COMMERCIAL REAL ESTATE

## VACANT LAND FOR SALE

30.3 ± Acres (Formerly Camping and Outdoor Recreation)

## RV PARK DEVELOPMENT SITE



### GENERAL INFORMATION

Sale Price:	TBD
Acreage:	30.3 ± Acres (21 ± AC usable + 9 AC water) See Features/Comments
Closest Cross Street:	At 80/90 Turnpike   St. Rt. 10
County:	Fulton (Village of Delta)
Zoning:	TBD (per intended development use)
Easements:	Of Record
Topography:	Flat
Survey Available:	Yes
Environmental Report:	No

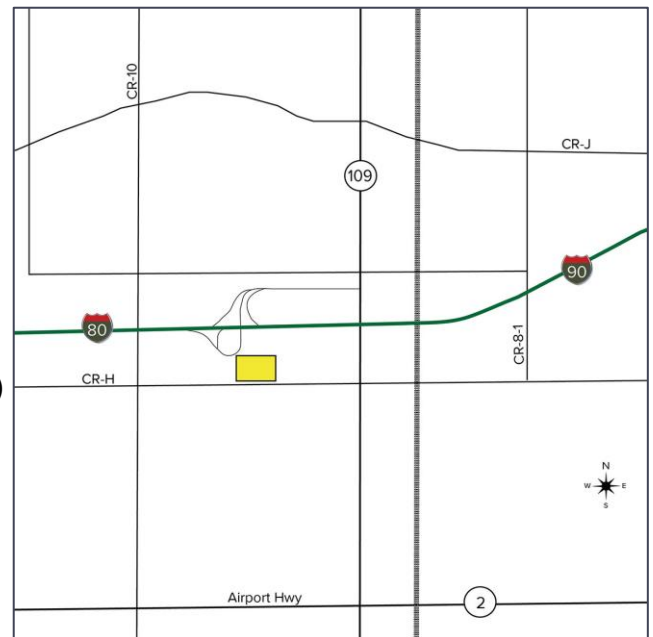

For more information, please contact:

**KEENAN FIELDS, SIOR**  
(419) 290 8334 or (419) 249 6311  
kfields@signatureassociates.com

**JARED JENSEN**  
(419) 249 6326 or (419) 377 8964  
jjensen@signatureassociates.com

**SIGNATURE ASSOCIATES**  
7150 Granite Circle, Suite 200  
Toledo, Ohio 43617  
www.signatureassociates.com

# 9482 County Road H, Delta, OH 43515

## Vacant Land For Sale

30.3 ±  
Acres  
AVAILABLE

### PROPERTY DESCRIPTION

Drainage:	Good
Improvements:	None
Restrictions:	None
Sign on Property:	Yes
Adjacent Land:	
North:	80/90 Turnpike – Exit # 39 3B (Village of Delta) B-2 Hwy/General Commercial
South:	Industrial/Commercial (Village of Delta) M1-20
East:	State Route 109, Commercial (Village of Delta) Love's
West:	Vacant land/Un-Zoned (Pike Township)

### 2025 TRAFFIC COUNTS (TWO-WAY)

4,246	State Route 109
5,387	County Road H at State Route 109
25,815	I-80/90
214,509	Delta-Lyons Ohio Turnpike Exit 39 (entering & exiting vehicles by Interchange) <small>* Based on a 4-month collection period by the Ohio Turnpike And Infrastructure Commission. Information provided as of April 30, 2024.</small>

### Redevelopment Features:

- 30 full hook-ups RV campsites
- 130 ± open campsites including 30 waterfront campsites with water views
- Wash/shower house with restrooms
- Picnic pavilion/covered shelter area
- 25' x 40' maintenance barn
- 3,000 sf clubhouse on site
- 2 lakes – 7 ± acre recreational lake & 2 ± acre secondary lake
- 12-14 acres of wooded walking trails and national recreation space

### UTILITIES

Electric:	Toledo Edison/TRI Co. substation 345 KVA immediate, main line
Gas:	Ohio Gas Company
Water:	12" line – Village of Delta – NWC Co. Rd. H & SR-109 • Distance 1,970'
Sanitary Sewer:	12" line – Village of Delta – N. side of Co. Rd. H – 600' distance to west side of Love's
Storm Sewer:	Village of Delta

### 2025 REAL ESTATE TAXES

Parcel Numbers:	21.3 AC – 20-041140-00.000 9.0 AC – 20-041112-06.000
2025 Total Taxes:	\$2,672.51

### DEMOGRAPHICS

	POPULATION	MED. HH INCOME
1 MILE	40	\$107,265
3 MILE	4,406	\$76,259
5 MILE	8,613	\$77,250

### Comments:

- **Former use was The Izaak Walton League Environmental Conservation and Outdoor Recreation Area**
- **Site was recently annexed into the Village of Delta (Zoning will be assigned per intended use)**
- Located just south of Turnpike Interchange Exit #39 (Gate 3 B)
- Access to the property off County Road H

For more information, please contact:

**KEENAN FIELDS, SIOR**  
(419) 290 8334 or (419) 249 6311  
kfields@signatureassociates.com

**JARED JENSEN**  
(419) 249 6326 or (419) 377 8964  
jjensen@signatureassociates.com

**SIGNATURE ASSOCIATES**  
7150 Granite Circle, Suite 200  
Toledo, Ohio 43617  
www.signatureassociates.com

# 9482 County Road H, Delta, OH 43515

Vacant Land For Sale

30.3 ±  
Acres  
AVAILABLE



For more information, please contact:

**KEENAN FIELDS, SIOR**  
(419) 290 8334 or (419) 249 6311  
kfields@signatureassociates.com

**JARED JENSEN**  
(419) 249 6326 or (419) 377 8964  
jjensen@signatureassociates.com

**SIGNATURE ASSOCIATES**  
7150 Granite Circle, Suite 200  
Toledo, Ohio 43617  
www.signatureassociates.com

Information is subject to verification and no liability for errors or omissions is assumed. Price is subject to change and listing withdrawal.

# 9482 County Road H, Delta, OH 43515

## Vacant Land For Sale

30.3 ±  
Acres  
AVAILABLE



For more information, please contact:

**KEENAN FIELDS, SIOR**  
(419) 290 8334 or (419) 249 6311  
kfields@signatureassociates.com

**JARED JENSEN**  
(419) 249 6326 or (419) 377 8964  
jjensen@signatureassociates.com

**SIGNATURE ASSOCIATES**  
7150 Granite Circle, Suite 200  
Toledo, Ohio 43617  
www.signatureassociates.com

9482 County Road H, Delta, OH 43515

Vacant Land For Sale

30.3 ±  
Acres  
AVAILABLE

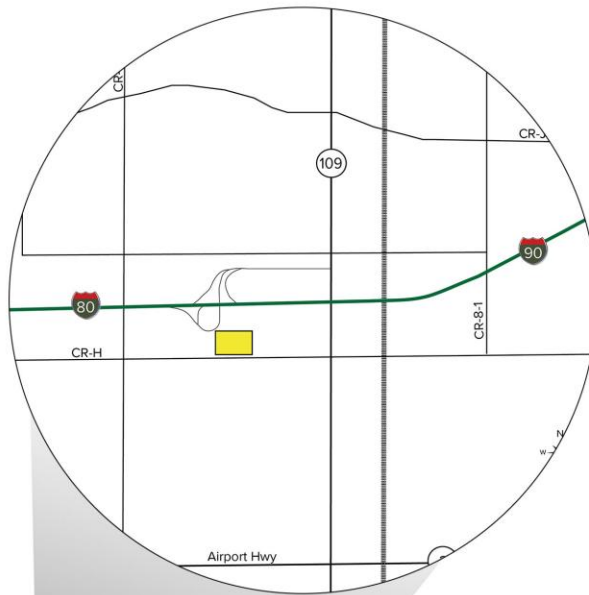

For more information, please contact:

**KEENAN FIELDS, SIOR**  
(419) 290 8334 or (419) 249 6311  
kfields@signatureassociates.com

**JARED JENSEN**  
(419) 249 6326 or (419) 377 8964  
jjensen@signatureassociates.com

**SIGNATURE ASSOCIATES**  
7150 Granite Circle, Suite 200  
Toledo, Ohio 43617  
www.signatureassociates.com