

ARCS SYMBOL LIST	
	RADIO AMPLIFICATION UNIT (RAU); TOWERIQ TACTICAL SERIES, CURRENT MODEL REPEATING CH. 11 = 483.0125MHz REPEATING CH. 12 = 484.7625MHz
	DEDICATED RADIO CONSOLE (DRC); TOWERIQ TACTICAL SERIES, CURRENT MODEL. FIELD COORDINATE EXACT LOCATION WITH ARCHITECT AND FIRE ALARM CONTRACTOR.
	2-WAY EQUAL POWER DIVIDER
	MICROLAB POWER SPLITTERS Dx-67FN SERIES
	DIRECTIONAL COUPLER / RISER TAP; TOWERIQ TACTICAL SERIES PUBLIC SAFETY RISER TAPPER VALUE TO BE DETERMINED AND REFLECTED ON FLOOR PLANS AND RISER DIAGRAMS
	DIPOLE ANTENNA, WALL MOUNTED; TOWERIQ TACTICAL SERIES PUBLIC SAFETY UHF ANTENNA (TTP-26-10104-01.00). FIELD COORDINATE EXACT LOCATION WITH ARCHITECT
	500 TERMINATION LOAD
	NEMA LF-30P TWIST LOCK PLUG, CONNECTED TO DEDICATED 120V 30A CIRCUIT ON EMERGENCY POWER. CONNECT TO FIRE ALARM ATS. PROVIDED BY OTHERS. (REFER TO ELECTRICAL PLANS)
	INTERNET CONNECTION FOR ARCS RAU. PROVIDE (1) CATEGORY 6 UTP TERMINATED WITH AN RJ45 JACK, WALL MOUNTED AND PLATED. PROVIDED BY OTHERS. (REFER TO TELECOMMUNICATIONS PLANS)
	CABLE UP; PENETRATING TO FLOOR ABOVE
	CABLE DOWN; PENETRATING TO FLOOR BELOW
	1/2" RISER CABLING: 1/2" PLENUM-RATED AIR-DIELECTRIC COAXIAL CABLE RFS CLEARFILL, ECA12-50JPL
	BRANCH CABLING: 1/2" PLENUM-RATED AIR-DIELECTRIC COAXIAL CABLE RFS CLEARFILL, ECA12-50JPL
	CONTROL CABLE: (2) 16AWG-2C FIRE ALARM CABLE WITH 2-HOUR FIRE RATING (UL 2196 CERTIFIED) RADIO SIGNALS: FPL C01049102 OR EQUIVALENT INSTALLED AS PER MANUFACTURER'S RECOMMENDATIONS.

CABLING KEYNOTES	
(A)	ARCS RISER IN STAIR 'A'. FURNISH AND INSTALL (1) 1/2" 500 COAXIAL CABLE IN 1/2" EMT.
(B)	ARCS RISER IN STAIR 'B'. FURNISH AND INSTALL (1) 1/2" 500 COAXIAL CABLE IN 1/2" EMT.
(BR)	ARCS BRANCH CABLING. FURNISH AND INSTALL (1) 1/2" 500 COAXIAL CABLE IN 1/2" EMT.
(C)	ARCS CONTROL CABLING

- | DRAWING NOTES | |
|---------------|---|
| • | DRAWING IS DIAGRAMMATIC AND INTENDED TO SHOW SCOPE AND GENERAL CONNECTIVITY OF SYSTEM. |
| • | ALL ANTENNA LOCATIONS ARE SUBJECT TO FIELD COORDINATION. ALL CEILING-MOUNTED ANTENNAS TO BE ALIGNED WITH LIGHTING AND SPRINKLERS. |
| • | ANTENNAS, SPLITTERS, RISER TAPS NOT DRAWN TO SCALE. |
| • | ALL CABLING TO BE PROVIDED 2-HOUR FIRE RATED ENCLOSURE. |

NO.	DATE	REVISIONS / SUBMISSIONS	Rev.
16			
15			
14			
13			
12			
11			
10			
9			
8			
7			
6			
5	06.28.2019	ISSUE FOR CONSTRUCTION	
4	05.31.2019	90% CONSTRUCTION DOCUMENTS (PROGRESS SUBMISSION)	
3	03.22.2019	PROGRESS PRINT 60% CONSTRUCTION DOCUMENTS	
2	01.18.2019	DESIGN DEVELOPMENT	
1	06.22.2018	Schematic Design	

fxcollaborative

FXCollaborative Architects LLP | 22 West 19th Street | New York, NY 10011 | 212 627 1700 | fxcollaborative.com

SEVERUD
469 Seventh Avenue, Suite 900, New York, NY 10018 212-668-3700

MG ENGINEERING D.P.C.
116 West 32nd Street, New York, NY 10001 212-643-9005

LANGAN
21 Park Place, 300 West 31st Street, 8th Floor, New York, NY 10001 212-478-5400

GILSANZ MURRAY STEFICEK LLP
129 West 27th Street, Floor 5, New York, NY 10001 212-254-0030

INC Architecture & Design
150 Varot Street, Floor 5 South, New York, NY 10013 212-673-1695

ONELUX Studio
158 West 29th Street, 10th Floor, New York, NY 10001 212-201-9790

RKLA Studio
333 Hudson Street, Suite 1001, New York, NY 10013 212-229-2534

185 Broadway

New York, NY 10038

DRAWING TITLE:
3RD FLOOR ARCS PLAN

Seal: _____ Drawn: _____ Project No.: _____
Author: _____ 8126 00

Drawing No.: _____

06/12/18
Scale:
As indicated of _____

FR-103.00

NEW YORK CITY ENERGY CONSERVATION CODE
TO THE BEST OF MY KNOWLEDGE, BELIEF AND PROFESSIONAL JUDGMENT, THESE PLANS AND SPECIFICATIONS ARE IN COMPLIANCE WITH THE 2016 NEW YORK CITY ENERGY CONSERVATION CODE.

MGE
United Technologies Corp.
110 West 32nd Street, 12th Floor, New York, NY 10001
P 212-643-9955 F 212-643-9923 www.mge.com

ARCS SYMBOL LIST	
	RADIO AMPLIFICATION UNIT (RAU); TOWERIQ TACTICAL SERIES, CURRENT MODEL. REPEATING CH. 11 + 483.0125MHz. REPEATING CH. 12 + 484.7625MHz.
	DEDICATED RADIO CONSOLE (DRC); TOWER IQ TACTICAL SERIES, CURRENT MODEL. FIELD COORDINATE EXACT LOCATION WITH ARCHITECT AND FIRE ALARM CONTRACTOR.
	2-WAY EQUAL POWER DIVIDER
	MICROLAB POWER SPLITTERS Dx-67FN SERIES
	DIRECTIONAL COUPLER / RISER TAP; TOWER IS TACTICAL SERIES. PUBLIC SAFETY RF TAPPER. VALUE TO BE DETERMINED AND REFLECTED ON FLOOR PLANS AND RISER DIAGRAMS.
	DIPLOLE ANTENNA, WALL MOUNTED; TOWERIQ TACTICAL SERIES PUBLIC SAFETY UHF ANTENNA (TPP 50-10164-01.00). FIELD COORDINATE EXACT LOCATION WITH ARCHITECT.
	500 TERMINATION LOAD
	NEMA LF-30P TWIST LOCK PLUG, CONNECTED TO DEDICATED 120V 30A CIRCUIT ON EMERGENCY POWER. CONNECT TO FIRE ALARM ATS. PROVIDED BY OTHERS. (REFER TO ELECTRICAL PLANS)
	INTERNET CONNECTION FOR ARCS RAIL. PROVIDE (1) CATEGORY 6 UTP TERMINATED WITH AN RJ45 JACK, WALL MOUNTED AND PLATED. PROVIDED BY OTHERS. (REFER TO TELECOMMUNICATIONS PLANS)
	CABLE UP; PENETRATING TO FLOOR ABOVE.
	CABLE DOWN; PENETRATING TO FLOOR BELOW.
	1/2" RISER CABLING: 1/2" PLENUM-RATED AIR-DIELECTRIC COAXIAL CABLE RFS CLEARFILL ICA12-50UPL
	BRANCH CABLING: 1/2" PLENUM-RATED AIR-DIELECTRIC COAXIAL CABLE RFS CLEARFILL ICA12-50UPL
	CONTROL CABLE (2) 18AWG-2C FIRE ALARM CABLE WITH 2-HOUR FIRE RATING (UL 2196 CERTIFIED). RADIX DURALIFE FPL CU16A0102, OR EQUIVALENT INSTALLED AS PER MANUFACTURER'S RECOMMENDATIONS.

CABLING KEYNOTES	
	ARCS RISER IN STAIR "A". FURNISH AND INSTALL (1) 1/2" 500 COAXIAL CABLE IN 1 1/2" EMT.
	ARCS RISER IN STAIR "B". FURNISH AND INSTALL (1) 1/2" 500 COAXIAL CABLE IN 1 1/2" EMT.
	ARCS BRANCH CABLING. FURNISH AND INSTALL (1) 1/2" 500 COAXIAL CABLE IN 1 1/2" EMT.
	ARCS CONTROL CABLING

DRAWING NOTES	
DRAWING IS DIAGRAMMATIC AND INTENDED TO SHOW SCOPE AND GENERAL CONNECTIVITY OF SYSTEM.	
ALL ANTENNA LOCATIONS ARE SUBJECT TO FIELD COORDINATION. ALL CEILING-MOUNTED ANTENNAS TO BE ALIGNED WITH LIGHTING AND SPRINKLERS.	
ANTENNAS, SPLITTERS, RISER TAPS NOT DRAWN TO SCALE.	
ALL CABLING TO BE PROVIDED 2-HOUR FIRE RATED ENCLOSURE.	

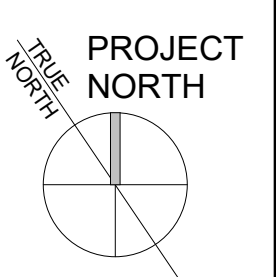
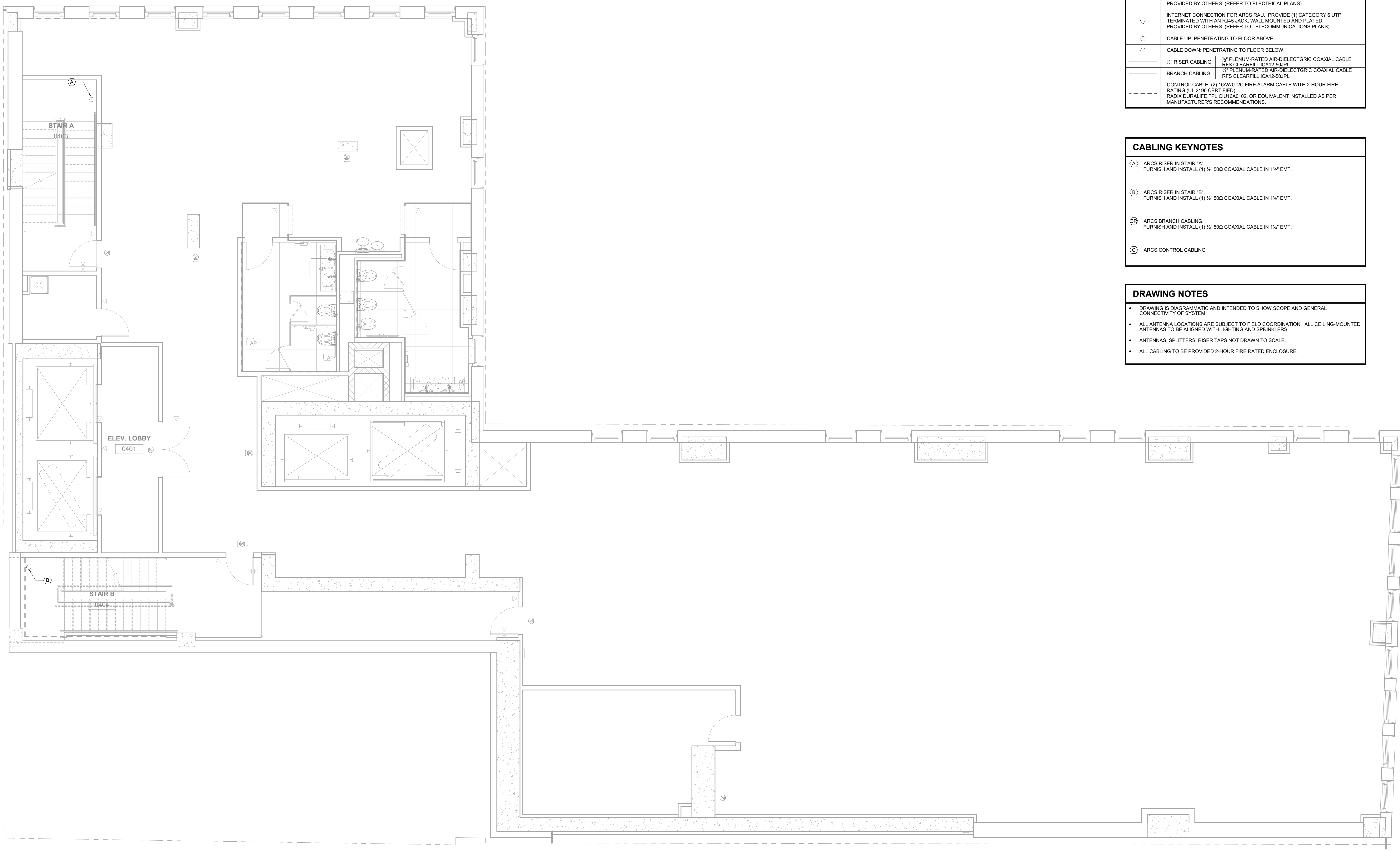

NO.	DATE	REVISIONS / SUBMISSIONS	Rev.
16			
15			
14			
13			
12			
11			
10			
9			
8			
7			
6			
5	06.28.2019	ISSUE FOR CONSTRUCTION	
4	05.31.2019	90% CONSTRUCTION DOCUMENTS (PROGRESS SUBMISSION)	
3	03.22.2019	PROGRESS PRINT FOR CONSTRUCTION DOCUMENTS	
2	01.18.2019	DESIGN DEVELOPMENT	
1	06.22.2018	Schematic Design	

fxcollaborative

FXCollaborative Architects LLP | 22 West 19th Street | New York, NY 10011 | 212 627 1700 | fxcollaborative.com
SEVERUD
 460 Seventh Avenue, Suite 900, New York, NY 10018 212-668-3700
MG ENGINEERING D.P.C.
 116 West 32nd Street, New York, NY 10001 212-643-9005
LANGAN
 21 Park Place, 300 West 31st Street, 8th Floor, New York, NY 10001 212-478-5400
GILSANZ MURRAY STEFICEK LLP
 129 West 27th Street, Floor 5, New York, NY 10001 212-254-0030
INC Architecture & Design
 150 Varot Street, Floor 5 South, New York, NY 10013 212-673-1695
ONELUX Studio
 158 West 29th Street, 10th Floor, New York, NY 10001 212-201-9790
RKLA Studio
 333 Hudson Street, Suite 1001, New York, NY 10013 212-229-2534

185 Broadway
 New York, NY 10038

DRAWING TITLE:
4TH FLOOR ARCS PLAN

Seal: _____ Drawn: _____ Project No.: _____
 Author: _____ 8126 00

Drawing No.: _____
 06/12/18
 Scale: _____
 As indicated of _____

FR-104.00

NEW YORK CITY ENERGY CONSERVATION CODE
 TO THE BEST OF MY KNOWLEDGE, BELIEF AND PROFESSIONAL JUDGMENT, THESE PLANS AND SPECIFICATIONS ARE IN COMPLIANCE WITH THE 2016 NEW YORK CITY ENERGY CONSERVATION CODE.



V
U
T
S
R
Q
P
N
M
L
K
J
H
G
F
E
D
C
B
A

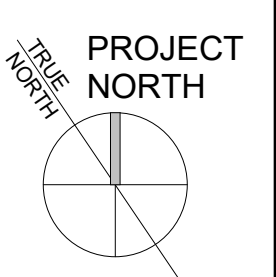

ARCS SYMBOL LIST	
	RADIO AMPLIFICATION UNIT (RAU); TOWERIQ TACTICAL SERIES, CURRENT MODEL REPEATING CH. 11 = 483.0125MHz REPEATING CH. 12 = 484.7025MHz
	DEDICATED RADIO CONSOLE (DRC); TOWERIQ TACTICAL SERIES, CURRENT MODEL. FIELD COORDINATE EXACT LOCATION WITH ARCHITECT AND FIRE ALARM CONTRACTOR.
	2-WAY EQUAL POWER DIVIDER
	MICROLAB POWER SPLITTERS Dx-67FN SERIES
	DIRECTIONAL COUPLER / RISER TAP; TOWER IS TACTICAL SERIES PUBLIC SAFETY RF TAPPER VALUE TO BE DETERMINED AND REFLECTED ON FLOOR PLANS AND RISER DIAGRAMS
	DIPOLE ANTENNA, WALL MOUNTED; TOWERIQ TACTICAL SERIES PUBLIC SAFETY UHF ANTENNA (TPP-50-10164-01.00). FIELD COORDINATE EXACT LOCATION WITH ARCHITECT
	500 TERMINATION LOAD
	NEMA LF-30P TWIST LOCK PLUG, CONNECTED TO DEDICATED 120V 30A CIRCUIT ON EMERGENCY POWER. CONNECT TO FIRE ALARM ATS PROVIDED BY OTHERS. (REFER TO ELECTRICAL PLANS)
	INTERNET CONNECTION FOR ARCS RAU. PROVIDE (1) CATEGORY 6 UTP TERMINATED WITH AN RJ45 JACK, WALL MOUNTED AND PLATED. PROVIDED BY OTHERS. (REFER TO TELECOMMUNICATIONS PLANS)
	CABLE UP: PENETRATING TO FLOOR ABOVE.
	CABLE DOWN: PENETRATING TO FLOOR BELOW.
	1/2" RISER CABLING: 1/2" PLENUM-RATED AIR-DIELECTRIC COAXIAL CABLE RFS CLEARFILL ICA12-50JPL
	BRANCH CABLING: 1/2" PLENUM-RATED AIR-DIELECTRIC COAXIAL CABLE RFS CLEARFILL ICA12-50JPL
	CONTROL CABLE: (2) 18AWG-2C FIRE ALARM CABLE WITH 2-HOUR FIRE RATING (UL 2196-CERTIFIED) RADIX DURALIFE PPL CIU16AD102, OR EQUIVALENT INSTALLED AS PER MANUFACTURER'S RECOMMENDATIONS.

CABLING KEYNOTES	
(A)	ARCS RISER IN STAIR "A". FURNISH AND INSTALL (1) 1/2" 500 COAXIAL CABLE IN 1 1/2" EMT.
(B)	ARCS RISER IN STAIR "B". FURNISH AND INSTALL (1) 1/2" 500 COAXIAL CABLE IN 1 1/2" EMT.
(BR)	ARCS BRANCH CABLING. FURNISH AND INSTALL (1) 1/2" 500 COAXIAL CABLE IN 1 1/2" EMT.
(C)	ARCS CONTROL CABLING

DRAWING NOTES	
•	DRAWING IS DIAGRAMMATIC AND INTENDED TO SHOW SCOPE AND GENERAL CONNECTIVITY OF SYSTEM.
•	ALL ANTENNA LOCATIONS ARE SUBJECT TO FIELD COORDINATION. ALL CEILING-MOUNTED ANTENNAS TO BE ALIGNED WITH LIGHTING AND SPRINKLERS.
•	ANTENNAS, SPLITTERS, RISER TAPS NOT DRAWN TO SCALE.
•	ALL CABLING TO BE PROVIDED 2-HOUR FIRE RATED ENCLOSURE.

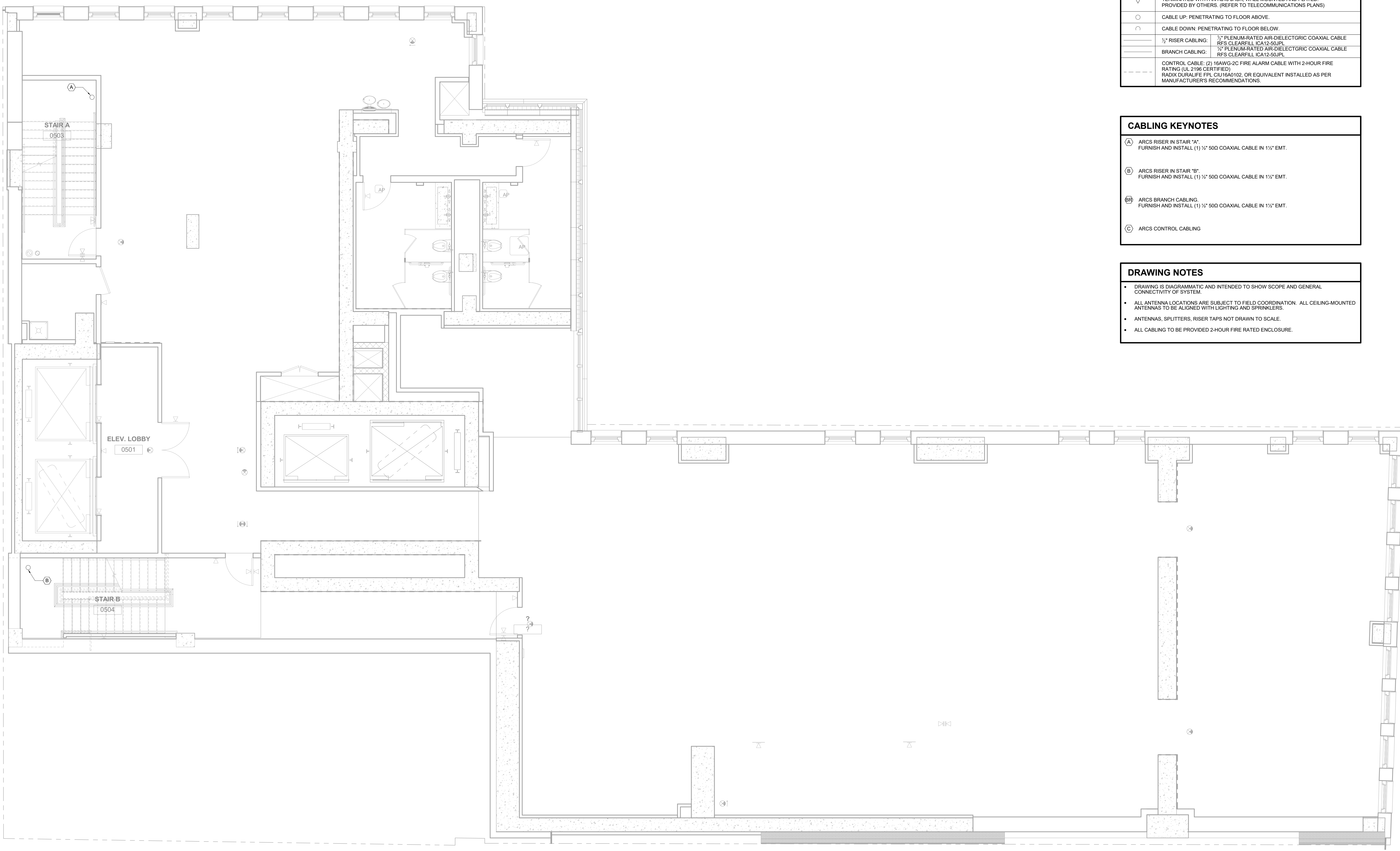

NO.	DATE	REVISIONS / SUBMISSIONS	Rev.
16			
15			
14			
13			
12			
11			
10			
9			
8			
7			
6			
5	06.28.2019	ISSUE FOR CONSTRUCTION	
4	05.31.2019	90% CONSTRUCTION DOCUMENTS (PROGRESS SUBMISSION)	
3	03.22.2019	PROGRESS PRINT (90% CONSTRUCTION DOCUMENTS)	
2	01.18.2019	DESIGN DEVELOPMENT	
1	06.22.2018	Schematic Design	

fxcollaborative
 FxCollaborative Architects LLP | 22 West 19th Street | New York, NY 10011 | 212 627 1700 | fxcollaborative.com
SEVERUD
 469 Seventh Avenue, Suite 900, New York, NY 10018 212-668-3700
MG ENGINEERING D.P.C.
 116 West 32nd Street, New York, NY 10001 212-643-9005
LANGAN
 21 Park Place, 300 West 31st Street, 8th Floor, New York, NY 10001 212-479-5400
GILSANZ MURRAY STEFICEK LLP
 129 West 27th Street, Floor 5, New York, NY 10001 212-254-0030
INC Architecture & Design
 150 Varot Street, Floor 5 South, New York, NY 10013 212-673-1695
ONELUX Studio
 158 West 29th Street, 10th Floor, New York, NY 10001 212-201-9790
RKLA Studio
 333 Hudson Street, Suite 1001, New York, NY 10013 212-229-2534

185 Broadway
 New York, NY 10038

DRAWING TITLE:
5TH FLOOR ARCS PLAN

Seal: _____ Drawn: _____ Project No.: 8126.00
 Author: _____
 Drawing No.: _____

06/12/18
 Scale: As indicated of

NEW YORK CITY ENERGY CONSERVATION CODE
 TO THE BEST OF MY KNOWLEDGE, BELIEF AND PROFESSIONAL JUDGMENT, THESE PLANS AND SPECIFICATIONS ARE IN COMPLIANCE WITH THE 2016 NEW YORK CITY ENERGY CONSERVATION CODE.

MGE
 Unified Technologies Corp.
 110 West 32nd Street, 12th Floor, New York, NY 10001
 P 212-643-9262 F 212-643-9003 www.mgecorp.net

FR-105.00

V
U
T
S
R
Q
P
N
M
L
K
J
H
G
F
E
D
C
B
A

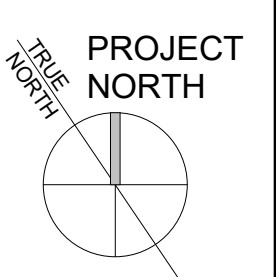

ARCS SYMBOL LIST	
	RADIO AMPLIFICATION UNIT (RAU), TOWERIQ TACTICAL SERIES, CURRENT MODEL REPEATING CH. 11 = 483.0125MHz REPEATING CH. 12 = 484.7625MHz
	DEDICATED RADIO CONSOLE (DRC), TOWER IQ TACTICAL SERIES, CURRENT MODEL, FIELD COORDINATE EXACT LOCATION WITH ARCHITECT AND FIRE ALARM CONTRACTOR
	2-WAY EQUAL POWER DIVIDER MICROLAB POWER SPLITTERS Dx-67FN SERIES
	DIRECTIONAL COUPLER / RISER TAP, TOWER IQ TACTICAL SERIES PUBLIC SAFETY RF TAPPER VALUE TO BE DETERMINED AND REFLECTED ON FLOOR PLANS AND RISER DIAGRAMS
	DIPOLE ANTENNA, WALL MOUNTED, TOWERIQ TACTICAL SERIES PUBLIC SAFETY UHF ANTENNA (TPP-50-10164-01.00), FIELD COORDINATE EXACT LOCATION WITH ARCHITECT
	500 TERMINATION LOAD
	NEMA LF-30P TWIST LOCK PLUG, CONNECTED TO DEDICATED 120V 30A CIRCUIT ON EMERGENCY POWER, CONNECT TO FIRE ALARM ATS, PROVIDED BY OTHERS. (REFER TO ELECTRICAL PLANS)
	INTERNET CONNECTION FOR ARCS RAU, PROVIDE (1) CATEGORY 6 UTP TERMINATED WITH AN RJ45 JACK, WALL MOUNTED AND PLATED, PROVIDED BY OTHERS. (REFER TO TELECOMMUNICATIONS PLANS)
	CABLE UP: PENETRATING TO FLOOR ABOVE.
	CABLE DOWN: PENETRATING TO FLOOR BELOW.
	1/2" RISER CABLING: 1/2" PLENUM-RATED AIR-DIELECTRIC COAXIAL CABLE RFS CLEARFILL ICA12-50JPL
	BRANCH CABLING: 1/2" PLENUM-RATED AIR-DIELECTRIC COAXIAL CABLE RFS CLEARFILL ICA12-50JPL
	CONTROL CABLE: (2) 16AWG-2C FIRE ALARM CABLE WITH 2-HOUR FIRE RATING (UL 2196 CERTIFIED) RADIO DURALIFE PPL CU116A102, OR EQUIVALENT INSTALLED AS PER MANUFACTURER'S RECOMMENDATIONS.

CABLING KEYNOTES	
	ARCS RISER IN STAIR "A" FURNISH AND INSTALL (1) 1/2" 500 COAXIAL CABLE IN 1 1/2" EMT.
	ARCS RISER IN STAIR "B" FURNISH AND INSTALL (1) 1/2" 500 COAXIAL CABLE IN 1 1/2" EMT.
	ARCS BRANCH CABLING FURNISH AND INSTALL (1) 1/2" 500 COAXIAL CABLE IN 1 1/2" EMT.
	ARCS CONTROL CABLING

DRAWING NOTES	
DRAWING IS DIAGRAMMATIC AND INTENDED TO SHOW SCOPE AND GENERAL CONNECTIVITY OF SYSTEM.	
ALL ANTENNA LOCATIONS ARE SUBJECT TO FIELD COORDINATION. ALL CEILING-MOUNTED ANTENNAS TO BE ALIGNED WITH LIGHTING AND SPRINKLERS.	
ANTENNAS, SPLITTERS, RISER TAPS NOT DRAWN TO SCALE.	
ALL CABLING TO BE PROVIDED 2-HOUR FIRE RATED ENCLOSURE.	

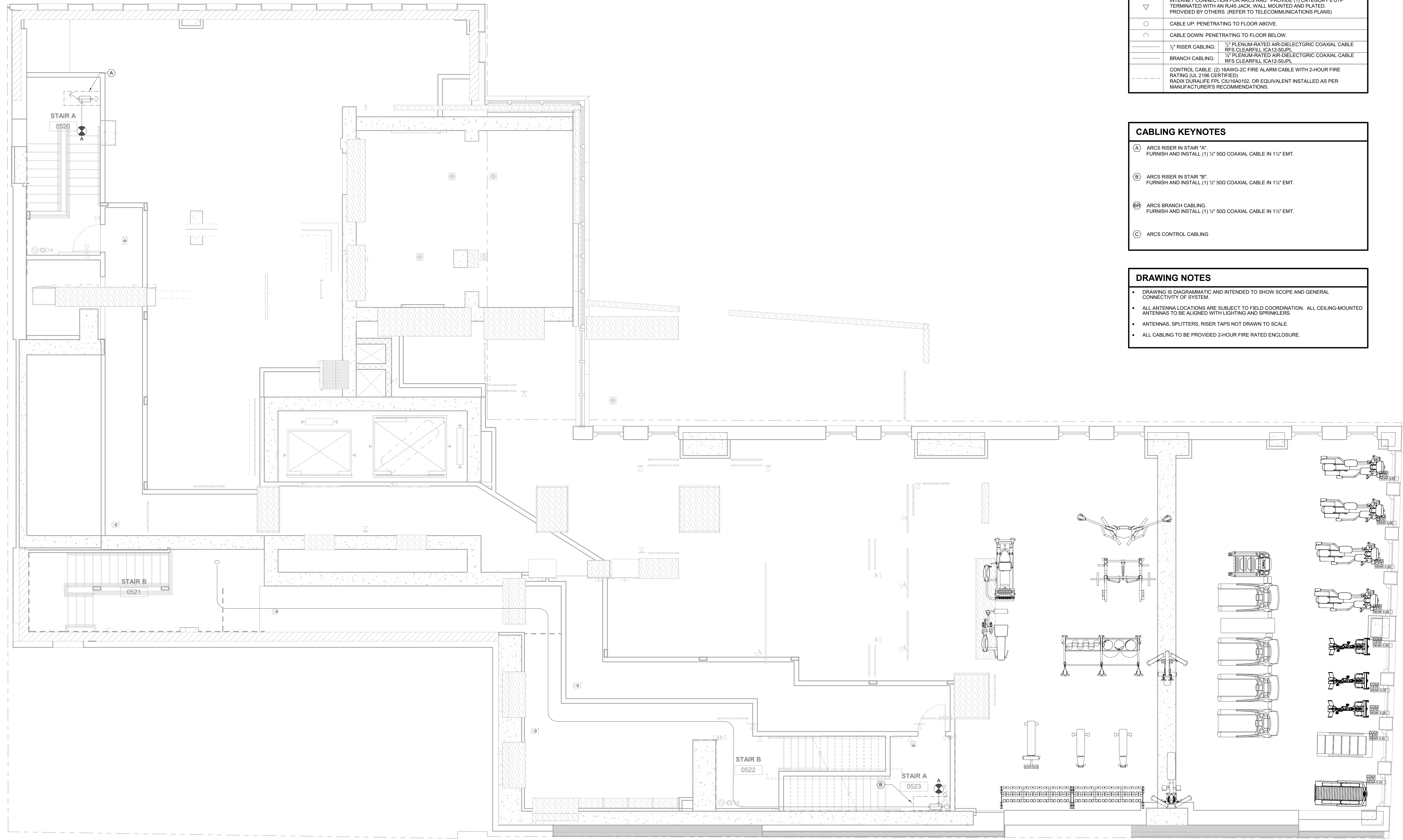

NO.	DATE	REVISIONS / SUBMISSIONS	Rev.
16			
15			
14			
13			
12			
11			
10			
9			
8			
7			
6			
5	06.28.2019	ISSUE FOR CONSTRUCTION	
4	05.31.2019	90% CONSTRUCTION DOCUMENTS (PROGRESS SUBMISSION)	
3	03.22.2019	PROGRESS PRINT (90% CONSTRUCTION DOCUMENTS)	
2	01.18.2019	DESIGN DEVELOPMENT	
1	06.22.2018	Schematic Design	

fxcollaborative
 FXCollaborative Architects LLP | 22 West 19th Street | New York, NY 10011 | 212 627 1700 | fxcollaborative.com
SEVERUD
 460 Seventh Avenue, Suite 900, New York, NY 10018 212-686-3700
MG ENGINEERING D.P.C.
 116 West 32nd Street, New York, NY 10001 212-643-9005
LANGAN
 21 Penn Plaza, New York, NY 10001 212-479-5400
GILSANZ MURRAY STEFICEK LLP
 129 West 27th Street, Floor 5, New York, NY 10001 212-254-0030
INC Architecture & Design
 150 Varot Street, Floor 5 South, New York, NY 10013 212-673-1665
ONELUX Studio
 158 West 29th Street, 10th Floor, New York, NY 10001 212-201-9790
RKLA Studio
 333 Hudson Street, Suite 1001, New York, NY 10013 212-229-2534

185 Broadway
 New York, NY 10038

DRAWING TITLE:
5TH FLOOR MEZZANINE ARCS PLAN

Seal: _____ Drawn: _____ Project No.: 8126.00
 Author: _____

Drawing No.: **FR-106.00**
 06/12/18
 Scale: As indicated

NEW YORK CITY ENERGY CONSERVATION CODE
 TO THE BEST OF MY KNOWLEDGE, BELIEF AND PROFESSIONAL JUDGMENT, THESE PLANS AND SPECIFICATIONS ARE IN COMPLIANCE WITH THE 2016 NEW YORK CITY ENERGY CONSERVATION CODE.

MGE
 Unified Technologies Corp.
 110 West 32nd Street, 12th Floor, New York, NY 10001
 P 212.643.9262 F 212.643.9203 www.mgecorp.net

- TELECOMMUNICATIONS DRAWING NOTES**
- DRAWINGS ARE DIAGRAMMATIC AND INDICATE GENERAL ARRANGEMENT OF SYSTEMS AND WORK. COORDINATE LAYOUT ON THESE DRAWINGS AGAINST DRAWINGS OF OTHER TRADES TO VERIFY THAT HEADROOM AND SPACE CONDITIONS ARE MAINTAINED.
 - CONDUIT PATHWAYS ARE SHOWN FOR COORDINATION PURPOSES ONLY. REFER TO ELECTRICAL PLANS. CONDUIT IS TO BE FURNISHED AND INSTALLED BY ELECTRICAL CONTRACTOR.
 - ELECTRICAL POWER/RECEPTACLES ARE SHOWN FOR COORDINATION PURPOSES ONLY. REFER TO ELECTRICAL PLANS FOR CIRCUITING INFORMATION.
 - ALL WORK IS SUBJECT TO FULL FIELD COORDINATION BY CONTRACTOR.
 - OUTLET IDENTIFICATION NUMBERING SHALL BE AS DIRECTED BY OWNER'S MSIT DEPARTMENT. INSTALLATION SHALL COMPLY WITH SPECIFICATIONS. EACH CABLE SHALL BE TAGGED AT ALL TERMINATION POINTS.
 - ALL CONDUIT AND SLEEVE ENDS SHALL HAVE PROTECTIVE BUSHINGS. PROTECTIVE GROMMETS SHALL BE PROVIDED AT ALL PENETRATIONS FOR CABLING THROUGH METAL STUDS. PULLING OR LAYING CABLE OVER SHARP EDGES IS NOT PERMITTED.

TELECOMMUNICATIONS SYMBOL LIST

(H)	WALL-MOUNTED COMMUNICATIONS OUTLET: (#) CATEGORY 6 UTP CABLES (2, 4, 6)
APT	WALL-MOUNTED APARTMENT COMMUNICATIONS OUTLET: (1) CATEGORY 6 UTP CABLES (1) RG-6 COAXIAL CABLE
WAP	WALL-MOUNTED APARTMENT COMMUNICATIONS OUTLET: (1) CATEGORY 6 UTP CABLE MOUNT OUTLET ABOVE SHELF IN CLOSET. COORDINATE WITH ELECTRICAL CONTRACTOR TO PROVIDE ELECTRICAL POWER AT OUTLET LOCATION.
W	WALL PHONE: (1) CATEGORY 6 UTP CABLE
AV	AUDIOVISUAL DISPLAY DATA OUTLET: (2) CATEGORY 6 UTP CABLES (1) CATEGORY 6 STP CABLE (1) QUAD SHIELDED RG COAXIAL CABLE
IDF	IDF DATA OUTLET: (1) 12-STRAND OM3 FIBEROPTICAL DATA CABLE TO MDF IN SUB CELLAR
(WAP)	CEILING-MOUNTED WIRELESS ACCESS POINT OUTLET: (2) CATEGORY 6 UTP CABLES ON A DATA SURFACE BOX IN ACCESSIBLE CEILING
(NIDVZ)	APARTMENT NID ENCLOSURE AND VERIZON ONT LOCATION.
(ICM)	HANDS-FREE AUDIO INTERCOM STATION: SIEDLE BFS 850-02 W
(ENT)	AUDIO INTERCOM ENTRANCE STATION: SIEDLE ENTRY STATION
(GS)	AUDIO INTERCOM GUARD STATION:
(ICM) (CS)	AUDIO INTERCOM CALL BOX TO CONCIERGE DESK FOR AMENITY SPACES:

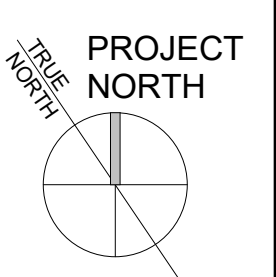
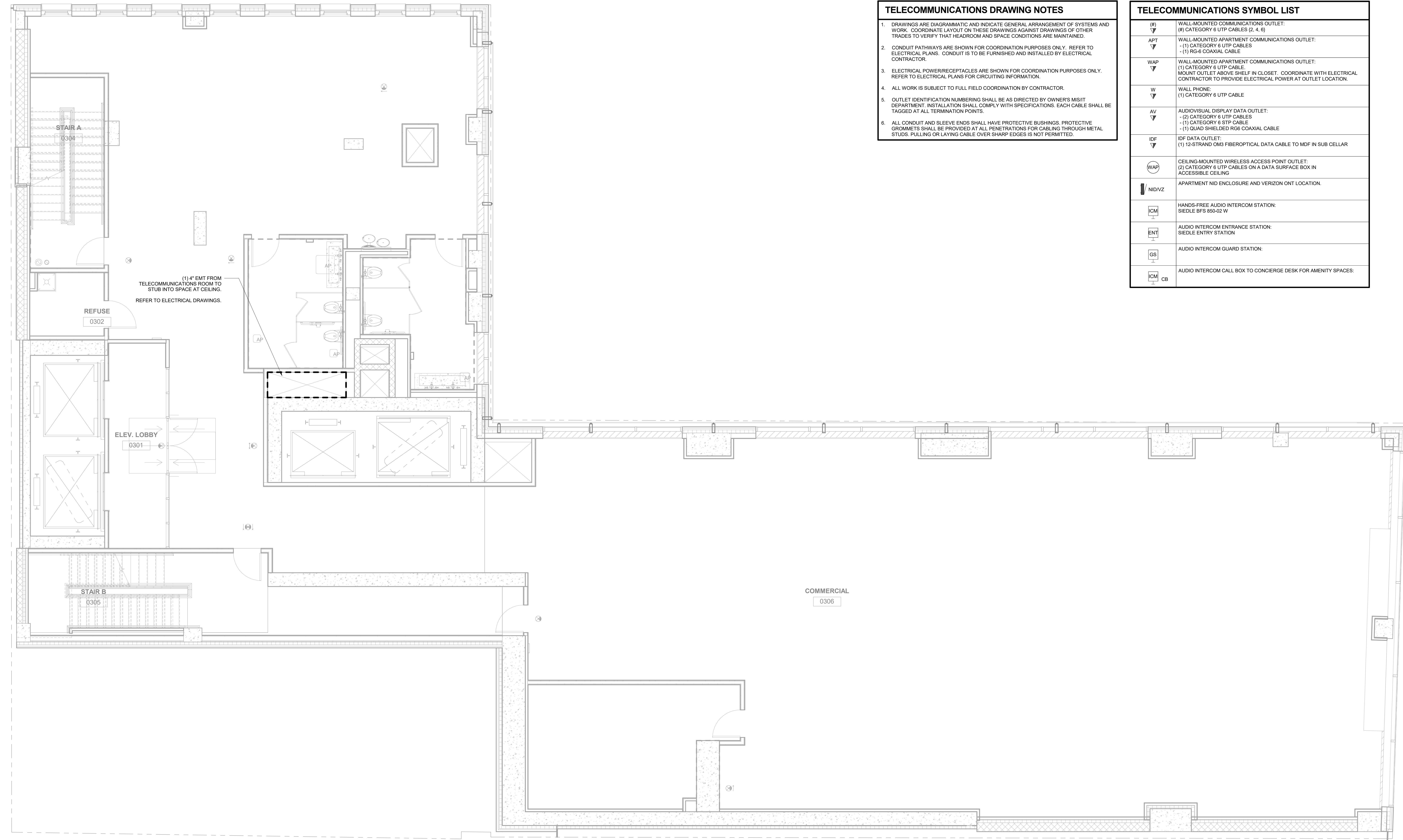

16			
15			
14			
13			
12			
11			
10			
9			
8			
7			
6			
5	06.28.2019	ISSUE FOR CONSTRUCTION	
4	05.31.2019	90% CONSTRUCTION DOCUMENTS (PROGRESS SUBMISSION)	
3	03.22.2019	PROGRESS PRINT (90% CONSTRUCTION DOCUMENTS)	
2	01.18.2019	DESIGN DEVELOPMENT	
1	06.22.2018	Schematic Design	
NO	DATE	REVISIONS SUBMISSIONS	Rev. Δ

fxcollaborative

FXCollaborative Architects LLP | 22 West 19th Street | New York, NY 10011 | 212 627 1700 | fxcollaborative.com
SEVERUD
 469 Seventh Avenue, Suite 900, New York, NY 10018 212-668-3700
MG ENGINEERING D.P.C.
 116 West 32nd Street, New York, NY 10001 212-643-9005
LANGAN
 21 Park Place, 300 West 31st Street, 8th Floor, New York, NY 10001 212-479-5400
GILSANZ MURRAY STEFICEK LLP
 129 West 27th Street, Floor 5, New York, NY 10001 212-254-0030
INC Architecture & Design
 150 Varot Street, Floor 5 South, New York, NY 10013 212-673-1695
ONELUX Studio
 158 West 29th Street, 10th Floor, New York, NY 10001 212-201-9790
RKLA Studio
 333 Hudson Street, Suite 1001, New York, NY 10013 212-229-2534

185 Broadway
 New York, NY 10038

DRAWING TITLE:
3RD FLOOR TELECOMMUNICATIONS PLAN

Seal: _____ Drawn: _____ Project No.: _____
 Author: _____ 8126 00

Drawing No.: _____

03/26/18
 Scale: _____
 As indicated of _____

NEW YORK CITY ENERGY CONSERVATION CODE
 TO THE BEST OF MY KNOWLEDGE, BELIEF AND PROFESSIONAL JUDGMENT, THESE PLANS AND SPECIFICATIONS ARE IN COMPLIANCE WITH THE 2016 NEW YORK CITY ENERGY CONSERVATION CODE.



TC-103.00

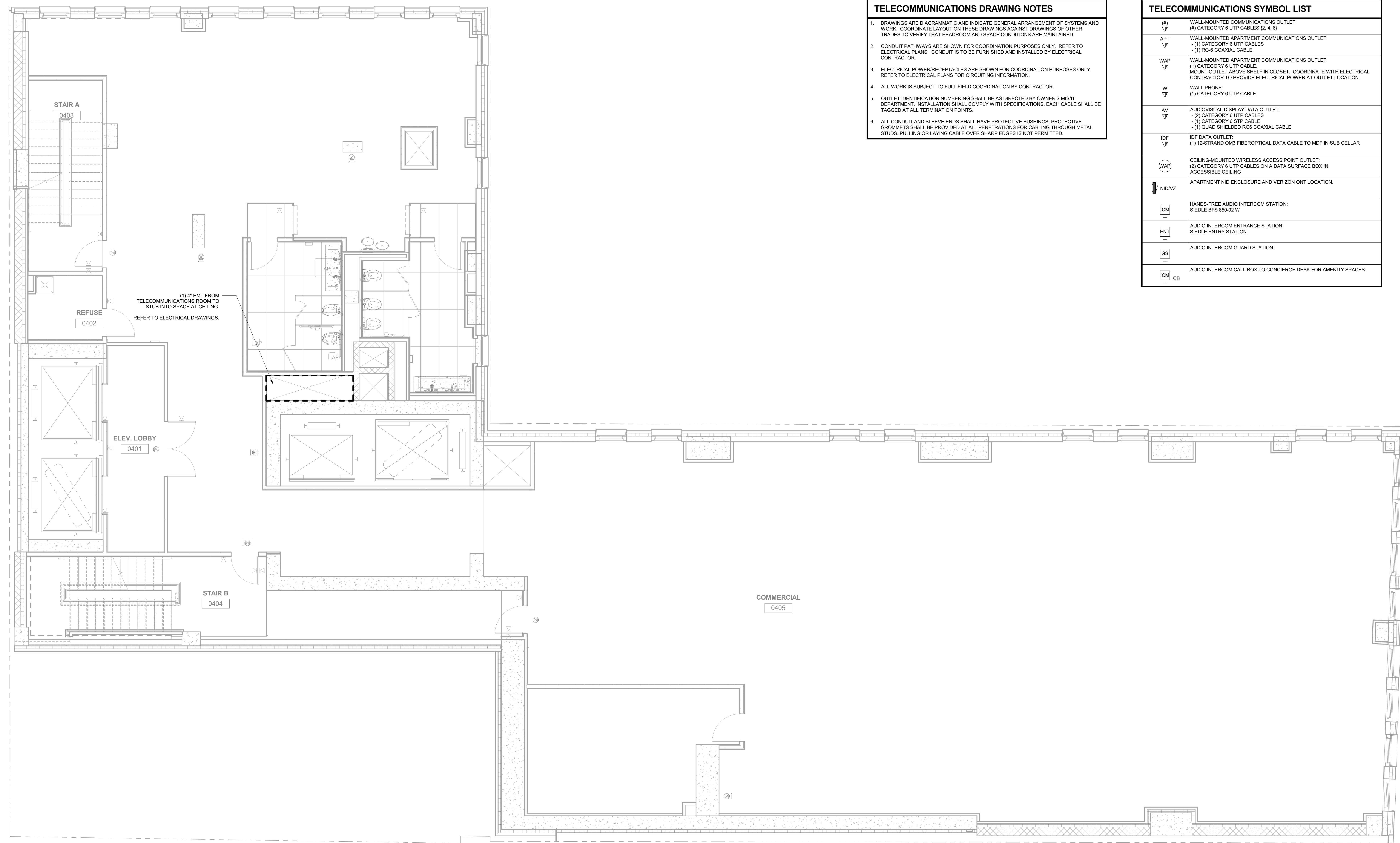

- TELECOMMUNICATIONS DRAWING NOTES**
- DRAWINGS ARE DIAGRAMMATIC AND INDICATE GENERAL ARRANGEMENT OF SYSTEMS AND WORK. COORDINATE LAYOUT ON THESE DRAWINGS AGAINST DRAWINGS OF OTHER TRADES TO VERIFY THAT HEADROOM AND SPACE CONDITIONS ARE MAINTAINED.
 - CONDUIT PATHWAYS ARE SHOWN FOR COORDINATION PURPOSES ONLY. REFER TO ELECTRICAL PLANS. CONDUIT IS TO BE FURNISHED AND INSTALLED BY ELECTRICAL CONTRACTOR.
 - ELECTRICAL POWER RECEPTACLES ARE SHOWN FOR COORDINATION PURPOSES ONLY. REFER TO ELECTRICAL PLANS FOR CIRCUITING INFORMATION.
 - ALL WORK IS SUBJECT TO FULL FIELD COORDINATION BY CONTRACTOR.
 - OUTLET IDENTIFICATION NUMBERING SHALL BE AS DIRECTED BY OWNER'S MSIT DEPARTMENT. INSTALLATION SHALL COMPLY WITH SPECIFICATIONS. EACH CABLE SHALL BE TAGGED AT ALL TERMINATION POINTS.
 - ALL CONDUIT AND SLEEVE ENDS SHALL HAVE PROTECTIVE BUSHINGS. PROTECTIVE GROMMETS SHALL BE PROVIDED AT ALL PENETRATIONS FOR CABLING THROUGH METAL STUDS. PULLING OR LAYING CABLE OVER SHARP EDGES IS NOT PERMITTED.

TELECOMMUNICATIONS SYMBOL LIST

(W)	WALL MOUNTED COMMUNICATIONS OUTLET: (9) CATEGORY 6 UTP CABLES (2, 4, 6)
APT	WALL MOUNTED APARTMENT COMMUNICATIONS OUTLET: (1) CATEGORY 6 UTP CABLES (1) RG-6 COAXIAL CABLE
WAP	WALL MOUNTED APARTMENT COMMUNICATIONS OUTLET: (1) CATEGORY 6 UTP CABLE MOUNT OUTLET ABOVE SHELF IN CLOSET. COORDINATE WITH ELECTRICAL CONTRACTOR TO PROVIDE ELECTRICAL POWER AT OUTLET LOCATION.
W	WALL PHONE: (1) CATEGORY 6 UTP CABLE
AV	AUDIOVISUAL DISPLAY DATA OUTLET: (2) CATEGORY 6 UTP CABLES (1) CATEGORY 6 STP CABLE (1) QUAD SHIELDED RG6 COAXIAL CABLE
IDF	IDF DATA OUTLET: (1) 15-STRAND OM3 FIBEROPTICAL DATA CABLE TO MDF IN SUB CELLAR
(WAP)	CEILING MOUNTED WIRELESS ACCESS POINT OUTLET: (2) CATEGORY 6 UTP CABLES ON A DATA SURFACE BOX IN ACCESSIBLE CEILING
NID/VZ	APARTMENT NID ENCLOSURE AND VERIZON ONT LOCATION.
ICM	HANDS-FREE AUDIO INTERCOM STATION: SIEDLE BFS 850-02 W
ENT	AUDIO INTERCOM ENTRANCE STATION: SIEDLE ENTRY STATION
GS	AUDIO INTERCOM GUARD STATION:
ICM CB	AUDIO INTERCOM CALL BOX TO CONCIERGE DESK FOR AMENITY SPACES:

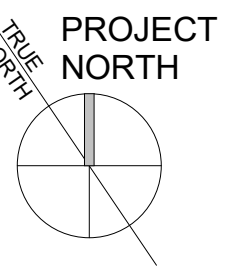

NO.	DATE	REVISIONS SUBMISSIONS	Rev. Δ
16			
15			
14			
13			
12			
11			
10			
9			
8			
7			
6			
5	06.28.2019	ISSUE FOR CONSTRUCTION	
4	05.31.2019	90% CONSTRUCTION DOCUMENTS (PROGRESS SUBMISSION)	
3	03.22.2019	PROGRESS PRINT (90% CONSTRUCTION DOCUMENTS)	
2	01.18.2019	DESIGN DEVELOPMENT	
1	06.22.2018	Schematic Design	

fxcollaborative

FXCollaborative Architects LLP | 22 West 19th Street | New York, NY 10011 | 212 627 1700 | fxcollaborative.com
SEVERUD
 460 Seventh Avenue, Suite 900, New York, NY 10018 212-668-3700
MG ENGINEERING D.P.C.
 116 West 32nd Street, New York, NY 10001 212-643-9005
LANGAN
 21 Park Place, 300 West 31st Street, 8th Floor, New York, NY 10001 212-479-5400
GILSANZ MURRAY STEFICEK LLP
 129 West 27th Street, Floor 5, New York, NY 10001 212-254-0030
INC Architecture & Design
 150 Varot Street, Floor 5 South, New York, NY 10013 212-673-1695
ONELUX Studio
 158 West 29th Street, 10th Floor, New York, NY 10001 212-201-9790
RKLA Studio
 333 Hudson Street, Suite 1001, New York, NY 10013 212-229-2534

185 Broadway
 New York, NY 10038

DRAWING TITLE:
4TH FLOOR TELECOMMUNICATIONS PLAN

Seal: _____ Drawn: _____ Project No.: _____
 Author: _____ 8126 00

Drawing No.: _____
 Scale: 05/22/18
 As indicated of

NEW YORK CITY ENERGY CONSERVATION CODE
 TO THE BEST OF MY KNOWLEDGE, BELIEF AND PROFESSIONAL JUDGMENT, THESE PLANS AND SPECIFICATIONS ARE IN COMPLIANCE WITH THE 2016 NEW YORK CITY ENERGY CONSERVATION CODE.

MGE
 Unified Technologies Corp.
 116 West 32nd Street, 12th Floor, New York, NY 10001
 P 212-643-9950 F 212-643-9923 www.mgecorp.net

TC-104.00

- TELECOMMUNICATIONS DRAWING NOTES**
- DRAWINGS ARE DIAGRAMMATIC AND INDICATE GENERAL ARRANGEMENT OF SYSTEMS AND WORK. COORDINATE LAYOUT ON THESE DRAWINGS AGAINST DRAWINGS OF OTHER TRADES TO VERIFY THAT HEADROOM AND SPACE CONDITIONS ARE MAINTAINED.
 - CONDUIT PATHWAYS ARE SHOWN FOR COORDINATION PURPOSES ONLY. REFER TO ELECTRICAL PLANS. CONDUIT IS TO BE FURNISHED AND INSTALLED BY ELECTRICAL CONTRACTOR.
 - ELECTRICAL POWER RECEPTACLES ARE SHOWN FOR COORDINATION PURPOSES ONLY. REFER TO ELECTRICAL PLANS FOR CIRCUITING INFORMATION.
 - ALL WORK IS SUBJECT TO FULL FIELD COORDINATION BY CONTRACTOR.
 - OUTLET IDENTIFICATION NUMBERING SHALL BE AS DIRECTED BY OWNER'S MS/IT DEPARTMENT. INSTALLATION SHALL COMPLY WITH SPECIFICATIONS. EACH CABLE SHALL BE TAGGED AT ALL TERMINATION POINTS.
 - ALL CONDUIT AND SLEEVE ENDS SHALL HAVE PROTECTIVE BUSHINGS. PROTECTIVE GROMMETS SHALL BE PROVIDED AT ALL PENETRATIONS FOR CABLES THROUGH METAL STUDS. PULLING OR LAYING CABLE OVER SHARP EDGES IS NOT PERMITTED.

TELECOMMUNICATIONS SYMBOL LIST

(W)	WALL-MOUNTED COMMUNICATIONS OUTLET: (#) CATEGORY 6 UTP CABLES (2, 4, 6)
APT	WALL-MOUNTED APARTMENT COMMUNICATIONS OUTLET: - (1) CATEGORY 6 UTP CABLES - (1) RG59 COAXIAL CABLE
WAP	WALL-MOUNTED APARTMENT COMMUNICATIONS OUTLET: (1) CATEGORY 6 UTP CABLE MOUNT OUTLET ABOVE SHELF IN CLOSET. COORDINATE WITH ELECTRICAL CONTRACTOR TO PROVIDE ELECTRICAL POWER AT OUTLET LOCATION.
W	WALL PHONE: (1) CATEGORY 6 UTP CABLE
AV	AUDIOVISUAL DISPLAY DATA OUTLET: - (2) CATEGORY 6 UTP CABLES - (1) CATEGORY 6 STP CABLE - (1) QUAD SHIELDED RG6 COAXIAL CABLE
IDF	IDF DATA OUTLET: (1) 12-STRAND OM3 FIBEROPTICAL DATA CABLE TO MDF IN SUB CELLAR
(WAP)	CEILING-MOUNTED WIRELESS ACCESS POINT OUTLET: (2) CATEGORY 6 UTP CABLES ON A DATA SURFACE BOX IN ACCESSIBLE CEILING
NID/VZ	APARTMENT NID ENCLOSURE AND VERIZON ONT LOCATION
ICM	HANDS-FREE AUDIO INTERCOM STATION: SIEDLE BFS 850-02 W
ENT	AUDIO INTERCOM ENTRANCE STATION: SIEDLE ENTRY STATION
GS	AUDIO INTERCOM GUARD STATION
ICM CB	AUDIO INTERCOM CALL BOX TO CONCERGE DESK FOR AMENITY SPACES

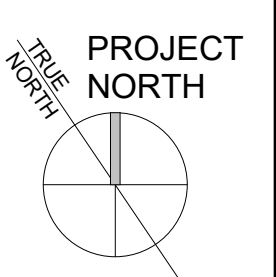
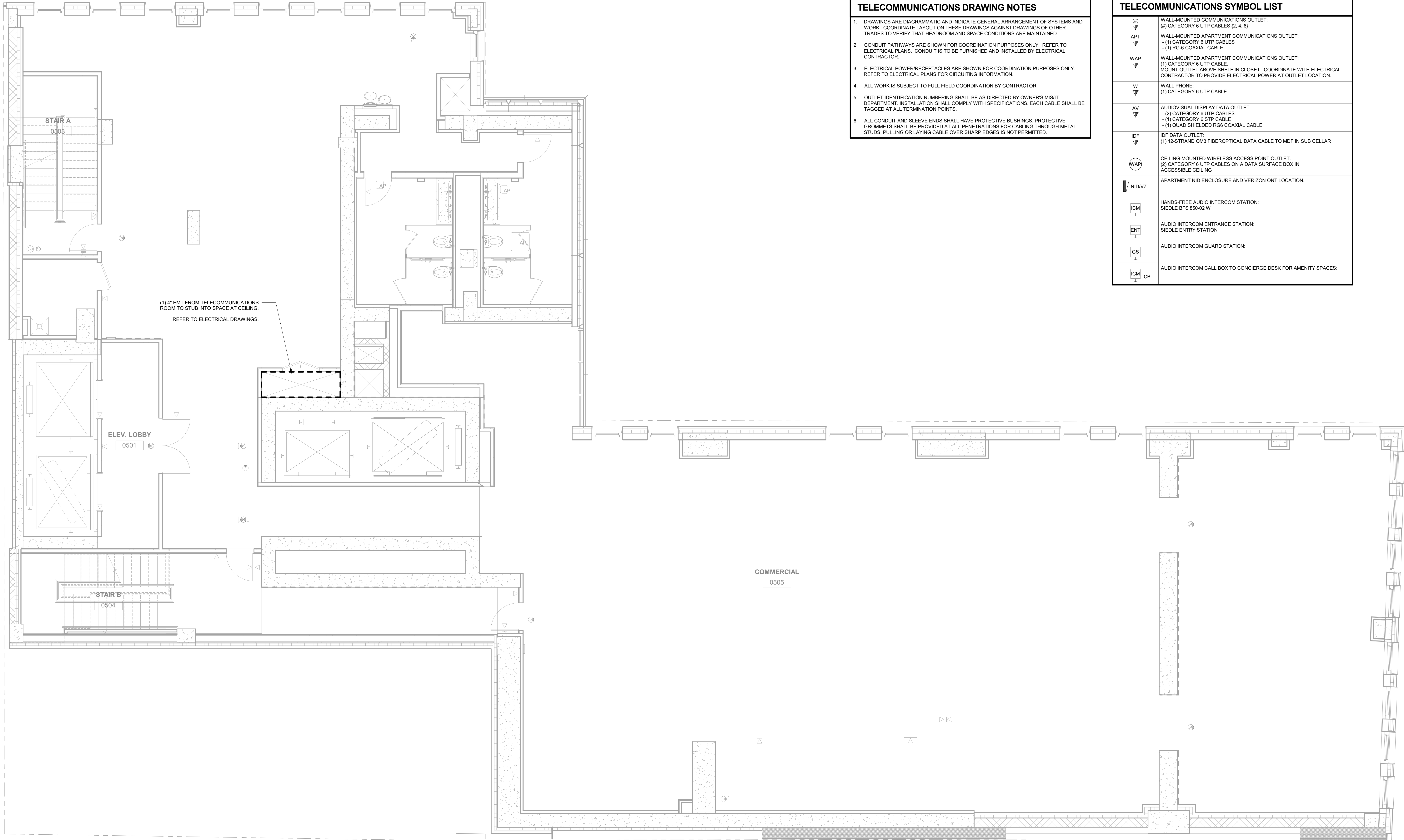

NO.	DATE	REVISIONS / SUBMISSIONS	Rev.
16			
15			
14			
13			
12			
11			
10			
9			
8			
7			
6			
5	06.28.2019	ISSUE FOR CONSTRUCTION	
4	05.31.2019	90% CONSTRUCTION DOCUMENTS (PROGRESS SUBMISSION)	
3	03.22.2019	PROGRESS PRINT (90% CONSTRUCTION DOCUMENTS)	
2	01.18.2019	DESIGN DEVELOPMENT	
1	06.22.2018	Schematic Design	

fxcollaborative

FXCollaborative Architects LLP | 22 West 19th Street | New York, NY 10011 | 212 627 1700 | fxcollaborative.com
SEVERUD
 469 Seventh Avenue, Suite 900, New York, NY 10018 212-686-3700
MG ENGINEERING D.P.C.
 116 West 32nd Street, New York, NY 10001 212-643-9005
LANGAN
 21 Park Place, 300 West 31st Street, 8th Floor, New York, NY 10001 212-479-5400
GILSANZ MURRAY STEFICEK LLP
 129 West 27th Street, Floor 5, New York, NY 10001 212-254-0030
INC Architecture & Design
 150 Varot Street, Floor 5 South, New York, NY 10013 212-673-1695
ONELUX Studio
 158 West 29th Street, 10th Floor, New York, NY 10001 212-201-9790
RKLA Studio
 333 Hudson Street, Suite 1001, New York, NY 10013 212-229-2534

185 Broadway
 New York, NY 10038

DRAWING TITLE:
5TH FLOOR TELECOMMUNICATIONS PLAN

Seal: _____ Drawn: _____ Project No.: _____
 Author: _____ 8126 00

Drawing No.: _____
 05/23/18
 Scale: _____
 As indicated of _____

NEW YORK CITY ENERGY CONSERVATION CODE
 TO THE BEST OF MY KNOWLEDGE, BELIEF AND PROFESSIONAL JUDGMENT, THESE PLANS AND SPECIFICATIONS ARE IN COMPLIANCE WITH THE 2016 NEW YORK CITY ENERGY CONSERVATION CODE.



TC-105.00