

REINTRODUCING

THE RETAIL AT THE BUCHANAN

770 Third Avenue | New York, NY 10017

ENTIRE WEST BLOCK BETWEEN EAST 47TH & 48TH STREETS



EXCLUSIVE RETAIL LEASING

KATZ & ASSOCIATES

RETAIL REAL ESTATE ADVISORS

Property Overview

HIGHLIGHTS

- Entire west block between East 47th and 48th Streets
- At the base of The Buchanan, a luxury 286 unit residential building
- New glass façade installed
- All non-competing uses considered
- Space B can be vented through precipitatory
- Spaces can be combined if necessary

POSSESSION
Immediate

TERM
Long Term

CEILINGS
9' - 18'

NEIGHBORS

- Sea Fire Grill
- Chop't
- Rosemary's
- Avra
- Le Pain Quotidien
- Citibank
- Wonder
- Walgreens
- Just Salad
- Dumpling General (coming soon)
- CVS Pharmacy
- 10000 Coffee
- Serafina Express
- The Lexington Hotel
- Super Runners Shop
- Bank of America
- Smith & Wollensky

DEMOGRAPHICS	0.25 Mile	0.5 Mile	0.75 Mile
POPULATION	12,752	45,355	94,740
HOUSEHOLDS	7,900	28,276	58,316
EMPLOYEES	115,651	397,809	633,806
AVERAGE HH INCOME	\$202,477	\$213,196	\$222,822



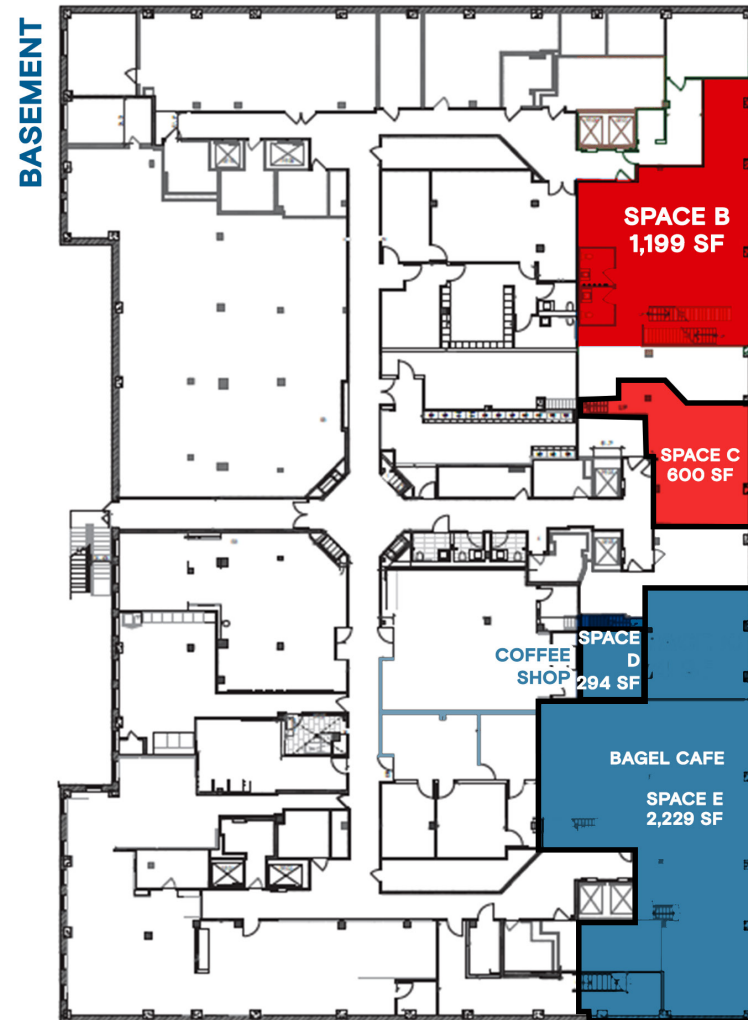
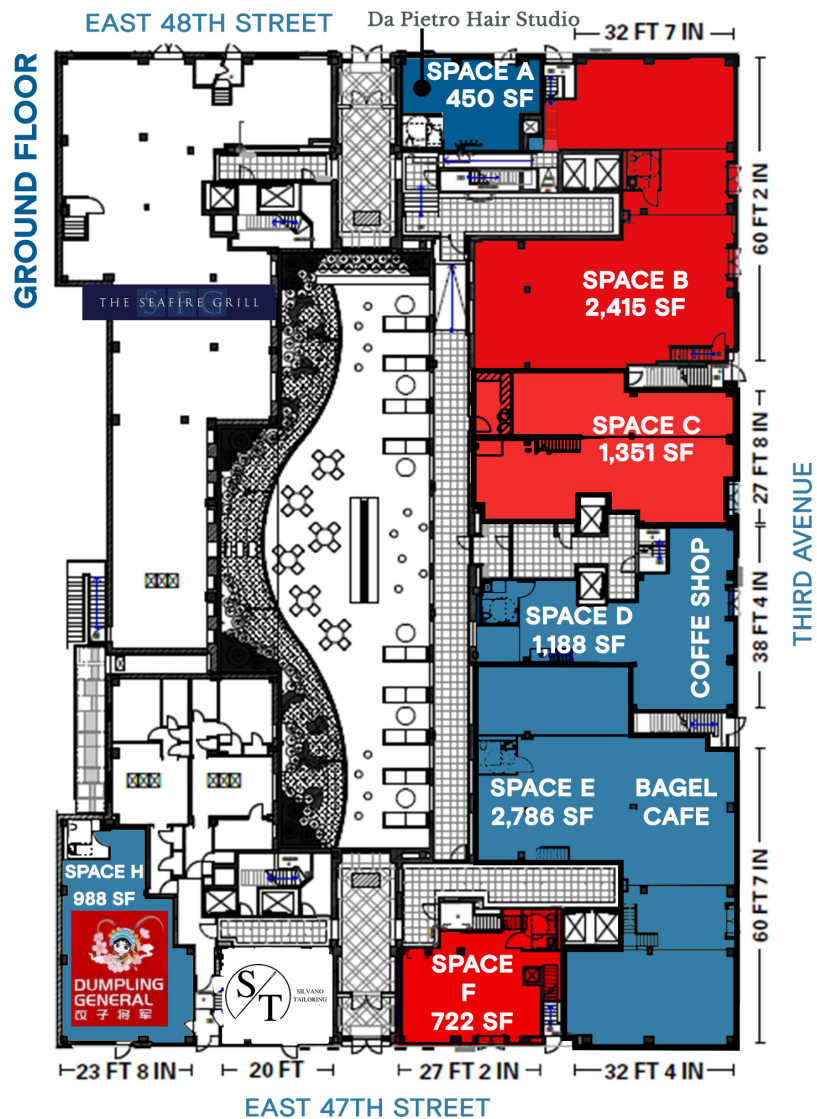

SPACE	GROUND SF	LOWER LEVEL SF	COMBINED SF	STATUS
Space A	450		450	Leased Open - DaPietra Hair Studio
Space B	2,415	1,199	3,614	Vacant
Space C	1,351	600	1,951	Vacant
Space D	1,188	294	1,482	Leased
Space E	2,786	2,229	5,015	Leased
Space F	722		722	Vacant
Space H	988		988	Leased Not Open - Dumpling General

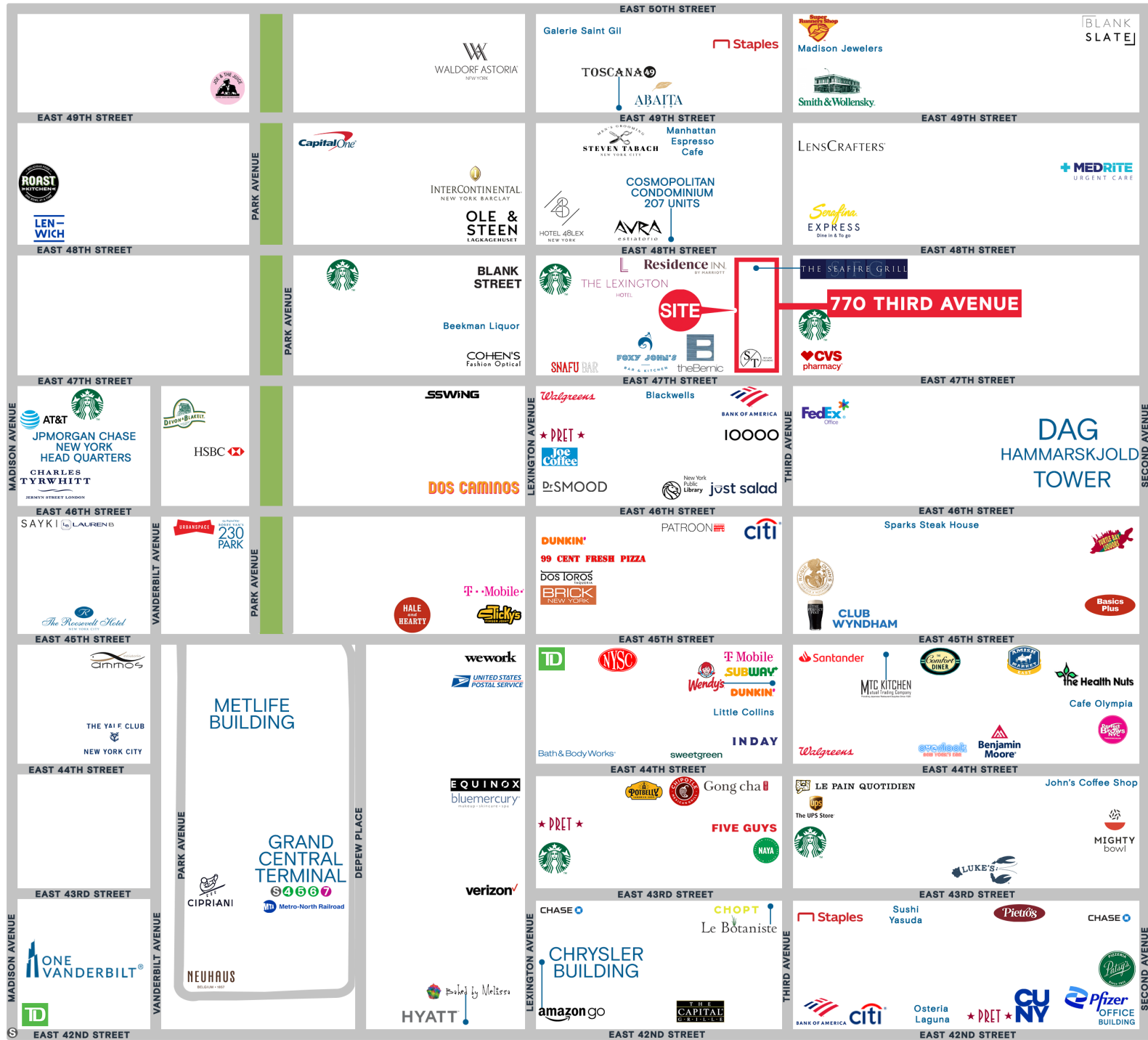



For More Information
Please Contact
Exclusive Brokers:

Daniel D. DePasquale
VICE PRESIDENT
ddd@katzretail.com
212.257.4996

David Yablon
DIRECTOR
davidyablon@katzretail.com
Call/Text 212.433.1986



KATZ & ASSOCIATES

RETAIL REAL ESTATE ADVISORS

katzretail.com

The information herein was obtained from third parties and has not been independently verified by Katz & Associates. Any and all interested parties should have their choice of experts inspect the property and verify all information. Katz & Associates makes no warranties or guarantees as to the information given to any prospective buyer or tenant. REV: 10.15.25