



AVAILABLE FOR LEASE

# SOUTHPORT

3600 E UNIVERSITY DRIVE | PHOENIX, AZ  
INDUSTRIAL, FLEX, OFFICE

The  
INITIAL  
DEVELOPMENT  
Company



CUSHMAN &  
WAKEFIELD

# SOUTHPORT

3600 EAST UNIVERSITY DRIVE | PHOENIX, AZ



# SOUTHPORT

3600 EAST UNIVERSITY DRIVE | PHOENIX, AZ

## PROPERTY FEATURES BUILDING B

Suite Size:	±21,713 SF
Cooling:	HVAC
Parking:	6 / 1,000 (Expandable)
Zoning:	A-2

LEASED

LEASED

## BUILDING B ±21,713 SF

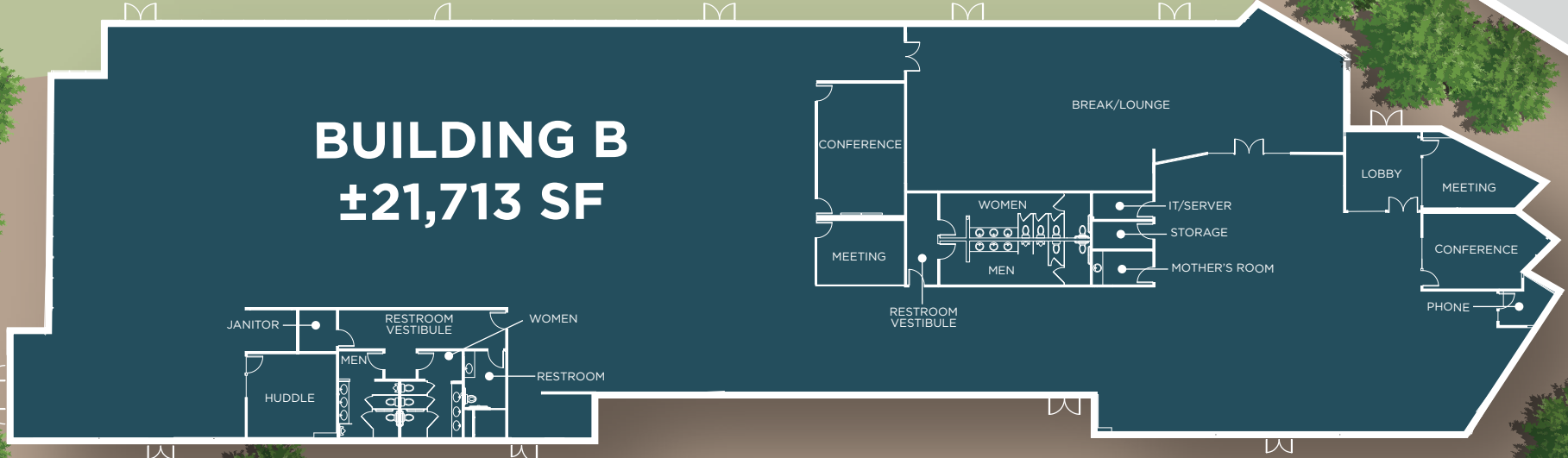



# SOUTHPORT

3600 EAST UNIVERSITY DRIVE | PHOENIX, AZ

LEASED

LEASED

## PROPERTY FEATURES BUILDING E

<b>Suite Size:</b>	±19,722 SF (Divisible)
<b>Clear Height:</b>	16'
<b>Cooling:</b>	HVAC
<b>Parking:</b>	6 / 1,000 (Expandable)
<b>Zoning:</b>	A-2
<b>Loading:</b>	(2) Grade Level Doors

**BUILDING E**  
**±19,722 SF**  
**(Divisible)**

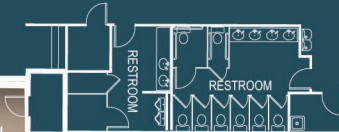

GRADE LEVEL  
DOOR

GRADE LEVEL  
DOOR

# SOUTHPORT

3600 EAST UNIVERSITY DRIVE | PHOENIX, AZ

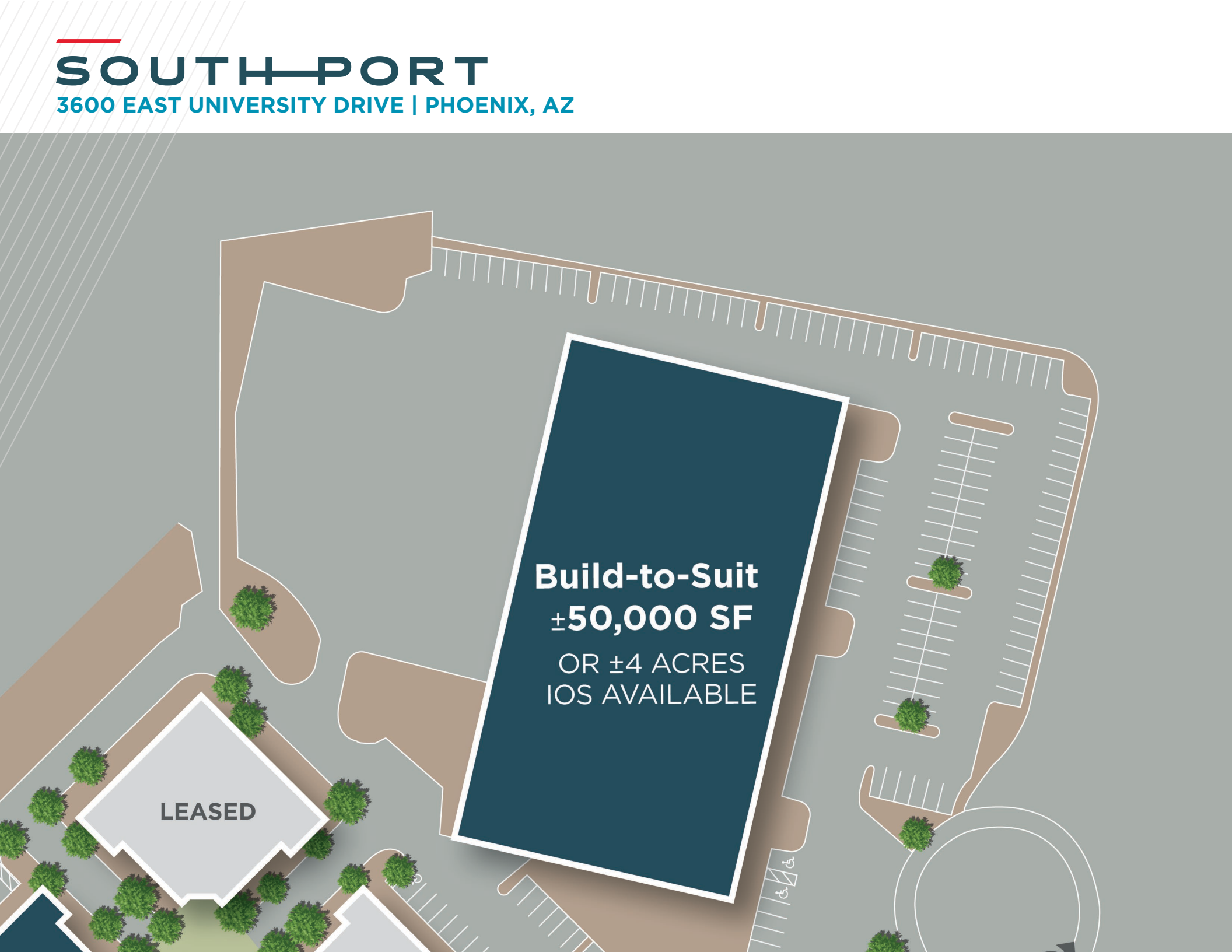

The image is a site plan for a property at 3600 East University Drive in Phoenix, AZ. It features a large dark blue rectangular area in the center, outlined in white, which is labeled 'Build-to-Suit ±50,000 SF OR ±4 ACRES IOS AVAILABLE'. To the left of this area is a light gray irregularly shaped area labeled 'LEASED'. The plan also shows a parking lot with several rows of parking spaces, some trees, and a circular driveway or road on the right side. The background is a light gray color with some faint white lines.

**Build-to-Suit**  
**±50,000 SF**  
OR ±4 ACRES  
IOS AVAILABLE

**LEASED**

# SOUTHPORT

3600 EAST UNIVERSITY DRIVE | PHOENIX, AZ





**FOR MORE INFORMATION, CONTACT:**

**JUSTIN SMITH**

Director  
+1 602 586 5938  
justin.p.smith@cushwake.com

**PATRICK SCHRIMSHER**

Director  
+1 602 468 8529  
patrick.schrimsher@cushwake.com

**MIKE HAENEL**

Executive Vice Chair  
+1 602 224 4404  
michael.haenel@cushwake.com

**FOSTER BUNDY**

Senior Director  
+1 602 229 5919  
foster.bundy@cushwake.com

**PHIL HAENEL**

Executive Vice Chair  
+1 602 224 4409  
phil.haenel@cushwake.com

©2026 Cushman & Wakefield. All rights reserved. The information contained in this communication is strictly confidential. This information has been obtained from sources believed to be reliable but has not been verified. NO WARRANTY OR REPRESENTATION, EXPRESS OR IMPLIED, IS MADE AS TO THE CONDITION OF THE PROPERTY (OR PROPERTIES) REFERENCED HEREIN OR AS TO THE ACCURACY OR COMPLETENESS OF THE INFORMATION CONTAINED HEREIN, AND SAME IS SUBMITTED SUBJECT TO ERRORS, OMISSIONS, CHANGE OF PRICE, RENTAL OR OTHER CONDITIONS, WITHDRAWAL WITHOUT NOTICE, AND TO ANY SPECIAL LISTING CONDITIONS IMPOSED BY THE PROPERTY OWNER(S). ANY PROJECTIONS, OPINIONS OR ESTIMATES ARE SUBJECT TO UNCERTAINTY AND DO NOT SIGNIFY CURRENT OR FUTURE PROPERTY PERFORMANCE. [PD-153602] V18

