

FOR SALE/BUILD TO SUIT

UP TO 10,000 SF BUILDING PAD SITE

9002 Brook Rd | Glen Allen, VA 23060



S.L. NUSBAUM
REALTY CO.



ANDREW THACKER

Vice President

O. 804.320.7600

C. 804.357.6075

athacker@slnusbaum.com

NATHAN SHOR

Senior Vice President | Partner

O. 804.944.2399

C. 804.539.7404

nshor@slnusbaum.com

PROUD PARTNER

XTEAM
RETAIL ADVISORS

PROPERTY SUMMARY

UP TO 10,000 SF BUILDING PAD SITE

9002 Brook Rd | Glen Allen, VA 23060



S.L. NUSBAUM

REALTY CO.

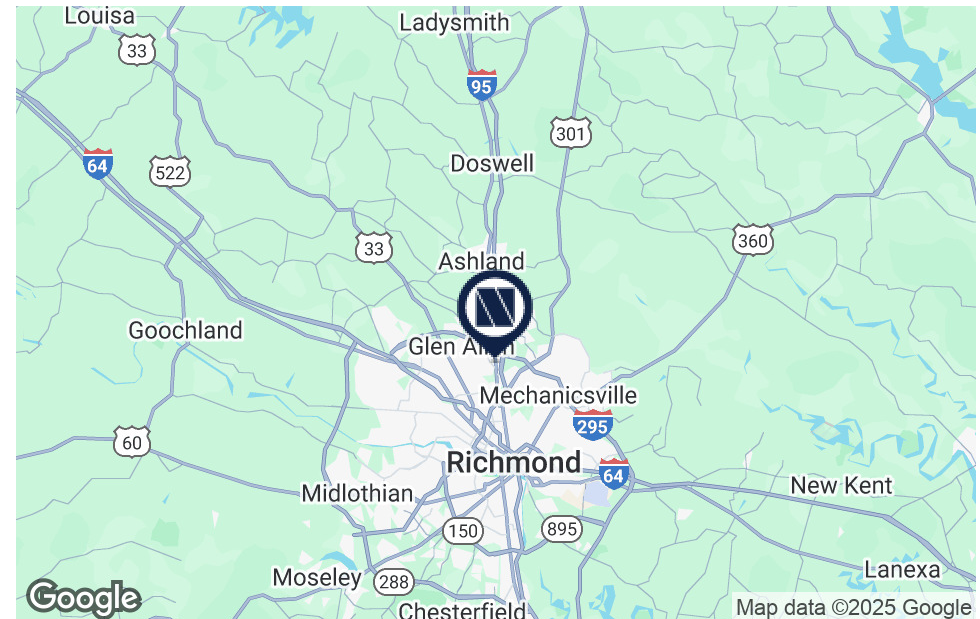
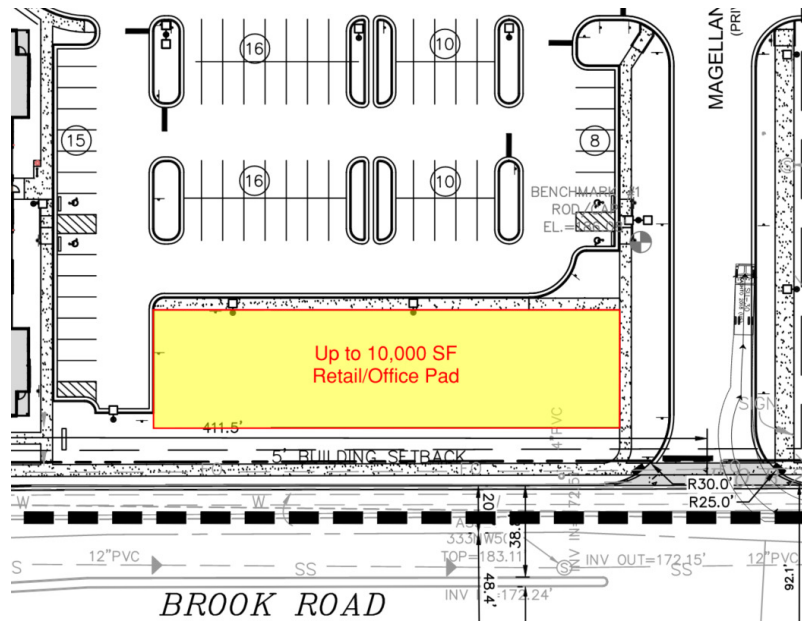

OFFERING SUMMARY

Sale Price: Contact Agents

Building Size: Up to 10,000 SF
with existing parking field

Zoning: Mixed Use R-6C

Plans for GreenCity Site

Henrico Sports & Events Center

DEMOGRAPHICS	1 MILE	3 MILES	5 MILES
Total Population	6,419	52,161	153,047
Daytime Population	6,432	52,609	178,865
Total Households	2,629	21,555	63,662
Average HH Income	\$97,407	\$103,109	\$114,731

PROPERTY OVERVIEW

Pad site with existing parking field in new mixed-use development in Glen Allen. Strategically located along US Rt 1/Brook Rd, with excellent visibility and accessibility to the Greater Richmond MSA.

PROPERTY HIGHLIGHTS

- Part of The Brook - 310 residential units (apartments & townhomes)
- Easy access, ±0.7 miles to I-295 & 1.2 miles to I-95 Exit 86 (Atlee/Elmont)
- As part of its comprehensive plans, Henrico County is extending Magellan Parkway across I-95 to GreenCity.
- The Brook is situated at a major intersection with direct access to the new ecodistrict.
- The site is located in a rapid growth area for high density residential

CONCEPTUAL RENDERING

UP TO 10,000 SF BUILDING PAD SITE

9002 Brook Rd | Glen Allen, VA 23060



S.L. NUSBAUM
REALTY CO.

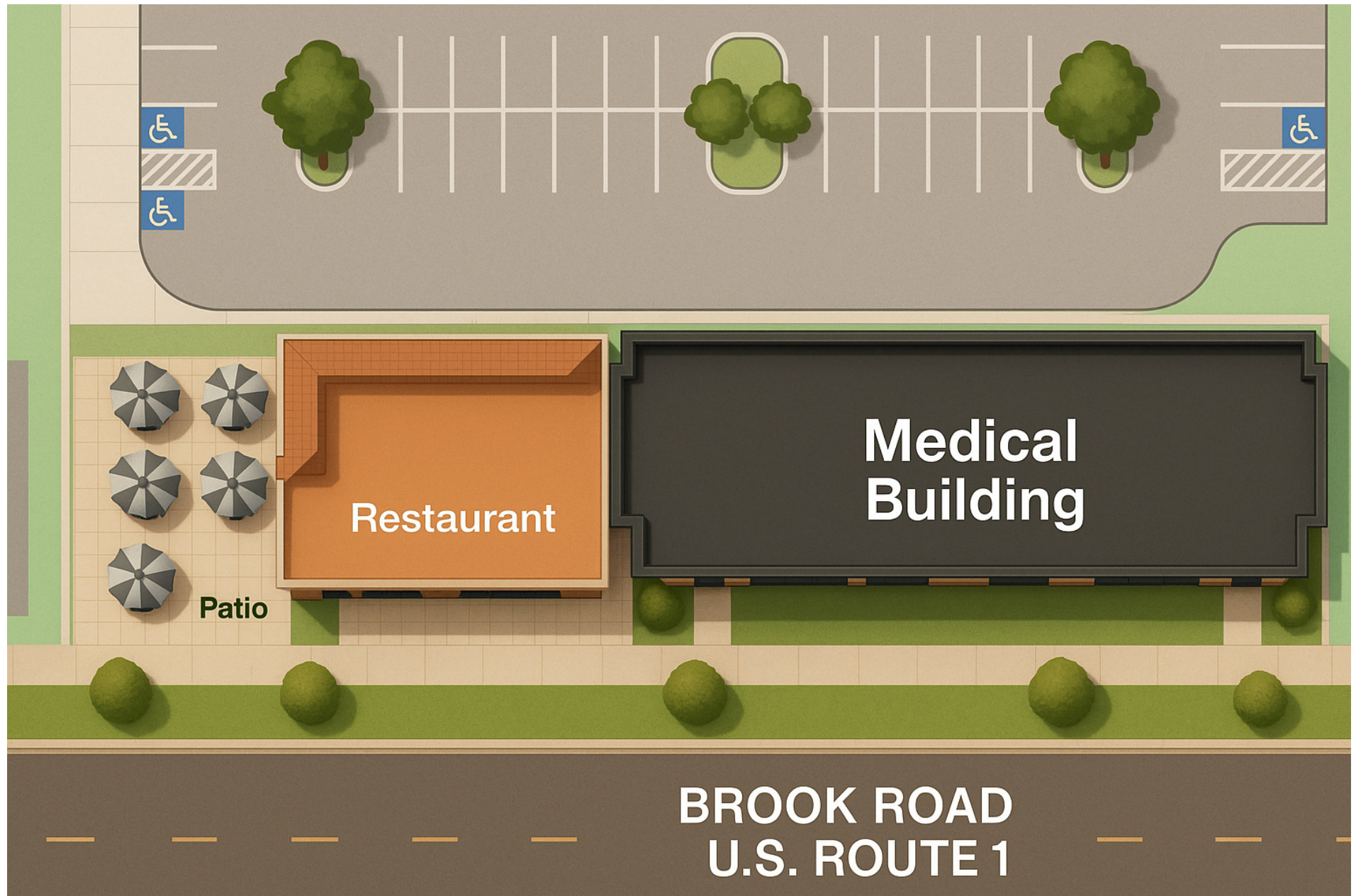

TRANSFORMING RT 1/I-95 CORRIDOR

UP TO 10,000 SF BUILDING PAD SITE

9002 Brook Rd | Glen Allen, VA 23060



S.L. NUSBAUM
REALTY CO.

GreenCity - Just 0.7 miles from the site, a \$2.3 billion, 204-acre 'ecodistrict' mixed-use project is planned, featuring 880 new residential units along with a major arena-anchored development. Henrico County is extending Magellan Parkway to connect GreenCity to Brook Road at the entrance of the site.

Retreat at One - Across the street from the site, Stanley Martin is under construction on a new 606-unit for-sale community. This development has a mix of two-story condos and townhomes as well as a commercial pad.

Virginia Center Commons - A 775,000 SF mall is actively being redeveloped to include a new sports complex, convention center, retail, 525 townhomes and 830 apartments.

River Mill - The original 250-acre project includes 300 townhomes, 285 apartments, 50 single-family homes and 400 zero-lot-line homes. They have recently expanded the development to add an additional 57 townhomes.



TRADE AREA

UP TO 10,000 SF BUILDING PAD SITE

9002 Brook Rd | Glen Allen, VA 23060



S.L. NUSBAUM
REALTY CO.



CONTACT INFORMATION

UP TO 10,000 SF BUILDING PAD SITE
9002 Brook Rd | Glen Allen, VA 23060



S.L. NUSBAUM
REALTY CO.

ANDREW THACKER

Vice President
C. 804.357.6075
O. 804.320.7600
athacker@slnusbaum.com

NATHAN SHOR

Senior Vice President | Partner
C. 804.539.7404
O. 804.944.2399
nshor@slnusbaum.com

COMMITMENT. INTEGRITY. EXCELLENCE. SINCE 1906.

Serving the Southeast and Mid-Atlantic region for well over a century, S.L. Nusbaum Realty Co. continues to provide a comprehensive experience for our clients and customers in all aspects of the multifamily and commercial real estate industry.

[CLICK HERE TO LEARN MORE](#)

PROUD PARTNER

XTEAM
RETAIL ADVISORS

[CLICK HERE TO LEARN MORE](#)

DISCLAIMER:

No warranty or representation, expressed or implied, is made to the accuracy or completeness of the information contained herein, and same is submitted subject to errors, omissions, change of price, rental or other conditions, withdrawal without notice, and to any special listing conditions imposed by the property owner(s). As applicable, we make no representation as to the condition of the property (or properties) in question or the property's (or properties') compliance with applicable laws, regulations, and codes.