



515 STONECREST BLVD.
SMYRNA, TENNESSEE 37167

SITE FEATURES

- First Floor Suite
- Private Side Entrance/Exit Door
- Available now
- Located just off the I-24 exit
- Across the street from TriStar Stonecrest Medical Center

ADDITIONAL INFORMATION:

Sharon Greaves, CCIM
(o) 615-701-2940
(c) 615-585-3004
SGREAVES@MOMENTUMCRES.COM

Floor Plan / Location

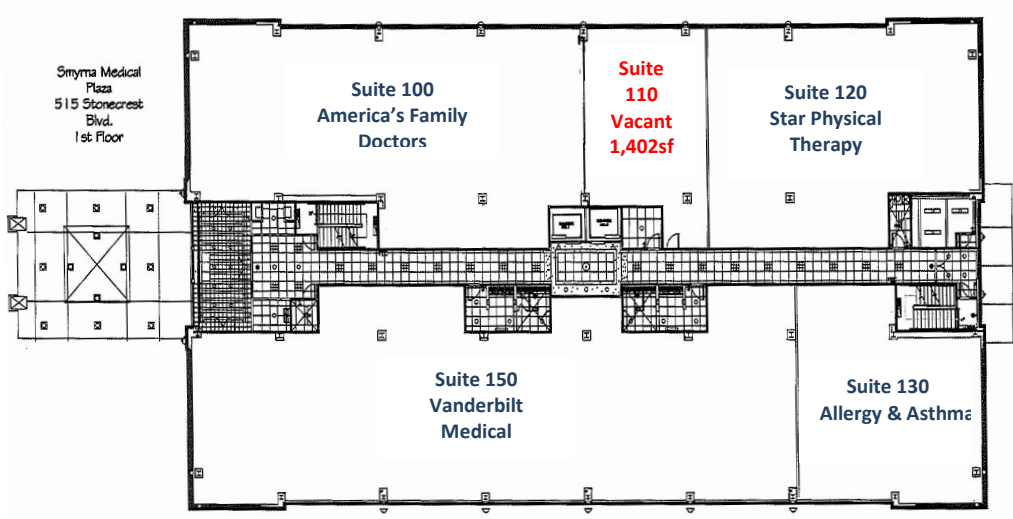

SECOND FLOOR

- Suite 200 Dermatology
- Suite 210 Advancing Vision
- Suite 220 Nelson Endodontics
- Suite 230 The Surgery Center
- Suite 240 Hardison Oral Surgeon
- Suite 250 Southern Orthodontic

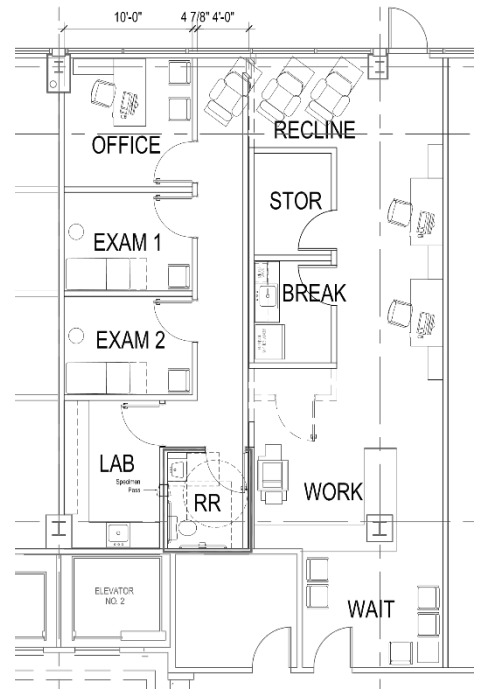

2055 N. Mount Juliet Rd
 Suite 205
 Mount Juliet, Tennessee 37122
www.momentumcres.com