 **JLL** SEE A BRIGHTER WAY

For Sublease

Discovery Place
3605 Gilmore Way
Burnaby, BC

Darrell Hurst

Executive Vice President

darrell.hurst@jll.com

+1 604 998 6042

Fraser Hurst

Senior Associate

fraser.hurst@jll.com

+1 604 998 6002

SALIENT DETAILS

Suite	320	Basic Rent	Contact listing brokers
Size	8,456 s.f.	Additional Rent	\$25.13 (2026)
Availability	June 2026 (to be negotiated)	Parking	Approx 20 stalls
Sublease Expiry	May 31, 2027	Furniture	Available (to be negotiated)

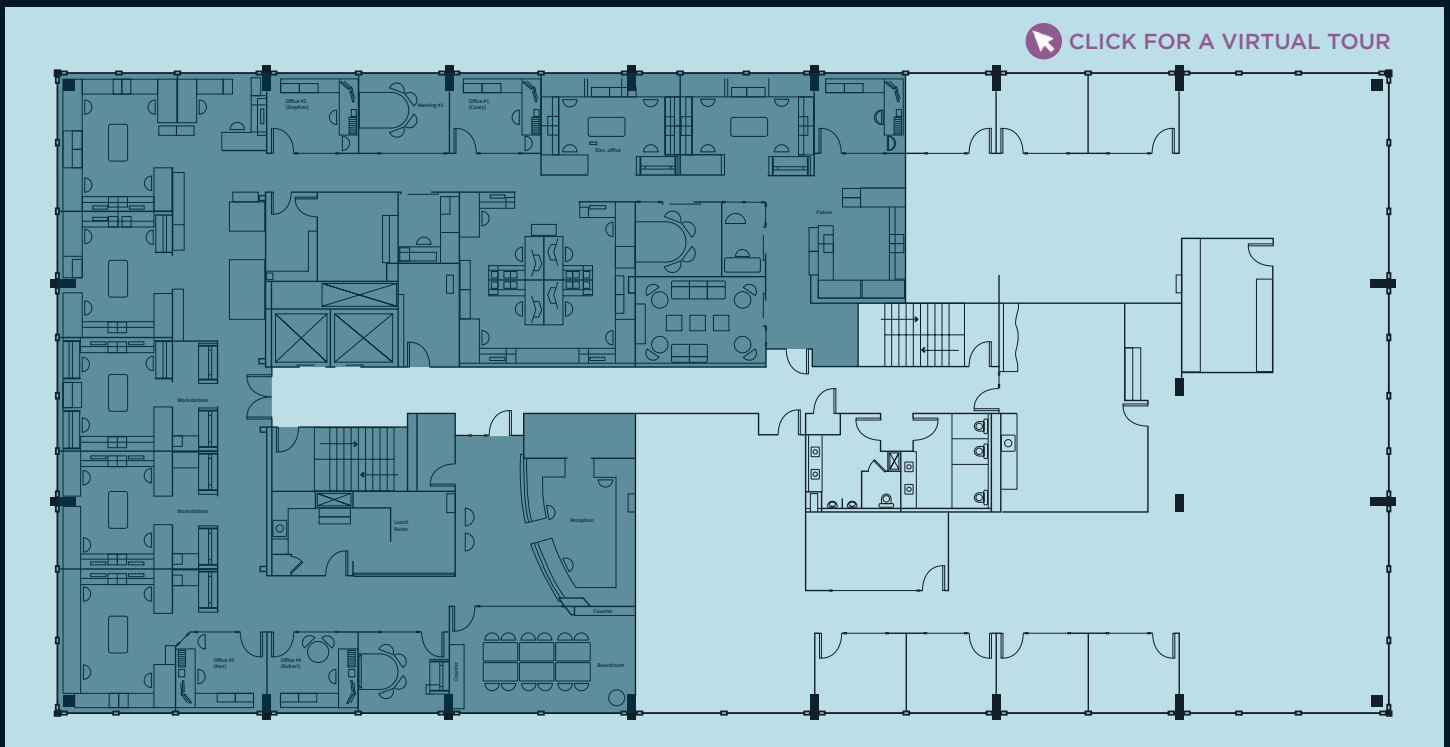



THE LOCATION

Located in the heart of Burnaby, 3605 Gilmore Way features a high-quality work environment complete with opening windows, bicycle storage, showers, jogging trails, tenant lounge and a large common meeting room.

BUILDING AMENITIES



Fitness Facility



End-of-trip Facilities



Bike Lockers



Common Boardroom



Secure Underground Parking



Tenant Lounge



24-7 Building Security

