

**Towns Edge Business Center
2 Enterprise Ave NE; Isanti, MN 55040**



- 24,800 SF
- Available Suites:
 - A4 – 6371 SF
- Built In 2006
- Single Phase Power
- 40 Shared Parking Spaces
- Efficient in-floor heat
- 1 – 12ft high drive-in overhead door
- 16ft ceiling height
- \$9.75 SF NNN
- 2025 CAM \$3.17
- 2025 Taxes: \$1.37sf

Contact:

Nik Anderson
COMMERCIAL AGENT

651.497.7222 direct 763.689.0349 office 763.552.5754 fax

Nik@ricproperty.com

Contact:

Matt Anderson
COMMERCIAL BROKER

612.327.2977 direct 763.689.0349 office 763.552.5754 fax

Matt@ricproperty.com

Although the information contained herein is based upon sources believed to be reasonably reliable, Owner and Broker, on their own behalf of their respective officers, employees, shareholders, partners, directors, members and affiliates, or any other affiliated party, disclaim any responsibility or liability for inaccuracies, representations and warranties (expressed or implied) contained in, or omitted from, this information or any other written or oral communication or information transmitted or made available to the recipient.

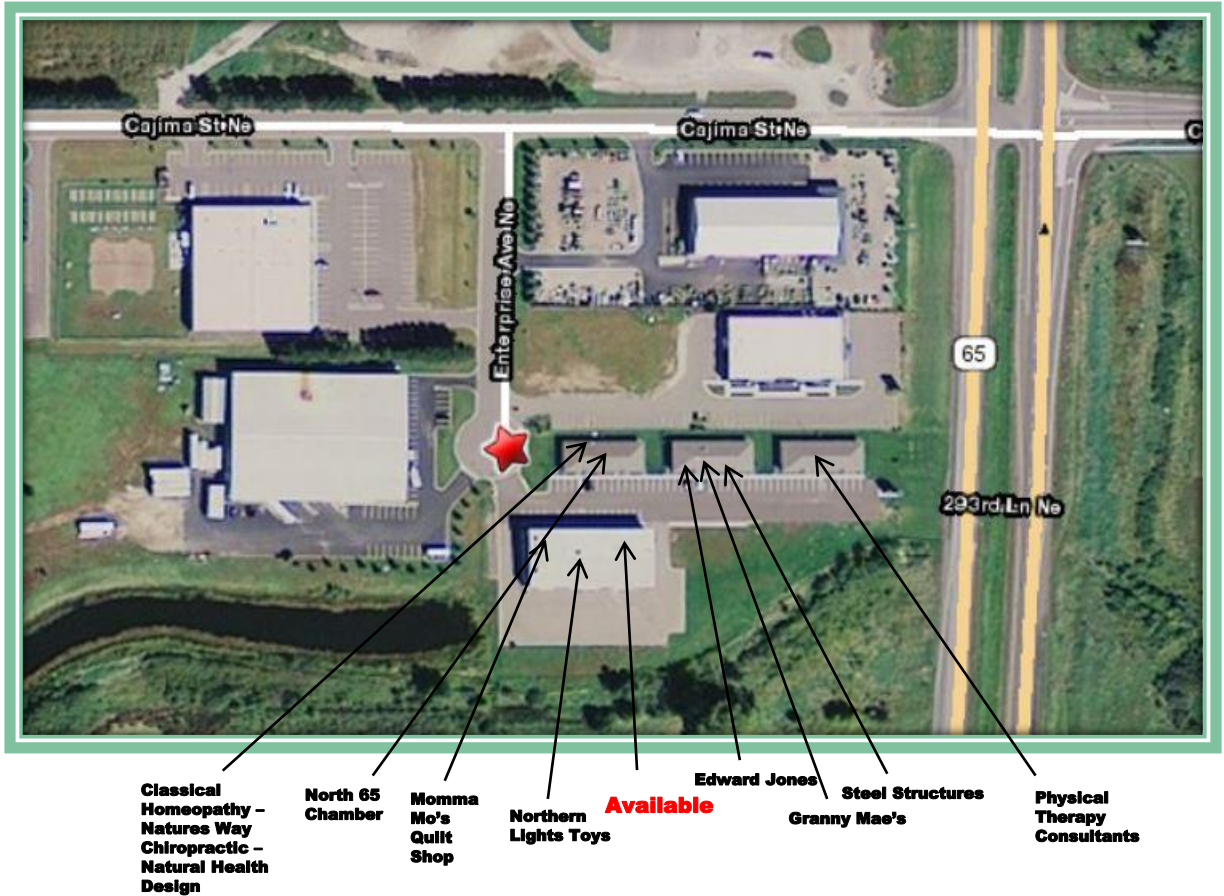

Local Retail

Contact:

Nik Anderson
COMMERCIAL AGENT

651.497.7222 direct 763.689.0349 office 763.552.5754 fax
Nik@ricproperty.com

Contact:

Matt Anderson
COMMERCIAL BROKER

612.327.2977 direct 763.689.0349 office 763.552.5754 fax
Matt@ricproperty.com

Floor Plans

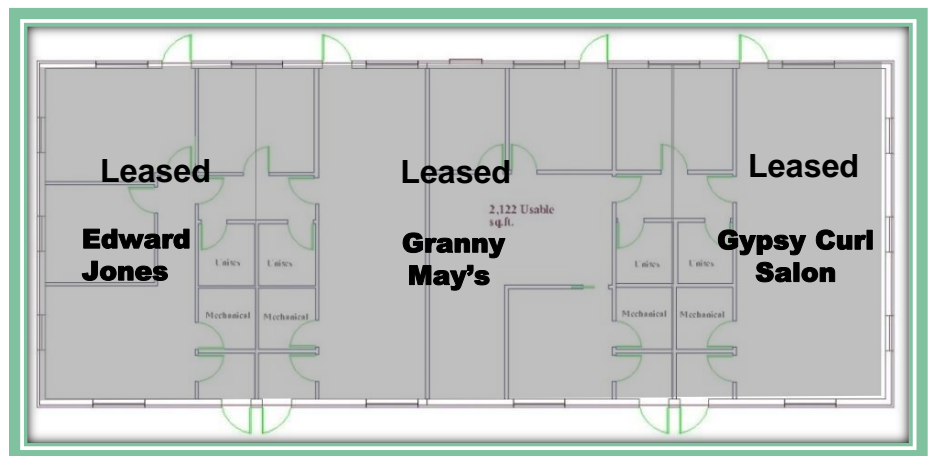
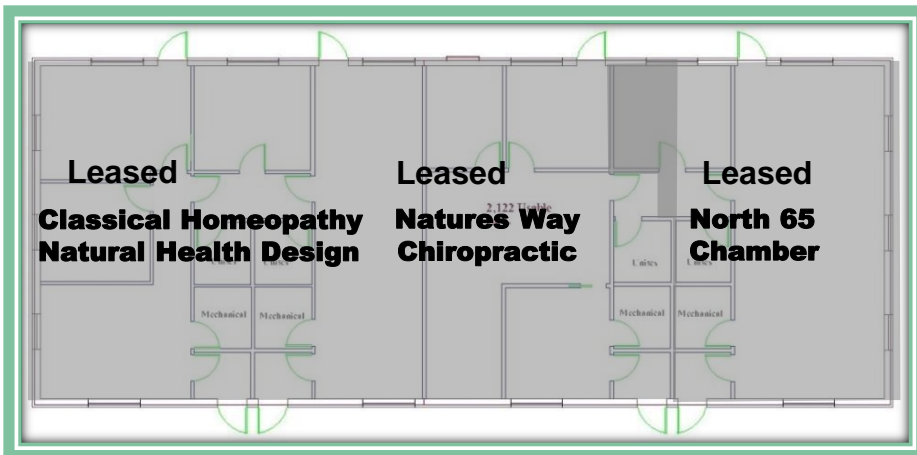
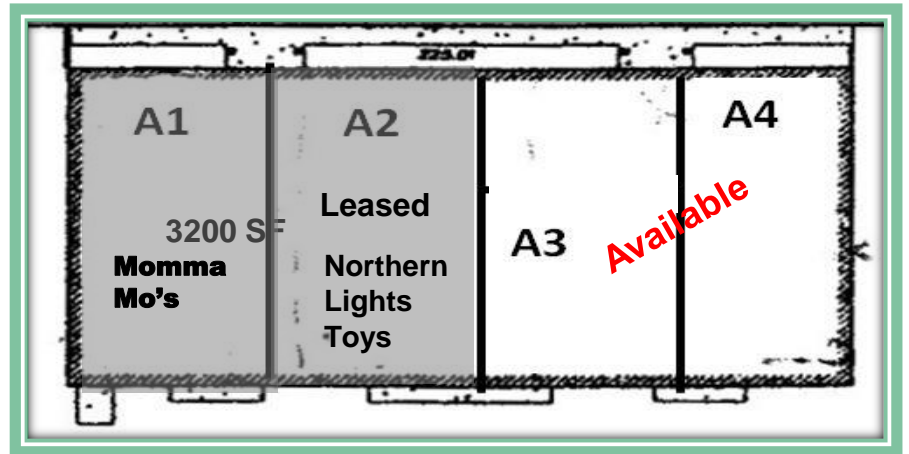

Contact:

Nik Anderson
COMMERCIAL AGENT

651.497.7222 direct 763.689.0349 office 763.552.5754 fax

Nik@ricproperty.com

Contact:

Matt Anderson
COMMERCIAL BROKER

612.327.2977 direct 763.689.0349 office 763.552.5754 fax

Matt@ricproperty.com



DEMOGRAPHICS

	3 MILES	5 MILES	10 MILES
POPULATION	9,006	17,866	50,201
MEDIAN HH INCOME	\$73,693	\$73,272	\$76,534

TRAFFIC COUNTS

HWY 65 AT COUNTY RD 5	18,900 CARS PER DAY
COUNTY RD 5 AT DUAL BLVD	1050-1550 CARS PER DAY
HWY 65 AT CAJIMA	18,900 CARS PER DAY

Contact:

Nik Anderson
COMMERCIAL AGENT

651.497.7222 direct 763.689.0349 office 763.552.5754 fax
Nik@ricproperty.com

Contact:

Matt Anderson
COMMERCIAL BROKER

612.327.2977 direct 763.689.0349 office 763.552.5754 fax
Matt@ricproperty.com

Although the information contained herein is based upon sources believed to be reasonably reliable, Owner and Broker, on their own behalf of their respective officers, employees, shareholders, partners, directors, members and affiliates, or any other affiliated party, disclaim any responsibility or liability for inaccuracies, representations and warranties (expressed or implied) contained in, or omitted from, this information or any other written or oral communication or information transmitted or made available to the recipient.

