

# FOR SALE

±13,171 SF OFFICE/WAREHOUSE MANUFACTURING BUILDING ON ±0.78 ACRES | 100% A/C



**CBRE**

6825 W FRYE RD | CHANDLER, AZ



# PROPERTY HIGHLIGHTS

**6825 W. Frye Road is located within San Tan Technology Park, offering strategic access to I-10 and Loop-202 .**

- + ±13,171 SF office/warehouse building on ±0.78 acres
- + 21' clear height
- + 100% A/C
- + Two grade level loading doors
- + One truckwell
- + 600 amps 277/480v
- + 10 year roof warranty
- + Power and compressed air lines distributed throughout warehouse
- + Exhaust system in warehouse
- + Zoning PAD, City of Chandler
- + Existing tenant leasing until Q4 2026
- + Call for pricing

**FOR SALE**

**±13,171**

Total SF on ±0.78 acres



# FLOOR PLAN

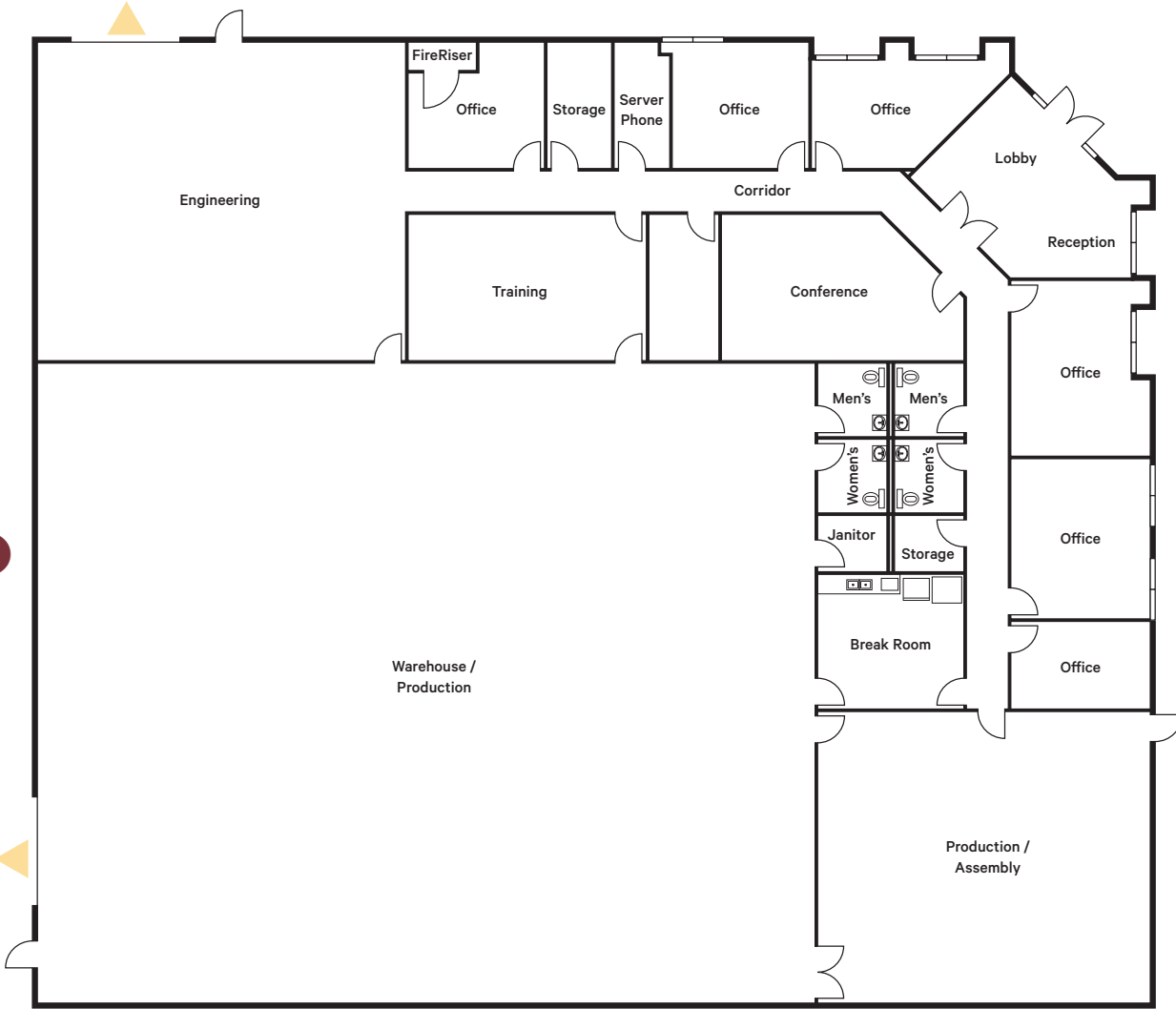

▲ Grade Level



NOT TO SCALE

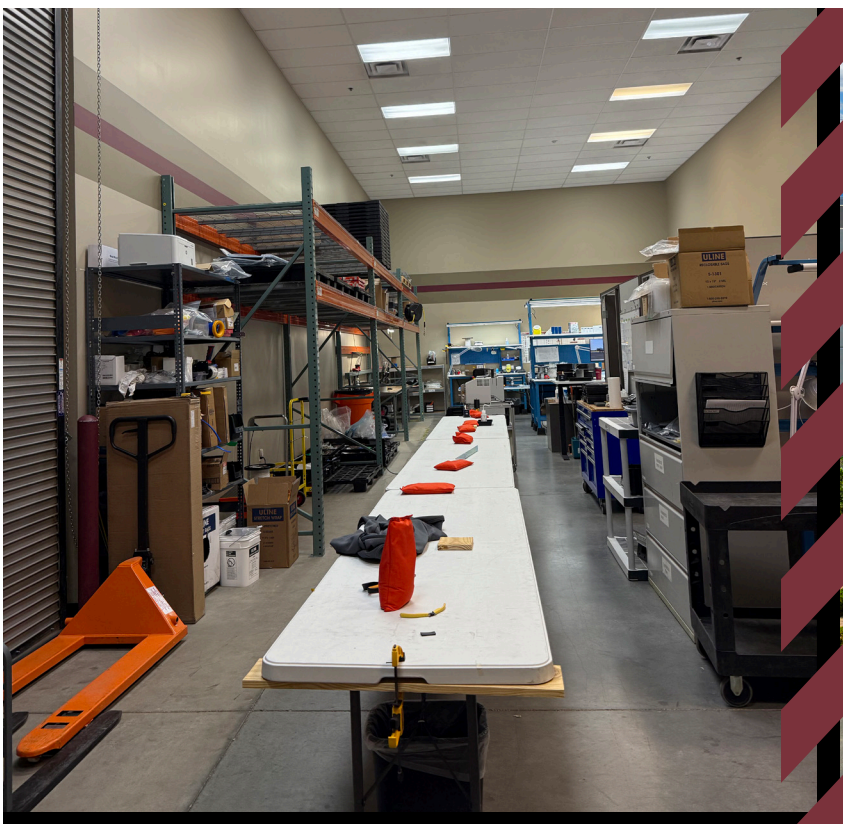

PHOENIX SOUTH MOUNTAIN PRESERVE

**ARROW**  
ARROW ELECTRONICS, INC.

**ASSMANN**  
WISSENER COMPONENTS  
A company of BCS

**BOEING** WAKE BALLAST **ZT** zippertubing.

CloudBlue **COMTECH** Precision AUTO BODY

**AMT** William Ryan Homes **CALIBER COLLISION**

**TITAN POWER**

VALLEY WIDE PLASTERING, INC.

UFP PACKAGING **50 CRAFCO**

**DICKSON** **ADESA**



±77,932 VPD

**MK**  
TECH CENTER



TURBINE AERO

CHANDLER BOULEVARD ±28,060 VPD

BRAND SMITH



**B** BRENNTAG

**Bashas'**

**DURUS**

**PRIME**  
CONTROLS

**TEK**  
Automotive

56TH STREET

BANKER INSULATION

**FINISHED EDGE**  
technology

AdvancedPCB

**NutraStar**

EquipmentShare

**Honeywell**

**ATH**  
Connecting you to Quality

**NAC**  
NORTH AMERICAN COMPOSITES  
DELIVERING PERFORMANCE

**OSOS**  
HOME & PATIO

**GST**  
INTERNATIONAL, INC.

**YESCO**

**B** BRYCON  
QUALITY. PRECISION. PURPOSE.

**pens.etc.**

FRYE ROAD

**a.n.s.**  
ARIZONA NUTRITIONAL SUPPLEMENTS

**NELCO**  
WORLDWIDE

**E&E** exhibit solutions  
exhibits | events | environments

**SHUTTERZ**  
INCORPORATED

**CEPA**  
C.E. Precision Assemblies  
Trexco | An Amphenol Company

**IAC**

**RITE-WAY**  
THERMAL

**ARMORWORKS**  
PROTECTION IS OUR PASSION

# FOR SALE

6825 W FRYE RD, CHANDLER

## CONTACTS

SERENA WEDLICH, SIOR  
Senior Vice President  
+1 602 735 5633  
serena.wedlich@cbre.com

JADEN SCARPONE  
Associate  
+1 623 853 6247  
jaden.scarpone@cbre.com

COURTNEY BOYLE  
Transaction Manager  
+1 602 735 5218  
courtney.boyle@cbre.com

# CBRE

© 2026 CBRE, Inc. All rights reserved. This information has been obtained from sources believed reliable but has not been verified for accuracy or completeness. CBRE, Inc. makes no guarantee, representation or warranty and accepts no responsibility or liability as to the accuracy, completeness, or reliability of the information contained herein. You should conduct a careful, independent investigation of the property and verify all information. Any reliance on this information is solely at your own risk. CBRE and the CBRE logo are service marks of CBRE, Inc. All other marks displayed on this document are the property of their respective owners, and the use of such marks does not imply any affiliation with or endorsement of CBRE. Photos herein are the property of their respective owners. Use of these images without the express written consent of the owner is prohibit

