

SANTA FE BUSINESS CENTER

175 Bosstick Blvd & 2910, 2920, & 2930 Norman Strasse Rd
San Marcos, CA 92069



FOR LEASE

INDUSTRIAL BUSINESS PARK

TOTALING 51,082 SF



PROPERTY HIGHLIGHTS



SANTA FE BUSINESS CENTER



Four Industrial Manufacturing Buildings



Minimal Office Buildout with Restrooms in Each Suite



Grade Level Roll-Up Loading Doors



Parking Ratio 2.0 / 1,000 SF



Convenient Access to Highway 78



Built in 1990



Zoning IP; San Marcos



Available Suite Sizes 780 SF-3,216 SF

AVAILABILITIES

CURRENT AVAILABILITIES

UNIT	SIZE	DESCRIPTION	LEASE RATE	AVAILABLE
2910 Norman Strasse / 104/105	3,216 SF	Reception, 3 private offices, restroom, and warehouse	\$1.50 / SF + \$0.20 CAM	Now
2930 Norman Strasse / 109	780 SF	Reception, restroom, and warehouse	\$1.60 / SF + \$0.20 CAM	November 1, 2024



175 Bosstick Blvd

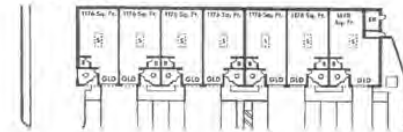

2930 Norman Strasse Rd

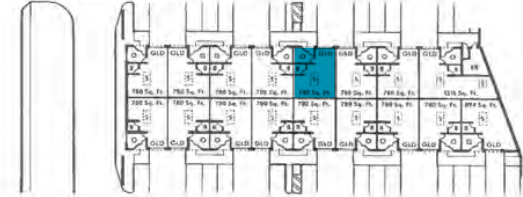

2920 Norman Strasse Rd

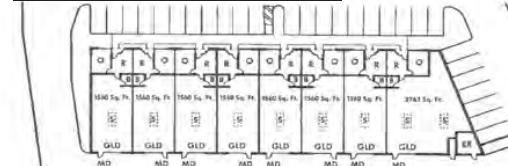

2910 Norman Strasse Rd



2910 NORMAN STRASSE

104 - 105

SUITES AVAILABLE

3,216

TOTAL SQUARE FEET

\$1.50 / SF

LEASE RATE + \$0.20 CAM

Now

DATE AVAILABLE

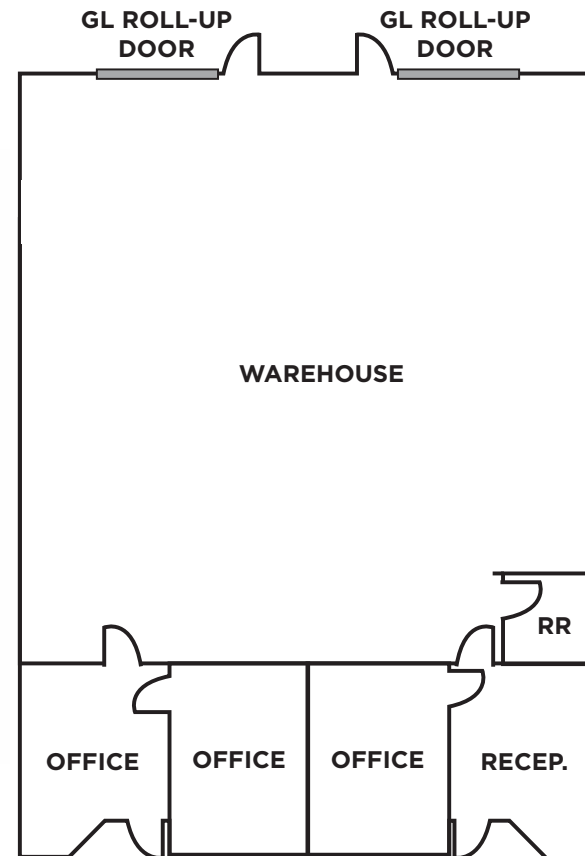

2930 NORMAN STRASSE

109

SUITE AVAILABLE

780

TOTAL SQUARE FEET

\$1.60 / SF

LEASE RATE + \$0.20 CAM

November 1, 2024

DATE AVAILABLE

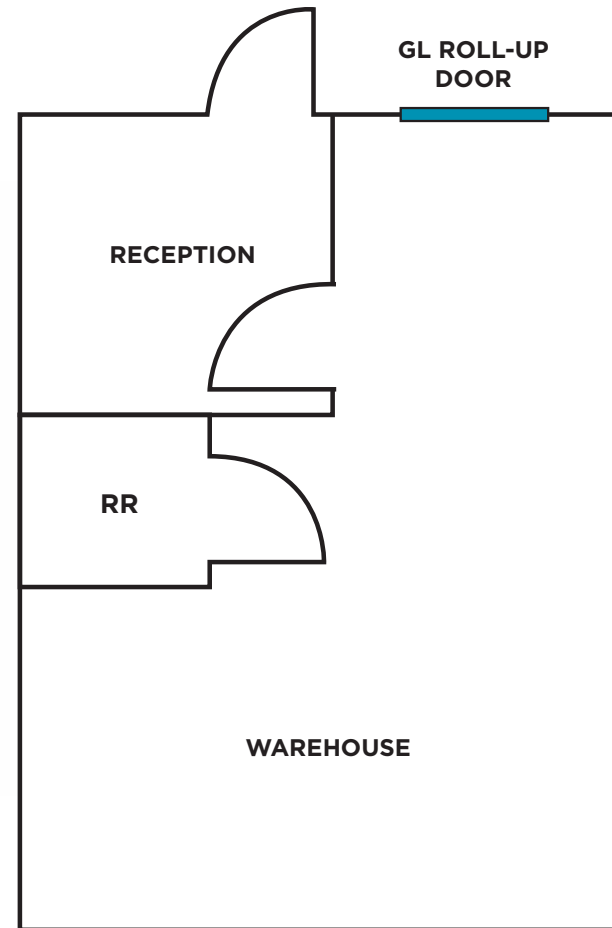

LOCATION

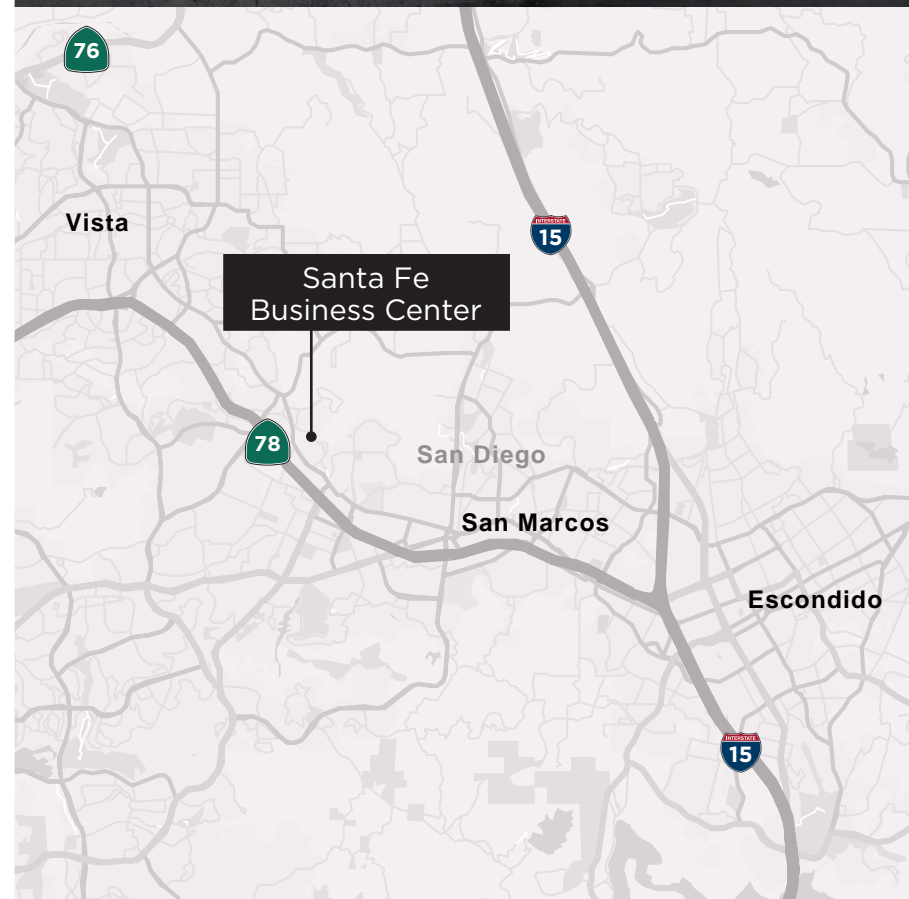
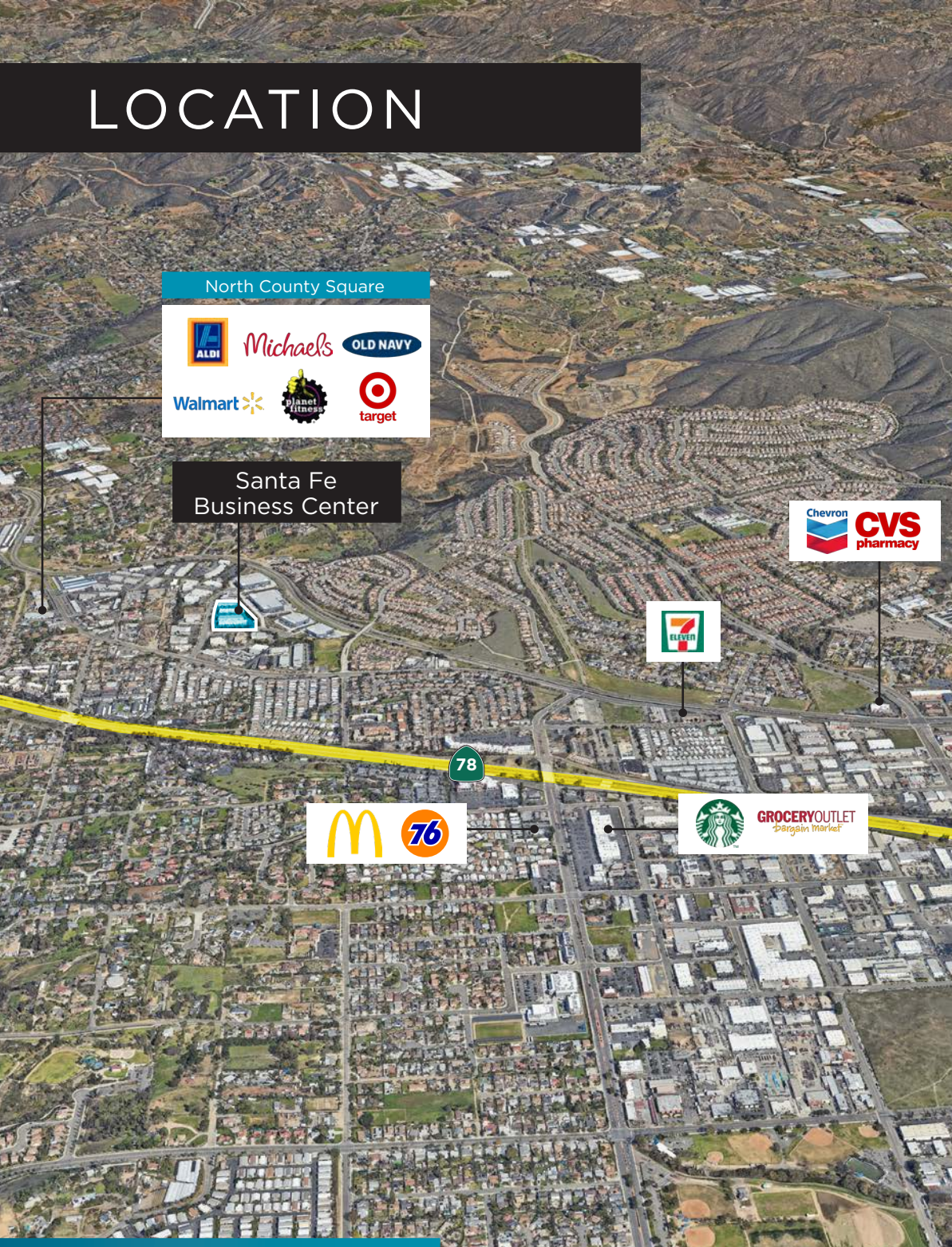



JOE CROTTY

760.473.1811

joe.crotty@cushwake.com

Lic. No.01369821

CONOR BOYLE

760.458.5739

conor.boyle@cushwake.com

Lic. No.01813305

TYLER STEMLEY

760.908.4270

tyler.stemley@cushwake.com

Lic. No.02003867

CARSON ODABASHIAN

760.431.3836

carson.odabashian@cushwake.com

Lic. No.02207230