

INDUSTRIAL FOR LEASE

CALL COMMERCIAL CENTER

1500 NORTH 1380 WEST | OREM, UTAH 84057



Property Description

At just over 210,000 square feet, Call Commercial Center is a three-building, 15-acre industrial park in Orem, Utah. Call Commercial Center offers close proximity to I-15, generous parking, 32-foot clear heights and brand new concrete tilt-up construction.



Property Photos



Site Plan

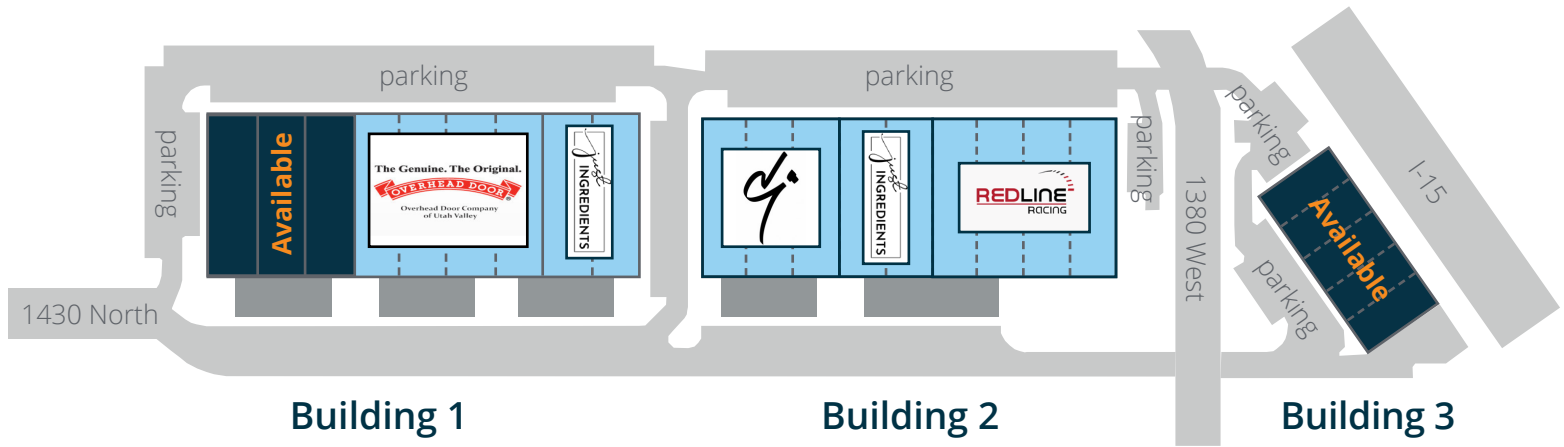

Highlights

Lease Rate	\$1.30 NNN
Total building SF	210,305 SF
Building 1	96,475 SF 32,360 SF available & ready for tenant improvements
Building 2	90,809 SF fully leased
Building 3	23,021 SF Available
Divisibility	32,360 SF
Lot size	15.35 acres
Building construction	Concrete tilt-up
Year built	2023
Clear height	32'
Dock-high doors	7
Ground-level doors	2
Parking	330 total spaces 1/750 SF ratio
Power	480 Volt-3 phase 400-600A per suite (Varies by suite).

Building 1

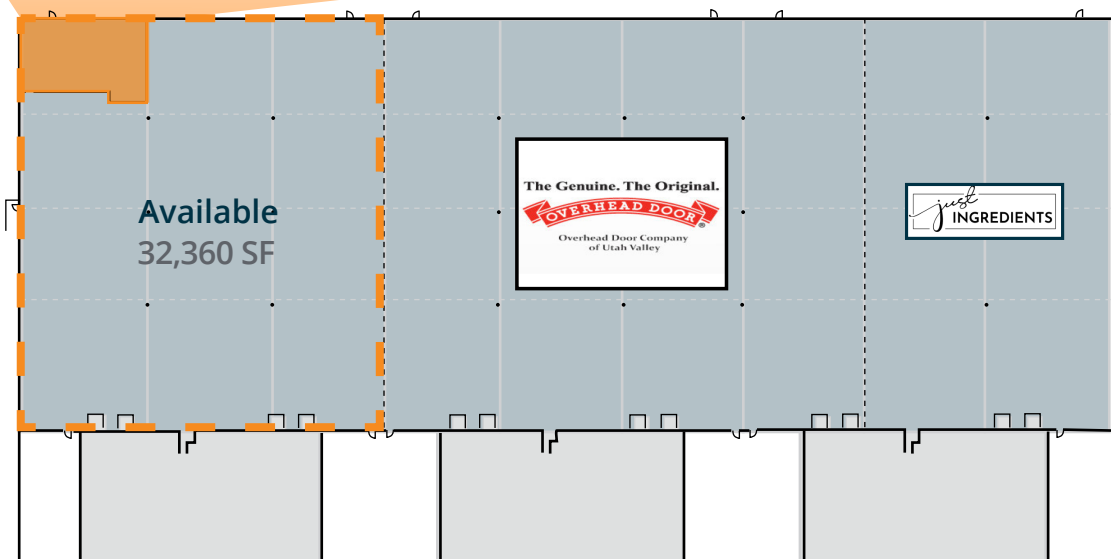
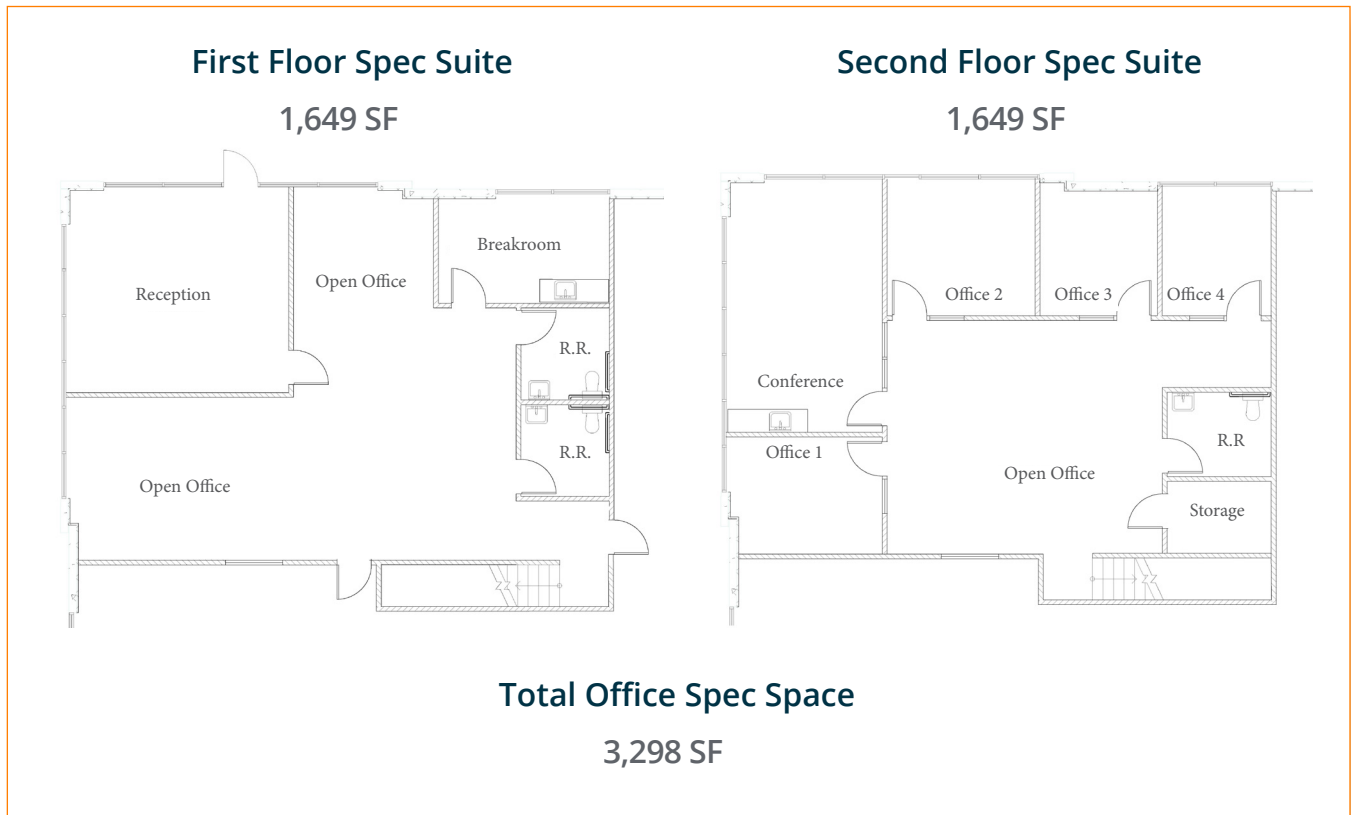

Building 1
90,809 SF

Building 3

Available
23,021 SF

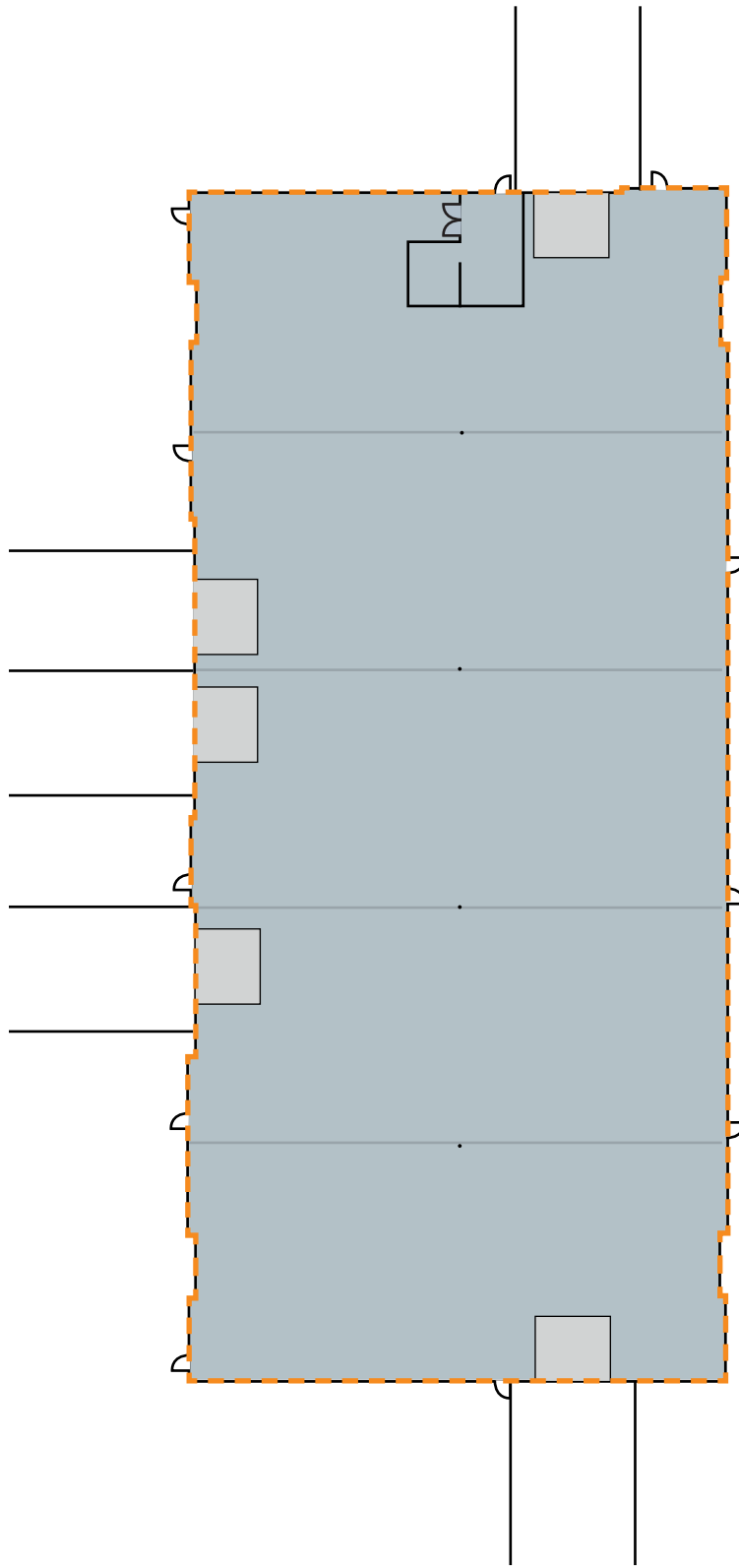

Site Map



INDUSTRIAL FOR LEASE

CALL COMMERCIAL CENTER

1500 NORTH 1380 WEST | OREM, UTAH 84057



Jarrold Hunt
+1 801 787 8940
jarrod.hunt@colliers.com

Lana Howell
+1 801 453 6857
lana.howell@colliers.com

This document has been prepared by Colliers International for advertising and general information only. Colliers International makes no guarantees, representations or warranties of any kind, expressed or implied, regarding the information including, but not limited to, warranties of content, accuracy and reliability. Any interested party should undertake their own inquiries as to the accuracy of the information. Colliers International excludes unequivocally all inferred or implied terms, conditions and warranties arising out of this document and excludes all liability for loss and damages arising there from. This publication is the copyrighted property of Colliers International and/or its licensor(s). ©2023. All rights reserved.