

FOWLERVILLE ROAD FOWLERVILLE, MICHIGAN

LAND FOR SALE
43.80 Acres Available



**SIGNATURE
ASSOCIATES**
KNOW SIGNATURE | KNOW RESULTS

I-96 FREEWAY FRONTAGE



PROPERTY FEATURES

- 43.80 acres
- Zoned Commercial
- Utilities at site
- Immediate I-96 access and exposure
- 2,500 sq. ft. of I-96 frontage at Fowlerville exit
- Site plan approved for commercial development next to Dick Scott Motor Mall
- Asking Price: \$3,285,000 (\$75,000/acre)

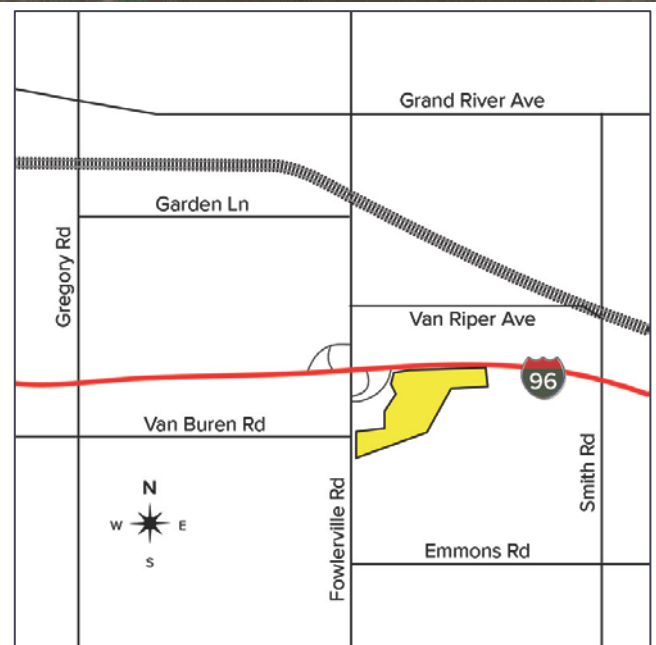

For more information, please contact:

STEVE GORDON

(248) 948 0101

sgordon@signatureassociates.com

SIGNATURE ASSOCIATES

One Towne Square, Suite 1200

Southfield, MI 48076

www.signatureassociates.com

Information is subject to verification and no liability for errors or omissions is assumed. Price is subject to change and listing withdrawal.

Fowlerville Rd - Fowlerville, Michigan

Vacant Land For Sale

43.80
Acres
AVAILABLE

Site Plan

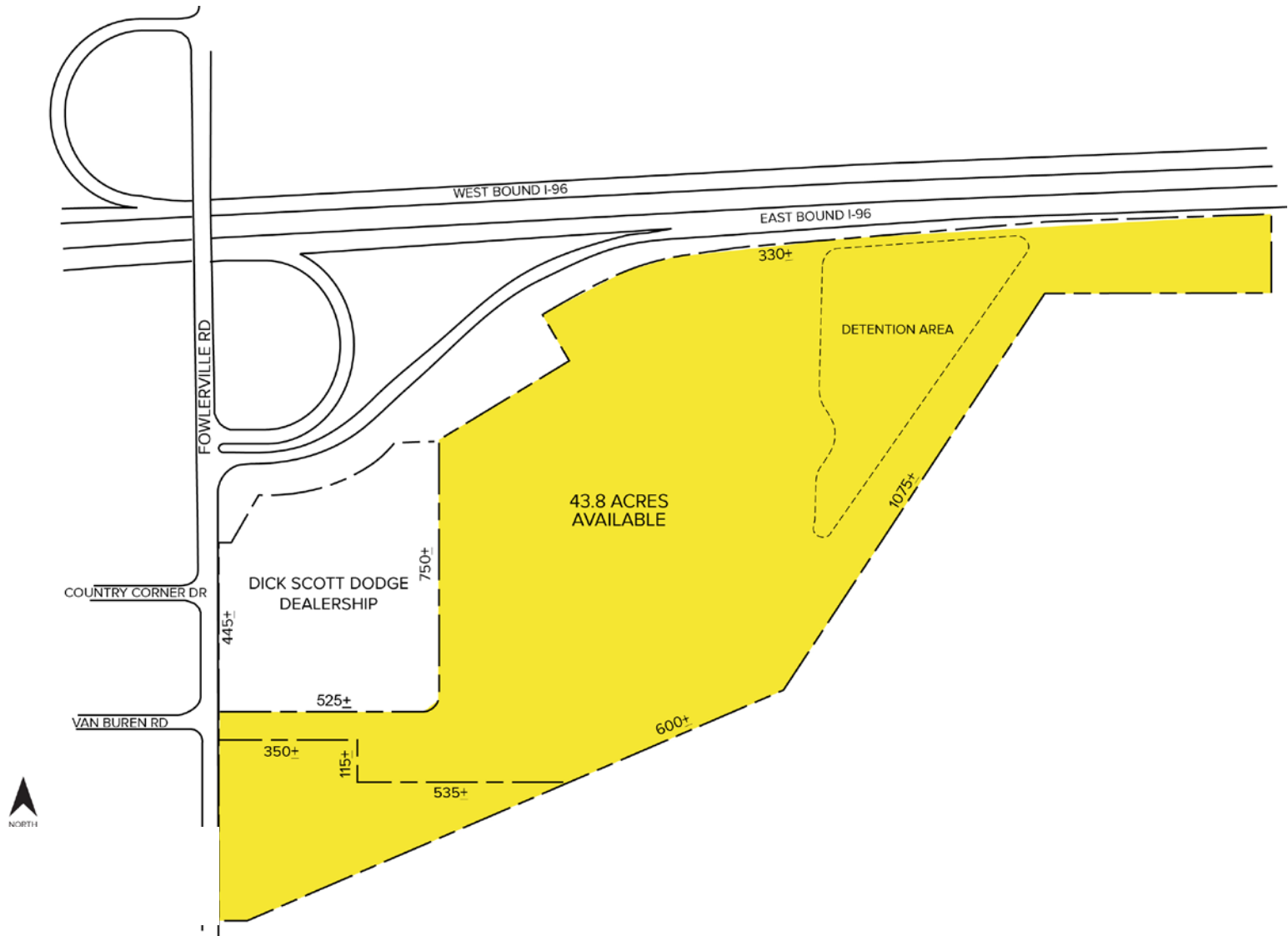

For more information, please contact:

STEVE GORDON

(248) 948 0101

sgordon@signatureassociates.com

SIGNATURE ASSOCIATES

One Towne Square, Suite 1200

Southfield, MI 48076

www.signatureassociates.com

Information is subject to verification and no liability for errors or omissions is assumed. Price is subject to change and listing withdrawal.