

# MULTI-TENANT INDUSTRIAL COMPLEX FOR LEASE

8111 GARDEN ROAD, RIVIERA BEACH, FL 33404

**REICHEL**

SINCE 1987

## FOR LEASE - DOVER CENTER



### Property Highlights:

- 12-unit industrial complex totaling 24,000 ± SF.
- Building features CBS construction and a double-tee concrete and built-up roof system.
- All units have 12' wide x 14' high overhead doors.
- Great location located on the SW corner of Garden Road and Fiscal Court.
- Located in Central Industrial Park North subdivision in Riviera Beach, Florida.
- Lease price: \$18.00 psf modified industrial gross plus electric.

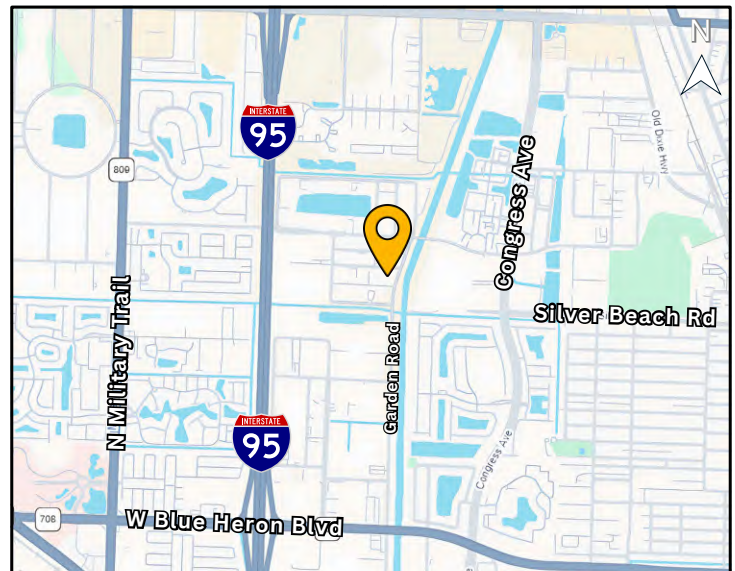

**REICHEL**  
SINCE 1987

Reichel Realty & Investments, Inc.  
8845 N. Military Trail  
Suite 100  
Palm Beach Gardens, FL 33410  
(561) 478-4440 main  
www.reichelrealty.com

For more information, please contact:



**Kerry Jackson, SIOR**  
Vice President  
(561) 478-4440 phone  
(561) 512-7512 cell  
kjackson@reichelrealty.com

***Driven by Integrity. Defined by Results.***

Any information given herewith is obtained from sources considered reliable. However, we are not responsible for misstatement of facts, errors, or omissions. Owner may withdraw from market, prior to sale or change price without notice.

# MULTI-TENANT INDUSTRIAL COMPLEX FOR LEASE

8111 GARDEN ROAD, RIVIERA BEACH, FL 33404

**REICHEL**

SINCE 1987

## PROPERTY INFORMATION SUMMARY

<b>Property:</b>	12-unit office/warehouse project for lease. The building features CBS construction with a double-tee concrete roof system and 17' clear height. Most units have glass storefronts and are front loaded. Each unit has at least one 12' wide x 14' high overhead door. The entire complex was recently repainted.
<b>Location:</b>	Located in Central Industrial Park North subdivision. Excellent frontage directly on Garden Road. Located on the Southwest corner of Garden and Fiscal Court.
<b>Zoning:</b>	(IL) Light Industrial, Palm Beach County. This zoning allows a variety of light industrial uses. Ideal for personal storage, car storage, a small service business or any use permitted in the Light Industrial District.
<b>Current Availability:</b>	<p>Unit E: 2,834 ± SF. Space has one large open office, a showroom and reception area, one bathroom, and the balance of the space is open warehouse. There is one 12' x 14' high overhead door. Unit fronts Garden Road. \$4,251.00 per month plus electricity and sales tax (currently zero percent).</p> <p>Unit G: 1,890 ± SF: Space has one office, balance warehouse. There is one 12' x 14' high overhead door. Unit fronts Fiscal Court on the north side of the building. \$2,835.00 per month plus electricity and sales tax (currently zero percent).</p>
<b>Lease Price:</b>	\$18.00 psf modified industrial gross plus electric.

**REICHEL**

SINCE 1987

Reichel Realty & Investments, Inc.  
8845 N. Military Trail  
Suite 100  
Palm Beach Gardens, FL 33410  
(561) 478-4440 main  
www.reichelrealty.com

For more information, please contact:



**Kerry Jackson, SIOR**  
Vice President  
(561) 478-4440 phone  
(561) 512-7512 cell  
kjackson@reichelrealty.com



# MULTI-TENANT INDUSTRIAL COMPLEX FOR LEASE

8111 GARDEN ROAD, RIVIERA BEACH, FL 33404

**REICHEL**

SINCE 1987

## PHOTOS



**REICHEL**

SINCE 1987

Reichel Realty & Investments, Inc.  
8845 N. Military Trail  
Suite 100  
Palm Beach Gardens, FL 33410  
(561) 478-4440 main  
[www.reichelrealty.com](http://www.reichelrealty.com)

For more information, please contact:



**Kerry Jackson, SIOR**

Vice President

(561) 478-4440 phone

(561) 512-7512 cell

[kjackson@reichelrealty.com](mailto:kjackson@reichelrealty.com)

# MULTI-TENANT INDUSTRIAL COMPLEX FOR LEASE

8111 GARDEN ROAD, RIVIERA BEACH, FL 33404

**REICHEL**

SINCE 1987

## PHOTOS



**REICHEL**

SINCE 1987

Reichel Realty & Investments, Inc.  
8845 N. Military Trail  
Suite 100  
Palm Beach Gardens, FL 33410  
(561) 478-4440 main  
[www.reichelrealty.com](http://www.reichelrealty.com)

For more information, please contact:



**Kerry Jackson, SIOR**  
Vice President  
(561) 478-4440 phone  
(561) 512-7512 cell  
[kjackson@reichelrealty.com](mailto:kjackson@reichelrealty.com)



# MULTI-TENANT INDUSTRIAL COMPLEX FOR LEASE

8111 GARDEN ROAD, RIVIERA BEACH, FL 33404

**REICHEL**

SINCE 1987

## FLOOR PLAN

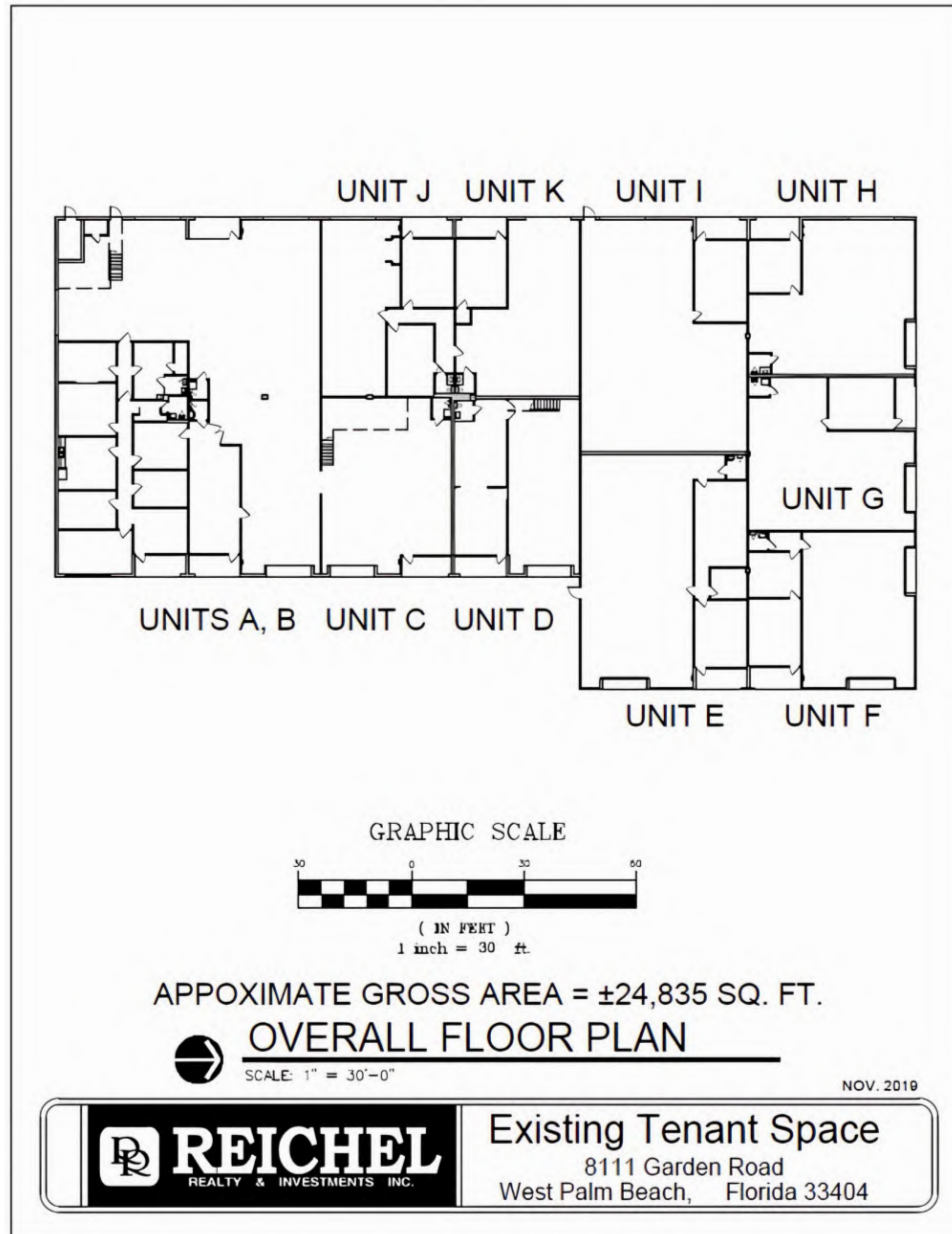

**REICHEL**

SINCE 1987

Reichel Realty & Investments, Inc.  
8845 N. Military Trail  
Suite 100  
Palm Beach Gardens, FL 33410  
(561) 478-4440 main  
[www.reichelrealty.com](http://www.reichelrealty.com)

For more information, please contact:



**Kerry Jackson, SIOR**  
Vice President  
(561) 478-4440 phone  
(561) 512-7512 cell  
[kjackson@reichelrealty.com](mailto:kjackson@reichelrealty.com)

## FLOOR PLAN

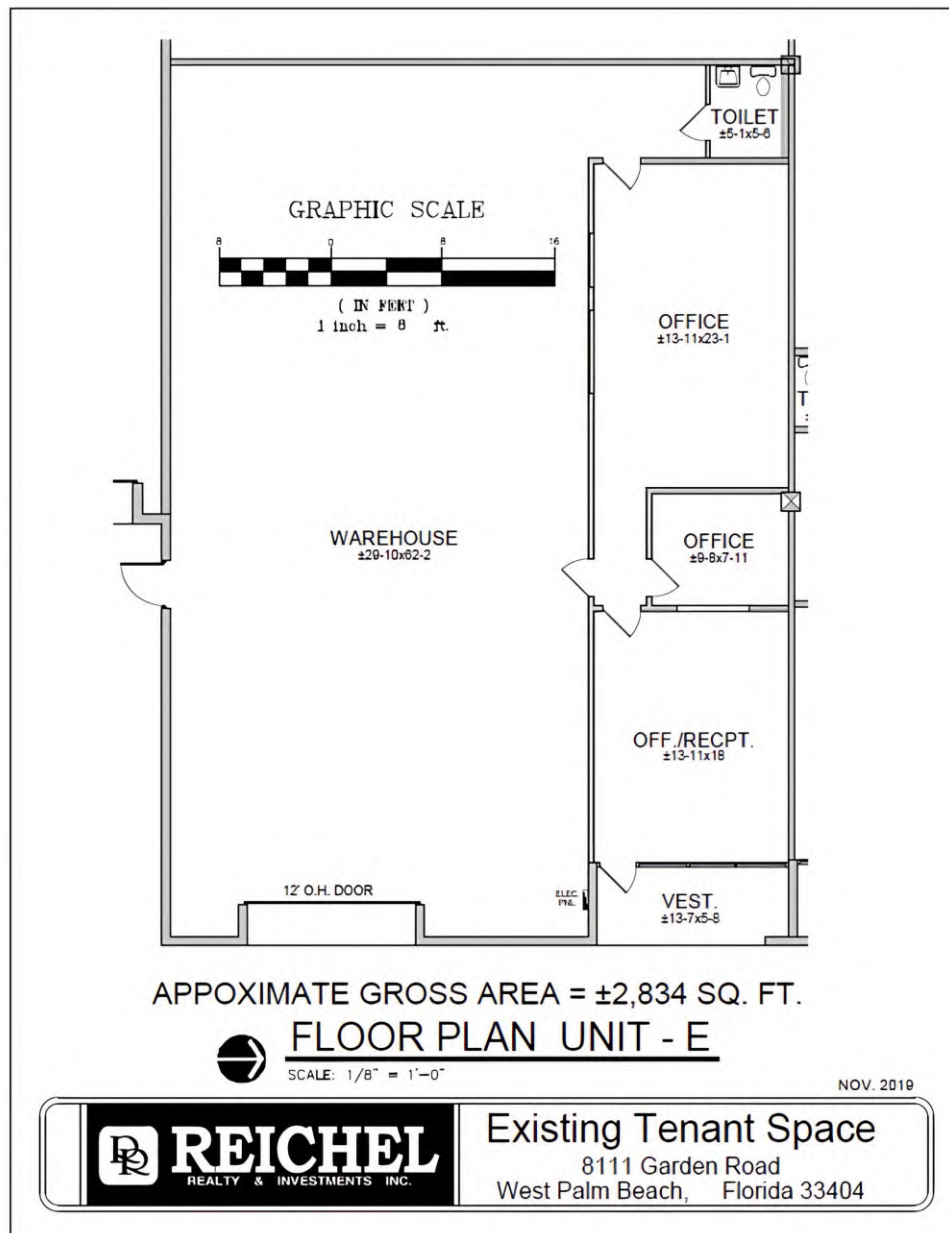

**REICHEL**

SINCE 1987

Reichel Realty & Investments, Inc.  
8845 N. Military Trail  
Suite 100  
Palm Beach Gardens, FL 33410  
(561) 478-4440 main  
www.reichelrealty.com

For more information, please contact:



**Kerry Jackson, SIOR**  
Vice President  
(561) 478-4440 phone  
(561) 512-7512 cell  
kjackson@reichelrealty.com

# MULTI-TENANT INDUSTRIAL COMPLEX FOR LEASE

8111 GARDEN ROAD, RIVIERA BEACH, FL 33404

**REICHEL**

SINCE 1987

## FLOOR PLAN

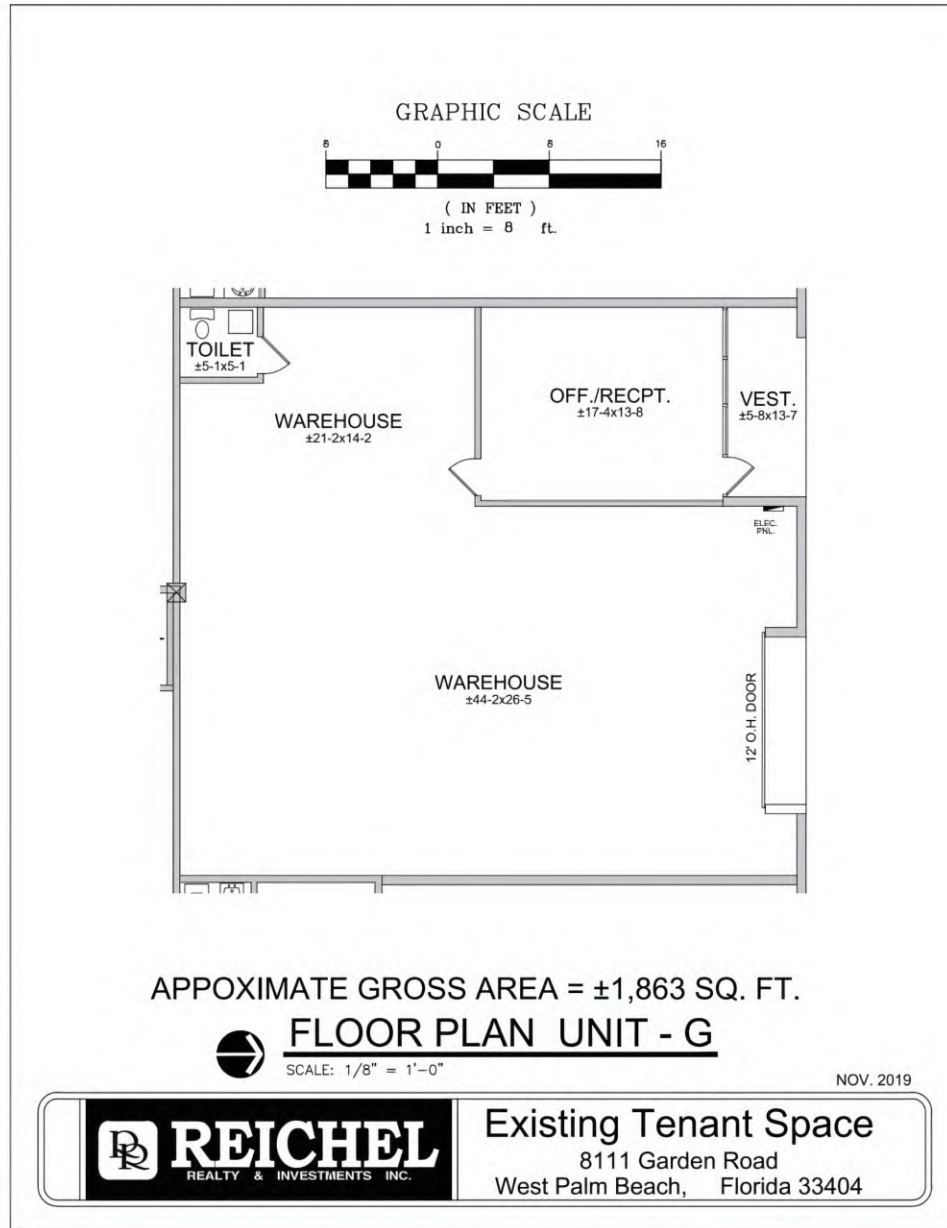

**REICHEL**

SINCE 1987

Reichel Realty & Investments, Inc.  
8845 N. Military Trail  
Suite 100  
Palm Beach Gardens, FL 33410  
(561) 478-4440 main  
www.reichelrealty.com

For more information, please contact:



**Kerry Jackson, SIOR**  
Vice President  
(561) 478-4440 phone  
(561) 512-7512 cell  
kjackson@reichelrealty.com



# MULTI-TENANT INDUSTRIAL COMPLEX FOR LEASE

8111 GARDEN ROAD, RIVIERA BEACH, FL 33404

**REICHEL**

SINCE 1987

## MAP

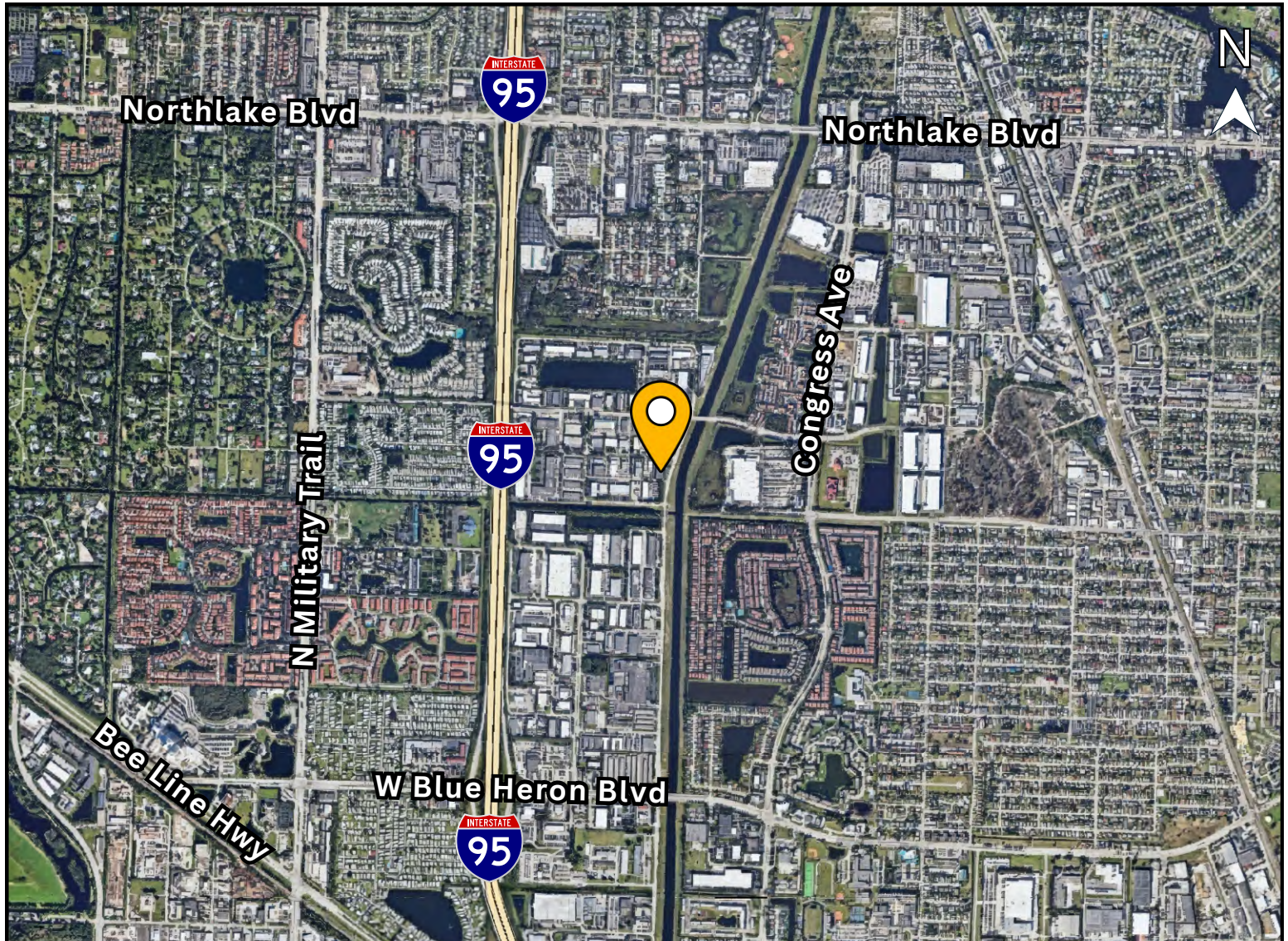

**REICHEL**

SINCE 1987

Reichel Realty & Investments, Inc.  
8845 N. Military Trail  
Suite 100  
Palm Beach Gardens, FL 33410  
(561) 478-4440 main  
[www.reichelrealty.com](http://www.reichelrealty.com)

For more information, please contact:



**Kerry Jackson, SIOR**

Vice President

(561) 478-4440 phone

(561) 512-7512 cell

[kjackson@reichelrealty.com](mailto:kjackson@reichelrealty.com)

### ***Experience the Reichel Advantage in Value-Added Services:***

- Management
- Commercial Real Estate
- Construction
- Tax Appeal
- Sales & Marketing
- Leasing
- Government Relations
- Work Outs

Any information given herewith is obtained from sources considered reliable. However, we are not responsible for misstatement of facts, errors, or omissions. Owner may withdraw from market, prior to sale or change price without notice.