

FOR LEASE

IOS/Contractor yard in Gig Harbor

5930 SEHMEL DR, GIG HARBOR, WA

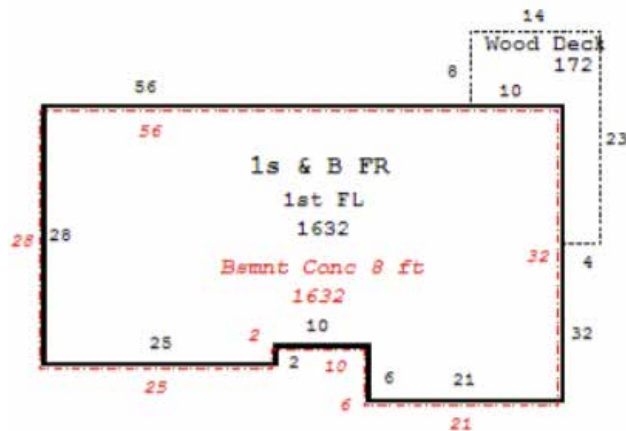

ADDRESS	5930 Sehmel Dr, Gig Harbor
LEASE RATE	\$7,500/mo NNN
PARCEL	0122361013
LOT SIZE	1.8 Acres (78,408 SF)
OFFICE	1,632 SF
DAYLIGHT BASEMENT STORAGE	<ul style="list-style-type: none"> • 1,632 SF • 20" Storage container with two rollup doors
ZONING	Employment District (ED) is an industrial zone located in Gig Harbor. Data recorded for code adopted on or before August 2024.
GENERAL LAND USE CATEGORY	Industrial
LAND USE SUBCATEGORY	Light Industrial/Flex

Retail and dining uses permitted
Office uses permitted
Light industrial/manufacturing uses permitted
Heavy industrial uses permitted
Warehouse and distribution center uses permitted
Data center uses conditionally permitted
Green energy generation uses conditionally permitted

5930 SEHMEL DR



AVAILABLE FOR LEASE

KIDDER MATHEWS

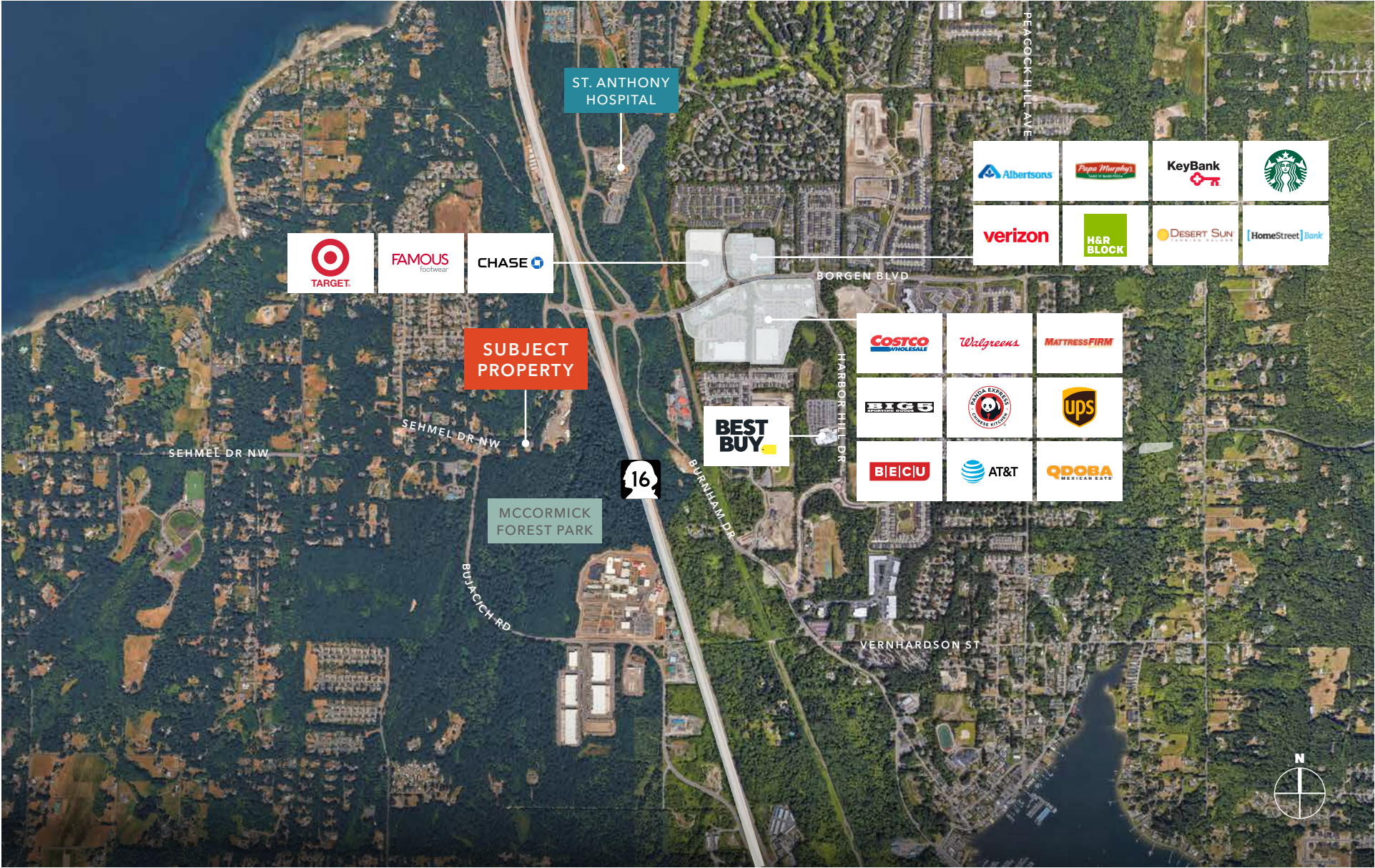

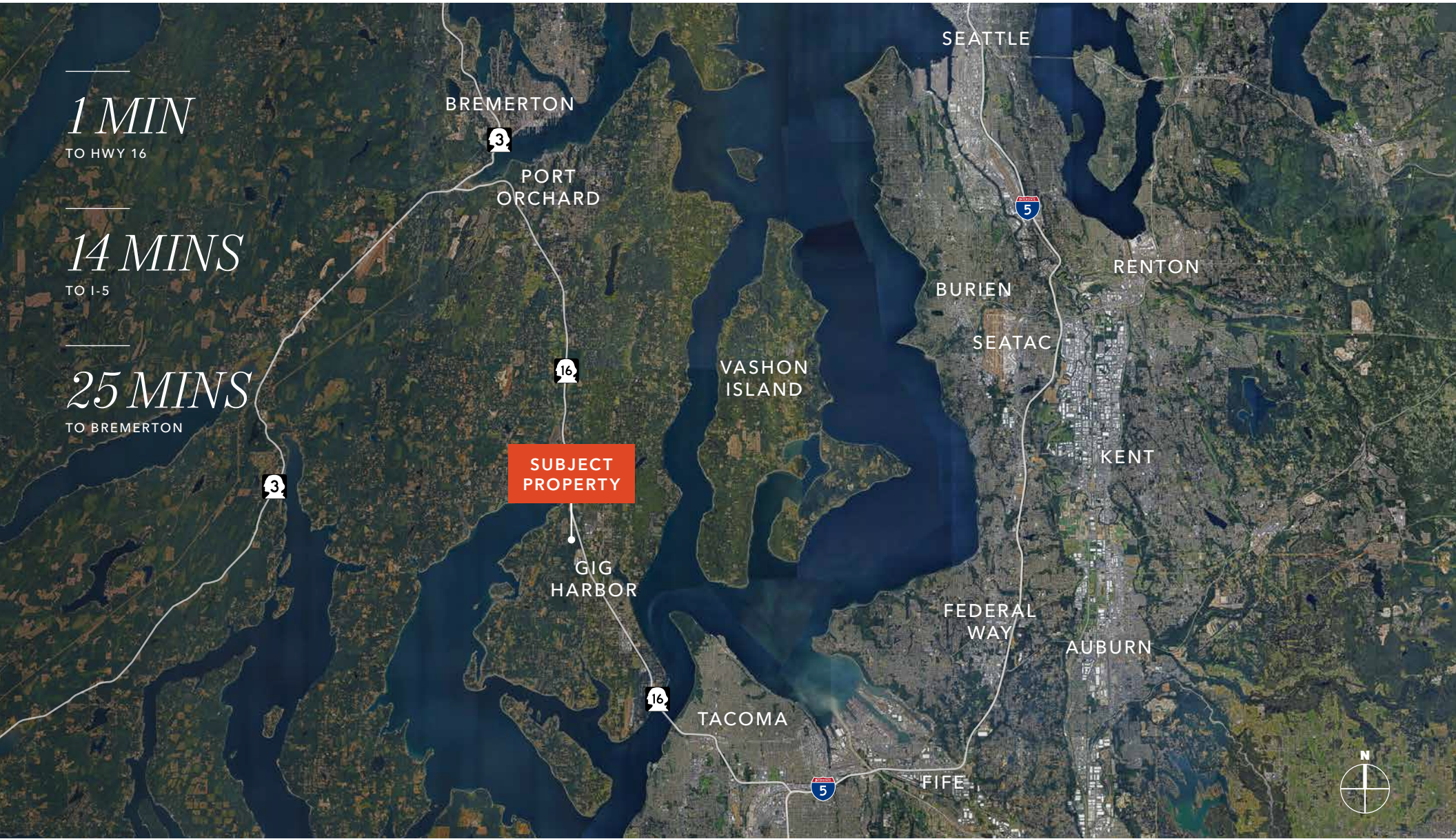

5930 SEHMEL DR

Exclusively leased by

BRUCE BARKER, CCIM, MBA
253.722.1459
bruce.barker@kidder.com

MATT MCLENNAN SIOR, CCIM
253.722.1458
matt.mclennan@kidder.com

KIDDER.COM

This information supplied herein is from sources we deem reliable. It is provided without any representation, warranty, or guarantee, expressed or implied as to its accuracy. Prospective Buyer or Tenant should conduct an independent investigation and verification of all matters deemed to be material, including, but not limited to, statements of income and expenses. Consult your attorney, accountant, or other professional advisor.

