

# Ammendale Technology Park

11850 Baltimore Avenue

**Available March 1, 2026**

Ammendale Technology Park is a planned business community which sits on more than 200 acres in northern Prince George's County. Ideally situated between Baltimore and Washington D.C., the park is less than five minutes from I-95.

## Space Details

- + 9,720 SF with 5,500 +/- SF office
- + Wet sprinkler
- + 21' clear
- + Column Spacing 33'4" x 37'6"
- + 2 docks

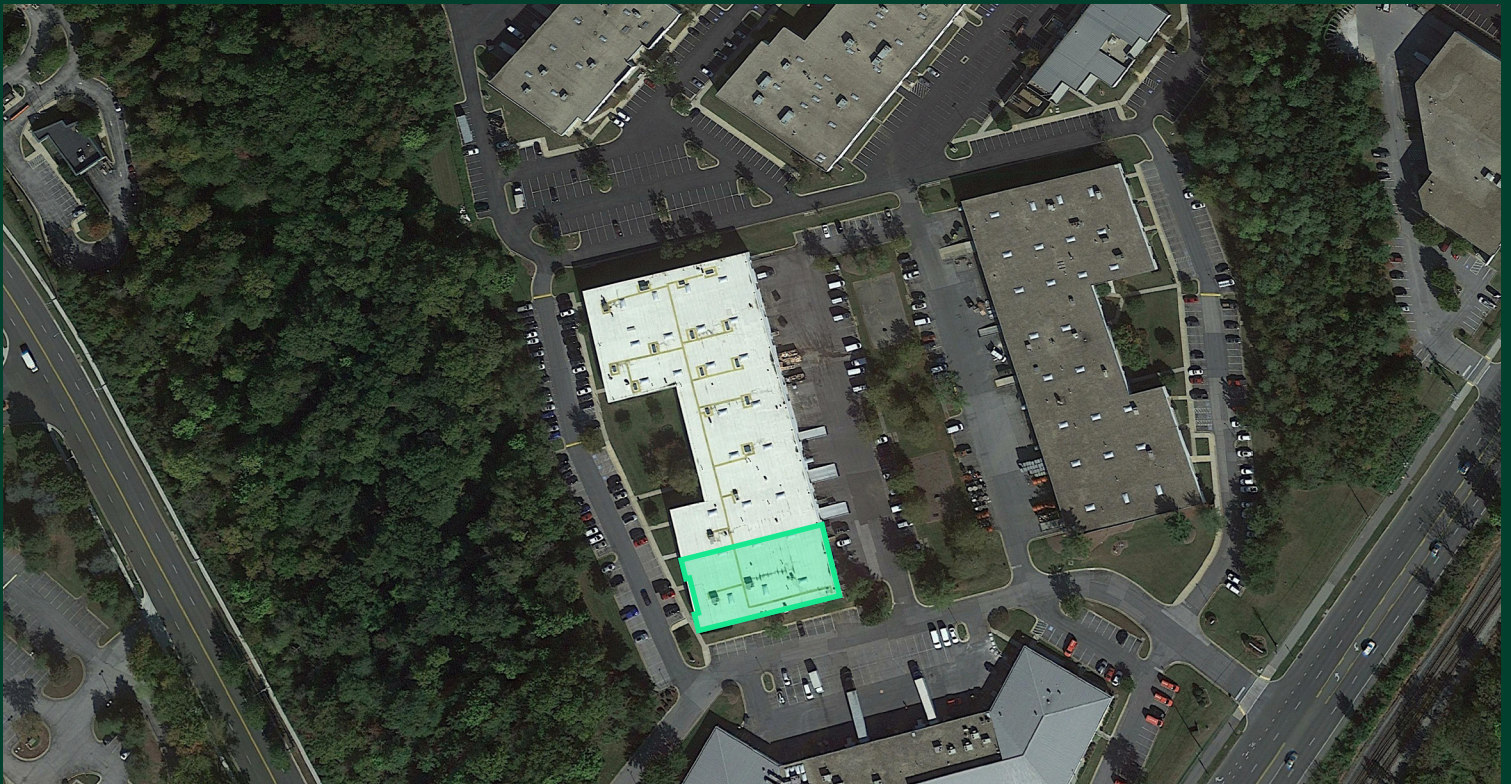

# Flex Space for Lease

9,720 square feet

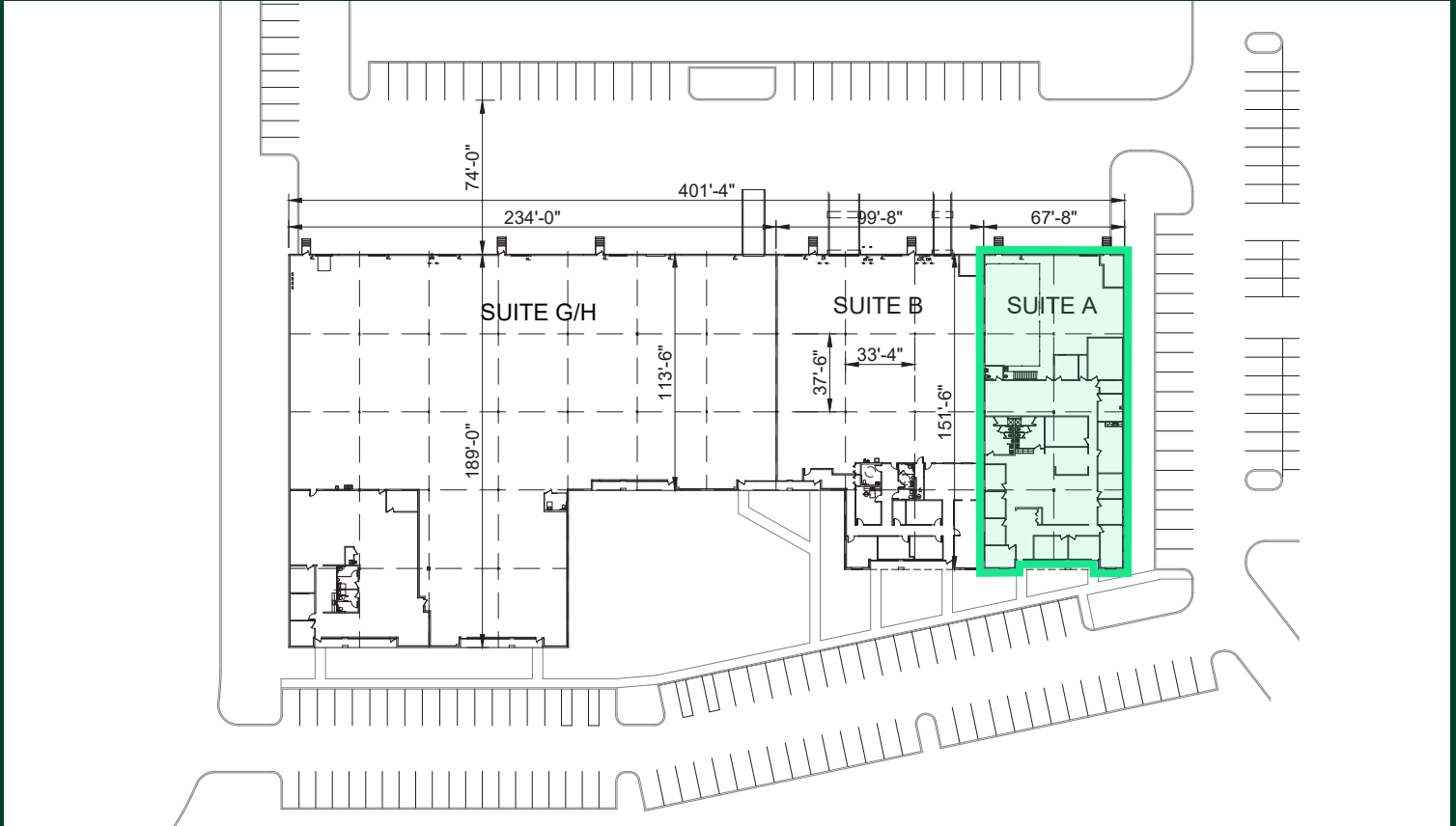

## Contact Us

**Kevin O'Neil**  
First Vice President  
+1 410 244 3119  
kevin.oneil1@cbre.com

**Jared Ross**  
First Vice President  
+1 410 244 3136  
jared.ross@cbre.com

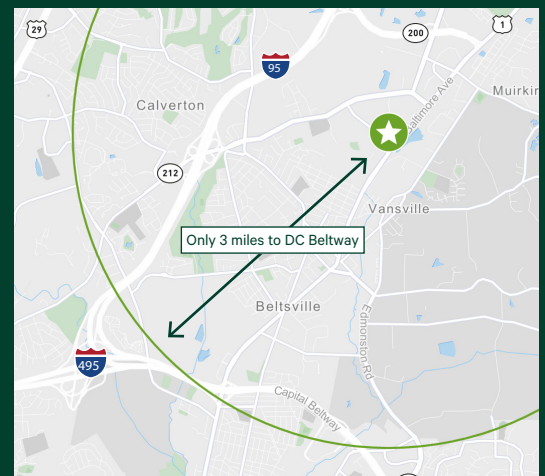

© 2025 CBRE, Inc. All rights reserved. This information has been obtained from sources believed reliable, but has not been verified for accuracy or completeness. You should conduct a careful, independent investigation of the property and verify all information. Any reliance on this information is solely at your own risk. CBRE and the CBRE logo are service marks of CBRE, Inc. All other marks displayed on this document are the property of their respective owners, and the use of such logos does not imply any affiliation with or endorsement of CBRE. Photos herein are the property of their respective owners. Use of these images without the express written consent of the owner is prohibited.