

TURN-KEY OFFICE IN FIFE

5050 20TH STREET E, FIFE, WA 98424



AVAILABLE FOR LEASE

SUITE 101

3,050 SF
(Ability to add the large reception area adjacent to the space for an additional 500 SF)

LEASE RATE

\$19.50/SF
Modified Gross

COMMENTS

Electricity and other utilities are covered by Landlord, and the interior maintenance and janitorial is covered by Tenant

OPEN FLOOR PLAN

Suite 101 offers a bright and open floor plan, abundant free parking and is fully furnished. Existing furniture for 24 people.



TURN-KEY OFFICE IN FIFE

5050 20TH STREET E, FIFE, WA 98424

FLOOR PLAN | SUITE 101

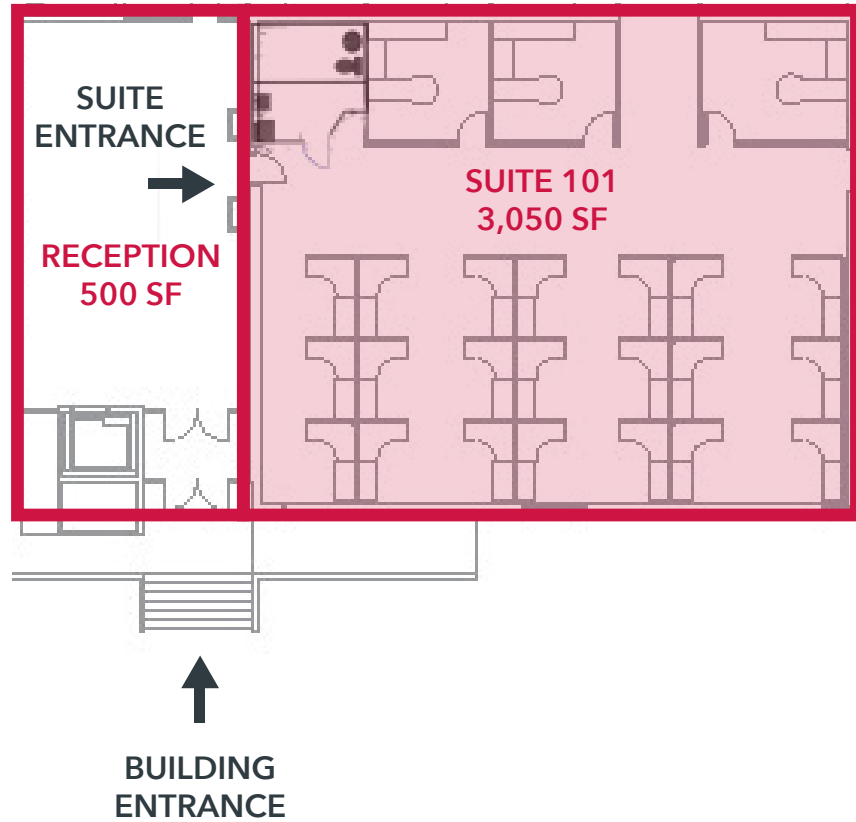

TURN-KEY OFFICE IN FIFE

5050 20TH STREET E, FIFE, WA 98424

PHOTOS | SUITE 101



Abundant Natural Light



Kitchenette



Optional Reception Area

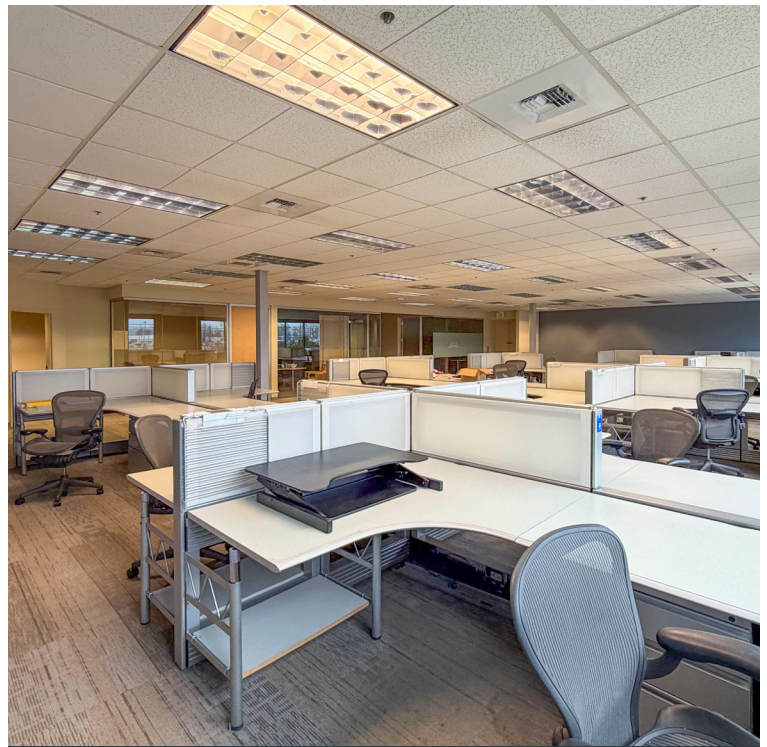

Furniture Included

TURN-KEY OFFICE IN FIFE

5050 20TH STREET E, FIFE, WA 98424

LOCAL AMENITIES MAP



CONTACT

JOHN BAUDER, ccim
jbauder@lee-associates.com
D 253-238-0043

HARRISON LAIRD
hlaird@lee-associates.com
D 253-238-0044

All information furnished regarding property for sale, rental or financing is from sources deemed reliable, but no warranty or representation is made to the accuracy thereof and same is submitted to errors, omissions, change of price, rental or other conditions prior to sale, lease or financing or withdrawal without notice. No liability of any kind is to be imposed on the broker herein. 5050 20th Street E, Fife, WA 98424. Lease 2024\5050 20th Street E_Lease Flyer