

RAY COUNTY ASSESSOR

Parcel Number:

05-03-06-02-015-012.000

Deed Holder:

HOUSEWORTH RENOVATIONS LLC

Property Address:

322 N PENNSYLVANIA AVE
LAWSON, MO 64062-0000

Class:

COMMERCIAL

Map Area:

LAWSON COMMERCIAL

Total Acres:

0.0650

Legal Description:

ALL LOT 5 BLOCK 8 LAWSON OLD SURVEY
(NOT TO BE USED ON LEGAL DOCUMENTS)

Property Report:

[PROPERTY REPORT \(PDF FILE\)](#)



Pin 05-03-06-02-015-012.000 Photo

1 / 1



Taxing Districts

District	Description
Road District	LAWSON
School District	LAWSON
Nursing Home	SHIRKEY
Ambulance District	LAWSON
Fire District	LAWSON
City	LAWSON

Current Value Information

FULL MARKET	Agricultural	Residential	Commercial\Other	Exempt	Total
Land	\$0	\$0	\$3,170	\$0	\$3,170
Building	\$0	\$0	\$59,970	\$0	\$59,970
Total	\$0	\$0	\$63,140	\$0	\$63,140

Prior Year Value Information

2021 Appraised	Agricultural	Residential	Commercial\Other	Exempt	Total
Land Full Market	\$0	\$0	\$3,170	\$0	\$3,170
Building Full Market	\$0	\$0	\$59,970	\$0	\$59,970
Total Full Market	\$0	\$0	\$63,140	\$0	\$63,140
2020 Appraised	Agricultural	Residential	Commercial\Other	Exempt	Total
Land Full Market	\$0	\$0	\$3,170	\$0	\$3,170
Building Full Market	\$0	\$0	\$58,790	\$0	\$58,790

Total Full Market	\$0	\$0	\$61,960	\$0	\$61,960
▼ More Years...					

Land Front Foot Information

Lot	Front	Rear	Side 1	Side 2	Eff Frontage
Main Lot	22.50	22.50	125.00	125.00	21.15
	Total SF 2,813				
	Total Acres 0.065				

Commercial Building Information

Occupancy	Year Built	Building Area
▼ Bars and Lounges	1900	1,886
▼ Store - Retail Small	2005	360

Yard Extra Information

Description	Item Count	Year Built
▼ Shed	1	2017

Building Permit Information

Date	Number	Tag Descr	Tag Date	Amount	Reason
07/01/2019	LAWSON 434	No	08/06/2019	0	Misc

Sketch

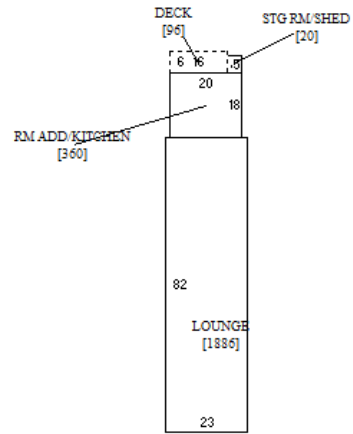

Sketch of Pin 05-03-06-02-015-012.000

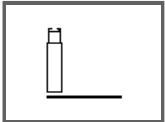

GIS Map Information

