

13.73 ACRES OF COMMERCIAL LAND

**42851 E COUNTY ROAD 1470**

**LONE WOLF, OK 73655**



**OFFERING MEMORANDUM**



**STEVEN HAKES**  
steve.hakes@metroproscommercial.com | www.metroproscommercial.com  
214-421-5769



# CONFIDENTIALITY AND AGREEMENT

This document, including the attached Offering Memorandum, contains confidential information and trade secrets belonging to [Your Company Name] ("Disclosing Party"). The recipient of this information ("Recipient") acknowledges and agrees to the following:

- **Confidentiality Obligation:** Recipient shall keep all information contained in this document strictly confidential and shall not disclose, disseminate, or share it with any third party without the prior written consent of the Disclosing Party.
- **Purpose of Use:** Recipient may use the confidential information solely for the purpose of evaluating and considering a potential transaction as described in the Offering Memorandum.
- **Non-Disclosure Agreement:** This notice does not constitute a separate Non-Disclosure Agreement (NDA) but serves as a reminder of the recipient's obligations concerning the confidential information provided herein.
- **Return or Destruction:** Upon the Disclosing Party's request or the conclusion of the evaluation, Recipient shall promptly return all copies of this document and its contents, or, at the Disclosing Party's option, destroy such materials.
- **No Rights Granted:** This notice does not grant any license or rights to the recipient with respect to the confidential information. By accessing this document, the recipient acknowledges their understanding of and agreement to the terms and obligations set forth in this Confidentiality Notice.



**STEVEN HAKES**

[steve.hakes@metroproscommercial.com](mailto:steve.hakes@metroproscommercial.com)

[www.metroproscommercial.com](http://www.metroproscommercial.com)

214 - 421 - 5769



# PROPERTY DESCRIPTION

## 42851 E COUNTY ROAD 1470 LONE WOLF, OK 73655

Just under 14 Acres of beautiful land nestled in the Quartz Mountain region of Southwestern Oklahoma. This land contains a red metal building that is 120' by 46' fully functional built out interior with full HVAC for a Cannabis Grow. Greenhouse is nearly 4,000 Square foot that needs repair with a cost of \$9,000. 3 RV spots, 4 car garage, and a double wide 2024 mobile home that sits in the back of the lot.

### PROPERTY DETAILS

<b>Property Address</b>	<b>42851 E County Road 1470</b>
<b>City, State, Zip</b>	<b>Lone Wolf, OK 73655</b>
Price	\$599,000
Price / AC	\$43,700
Sale Type	Investment
No. Lots	1
Property Type	Land
Property Subtype	Commercial
Proposed Use	Mixed Use
<b>Total Lot Size</b>	<b>13.73 AC</b>































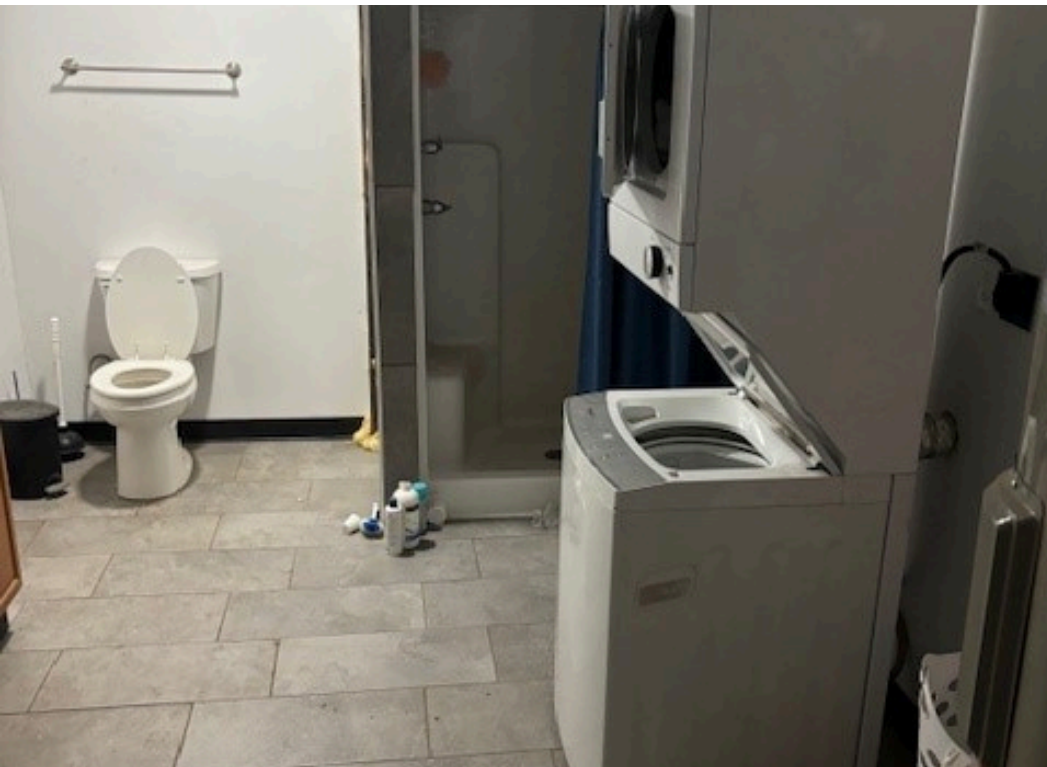



# LOCATION OVERVIEW



**SUBJECT PROPERTY**



## **42851 E COUNTY ROAD 1470**

- Nearly 14 acres of land in the Quartz Mountain region of Southwestern Oklahoma
- Features a red metal building (120' by 46') with a fully functional built-out interior and full HVAC for a cannabis grow operation
- Greenhouse (nearly 4,000 square feet) needs repair, estimated cost: \$9,000
- Includes 3 RV spots, a 4-car garage, and a double-wide 2024 mobile home at the back of the lot
- Suitable for a cannabis grow and processing facility; OMMA licenses available for sale
- Building includes a full-size bar from its previous use as a honky tonk bar
- Potential for several other uses
- Ideal for an RV park, neighboring Quartz Mountain State Park & Resort with frequently full camping areas



# LONE WOLF, OK

**Lone Wolf** is a town in Oklahoma with a population of 437. Lone Wolf is in Kiowa County. Living in Lone Wolf offers residents a rural feel and most residents own their homes.



POPULATION  
**437**



MEDIAN HOME VALUE  
**\$70,900**



MEDIAN RENT  
**\$467**



MEDIAN HH INCOME  
**\$37,361**



**8** WALK  
SCORE



**31** BIKE  
SCORE

<https://www.niche.com/places-to-live/lone-wolf-kiowa-ok/>  
<https://www.walkscore.com/score/2025-e-lone-wolf-ave-stillwater-ok-74075>



13.73 ACRES OF COMMERCIAL LAND

**42851 E COUNTY ROAD 1470**

**LONE WOLF, OK 73655**

**STEVEN HAKES**

steve.hakes@metroproscommercial.com | www.metroproscommercial.com

214-421-5769



**OFFERING MEMORANDUM**