

113,952 SF

Industrial Space For Lease



Prologis Vernon Business Center



2929 54th Street
Vernon, CA 90058 USA

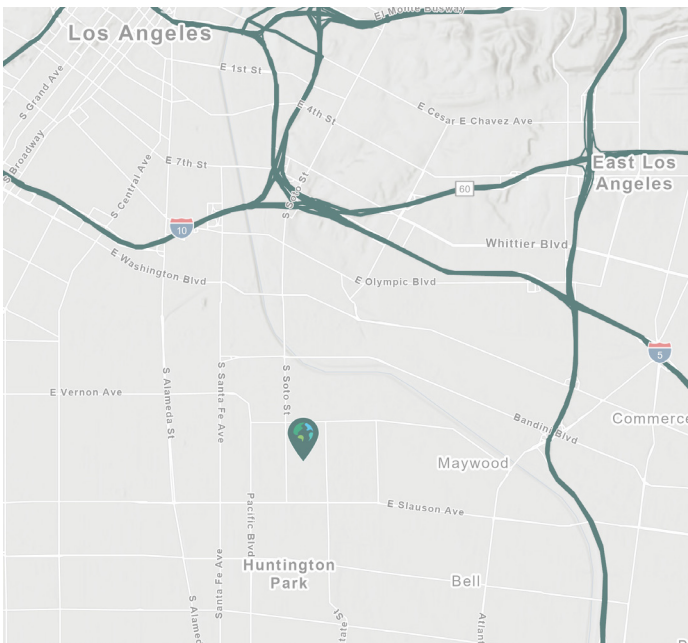

LOCATION

- Excellent Central Los Angeles County Location
- Close Proximity to 5, 10, 710, 60, 101 and 110 Freeways
- Approximately 5 miles to Downtown Los Angeles
- Approximately 22 Miles to Ports of Los Angeles & Long Beach

FACILITY

- Class "A" Corporate Headquarters Facility
- 10,146 SF Corporate Offices
- 36' Clearance
- E.S.F.R. K25 40 PSI Sprinklers
- 20 Dock High Doors/13 Trailer Stalls
- 172' Turning Radius/100% Concrete Truck Court
- 2 Ground Level Ramps
- Fenced and Secured Yard
- 60' Staging Bay & 56' x 60' Column Spacing
- 111 Car Parking (More Possible)
- 2,000 Amps (4000 Possible)
- White Scrim Foil/Painted Warehouse Walls
- 8" Concrete Warehouse Slab
- 2.5% Skylights

ADVANTAGES AND AMENITIES

- City of Vernon "Vernon Means Business"
- Low Business License Fees
- Reliable Low Cost Utilities
- In-House Health Department

Your single-source service for efficient move-in and operations: prologisessentials.com

113,952 SF

Industrial Space For Lease



Prologis Vernon Business Center

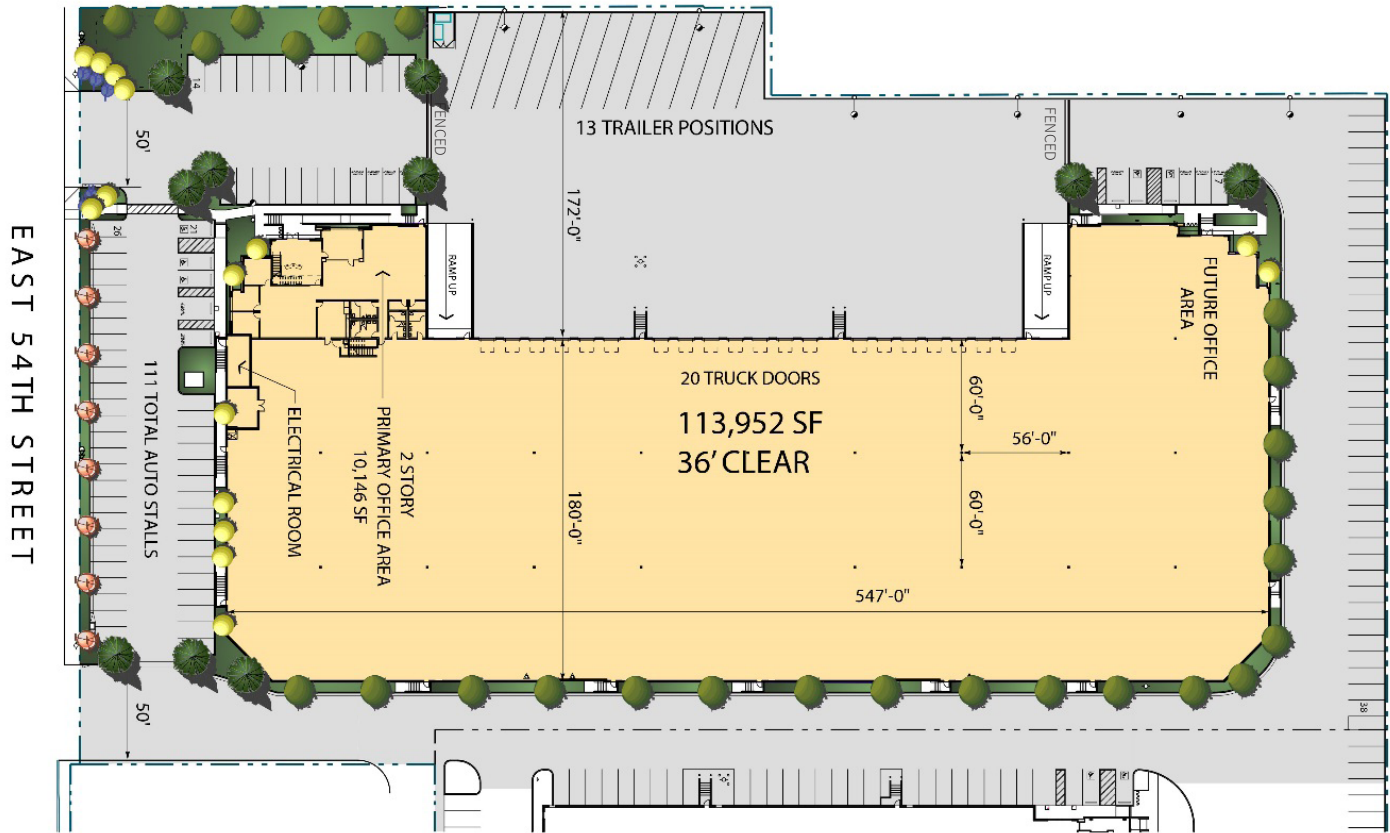

NOT TO SCALE

NEWMARK

Newmark

John McMillan
john.mcmillan@nmrk.com
CalDRE License #01103292
ph +1 310 491 2048
2301 Rosecrans Avenue
Suite 4100
El Segundo, CA 90245 USA

Newmark

Jeff Sanita
jeff.sanita@nmrk.com
CalDRE License #01242202
ph +1 310 491 2003
2301 Rosecrans Avenue
Suite 4100
El Segundo, CA 90245 USA

Newmark

Joey Farney
joey.farney@nmrk.com
CalDRE License #02218932
ph +1 310 491 2007
2301 Rosecrans Avenue
Suite 4100
El Segundo, CA 90245 USA

Newmark

Andrew Conroy
andrew.conroy@nmrk.com
CalDRE License #02143325
ph +1 310 491 2085
2301 Rosecrans Avenue
Suite 4100
El Segundo, CA 90245 USA

Prologis

Analise Guttman
aguttmann@prologis.com
CalDRE License #01966053
ph +1 562 345 9239
2141 Rosecrans Avenue
Suite 1151
El Segundo, CA 90245 USA