

# PLATFORM

START HERE.

# PLATFORM

## ABOUT THE PROPERTY

PLATFORM stands at the crossroads of commerce and creativity. This communal space, in the heart of San Antonio's arts district, combines co-working with networking in a relaxed environment. Let Platform become your departure point. **START HERE.**

PLATFORM is a 24,772 square foot mixed-use complex located at 1518 S. Alamo which explores the future of a balanced work-life. The ample parking, distinct visibility, and easy access to I-35 make it a great resource for food/beverage or freelancers and large business teams alike.

## KEY HIGHLIGHTS

- **24,772 SQ FT ON 1.5 ACRE LOT**
- **PARKING AND EASY ACCESS TO I-35**
- **WALKING DISTANCE TO BLUE STAR AND RIVER**
- **5 MINUTE DRIVE TO DOWNTOWN**
- **UNIQUE CUSTOMIZABLE OFFICE SUITES**
- **PUBLIC RECREATION, DINING, LOUNGE, WORK SPACE**

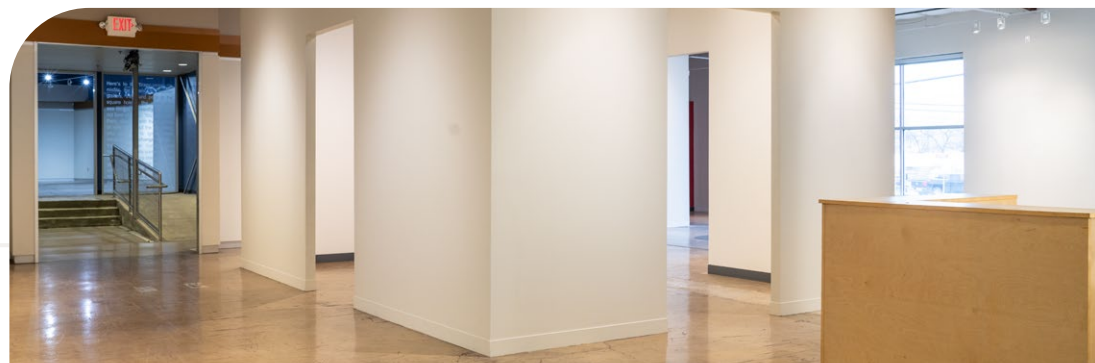

## MIMICKING ITS ADJACENT INTERSECTION, **PLATFORM** IS THE NEXUS OF SOUTHTOWN'S MANY NEIGHBORHOODS AND DISTRICTS

### ABOUT THE AREA

PLATFORM is tucked below San Antonio's downtown core in the Southtown neighborhood. This area is known for its interesting blend of districts, neighborhoods and businesses where locals live, work and play... a lot. PLATFORM is surrounded by the King William, Lavaca, Arsenal and Nathan neighborhoods along with the Blue Star, Lone Star and SoFlo districts. PLATFORM's vibrantly diverse surroundings range from restored Victorian homes, to mid-20th century reimagined uses, to contemporary homes, townhouses and apartments.

PLATFORM's adjacencies also take advantage of the San Antonio River's transition from its world-renowned urban core Riverwalk to the award-winning Mission Reach restored riparian ecosystem: 8 Miles of walking and biking trails connecting four of our Spanish colonial missions while also providing connections to the San Pedro Creek Culture Park.



RIVER ACCESS

530 FT



WALKING SCORE

55



BIKING SCORE

82





## ABOUT THE AREA CONTINUED

The King William District is the grand dame of Southtown. Established in the late 1800's, King William became the state's first National Historic District in 1967, spurring reinvestment and improvements in the latter part of the 20th century. This residential influx spawned many new businesses and restaurants, some of which have received culinary acclaim, others are merely neighborhood favorites that attract customers from all over the city.

Set between the San Antonio River and San Pedro Creek, Southtown's SoFlo is home to numerous condominiums and apartments, as well as one of San Antonio's recently designated historic neighborhood, the Nathan Historic District. With an abundance of residents, SoFlo has seen an influx of restaurants, breweries, coffee shops and other retailers including downtown's lone grocery store HEB.

## IT ALL STARTED, AND CONTINUES, WITH ART

For 35 years, contemporary art lovers and creators have descended upon Southtown due to local developers banding together to give the arts community a thriving central heart in our city. Thus, Southtown would become the epicenter for contemporary arts adjacent to downtown San Antonio. Platform's neighbor, Blue Star Arts Complex, hosted its first contemporary art exhibit in 1986. Blue Star went on to kick-off First Friday in 1994, San Antonio's longest running art walk, which is now a Southtown experience throughout the neighborhood. Another local amenity supporting the arts is the recently opened Ruby City, which is the posthumous culmination of the efforts and interests of Linda Pace. Ruby City presents works from the Linda Pace Foundation Collection comprised of more than 900 paintings, sculptures, installations and video works.

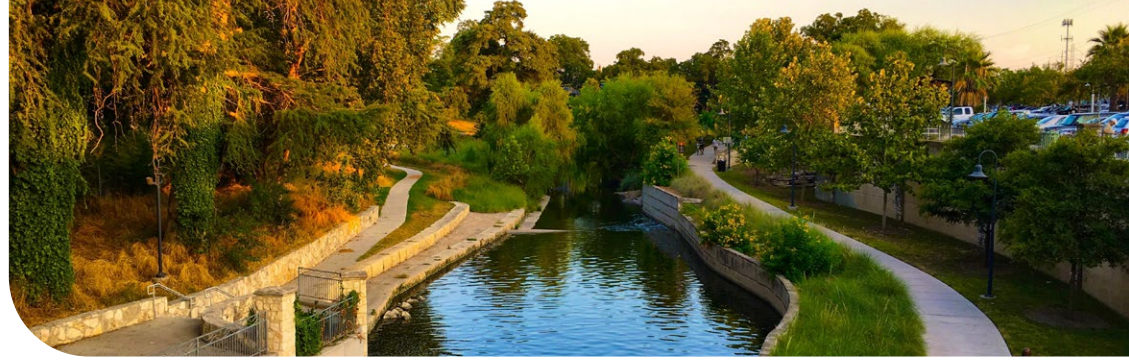



## WHAT'S NEARBY | 1518 S. ALAMO [VIEW GOOGLE MAP](#)

### LIVING

1. **THE 68'** | 151-Unit Multi Family
2. **ACERO** | 323-Unit Multi Family
3. **AGAVE APARTMENTS** | 349-Unit Multi Family
4. **CEVALLOS LOFTS** | 252-Unit Multi Family
5. **ENCORE SOFLO** | 339-Unit Multi Family
6. **THE FLATS AT BIG TEX** | 336-Unit Multi Family
7. **HEMISVIEW VILLAGE** | 245-Unit Multi Family
8. **HERITAGE PLAZA** | 341-Unit Multi Family
9. **INSPIRE DOWNTOWN** | 247-Unit Multi Family
10. **THE PEANUT FACTORY** | 102-Unit Multi Family
11. **REFUGIO PLACE** | 210-Unit Multi Family
12. **SOUTHTOWN FLATS** | 229-Unit Multi Family
13. **1010 SOUTH FLORES APARTMENTS** | 46-Unit Multi Family
14. **STEEL HOUSE LOFTS** | 67-Unit Multi Family
15. **JUDSON CANDY FACTORY LOFTS** | 84-Unit Multi Family

### BUSINESSES AND HOSPITALITY

16. **BLUE STAR** | Stella, Halcyon, Blue Star Brewing + Arts Complex
17. **HEB HEADQUARTERS** | Arsenal Campus
18. **RUBY CITY**
19. **CAMP OUTPOST CO.**
20. **DOS SIRENOS BREWING**
21. **LA TUNA ICE HOUSE**
22. **LIBERTY BAR**
23. **FRUTERIA**
24. **THE GUENTHER HOUSE**
25. **SOUTHTOWN STRIP** | Little Em's Oyster Bar, Casa Frida, Tito's, Hot Joy, Rosario's, Pizza Vesuvio, The Friendly Spot, The Good Kind + More
26. **BLISS**
27. **SOUTHTOWN PIZZERIA**
28. **MAVERICK TEXAS BRASSERIE**

● = NEIGHBORHOODS

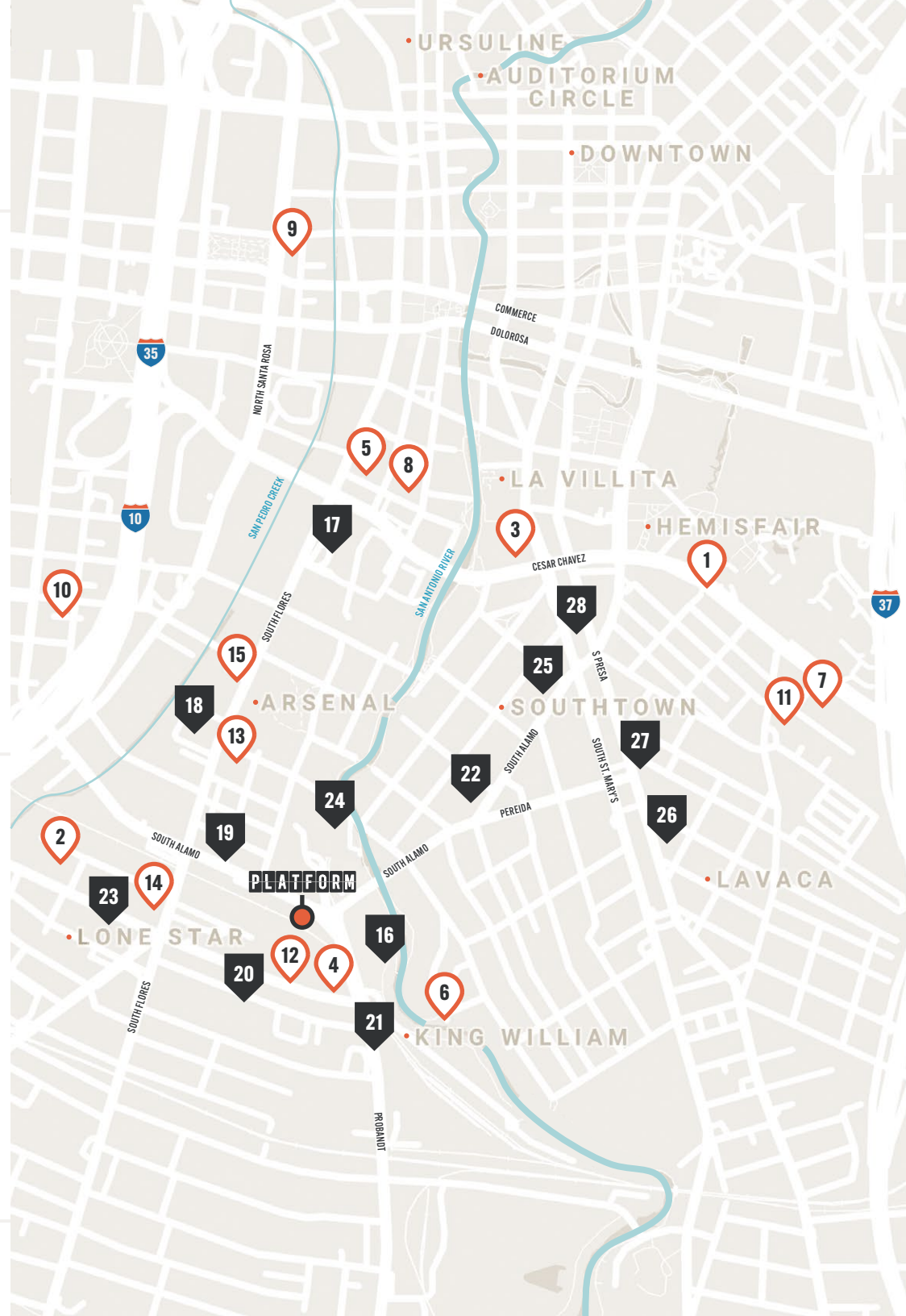

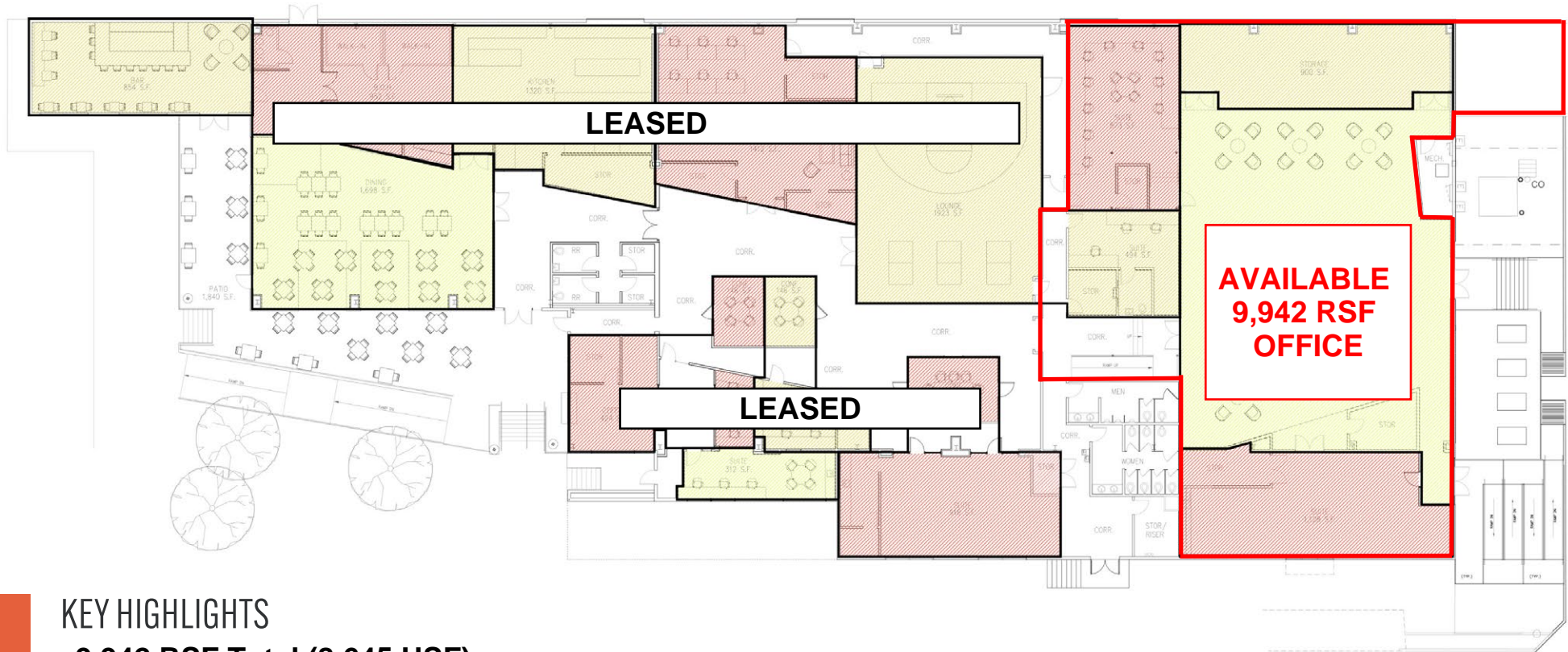

## KEY HIGHLIGHTS

- 9,942 RSF Total (8,645 USF)
- 2:1,000 SF Parking
- Open Plan With Several Private Offices & Conference Areas
- Climate Controlled Delivery/Dock Area

