

# ARTIST + FARE

1800 - 1832 PLOVER ROAD, PLOVER, WI 54467



[WWW.LOKRECOMPANIES.COM](http://WWW.LOKRECOMPANIES.COM)



2026

# CENTRAL WISCONSIN'S HUB FOR ART, FOOD, WELLNESS, & FUN

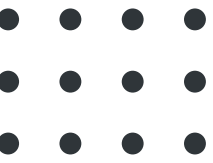

Previously a Shoko, this 40,000 SF building was converted into an unique opportunity for the entire community. Artist & Fare combines entertainment, wellness, specialty services, boutique stores, and incredible food and beverage – all in one center focused around fostering creativity, art, and community.

## **ESTABLISHED TENANTS**

Current and new tenants include Mikey's Restaurant, Mission Coffee, Anytime Fitness, O'so' Brewing, Avant Hair Lounge, and a spa collective comprising of manicure, pedicure, massage, tiny tattoos, and more.

## **HIGH-VISIBILITY OPPORTUNITY**

Just two minutes off interstate 39, nearby grocery, restaurants, and other high traffic establishment. 25,000+ cars pass by this prime location, daily. Ample parking with over 200 parking spots in front of the property.

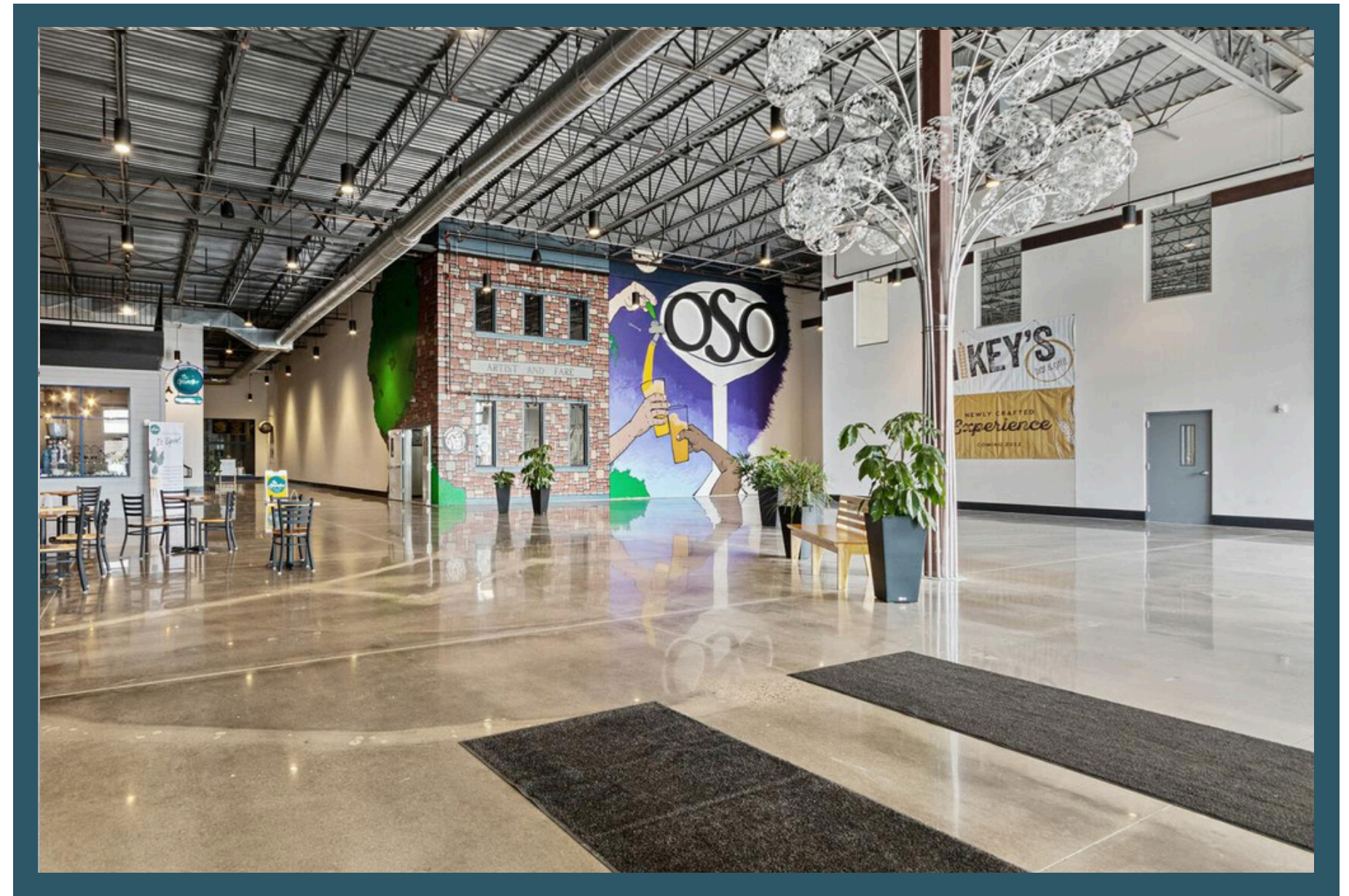

1800 - 1832 PLOVER ROAD, PLOVER, WI 54467

[WWW.LOKRECOMPANIES.COM](http://WWW.LOKRECOMPANIES.COM)

# UP TO 22,500 SF – VISIBLE TO 25,000+ CARS DAILY, TWO MINUTES FROM I-39

## — AVAILABILITY

1,000-22,500 square feet

## — NNN EXPENSES

\$5.25/SF



# VISIBLE FROM PLOVER'S BUSIEST ROADWAYS

22 MILE RADIUS POPULATION



DAILY CARS

25,000+



22 MILE RADIUS  
POPULATION

136,700



PORTAGE COUNTY  
HOUSEHOLDS

29,636



METRO AREA AVG.  
HOUSEHOLD INCOME

\$73,300

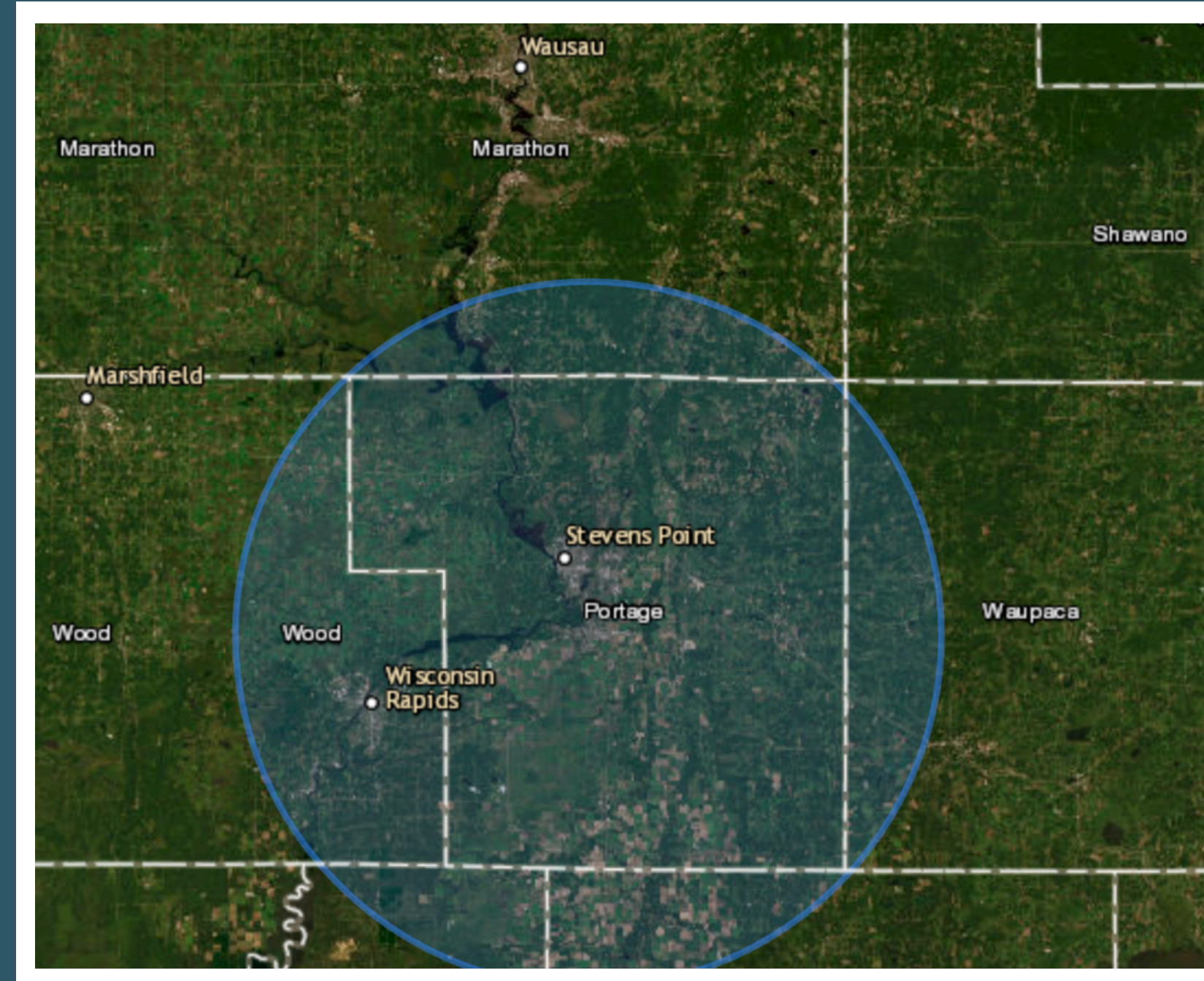

# STRONG CUSTOMER DRAW FROM ESTABLISHED NEIGHBORING BUSINESSES

## O'SO BREWING

1600+ weekly visitors

## MISSION COFFEE

600 weekly visitors

## MIKEY'S BAR & GRILL

1800 weekly visitors

## WELLNESS SPA COLLECTIVE

1000 weekly visitors

## ANYTIME FITNESS

500 weekly visitors

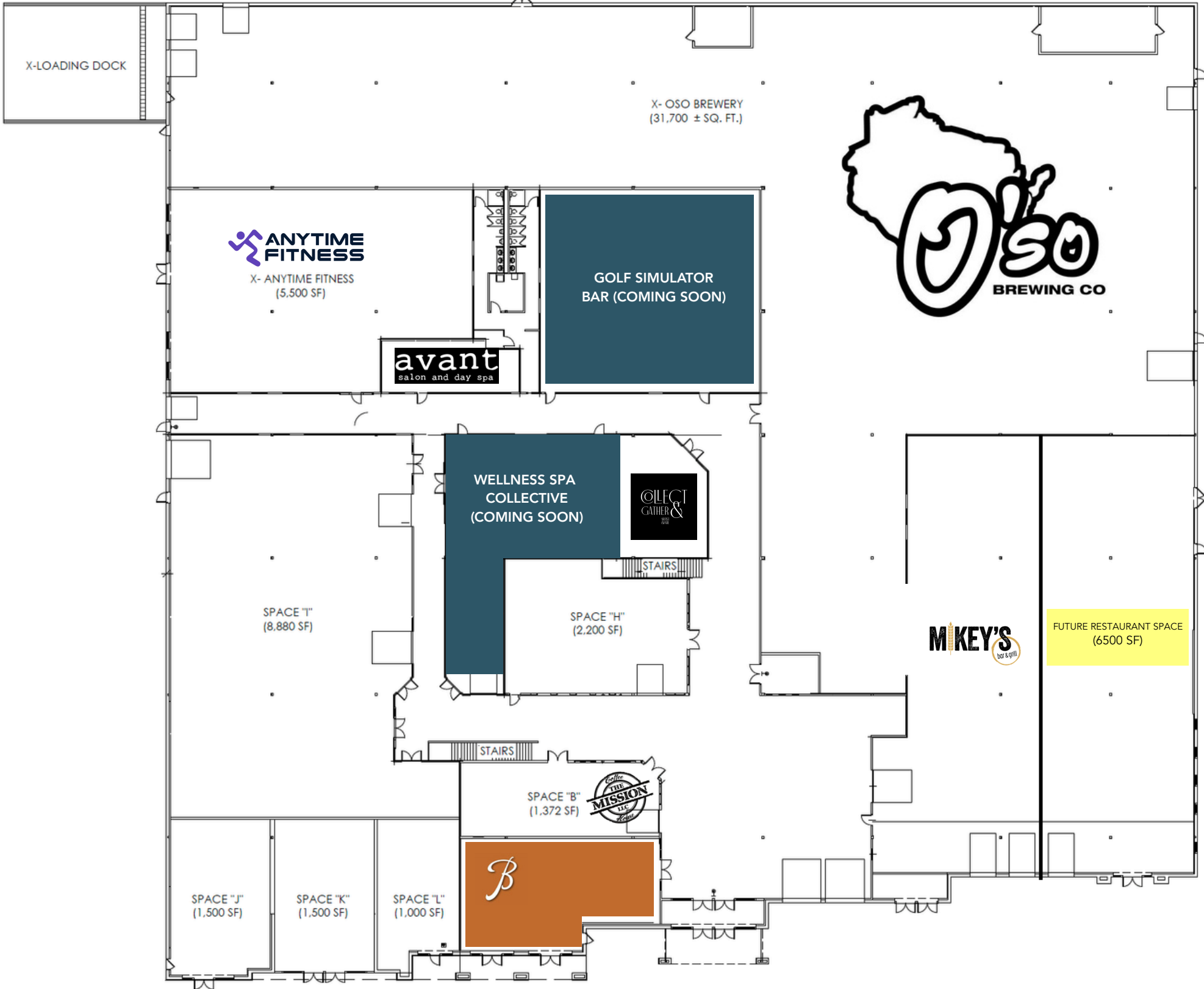

**Available Space:** 1000 SF - 8800 SF

**NNN:** \$5.25/SF

# CO-TENANTS THAT HAVE SHAPED THE PLOVER AREA



## O'so Brewing

O'so Brewing Company is a Central Wisconsin craft brewery known for its bold, creative beers and commitment to supporting local. With a welcoming taproom and rotating selection of unique brews, it's a destination for beer lovers and community events alike.



## Mission Coffee

Mission Coffee House is known for its ethically sourced coffee, handcrafted drinks, and warm, inviting spaces. With locations in Plover and Stevens Point, it's a local favorite for gathering, working, or simply enjoying a great cup of coffee.



## Mikey's Bar & Grill

Mikey's in Plover is a locally loved restaurant known for its elevated comfort food, creative cocktails, and welcoming atmosphere. With a focus on fresh ingredients and seasonal specials, it's a go-to spot for everything from casual lunches to date nights and group gatherings.

## Spa Collective

The wellness collective, a new concept, will offer services such as manicures and pedicures, waxing, facials, tiny tattoos, weight loss treatments, IV vitamin therapy, CBD and NAD therapy, and natural skin care and body sculpting options.

# THE STRIP

## AVAILABLE COMMERCIAL SPACES



**Available Space:** 1500 - 12500 SF

**NNN:** \$4.65/SF

# SITE MAP

1800 – 1832 PLOVER ROAD,  
PLOVER, WI 54467





**THANK  
YOU**

## **CONTACT US**

VICTOR ANDERSON

☎ 1.715.574.1677

🌐 [www.lokrecompanies.com](http://www.lokrecompanies.com)

📍 Wausau, WI.