

# Retail Space for Lease

# 5 Withers Street

Williamsburg, Brooklyn, NY

## Location:

NW Corner of North 9<sup>th</sup> Street & Withers Street

## Retail Space:

Ground Floor: 2,130 SF

Retail #101: 900 SF

Retail #102: 1,230 SF

## Frontage:

25 FT on Withers Street

## Ceiling Heights:

10-11 FT

## Price:

Upon request

## Highlights:

- Newly developed Retail Space available in a mixed-use building with luxury residences above
- Great Foot Traffic
- Direct Visibility from Union Avenue
- Located 3 minutes walking distance from L-train stop on Bedford Avenue and McCarren Park
- Landlord can deliver a custom build-out for Tenant



TALEA

PHEASANT

LILIA  
EST. 2018

REUNION

TATISERIE  
MOKO  
BROOKLYN

COFFEE  
VARIETY  
ROASTERS



**SLOAN  
REAL  
ESTATE**

**Call/Text:  
516 350 2621**

All information is from sources deemed reliable. No representation is made and we do not guarantee the accuracy of any information provided. All information must be independently verified. The value of any real estate investment is dependent on a variety of factors and should be evaluated carefully by prospective purchasers/ or tenants.

# 5 Withers Street

## Ground Floor Retail Floorplan

Williamsburg, Brooklyn, NY

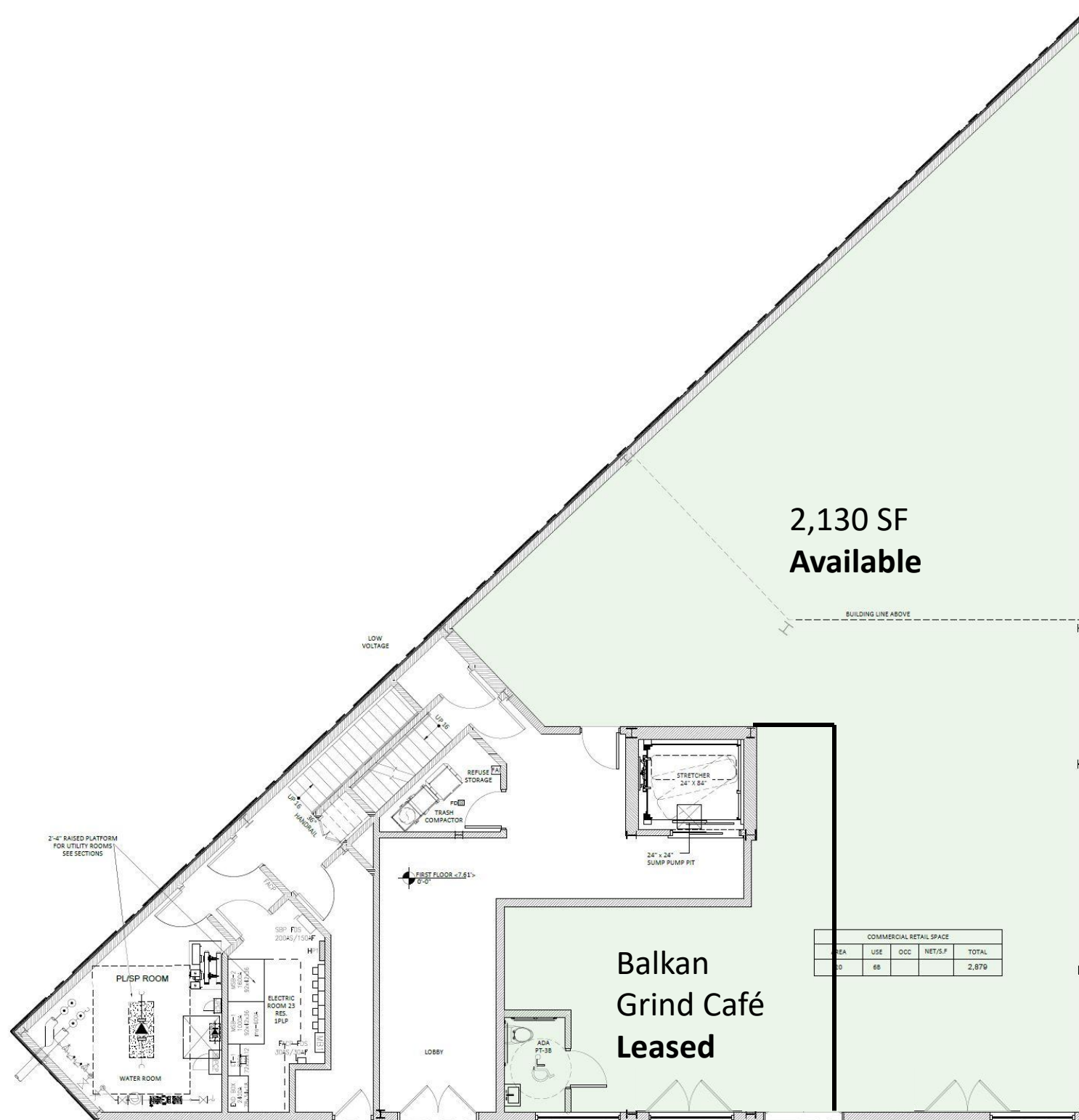

# 5 Withers Street

## Ground Floor Potential Divisions

Williamsburg, Brooklyn, NY

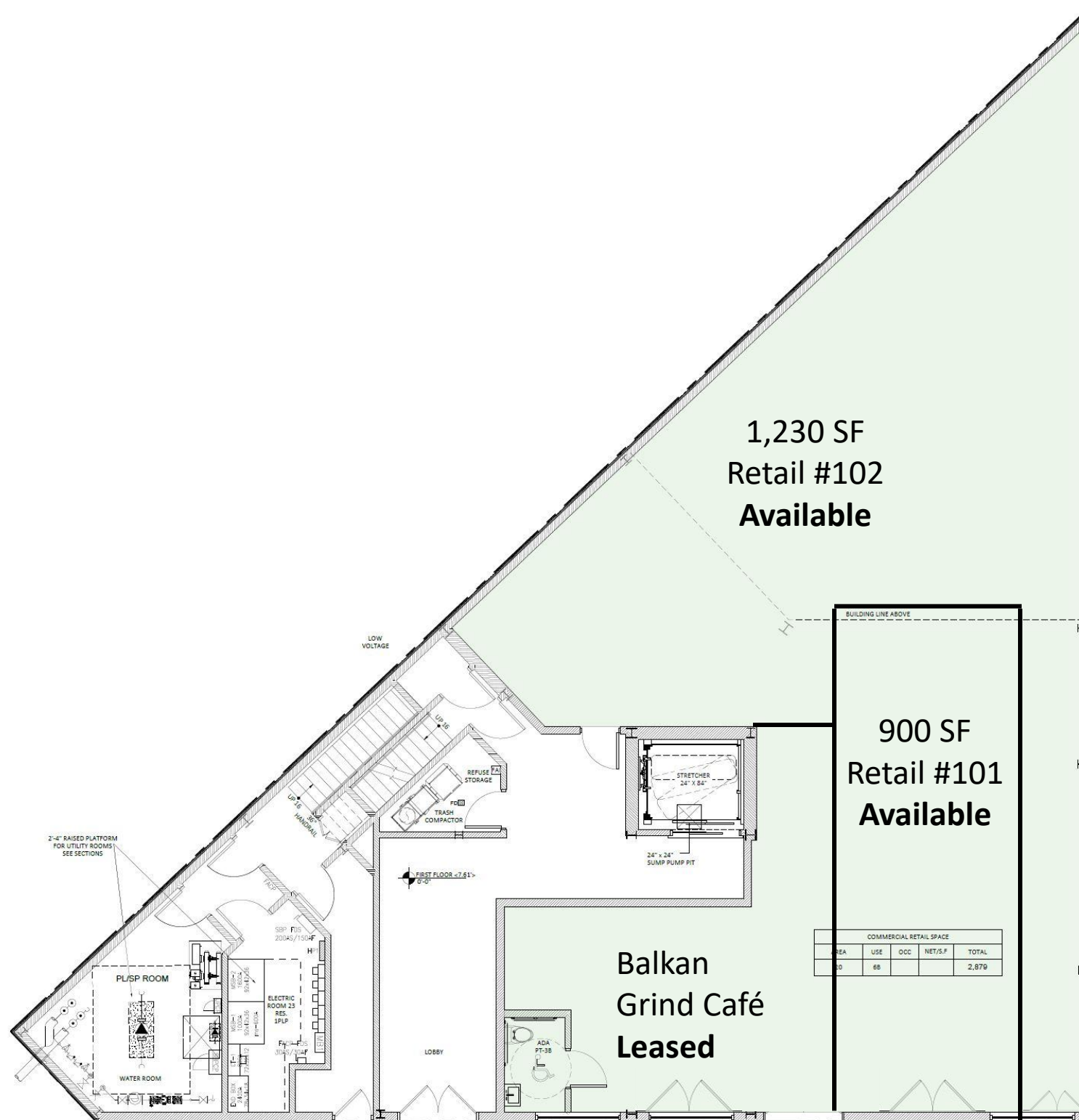

# 5 Withers Street

## Photos

Williamsburg, Brooklyn, NY



# 5 Withers Street

Williamsburg, Brooklyn, NY

## Local Map

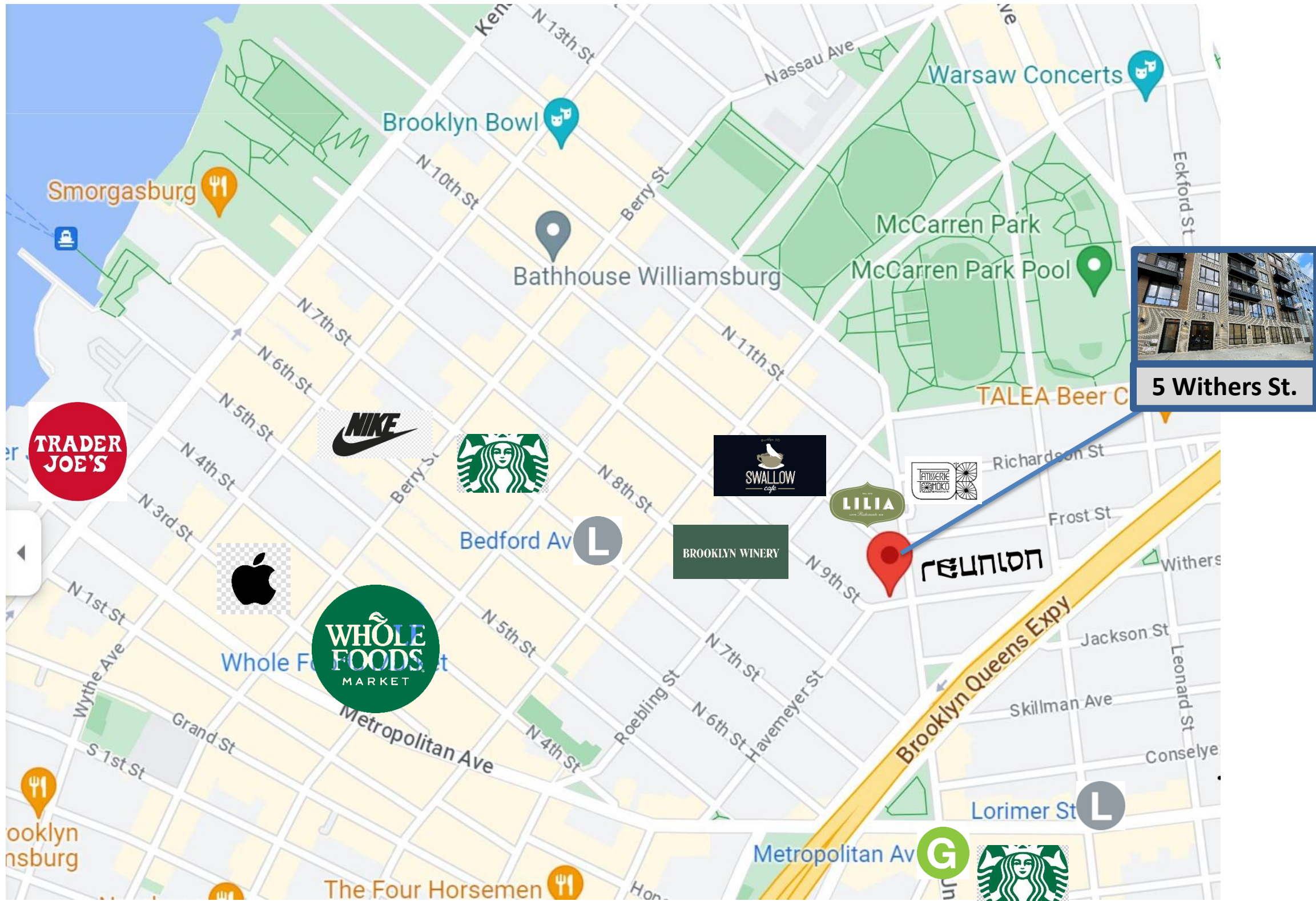

# CONTACT

---

**JOSH SLOAN**

516-350-2621

JS@SLOAN-RE.COM