

# For sublease

## Class A Office Space

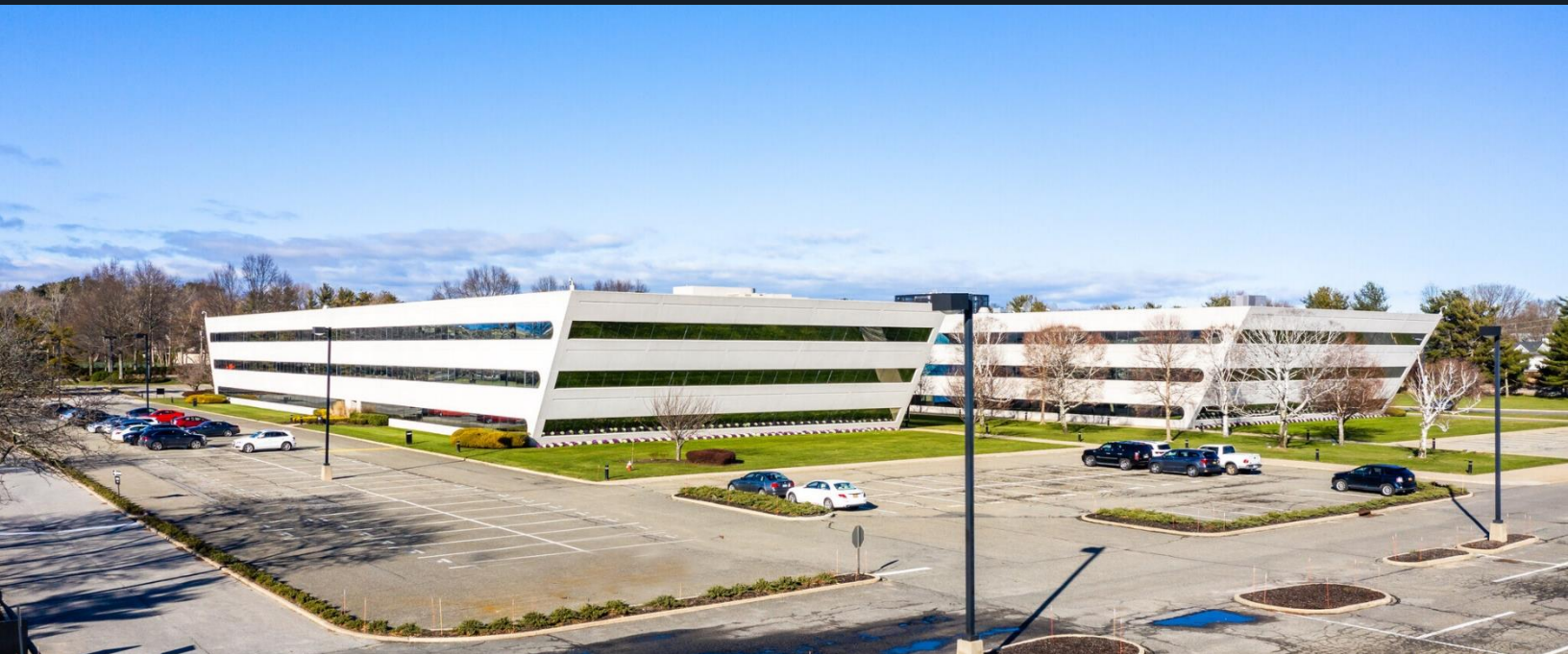

### Property specifications

Available size	Part 3rd floor – Entire Wing B: 55,361 SF (Divisible)
Possession	Arranged
Term	Thru 4/30/2030
Rental rate	Upon request
Space features	<ul style="list-style-type: none"><li>• Furniture may be available</li><li>• 168 cubicles / 63 offices</li><li>• Multiple conference rooms</li><li>• Above standard finishes</li><li>• Custom wood interior throughout</li><li>• Glass front offices throughout</li><li>• Multiple private bathrooms</li><li>• Large training room</li></ul>

- |                     |   |
|---------------------|---|
| Building highlights | <ul style="list-style-type: none"><li>• Concierge</li><li>• Full-service café</li><li>• Fitness center</li><li>• Newly renovated lobby</li><li>• 24-hour security desks</li><li>• Abundant parking</li><li>• New hotel planned in building parking lot</li><li>• Direct access from Exit 40E of the LIE</li></ul> |
|---------------------|---|

### One Jericho Plaza Jericho, NY

---

#### Michael Aievoli

Executive Vice President

+1 631 962 7380

[mike.aievoli@am.jll.com](mailto:mike.aievoli@am.jll.com)

---

# Floor plan

Part 3rd floor - Entire Wing B: 55,361 SF

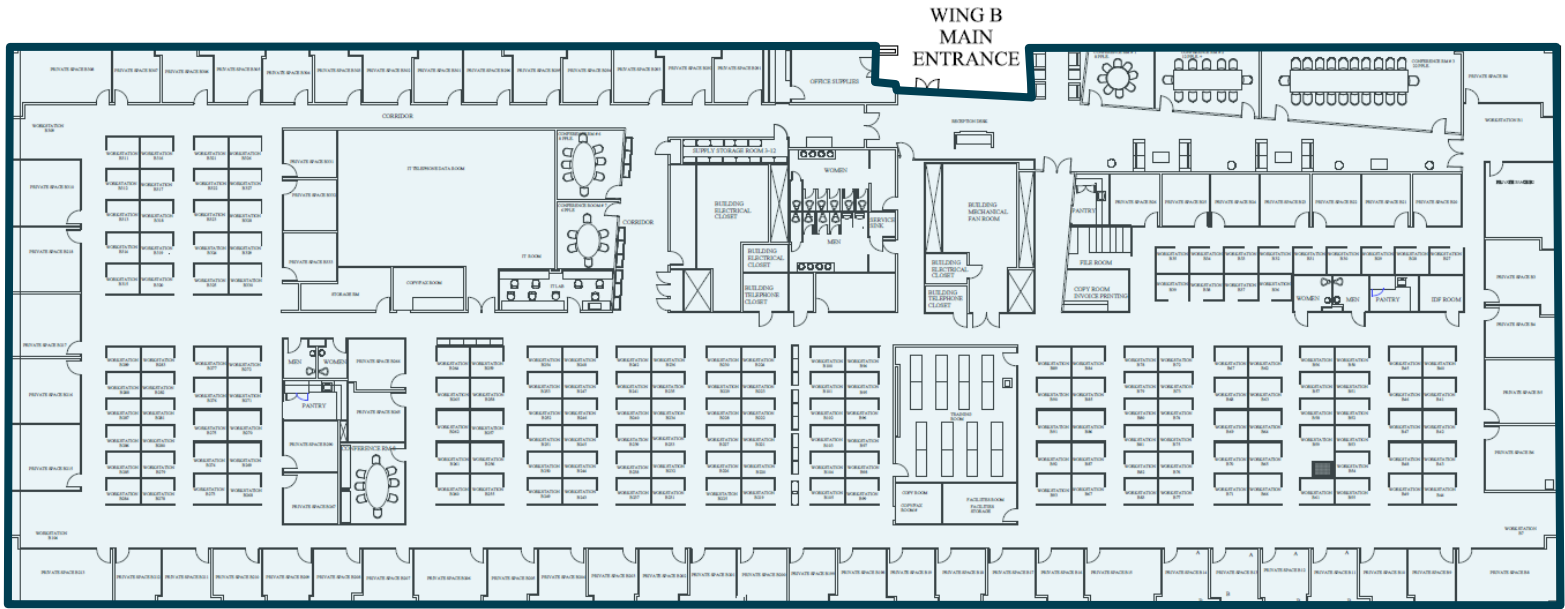

# Interior photos

