

RENE' NELSON, CCIM

Pacwest Commercial Real Estate, Inc.

NOW LEASING

Downtown Executive Suites



1177 Pearl Street, Eugene, Oregon 97401



For more information call:

René Nelson, CCIM
(541) 912-6583

rene@1031guru.com
www.eugene-commercial.com

- Prominent second-floor office space in downtown Eugene
- Approximately 1,950 SF with multiple private offices
- Two separate entrances to the second floor
- Two restrooms on-level with full support areas included
- On-site parking available; walkable to downtown amenities
- No elevator — walk-up second floor only
- Move-in ready
- From \$149/mo — utilities included

*See Floor Plan for Current
Availability and Monthly Expense*

This information deemed reliable but no representations or warranties are expressed or implied as to the accuracy. References to square footage and age are approximate. Tenant/Buyer must verify the information and bears all risk for any inaccuracies. René Nelson, CCIM | Pacwest Commercial Real Estate, Inc. | 541-912-6583 | rene@1031guru.com

RENE' NELSON, CCIM

Pacwest Commercial Real Estate, Inc.

NOW LEASING

Lease One Office or the Entire Floor

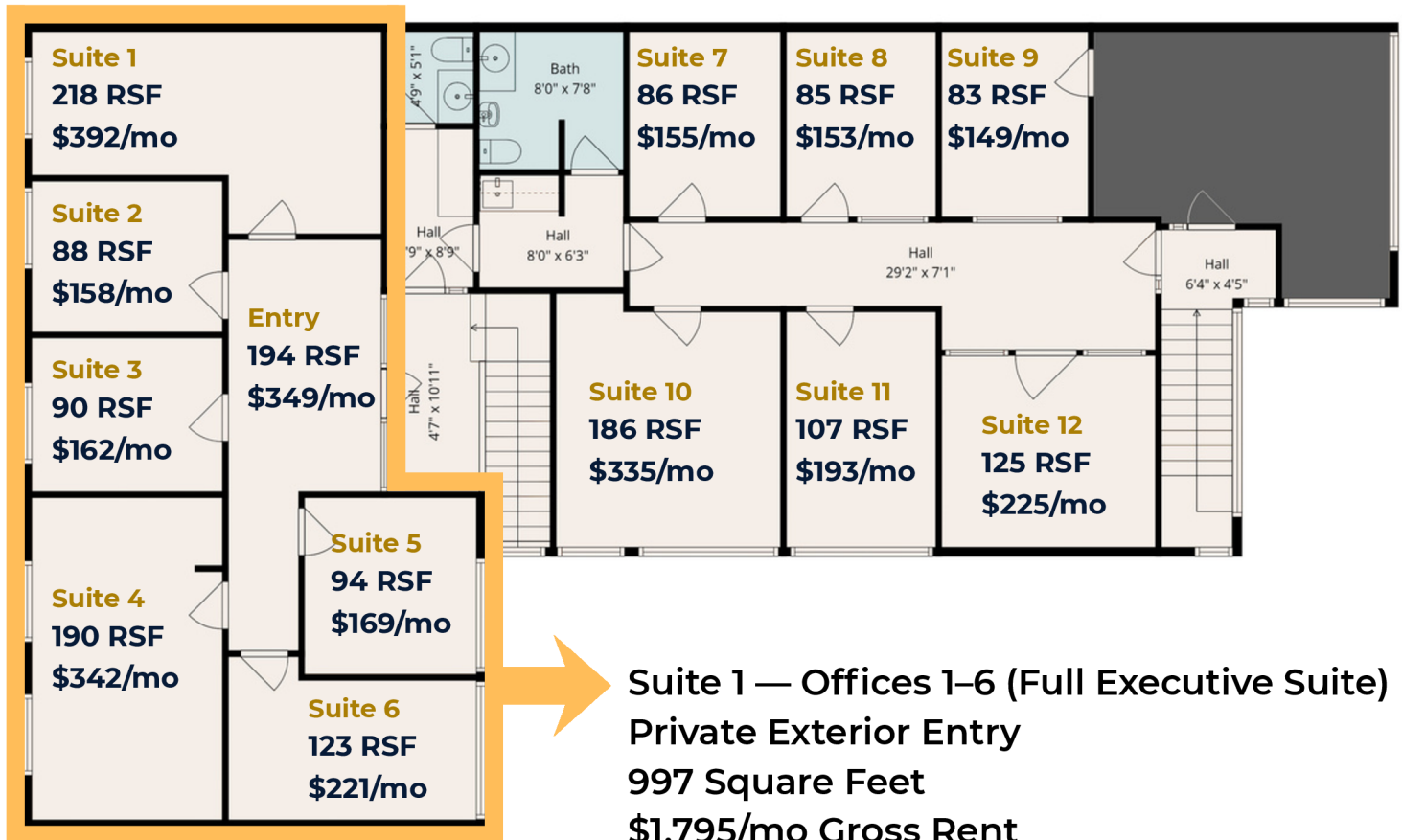

All rates include utilities.

Tenant responsible for their own Wi-Fi.