

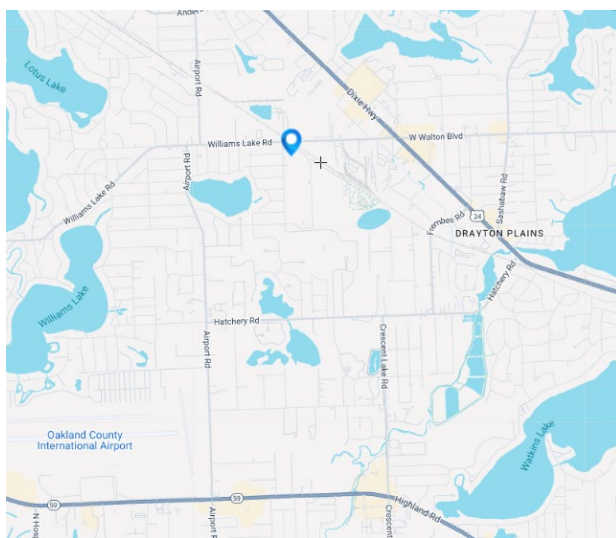

**FOR SUBLEASE**

# 5499 Perry Dr

Waterford, MI



## Property Highlights

- 5,400 SF Available for Sublease
- (4) 12' x 14' Grade Level Doors
- 16' Clearance
- Clear Span
- 3 Phase Power
- Convenient Access to US-24 (Dixie Highway) and M-59

For information, please contact:

**Teddy O'Keefe**

Associate

t 248-447-2715

teddy.okeefe@nmrk.com

**Mike Davidson**

Senior Managing Director

t 248-357-6599

mike.davidson@nmrk.com

[nmrk.com](http://nmrk.com)

**NEWMARK**

The information contained herein has been obtained from sources deemed reliable but has not been verified and no guarantee, warranty or representation, either express or implied, is made with respect to such information. Terms of sale or lease and availability are subject to change or withdrawal without notice.

## Sublease

5499 Perry Dr Waterford, MI 48329



### Pricing Information:

**Lease Rate Range:** \$11.33-\$11.33

**Lease Type:**

**Sale Price:** N/A

**Price per SF:** N/A

**Real Estate Taxes psf:** \$0.00

**Building Insurance psf:** \$0.00

**CAM psf:** N/A

### Property Details:

**Total Building Area:** 18,000 sf  
**Min/Max Available:** 5,400 sf  
**Office Area:** 2,000 sf  
**Property Type:** General Industrial  
**Tenancy:** Multi-tenant  
**Year Built:** 01/01/1995  
**Year Renovated:**  
**Zoning:** I-1  
**Site/Parcel Area:** 6.01 acres

**Parcel ID:** 13-09-251-048  
**Parking Description:** Ample  
**Rail Served:** No  
**Cranes:** No  
**Heat:** GFA  
**Clear Height Min/Max:** 16.0 '  
**Grade/Dock Doors:** 4 / 0  
**Sprinkler:** No  
**Power:** NA

### Comments:

Very clean multi-tenant building featuring three contiguous clear-span units with four 12' x 14' grade-level doors. Includes 2,000 SF of office space available for sublease. Conveniently located near US-24 and Williams Lake Road.

### Teddy O'Keefe

248.447.2715

[Teddy.Okeefe@nmrk.com](mailto:Teddy.Okeefe@nmrk.com)

### Michelle Davidson

512.637.1223

[mdavidson@ngkf.com](mailto:mdavidson@ngkf.com)

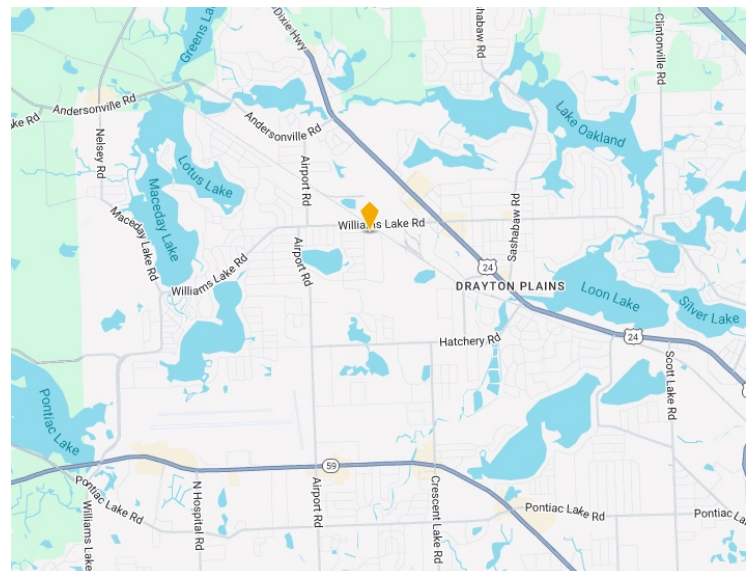

## 5499 Perry – Floor Plan

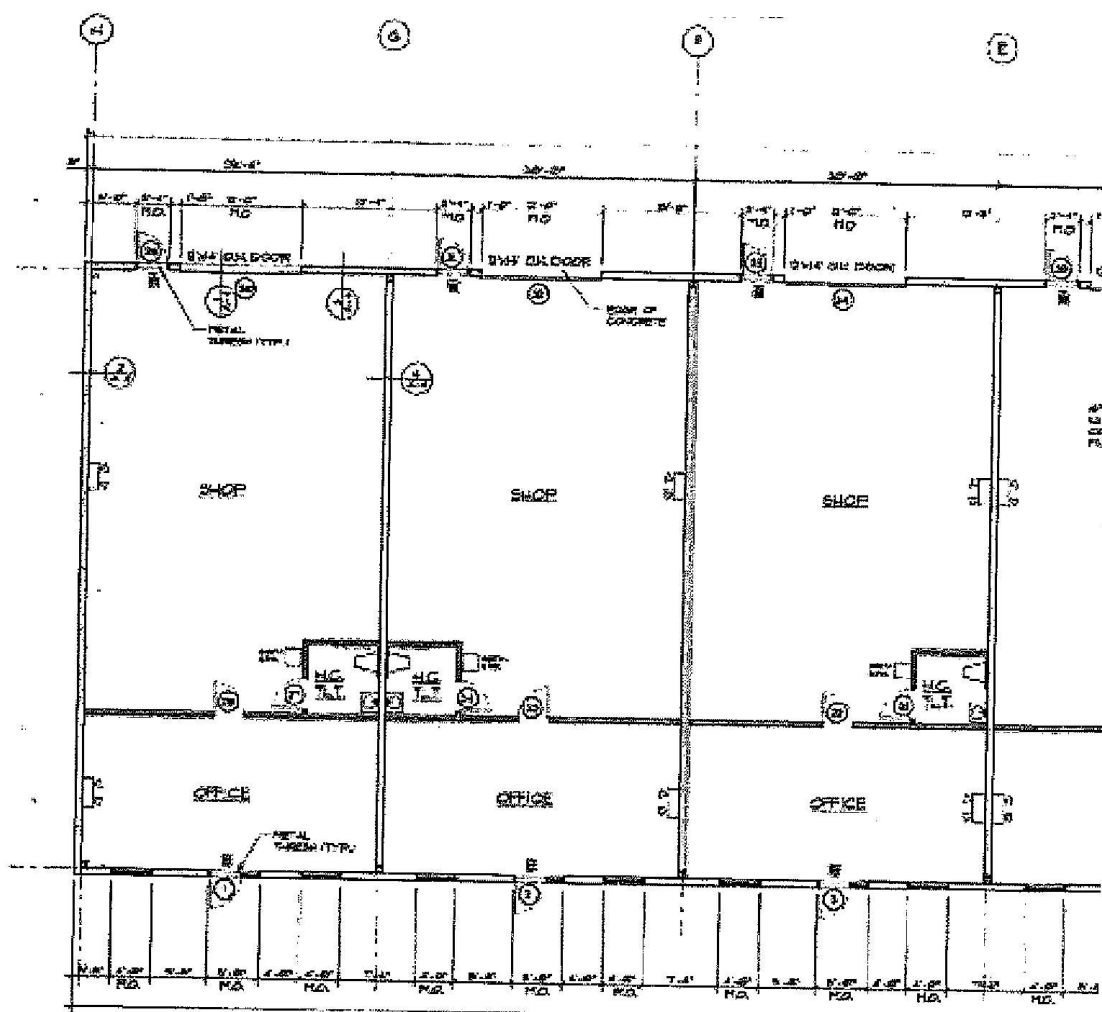

# NEWMARK





**NEWMARK**