



1420 VICEROY

1420 VICEROY DRIVE, DALLAS, TX 75235

40,580 SF, 2-STORY OFFICE BUILDING
FOR LEASE OR FOR SALE



**CUSHMAN &
WAKEFIELD**



PROPERTY HIGHLIGHTS



40,580 RSF Office Building For Lease or For Sale



Easy Access To:

- I-35
- Love Field
- Park Cities
- Uptown



2-Story Office on 3+ Acres of Land



Adjacent to Brook Hollow Golf Club



Built in 1971
Renovated in 1999



Excess Land for Corporate Events or Onsite Storage



171 Car Parking (20 Covered)



Backup Generator Available

FLOOR PLANS

FLOOR 1

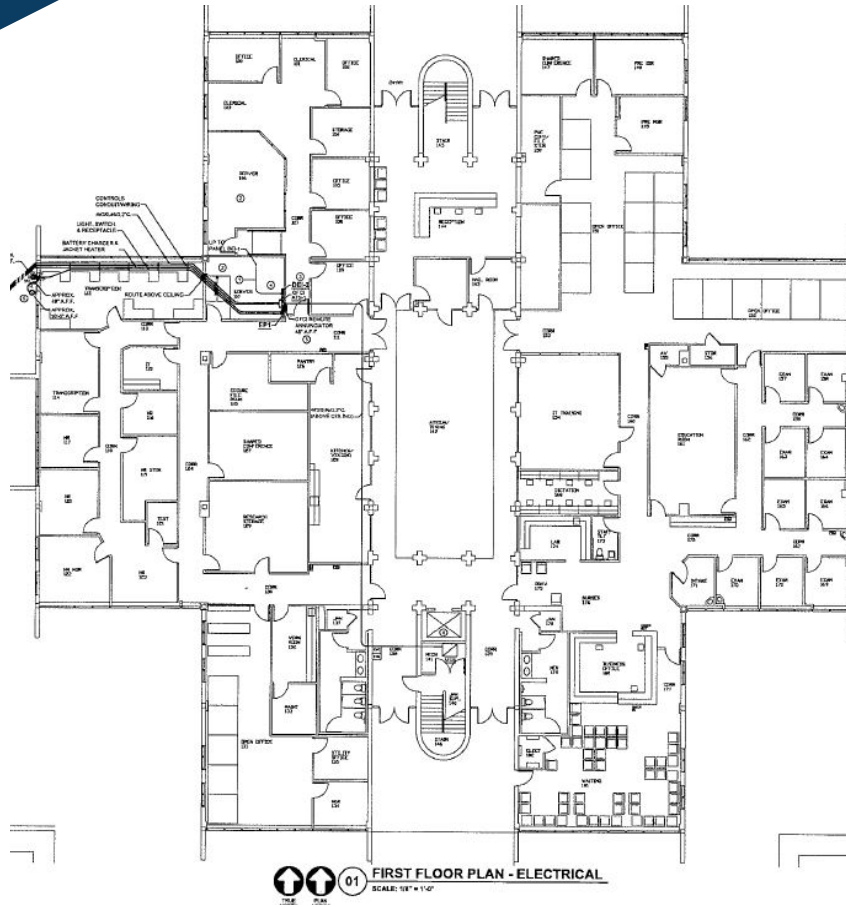

FLOOR 2

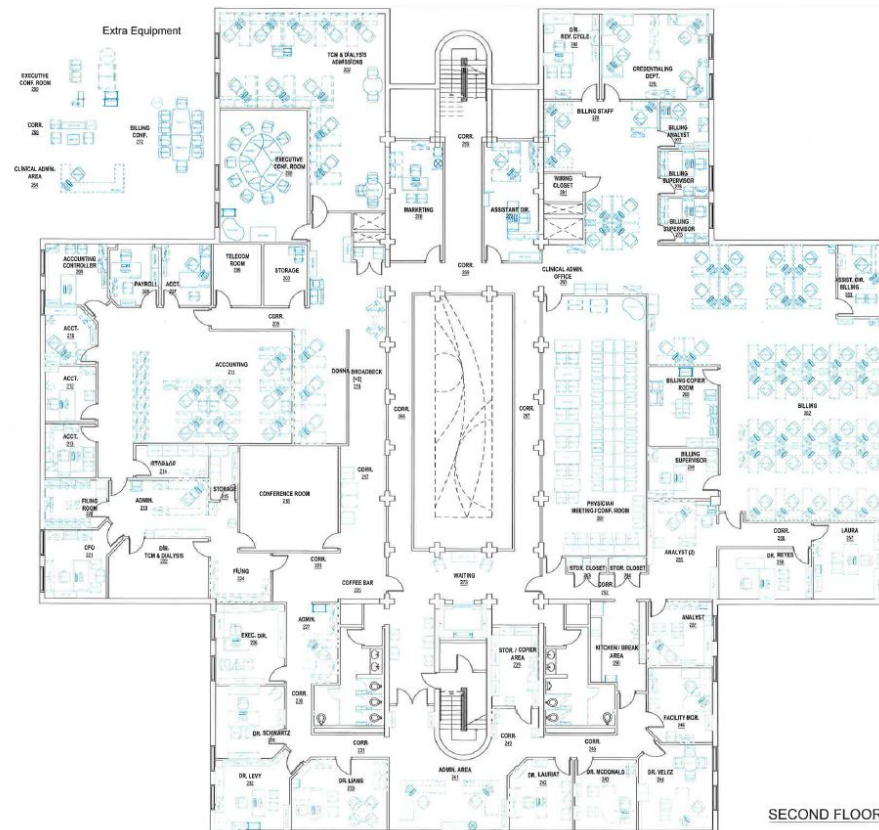

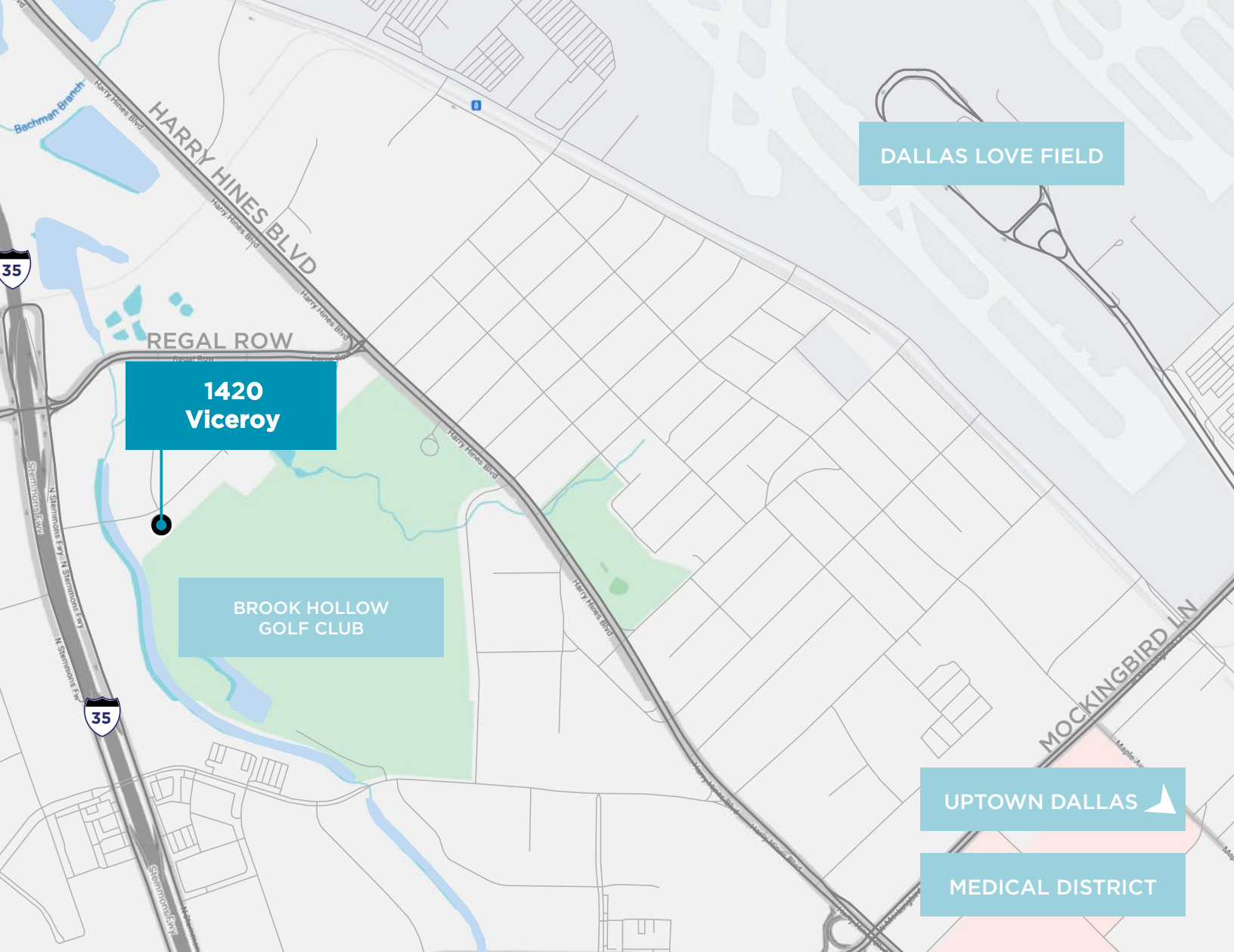

DALLAS LOVE FIELD

1420
Viceroy

BROOK HOLLOW
GOLF CLUB

UPTOWN DALLAS

MEDICAL DISTRICT

CONTACT INFO

MARK BECKER

+1 972 663 9757

mark.becker@cushwake.com

STEVE WENTZ

+1 972 663 9654

steve.wentz@cushwake.com



**CUSHMAN &
WAKEFIELD**

©2023 Cushman & Wakefield. All rights reserved. The information contained in this communication is strictly confidential. This information has been obtained from sources believed to be reliable but has not been verified. NO WARRANTY OR REPRESENTATION, EXPRESS OR IMPLIED, IS MADE AS TO THE CONDITION OF THE PROPERTY (OR PROPERTIES) REFERENCED HEREIN OR AS TO THE ACCURACY OR COMPLETENESS OF THE INFORMATION CONTAINED HEREIN, AND SAME IS SUBMITTED SUBJECT TO ERRORS, OMISSIONS, CHANGE OF PRICE, RENTAL OR OTHER CONDITIONS, WITHDRAWAL WITHOUT NOTICE, AND TO ANY SPECIAL LISTING CONDITIONS IMPOSED BY THE PROPERTY OWNER(S). ANY PROJECTIONS, OPINIONS OR ESTIMATES ARE SUBJECT TO UNCERTAINTY AND DO NOT SIGNIFY CURRENT OR FUTURE PROPERTY PERFORMANCE.