

44191 PLYMOUTH OAKS BLVD

UNIT #100

PLYMOUTH TWP, MICHIGAN

HI-TECH FOR SUBLEASE

10,842 Square Feet Available



**SIGNATURE
ASSOCIATES**
KNOW SIGNATURE | KNOW RESULTS

PLYMOUTH OAKS BUSINESS CENTER



PROPERTY FEATURES

- 10,842 square feet available
- 4,996 square feet office
- 18' clear height
- (3) 12' x 14' grade level doors
- Zoned light industrial
- Located on 4.310 acres
- Corner unit offers ample window-line
- 50/50 split of office and warehouse
- Great opportunity to be in one of the premier technology parks in Plymouth
- Lease Rate: Contact Broker

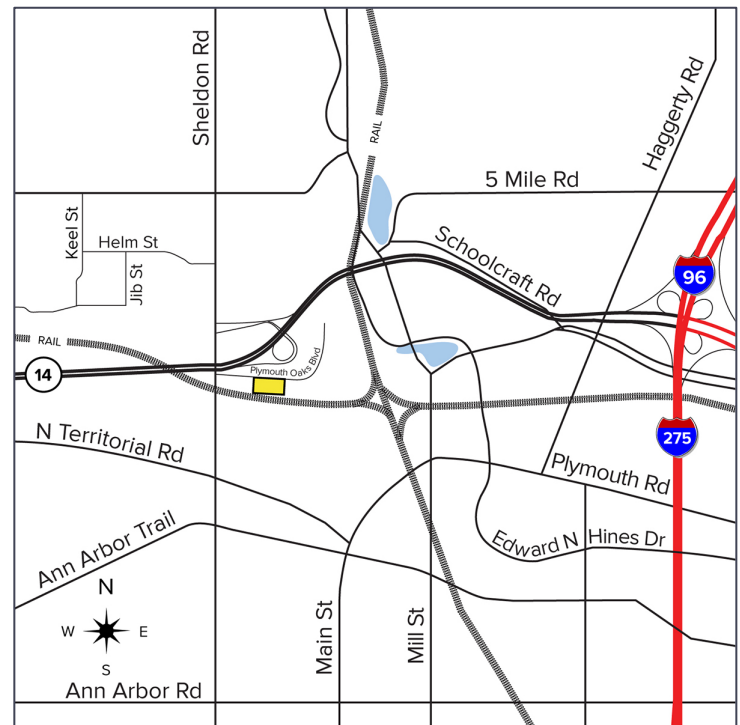

For more information, please contact:

JASON STOUGH

(248) 948 4180

jstough@signatureassociates.com

CHRIS D'ANGELO

(248) 948 0109

cdangelo@signatureassociates.com

SIGNATURE ASSOCIATES

One Towne Square, Suite 1200

Southfield, MI 48076

www.signatureassociates.com

44191 Plymouth Oaks Blvd – Plymouth Twp., Michigan

Hi-Tech For Sublease

10,842
Square Feet
AVAILABLE

Site Plan

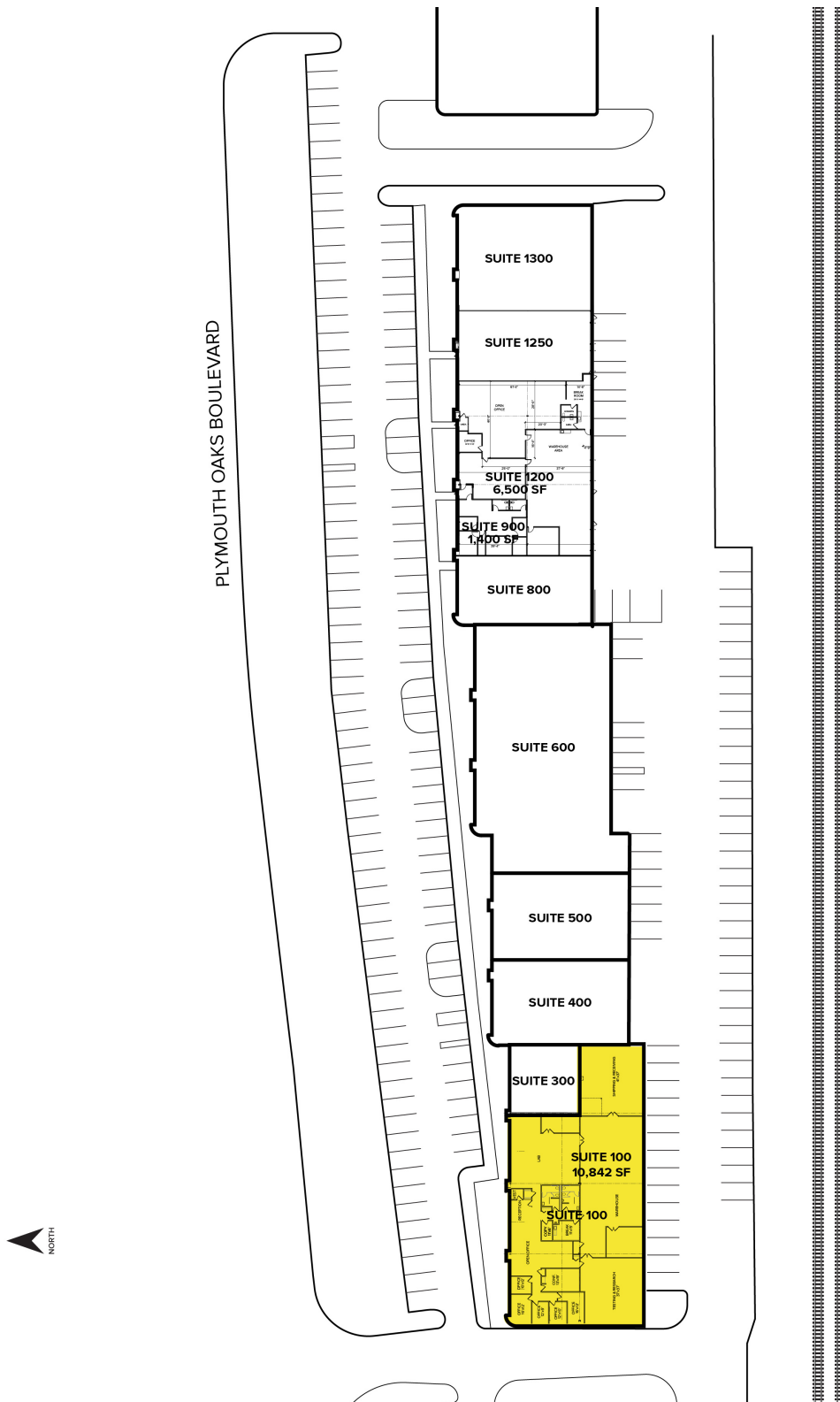

For more information, please contact:

JASON STOUGH

(248) 948 4180

jstough@signatureassociates.com

CHRIS D'ANGELO

(248) 948 0109

cdangelo@signatureassociates.com

SIGNATURE ASSOCIATES

One Towne Square, Suite 1200

Southfield, MI 48076

www.signatureassociates.com

44191 Plymouth Oaks Blvd – Plymouth Twp., Michigan

Hi-Tech For Sublease

10,842
Square Feet
AVAILABLE

Floor Plan

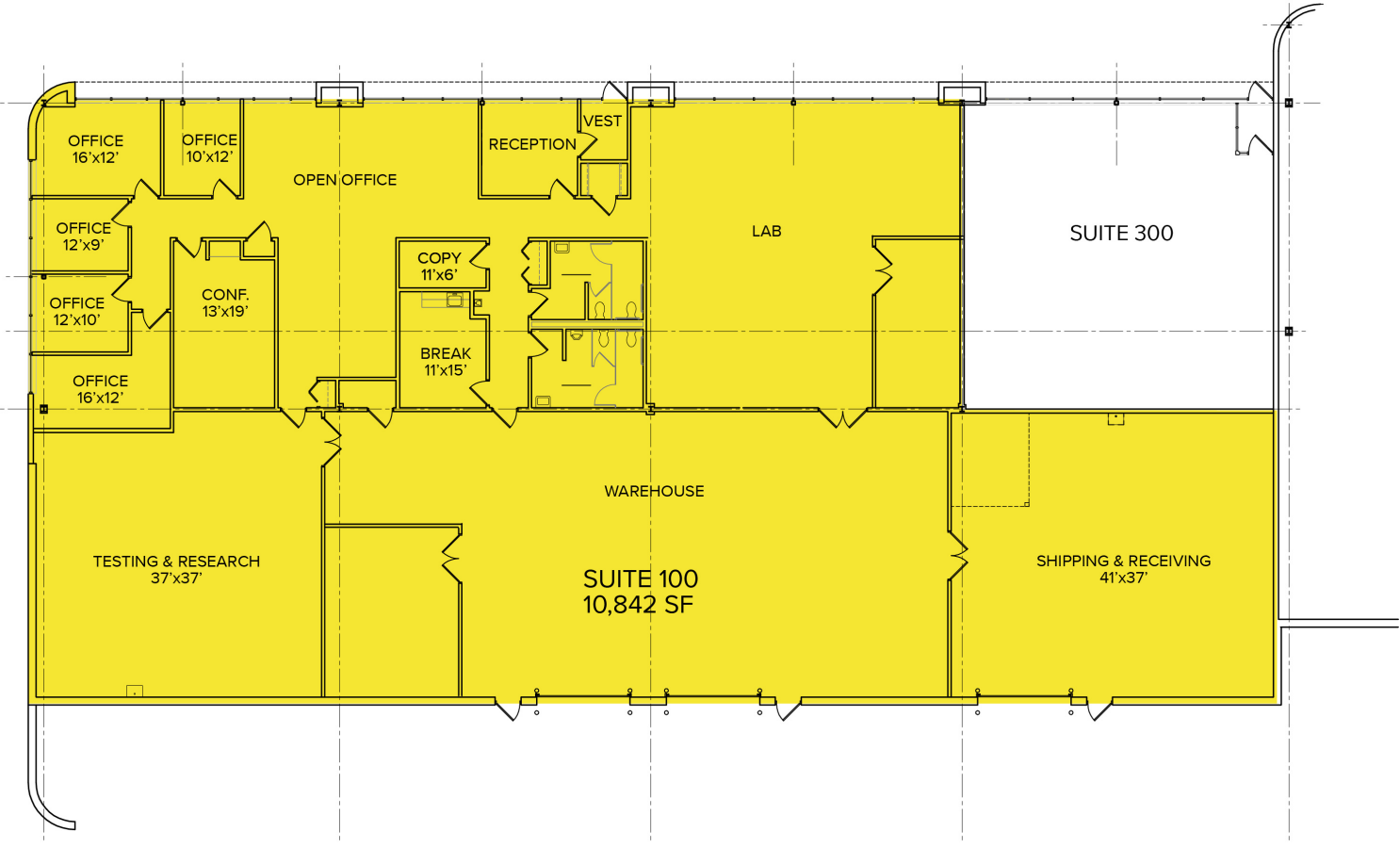

For more information, please contact:
JASON STOUGH
(248) 948 4180
jstough@signatureassociates.com

CHRIS D'ANGELO
(248) 948 0109
cdangelo@signatureassociates.com

SIGNATURE ASSOCIATES
One Towne Square, Suite 1200
Southfield, MI 48076
www.signatureassociates.com

Information is subject to verification and no liability for errors or omissions is assumed. Price is subject to change and listing withdrawal.

44191 Plymouth Oaks Blvd – Plymouth Twp., Michigan

Hi-Tech For Sublease

10,842
Square Feet
AVAILABLE

Aerial



For more information, please contact:

JASON STOUGH
(248) 948 4180
jstough@signatureassociates.com

CHRIS D'ANGELO
(248) 948 0109
cdangelo@signatureassociates.com

SIGNATURE ASSOCIATES
One Towne Square, Suite 1200
Southfield, MI 48076
www.signatureassociates.com

Information is subject to verification and no liability for errors or omissions is assumed. Price is subject to change and listing withdrawal.