

OFFERING MEMORANDUM

19515 Tamarack Lane
Ordway, CO 81063

PRESENTED BY:

Brett Bennett
Ajax Realty Group
303-549-4182
brett@ajaxrealtygroup.com

All information herein is deemed reliable, but not guaranteed.

Buyer to verify any and all information.



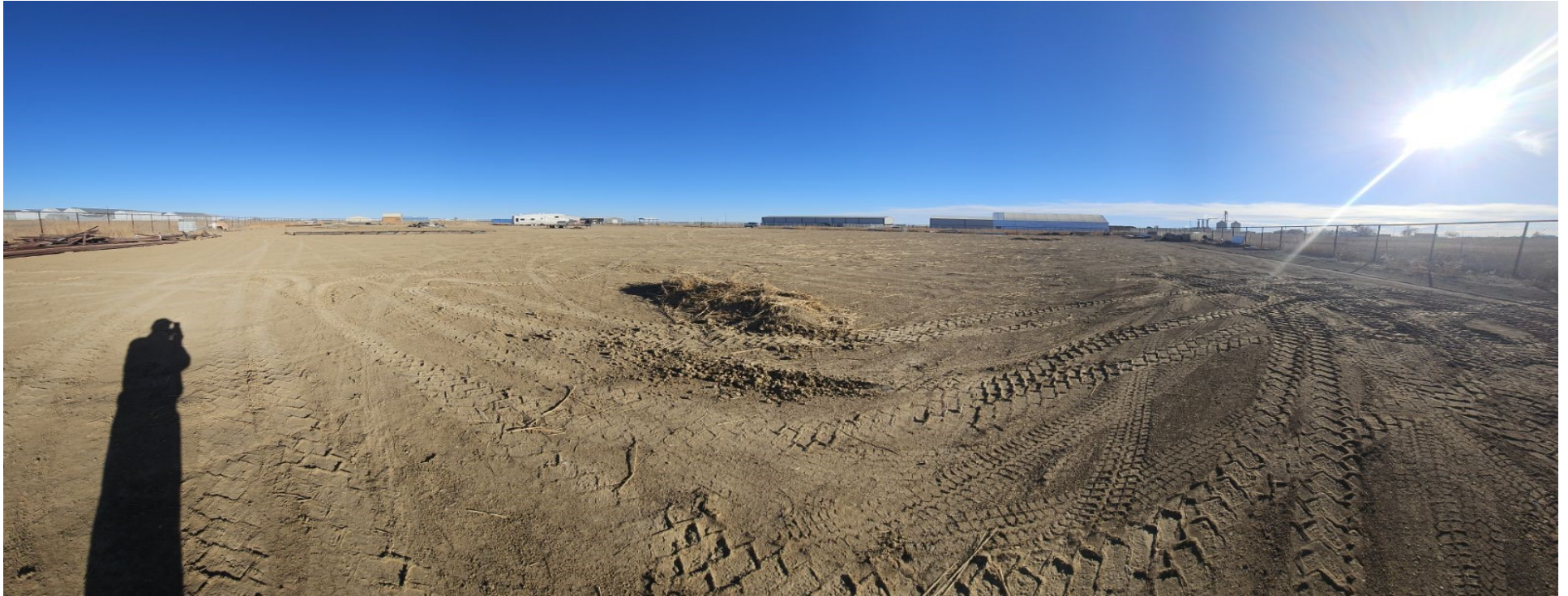

OFFERING SUMMARY:

SALE PRICE:	\$65,000
SALE TYPE:	Owner/User or Investment
LOT SIZE:	2.57 Acres
ZONING:	Industrial

PROPERTY OVERVIEW

Check out this fantastic 2.5 acre lot in Ordway Colorado. The property offers great views, and is fully fenced around the entire perimeter with an access gate. The property is graded and level and is zoned for Residential, Agricultural, Commercial or Special Use. The water line has been stubbed to the property and water is provided by the Town of Ordway. Electrical is adjacent to the property. Come see this lot and it's possibilities today.

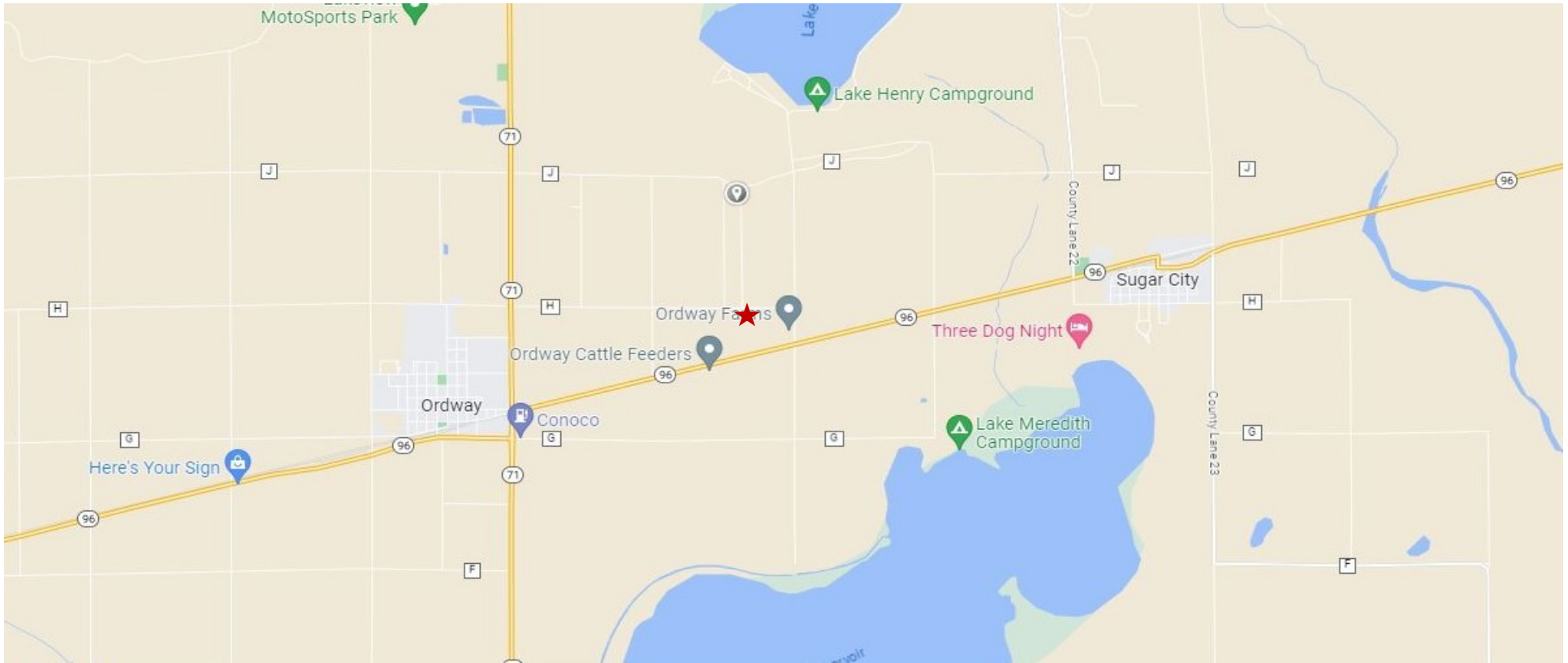

ORDWAY, CO

Ordway is a city located in Crowley County, Colorado. It is the county seat of Crowley County.

CITY INFORMATION

CITY POPULATION (2023)	1,257
CROWLEY COUNTY POPULATION: (2022)	5,614
AVERAGE HOUSEHOLD INCOME:	\$46,515
MEDIAN HOUSE VALUE:	\$146,777
UNEMPLOYMENT RATE (July 2023):	5.9%

<https://worldpopulationreview.com/us-cities/ordway-co-population>

<https://www.zillow.com/home-values/6339/ordway-co/>

<https://www.bestplaces.net/economy/city/colorado/ordway>

DRIVING DIRECTIONS:

If coming from I-25 and State Hwy 50 in Pueblo, CO - Go east on State Hwy 50 to State Hwy 96 N. Go left or northeast on State Hwy 96. Follow State Hwy 96 east to the town of Ordway, CO. Go north or left on County Road 71. Go right on County Road H and continue east. Take a right onto Maverick Lane. Continue South on Maverick Lane to Tamarack. On NW Corner.

