



209 10TH AVE S

FOR SUBLEASE | 2,820 SF | GULCH

FOUNDRY
COMMERCIAL

PROPERTY OVERVIEW



PROPERTY DETAILS

| | |
|---------------|--|
| ADDRESS | 209 10th Ave S |
| SUBMARKET | Gulch |
| TERM | Sublease expires 4/30/2025 |
| RATE | \$40/SF FSG |
| SUITE | 416 and 418 |
| SF AVAILABLE | 2,820 |
| PARKING RATIO | 8 Parking Spaces |
| AMENITIES | 1st Floor retail, Walkable to dozens of restaurants, Common Area conference room |
| AVAILABLE | Immediately |

PROPERTY HIGHLIGHTS

- Move in Ready Office Space
- Furniture can be made available
- 8 dedicated parking spaces
- Modern, sleek buildout in one of Nashville's historic buildings
- Common Area conference room available for tenants' use
- Walkable to retail

SUITE 416 & 418 - 2,820 SF

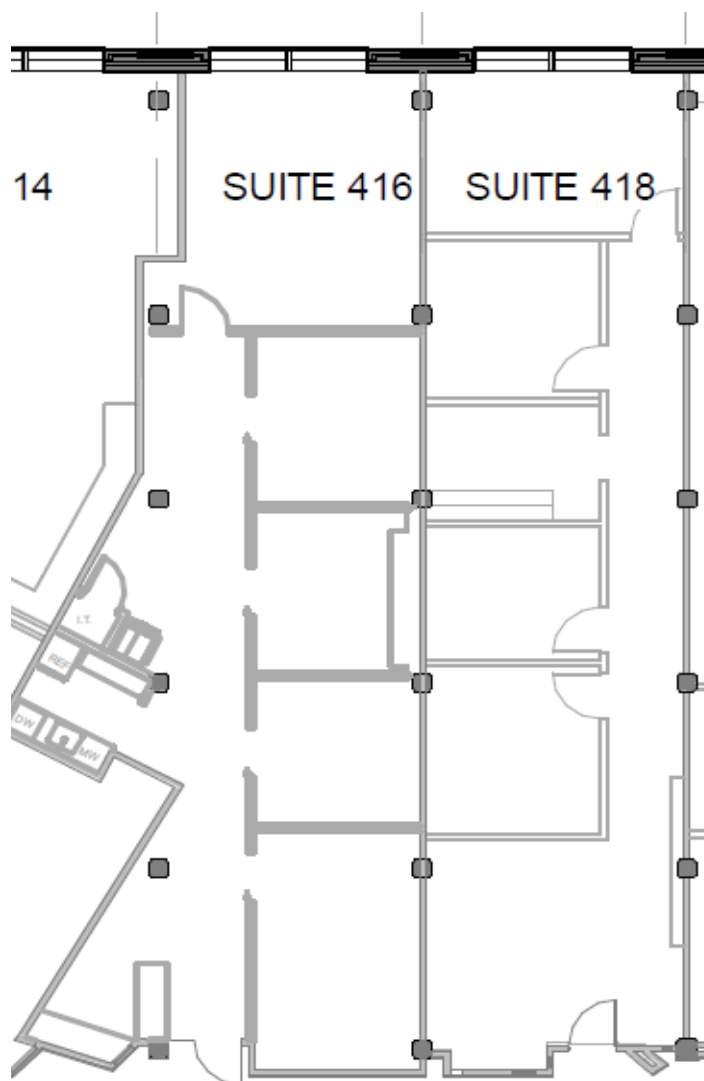

209 10TH AVE S
NASHVILLE, TN

SHELBY HALL
SHELBY.HALL@FOUNDRYCOMMERCIAL.COM
615.771.0770

JOHN MUDGETT
JOHN.MUDGETT@FOUNDRYCOMMERCIAL.COM
615.334.7259

FOUNDRY
COMMERCIAL

foundrycommercial.com

