

# ±3,000 sf flex/warehouse in North Charleston, SC

3792 Ladson Road, Suite A | Ladson, SC 29456

FOR LEASE



**Gray Wilson**  
Associate  
+1 803 608 5688  
[gray.wilson@avisonyoung.com](mailto:gray.wilson@avisonyoung.com)

**Don Lewis**  
Associate  
+1 901 626 7943  
[don.lewis@avisonyoung.com](mailto:don.lewis@avisonyoung.com)

**Alex Irwin**  
Senior Vice President  
+1 843 637 5013  
[alex.irwin@avisonyoung.com](mailto:alex.irwin@avisonyoung.com)

**STONO**  
GROUP

**AVISON  
YOUNG**

# Property overview

## Description

Well-positioned within one of the Lowcountry's most active industrial corridors, this well-configured flex space offers an efficient blend of office and warehouse functionality. The suite features finished office space complemented by open warehouse, providing an efficient footprint for a range of users. The space is equipped with one grade-level loading door and is ideally suited for light distribution, contractors, service providers, and small-bay industrial tenants seeking a strategic North Charleston location.

## Specifications

Total building size	±12,080 sf
Available suite	A
Available size	±3,007 sf
Warehouse space	±2,078 sf
Office space	±929 sf
Lease rate	\$18.50/sf/year
Lease type	NNN
TMS	389-00-00-121
Zoning	GC
County	Charleston
Municipality	Charleston County
Drive-in doors	(1) 12' x 14'
Lighting	LED
Power	200 amps, 240v, 3 phase per suite



# Floorplan

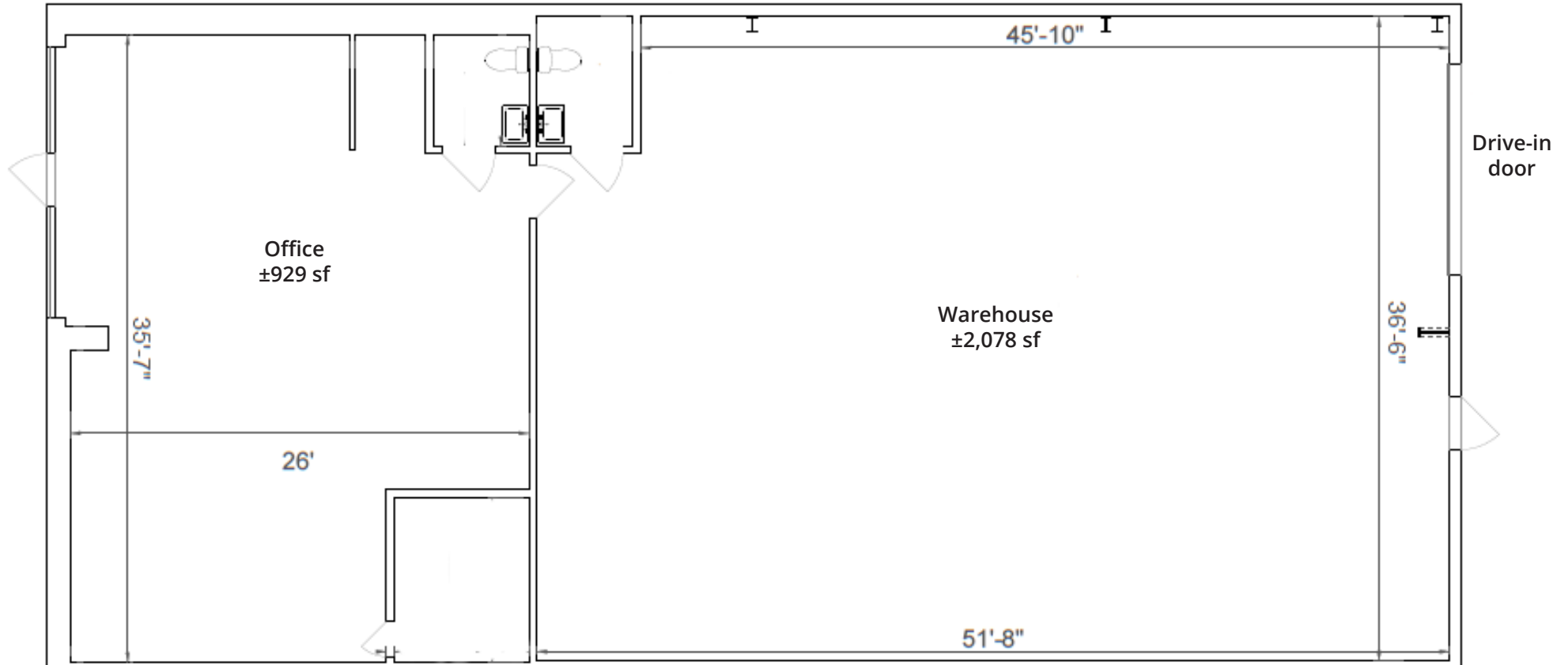

# Conceptual rendering

## Planned landlord improvements:

- Updated exterior paint scheme
- New monument signage
- Refreshed landscaping and vegetation management
- Parking lot resealing and restriping
- New architectural awnings
- Move-in ready spec office build-out



# Photos



3792 Ladson Road | Avison Young

# Location



SHIMANO



Charleston  
Air Force Base



CHS Airport



US Navy Weapons  
Joint Base Charleston



North Charleston  
Terminal



Hugh Leatherman  
Terminal



Wando Welch  
Terminal

Charleston

## SC Ports

North Charleston	16 miles
Hugh Leatherman	18 miles
Wando Welch	23 miles

## Airports

Joint Base Charleston	12 miles
Charleston Interna-	13 miles

## Drive Times

I-26	2 miles
I-95	36 miles



## LISTING TEAM

---

**Gray Wilson**

Associate

+1 803 608 5688

[gray.wilson@avisonyoung.com](mailto:gray.wilson@avisonyoung.com)

**Don Lewis**

Associate

+1 901 626 7943

[don.lewis@avisonyoung.com](mailto:don.lewis@avisonyoung.com)

**Alex Irwin**

Senior Vice President

+1 843 637 5013

[alex.irwin@avisonyoung.com](mailto:alex.irwin@avisonyoung.com)

Avison Young - South Carolina, Inc. | 40 Calhoun Steet, Suite 350 | Charleston, SC 29401 | +1 843 725 7200

**STONO**  
GROUP

**AVISON  
YOUNG**

© 2026. Avison Young. Information contained herein was obtained from sources deemed reliable and, while thought to be correct, have not been verified. Avison Young does not guarantee the accuracy or completeness of the information presented, nor assumes any responsibility or liability for any errors or omissions therein.