

# For Sublease

**2460 Brodhead Road**  
Bethlehem, PA

**25,000 – 500,000 SF AVAILABLE**

Up to 50 trailer parking spaces available for sublease



**Available Immediately through February 2025**



# Building Specifications

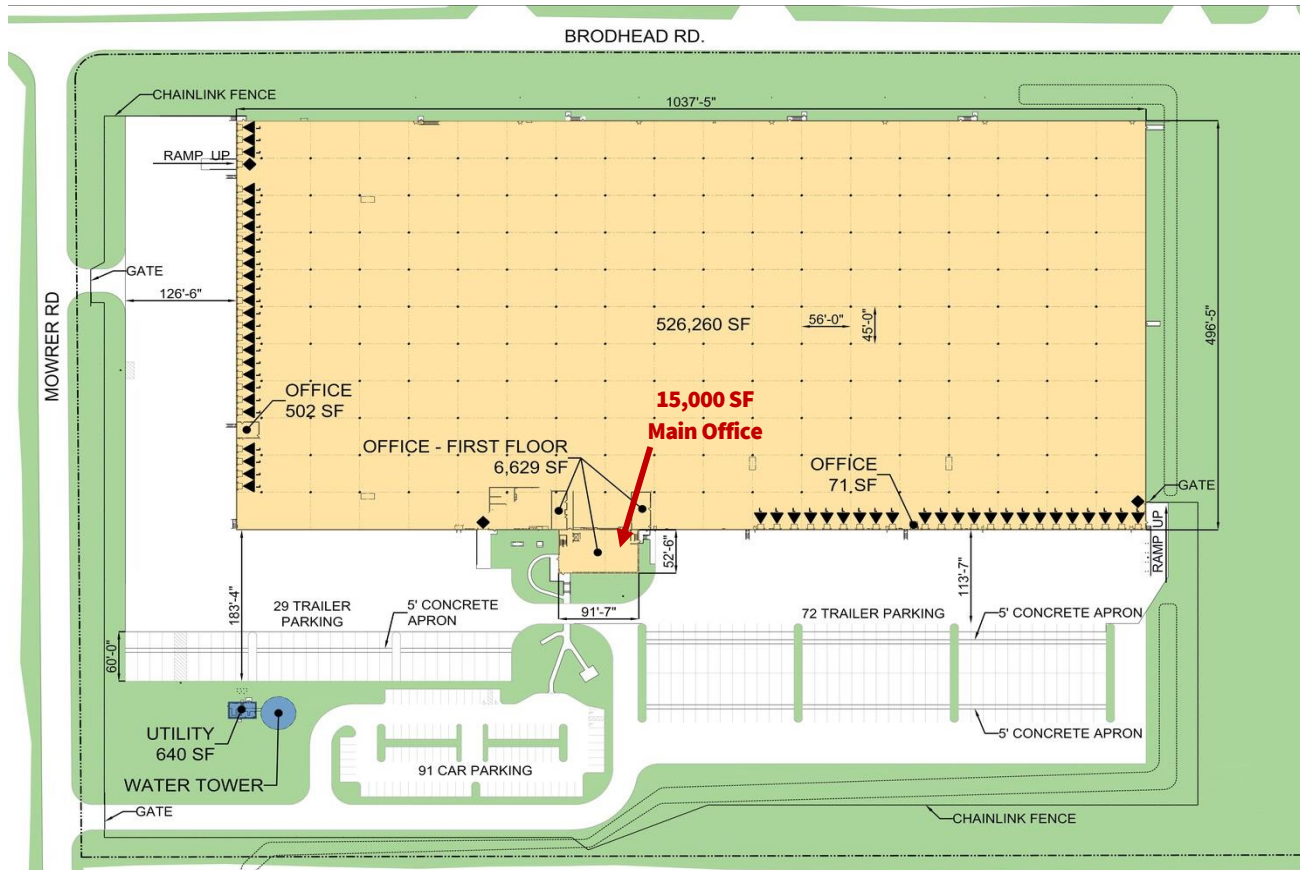

## Building Specifications:

- **Building Size:** 526,260 SF
- **Sublease Size:** 25,000 – 500,000 SF
- **Office Space:** Up to 15,000 SF
- **Year Built:** 1997
- **Sublease Dimensions:** 496' depth x 1,037' width
- **Ceiling Height:** 35' at first column from dock wall
- **Car Parking:** 50 spaces
- **Trailer Parking:** 50 dedicated stalls
- **Loading Doors:** up to 46 fully equipped loading doors
- **Drive-in Doors:** Two (2)
- **Sprinkler System:** ESFR system
- **Lighting:** T-5 lights on motion sensors



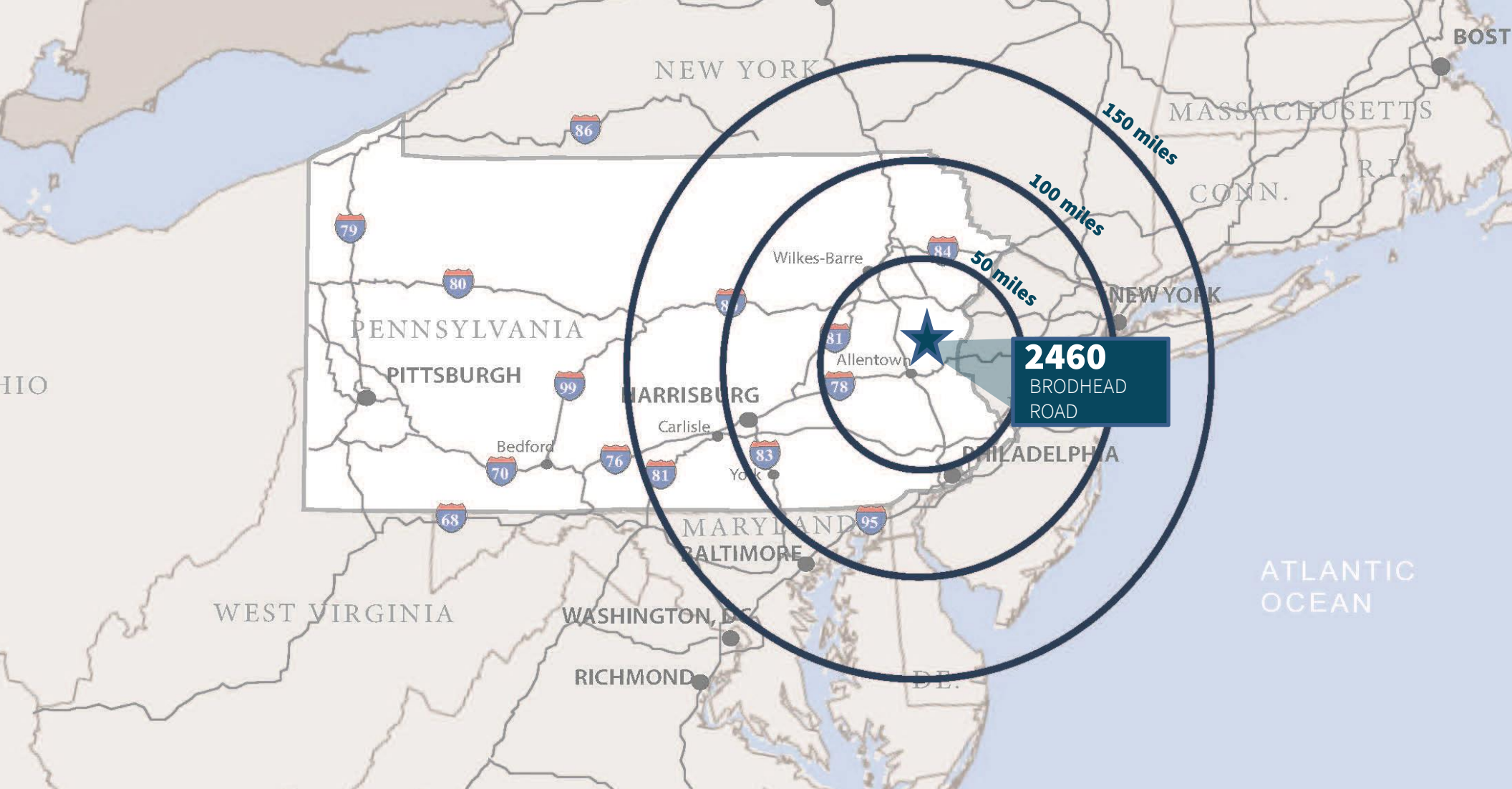

For more information,  
please contact:

**Ryan Barros**

+1 610.249.2264

[ryan.barros@jll.com](mailto:ryan.barros@jll.com)

**Jeff Lockard**

+1 215.990.1889

[jeff.lockard@jll.com](mailto:jeff.lockard@jll.com)

**JLL | 550 E Swedesford Road | Suite 260 | Wayne, PA 19087**

Although information has been obtained from sources deemed reliable, JLL does not make any guarantees, warranties or representations, express or implied, as to the completeness or accuracy as to the information contained herein. Any projections, opinions, assumptions, or estimates used are for example only. There may be differences between projected and actual results, and those differences may be material. JLL does not accept liability for any loss or damage suffered by any party resulting from reliance on this information. If the recipient of this information has signed a confidentiality agreement with JLL regarding this matter, this information is subject to the terms of that agreement. ©2023. Jones Lang LaSalle IP, Inc. All rights reserved.

