

FOR SALE - SALVATION ARMY BUILDING

2551 DODGE STREET, OMAHA, NE 68131

OFFICE | 44,119 SF | \$4,019,750



 **LEE &
ASSOCIATES**
COMMERCIAL REAL ESTATE SERVICES

PRESENTED BY:

Daniel J. Goaley

402.690.0400

dgoaley@lee-associates.com

Daniel Dutton

402.677.1247

ddutton@lee-associates.com

Jacob D. Militti

402.917.0071

jmilitti@lee-associates.com

Omaha: 12020 Shamrock Plaza, Suite 333 | Omaha, NE 68154 | 531.721.2888

Lincoln: 200 South 21st Street, Suite A113 | Lincoln, NE 68510 | 531.721.2888



FOR SALE

2551 DODGE STREET, OMAHA, NE 68131

Office | 44,119 SF | \$4,019,750



PROPERTY DESCRIPTION

40,000+ SF of space that includes floors 2 & 3 (9,686 SF each) and the main & lower floors (12,374 SF each). Four floors total with on-site parking lot.

PROPERTY HIGHLIGHTS

- Great visibility on the corner of 25th & Dodge St
- Both an owner-user or investment opportunity
- 4 floors with over 40,000 SF of space
- Additional 12,000 SF lot may be available to purchase
- Perfect for a non profit organization

LOCATION DESCRIPTION

Located in busy & beautiful downtown Omaha at 25th & Dodge Street. Easy quick highway access and highly visible.

OFFERING SUMMARY

Sale Price:	\$4,019,750
Price PSF:	\$96.55 PSF
Building Size:	44,119 SF

CONTACT

Daniel J. Goaley
dgoaley@lee-associates.com
C 402.690.0400

Daniel Dutton
ddutton@lee-associates.com
C 402.677.1247

Jacob D. Militti
jmilitti@lee-associates.com
C 402.917.0071

We obtained the information above from sources we believe to be reliable. However, we have not verified its accuracy and make no guarantee, warranty or representation about it. It is submitted subject to the possibility of errors, omissions, change of price, rental or other conditions, prior sale, lease or financing, or withdrawal without notice. We include projections, opinions, assumptions or estimates for example only, and they may not represent current or future performance of the property. You and your tax and legal advisors should conduct your own investigation of the property and transaction.

FOR SALE

2551 DODGE STREET, OMAHA, NE 68131

Office | 44,119 SF | \$4,019,750

Office Building
2551 Dodge St.

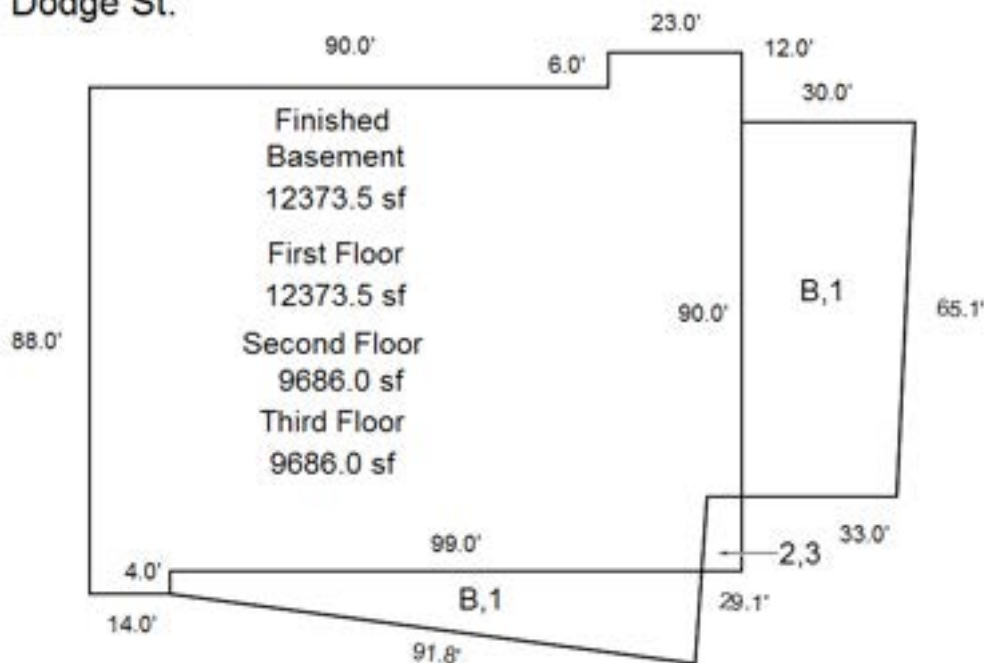

Sketch by Apex Sketch

CONTACT

Daniel J. Goaley
dgoaley@lee-associates.com
C 402.690.0400

Daniel Dutton
ddutton@lee-associates.com
C 402.677.1247

Jacob D. Militti
jmilitti@lee-associates.com
C 402.917.0071

We obtained the information above from sources we believe to be reliable. However, we have not verified its accuracy and make no guarantee, warranty or representation about it. It is submitted subject to the possibility of errors, omissions, change of price, rental or other conditions, prior sale, lease or financing, or withdrawal without notice. We include projections, opinions, assumptions or estimates for example only, and they may not represent current or future performance of the property. You and your tax and legal advisors should conduct your own investigation of the property and transaction.

FOR SALE

2551 DODGE STREET, OMAHA, NE 68131

Office | 44,119 SF | \$4,019,750



CONTACT

Daniel J. Goaley
dgoaley@lee-associates.com
C 402.690.0400

Daniel Dutton
ddutton@lee-associates.com
C 402.677.1247

Jacob D. Militti
jmilitti@lee-associates.com
C 402.917.0071

We obtained the information above from sources we believe to be reliable. However, we have not verified its accuracy and make no guarantee, warranty or representation about it. It is submitted subject to the possibility of errors, omissions, change of price, rental or other conditions, prior sale, lease or financing, or withdrawal without notice. We include projections, opinions, assumptions or estimates for example only, and they may not represent current or future performance of the property. You and your tax and legal advisors should conduct your own investigation of the property and transaction.

FOR SALE

2551 DODGE STREET, OMAHA, NE 68131

Office | 44,119 SF | \$4,019,750

LEE & ASSOCIATES

COMMERCIAL REAL ESTATE SERVICES



CONTACT

Daniel J. Goaley

dgoaley@lee-associates.com
C 402.690.0400

Daniel Dutton

ddutton@lee-associates.com
C 402.677.1247

Jacob D. Militti

jmilitti@lee-associates.com
C 402.917.0071

We obtained the information above from sources we believe to be reliable. However, we have not verified its accuracy and make no guarantee, warranty or representation about it. It is submitted subject to the possibility of errors, omissions, change of price, rental or other conditions, prior sale, lease or financing, or withdrawal without notice. We include projections, opinions, assumptions or estimates for example only, and they may not represent current or future performance of the property. You and your tax and legal advisors should conduct your own investigation of the property and transaction.

FOR SALE

2551 DODGE STREET, OMAHA, NE 68131

Office | 44,119 SF | \$4,019,750



COMMERCIAL REAL ESTATE SERVICES



CONTACT

Daniel J. Goaley
dgoaley@lee-associates.com
C 402.690.0400

Daniel Dutton
ddutton@lee-associates.com
C 402.677.1247

Jacob D. Militti
jmilitti@lee-associates.com
C 402.917.0071

We obtained the information above from sources we believe to be reliable. However, we have not verified its accuracy and make no guarantee, warranty or representation about it. It is submitted subject to the possibility of errors, omissions, change of price, rental or other conditions, prior sale, lease or financing, or withdrawal without notice. We include projections, opinions, assumptions or estimates for example only, and they may not represent current or future performance of the property. You and your tax and legal advisors should conduct your own investigation of the property and transaction.

FOR SALE

2551 DODGE STREET, OMAHA, NE 68131

Office | 44,119 SF | \$4,019,750



COMMERCIAL REAL ESTATE SERVICES

POPULATION	1 MILE	3 MILES	5 MILES
Total Population	24,670	128,172	268,100
Average Age	33	36	36
Average Age (Male)	33	35	36
Average Age (Female)	32	36	37

HOUSEHOLDS & INCOME	1 MILE	3 MILES	5 MILES
Total Households	11,113	52,857	105,926
# of Persons per HH	2.2	2.4	2.5
Average HH Income	\$54,508	\$73,501	\$73,162
Average House Value	\$271,550	\$248,894	\$223,510

Demographics data derived from AlphaMap

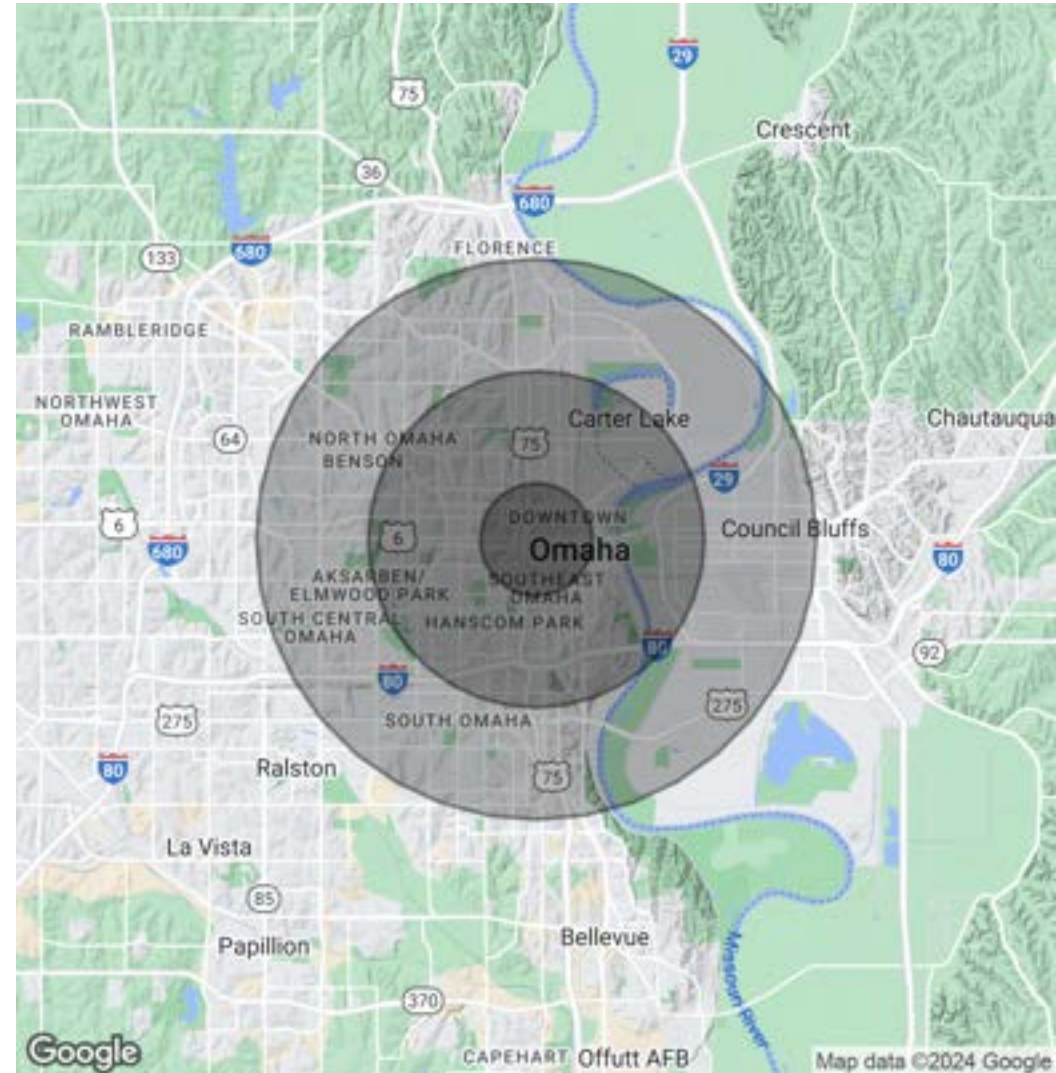

CONTACT

Daniel J. Goaley
dgoaley@lee-associates.com
C 402.690.0400

Daniel Dutton
ddutton@lee-associates.com
C 402.677.1247

Jacob D. Militti
jmilitti@lee-associates.com
C 402.917.0071

We obtained the information above from sources we believe to be reliable. However, we have not verified its accuracy and make no guarantee, warranty or representation about it. It is submitted subject to the possibility of errors, omissions, change of price, rental or other conditions, prior sale, lease or financing, or withdrawal without notice. We include projections, opinions, assumptions or estimates for example only, and they may not represent current or future performance of the property. You and your tax and legal advisors should conduct your own investigation of the property and transaction.