

FOR LEASE

FOLEY INDUSTRIAL PARK 23482 & 23520 FOLEY STREET

HAYWARD, CA



Teaser Rate of \$0.99
NNN Year 1*

*For Leases Signed by
6/30/26

6% Procuring
Commission Bonus!

BROOKS BAKER

Senior Associate
+1 510 874 1927
brooks.baker@cbre.com
Lic. 02000900

Two (2) Building Multi-Tenant
Industrial Project of ±40,400 SF

T TERRENO
CBRE

PHOTOS & SITE PLAN

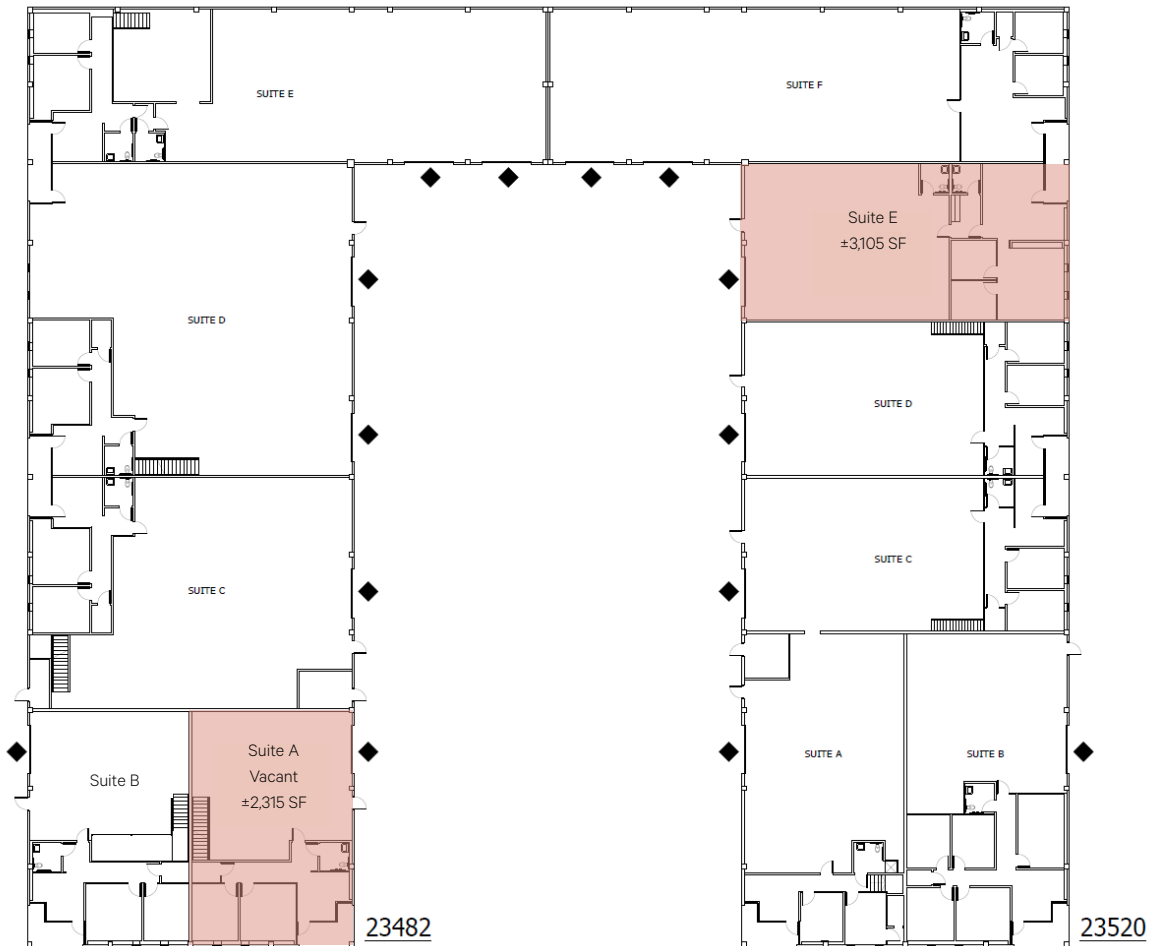
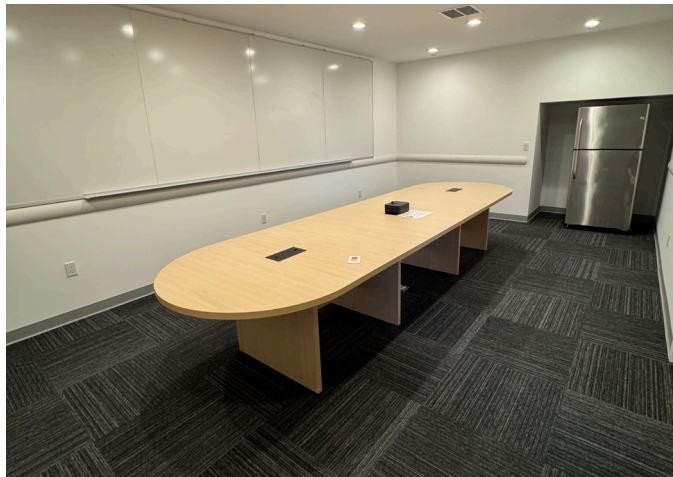

ADDRESS	SF	OFFICE	FEATURES	POWER	RATE	AVAILABLE
23482 Foley Street, Suite A	±2,315 SF	±812 SF	1 Grade Level Door	200 amps @ 208V	\$1.10 NNN/SF	Now
23520 Foley Street, Suite E	±3,105 SF	±1,127 SF	1 Grade Level Door	200 amps @ 208V	\$1.10 NNN/SF	Now

© 2026 CBRE, Inc. All rights reserved. This information has been obtained from sources believed reliable, but has not been verified for accuracy or completeness. You should conduct a careful, independent investigation of the property and verify all information. Any reliance on this information is solely at your own risk. CBRE and the CBRE logo are service marks of CBRE, Inc. All other marks displayed on this document are the property of their respective owners, and the use of such logos does not imply any affiliation with or endorsement of CBRE. Photos herein are the property of their respective owners. Use of these images without the express written consent of the owner is prohibited.