

5 Industrial Dr

M ATTAPOISETT

MA 02739, USA



FOR SALE OR LEASE

± 20,000 – 125,000 SF AVAILABLE

SUBDIVIDES TO VARIOUS SUITE SIZES

IMMEDIATE ACCESS TO I-195

NEWMARK

Building Specifications

Building SF	125,000 SF
Available SF	20,000 – 125,000 SF - subdivides to various suite sizes
Office SF	14,798 SF
Dock Doors	8 (with potential to add 7 more)
Drive-in Doors	1 (with potential to add 4 more)
Employee Parking	125
Clear Height	28' at center
Lighting	all new LEDs
Sprinklers	ESFR
Column Spacing	52'w x 25'd
Utilities	gas heat in warehouse, forced air AC and heat in office
Power	600a @480v, equivalent to 1,380 amps at 208v. A second service connection, with 2,000 amps at 480v (3-phase), equivalent to 4,615 amps at 208v, is designed and approved by the utility provider and is waiting at the street for connection

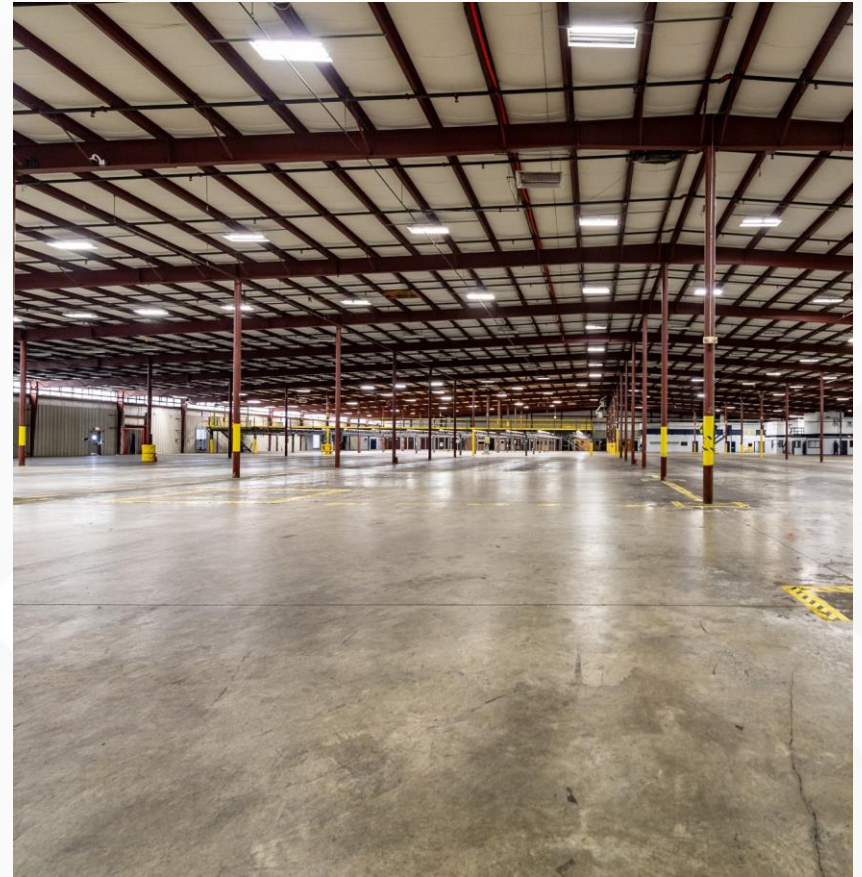

Site Plan - Existing & Potential Conditions

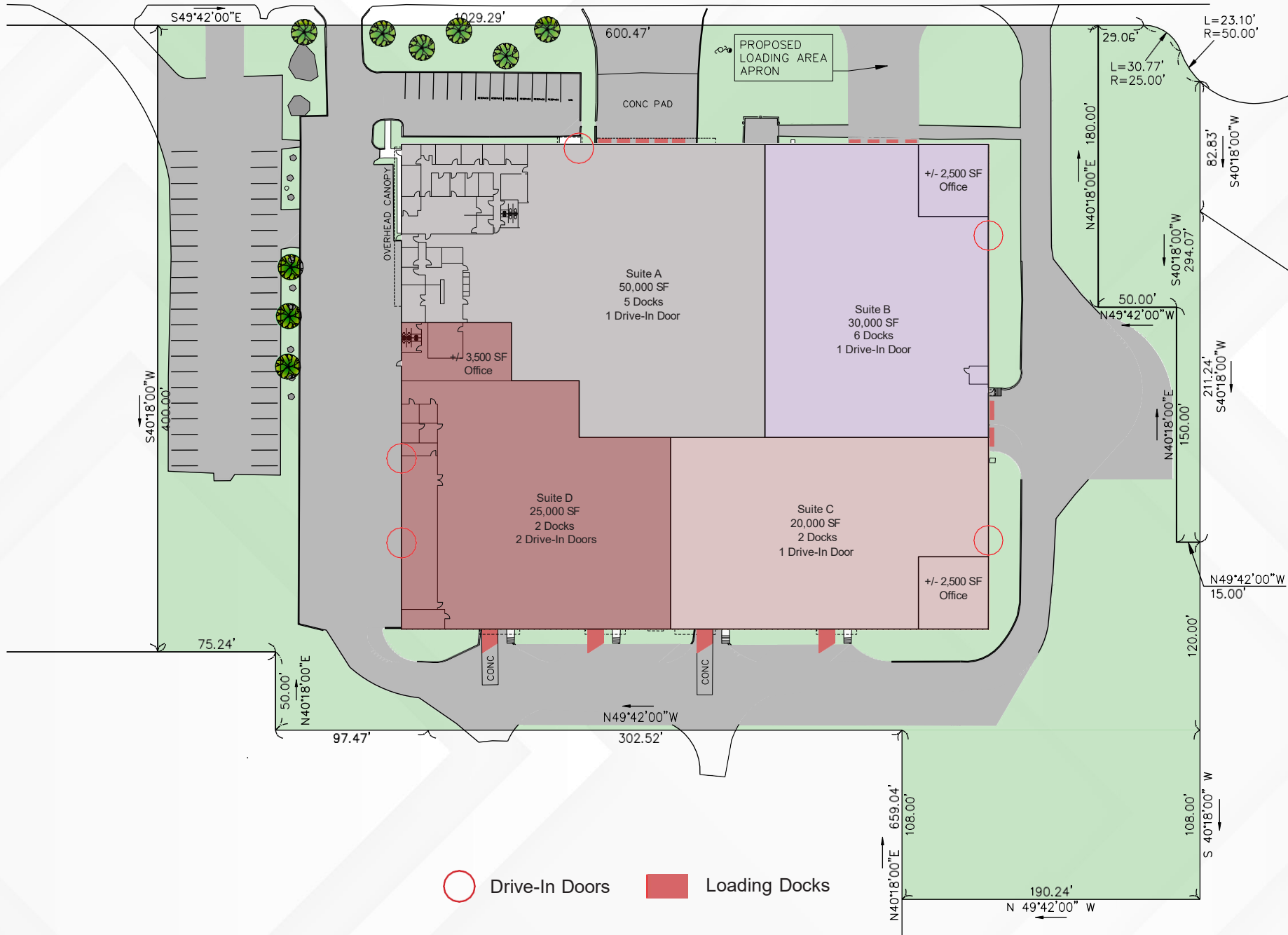

Floor Plan - Existing & Potential Conditions

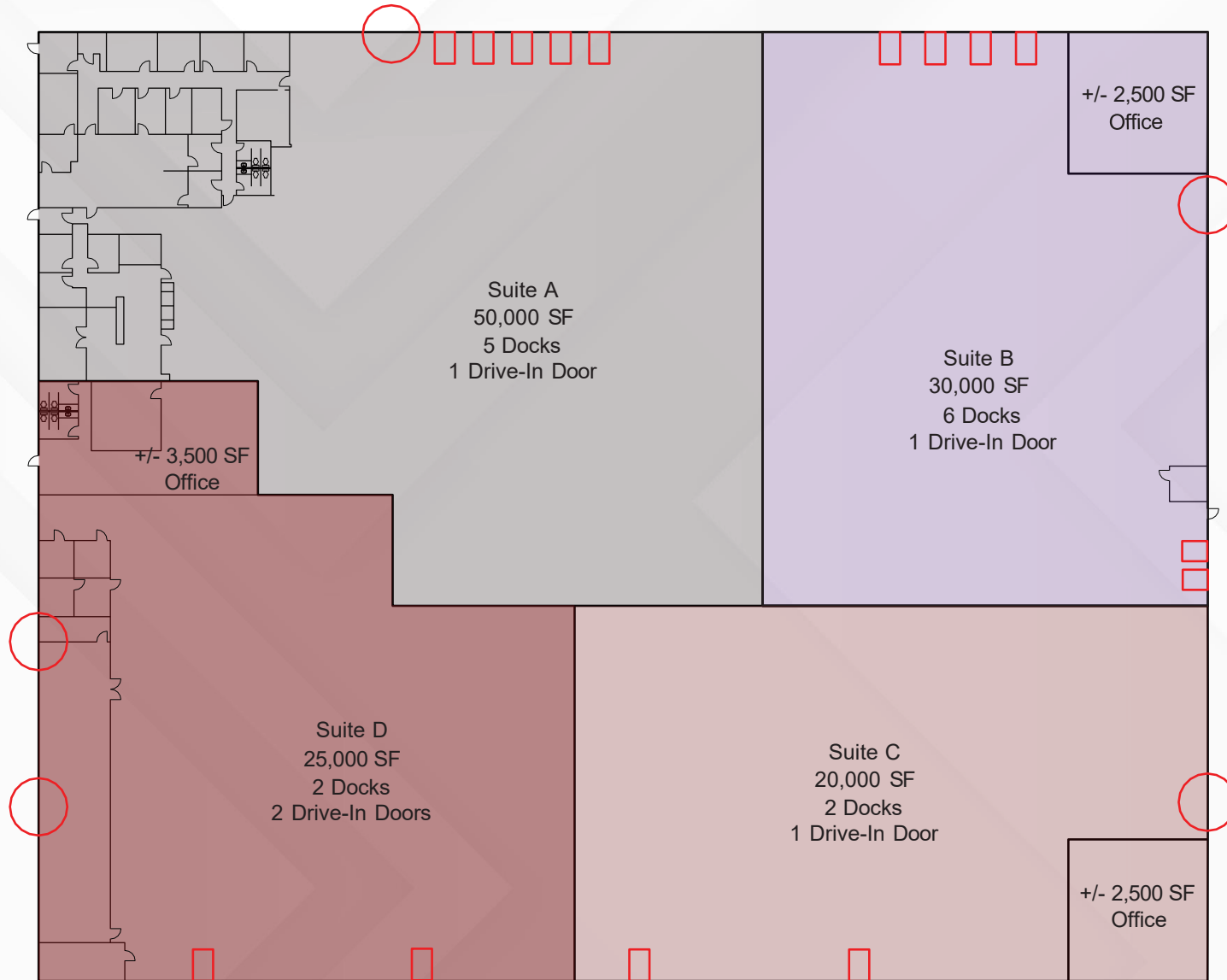

○ Drive-In Doors □ Loading Docks





Superior Access & Location



I - 195
0.5 MILES

I - 495
8 MILES

140
7 MILES

PROVIDENCE
30 MINUTES

BOSTON
<1 HR

BOURNE
BRIDGE
20 MINUTES

NEW BEDFORD
REGIONAL AIRPORT
10 MINUTES

RICK SCHUHWERK
617-863-8533
rick.schuhwerk@nmrk.com

ED JAROSZ
617-863-8529
ed.jarosz@nmrk.com

ALLIE PERCOCO
617-755-9563
allie.percoco@nmrk.com

MICHAEL MALINCONICO
617-863-8428
michael.malinconico@nmrk.com

ALISTAIR MATULE
617-599-4255
alistair.matule@nmrk.com

NEWMARK