

Wilmette Place

RETAIL SPACE FOR LEASE



135-147 Skokie Blvd
Wilmette, IL 60091

Andrew Prunty
Apex Commercial Realty
Managing Broker
(847) 650-8299
andrew@commercialrealtybyapex.com
Lic: 471.020524



THE SPACE

Location	135-147 Skokie Blvd Wilmette, IL 60091
County	Cook
Cross Street	Old Glenview Rd.
Traffic Count	15,750
Square Feet	2466
Rent Per SF (Annual)	\$30.00
Lease Type	NNN
Floor	1

Notes End-cap space with excellent exposure on Skokie Blvd.

HIGHLIGHTS

- Excellent exposure on Skokie Blvd.
- Located at signalized intersection
- Strong local demographics
- Close to numerous major retailers



POPULATION

1.00 MILE	3.00 MILE	5.00 MILE
14,384	143,900	349,424

AVERAGE HOUSEHOLD INCOME

1.00 MILE	3.00 MILE	5.00 MILE
\$164,961	\$181,701	\$158,598

NUMBER OF HOUSEHOLDS

1.00 MILE	3.00 MILE	5.00 MILE
5,548	52,408	129,772

PROPERTY FEATURES

TOTAL TENANTS	5
BUILDING SF	5,808
LAND ACRES	.44
YEAR BUILT	1989
ZONING TYPE	NR - Neighborhood Retail
NUMBER OF STORIES	1
NUMBER OF BUILDINGS	1
NUMBER OF PARKING SPACES	25
PARKING RATIO	4.4
CORNER LOCATION	Yes



Property Summary

- Wilmette Place is a neighborhood center located at the signalized corner of Skokie Blvd. and Old Glenview Rd. The property is located less than 1 mile north of Westfield's Old Orchard Mall.

Major Industries by Employee Count

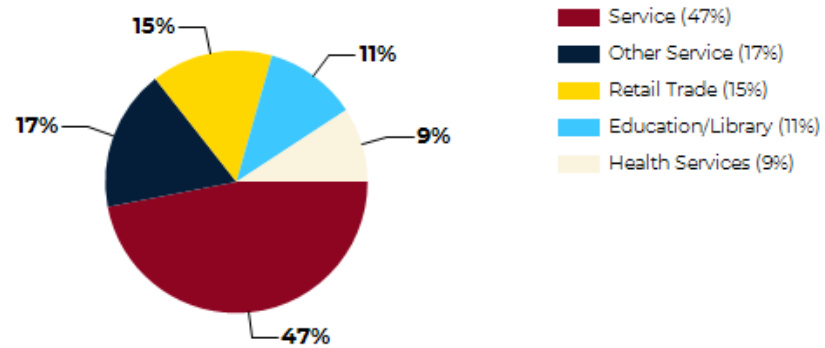

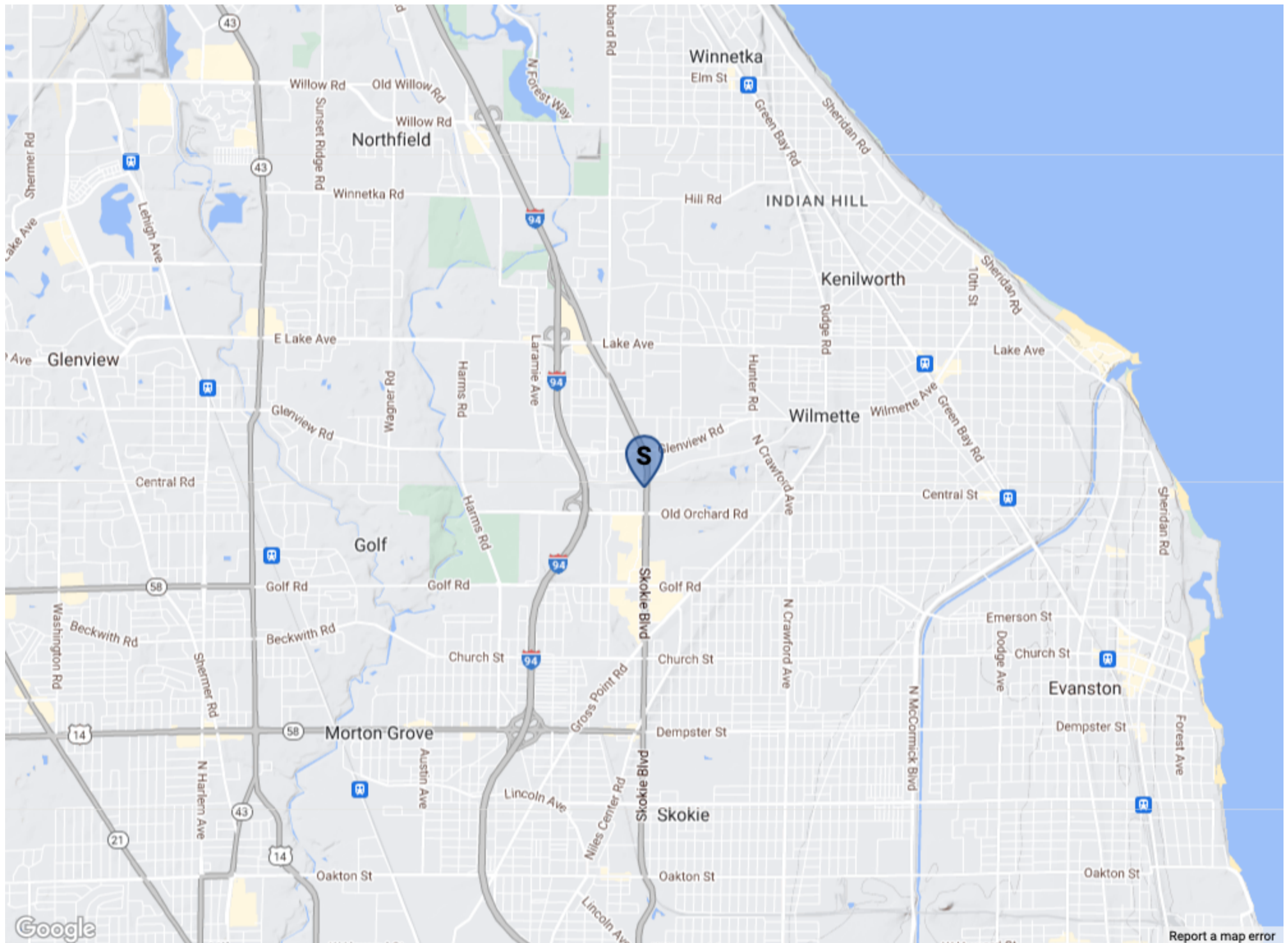

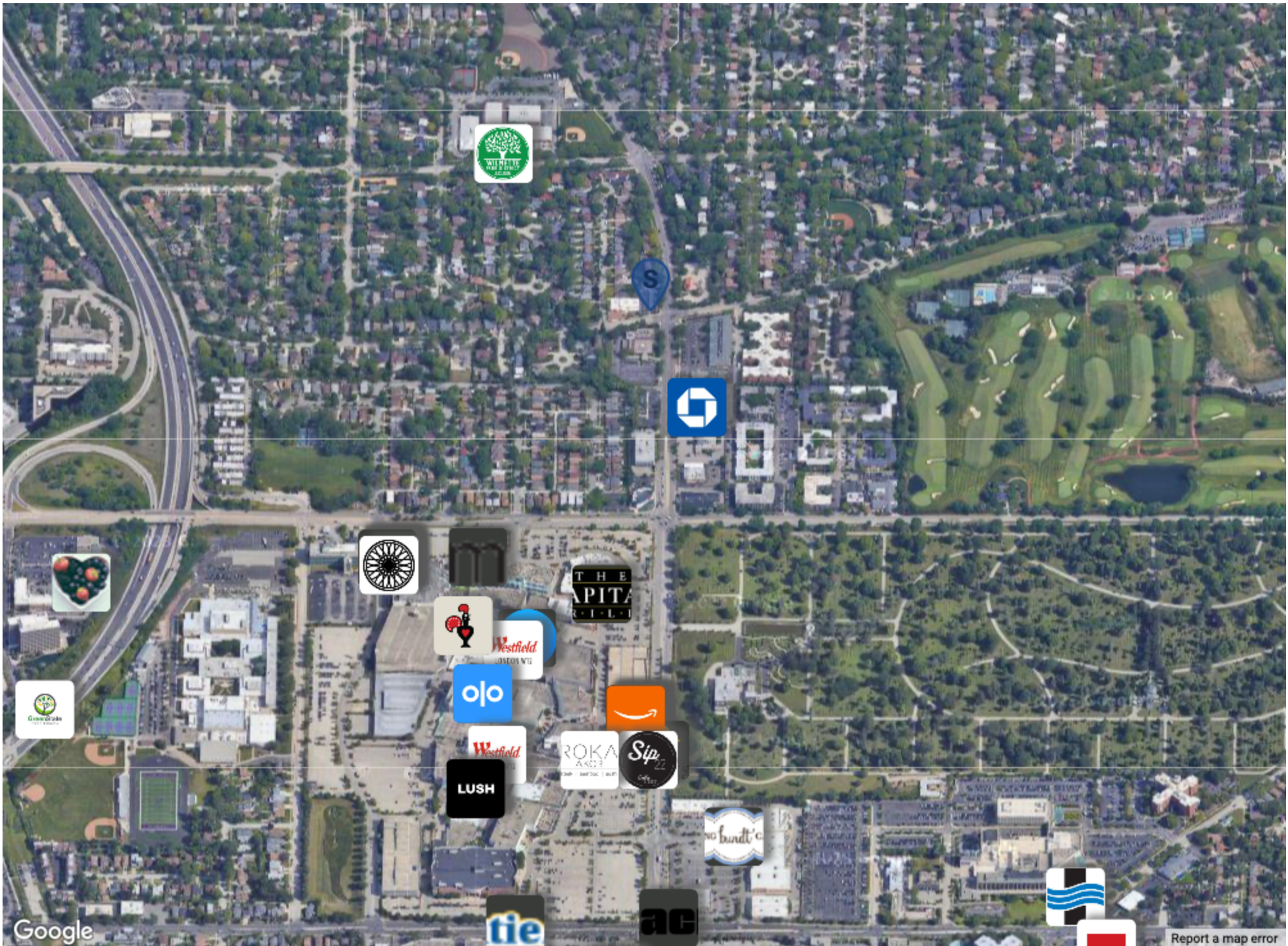

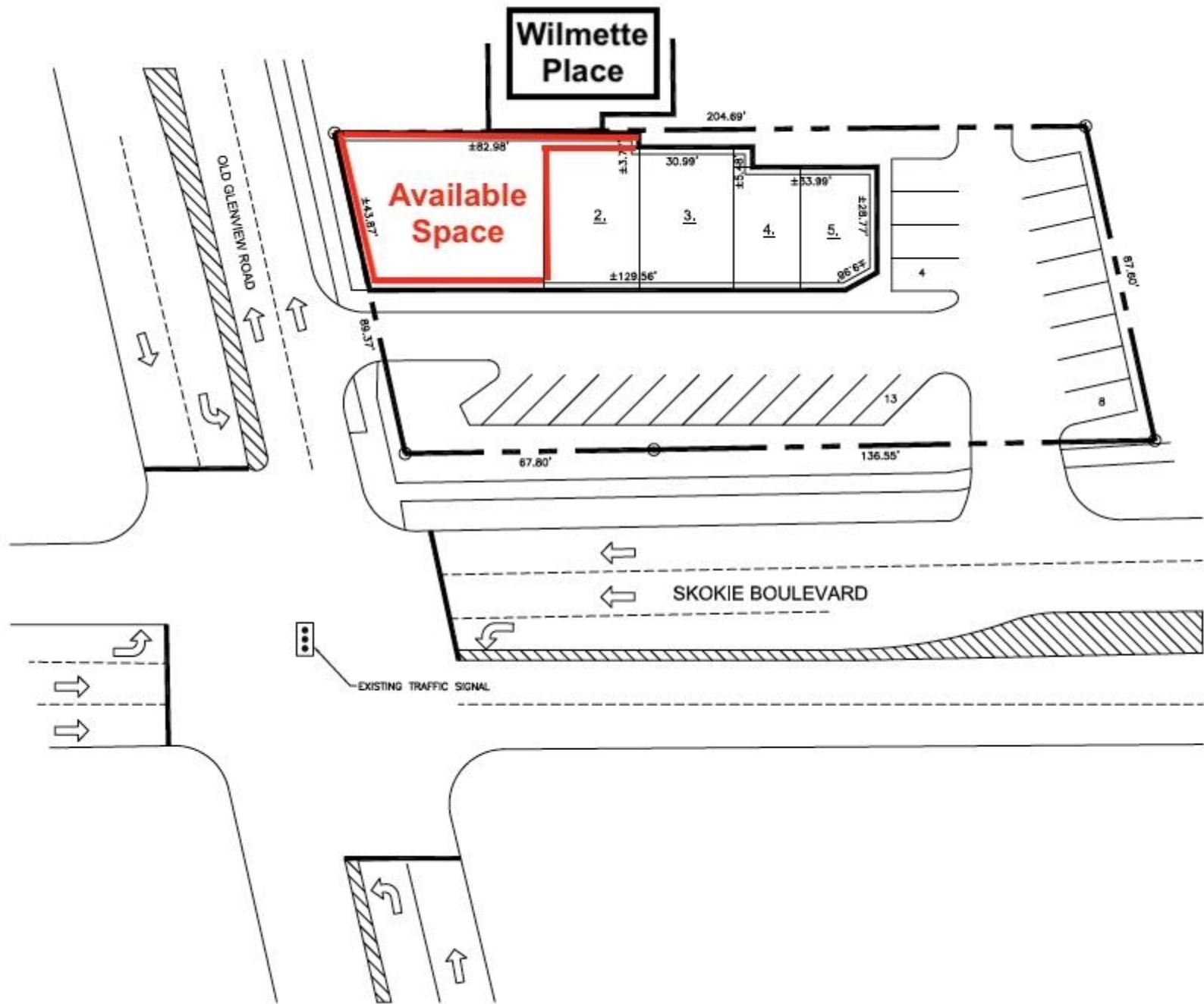

Wilmette Place

CONFIDENTIALITY and DISCLAIMER

The information furnished herein is from sources deemed reliable and is subject to inspection and verification by all parties relying on it. No liability for its accuracy, errors, or omissions is assumed by Apex Commercial Realty LLC. Price subject to change and this listing may be withdrawn without notice.



Exclusively Marketed by:

Andrew Prunty
Apex Commercial Realty
Managing Broker
(847) 650-8299
andrew@commercialrealtybyapex.com
Lic: 471.020524



<https://commercialrealtybyapex.com>